

FLEXSTEEL®

Power Reclining Loveseat with Power Headrests, Lumbar, Heat & Massage

IMPORTANT NOTE

Read these instructions carefully, and familiarize yourself with each procedure before assembling the furniture. Check that you have all the component parts, and familiarize yourself with each part before proceeding.

Take all the fittings out of the plastic bag and separate them into groups. Ensure you have enough space to lay out all the parts before assembly. To prevent damage to the parts, we recommend that you assemble the unit on a soft, flat surface.

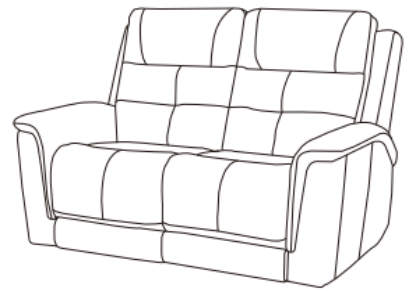

Part List

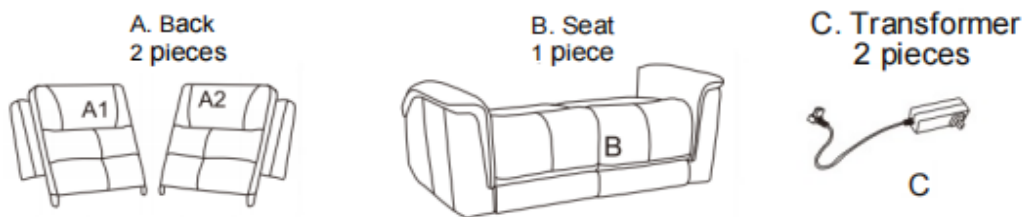

Assembly Instructions

STEP 1

Remove the Transformers (C) from the bottom of the seat (B). (See Figure 1)

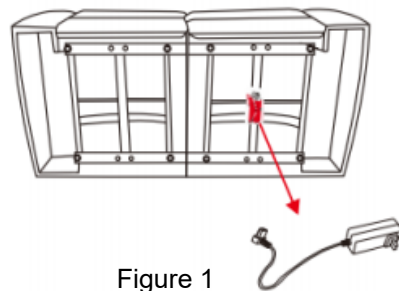

Figure 1

STEP 2

Attach the Backs (A1 & A2) to the Seat (B), ensure the brackets fit tightly. (See Figure 2)

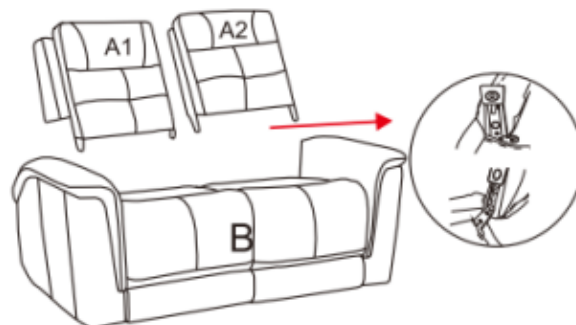

Figure 2

STEP 3

Zip the fabric on bottom of the Backs (A1 & A2) with back of Seat (B). (See Figure 3)

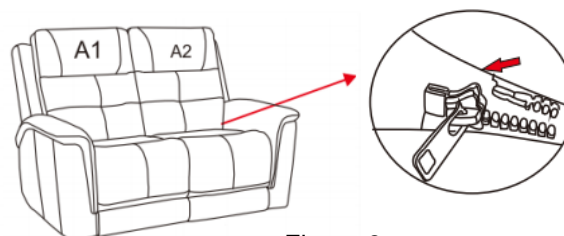

Figure 3

STEP 4

Flip up the back flap, and remove the cables from the Backs (A1 & A2).

Connect the cables with red labels together, and then connect the cables with labels A to A, B to B, C to C. (See Figure 4)

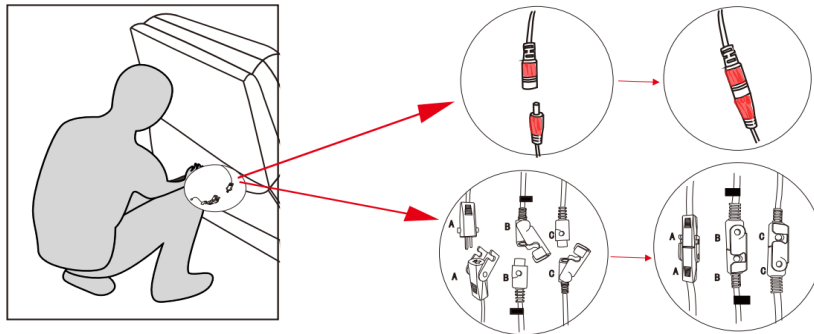

Figure 4

STEP 5

Connect the transformers (C) into the power ports on the back of the left & right seats. Plug both transformers (C) into nearby outlets, still making sure they are clear of the metal base.

Fasten the back flaps to the bottom of the furniture. (See Figure 6)

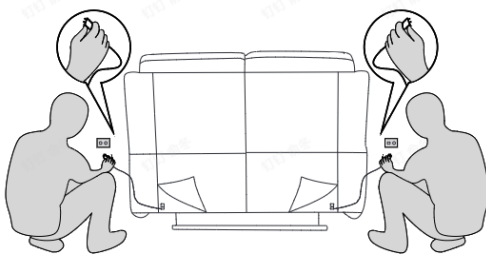

Figure 5

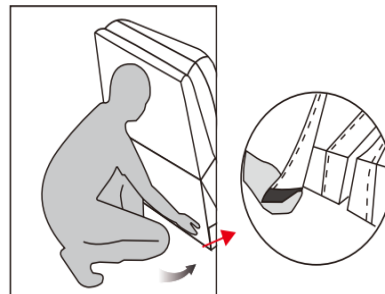

Figure 6

Back Disassembly

Pull up the spring leaf in bracket, then lift Back (A) up.

Unzip the black fabric on bottom of back from back of seat.

Disconnect all of the cables behind the backs. (See figure 7)

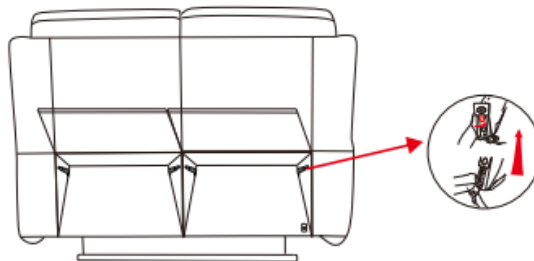

Figure 7

IMPORTANT NOTE

- To avoid any risk of suffocation to children or pets dispose of all plastic bags immediately.
- To ensure proper performance occasionally check for loose screws and tighten as needed.
- If the reclining functions are not working properly, check for loose cable connections before contacting the retailer.