

# INSTALLATION INSTRUCTIONS

Item Number: Backlit Mirror Two-AA22.232.2-7-1

(120VAC, 60Hz, max100W)

## ITEMS INCLUDED

 A  $\Phi 7.5 \times 36 \text{mm} \times 5$

 B  $4 \times 40 \text{mm} \times 3$    $5 \times 40 \text{mm} \times 2$

## NECESSARY TOOLS (NOT INCLUDED)



## INSTALLATION



### Installation must be carried out by a licensed electrician

- 1) For your safe, please switch off the main power supply and remove the appropriate circuit fuse before the installation. Before proceeding to install power supply wiring, ensure the conduit is brought in through the wall and into the chassis knockout. 6" of wire should be left extending into the metal fixture to make the connection.
- 2) The location should be mechanically sound enough to support the fixture;
- 3) Ensure the mounting surface is dry and allows for fitting to be safely connected to the main power supply;
- 4) If the location requires the provision of a new electrical supply, the supply must conform with the requirements of related Building Regulations ;
- 5) The top of the fixtures should be off the finished floor enough to accommodate the height of a user;
- 6) Using a spirit level as a guide , draw a pencil line on mounting surface to mark the bottom edge of the fitting; locate and mark the position of mounting screws on the mounting surface (mounting holes are provided in the chassis);
- 7) Wear suitable eye protection when drilling;
- 8) Use caution drilling take care when drilling on tiled surfaces in case of drill slips. A piece of masking tape applied to the wall before marking up the fixing holes will stop the drill from wandering.

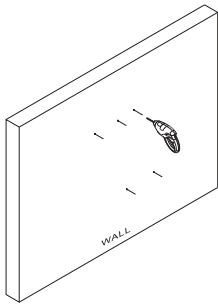

#### Step 1

Drilling the hole as the measurement

See next page for dimension

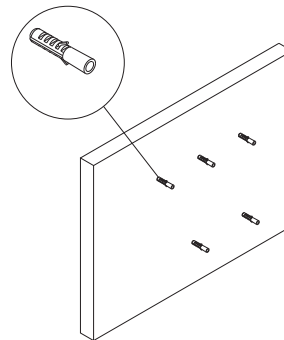

#### Step 2

Insert anchors (A) into the wall

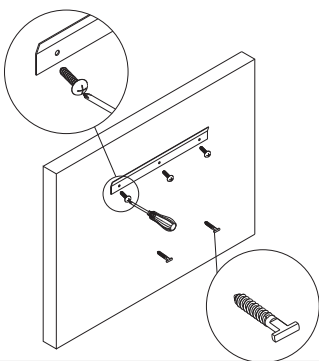

#### Step 3

Having a helper hold the fitting, secure the metal case to the wall using the screws (B) supplied.

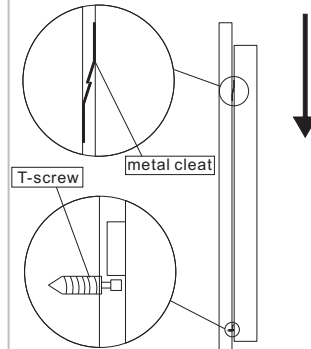

#### Step 4

Rotate the T-screw as shown

Install the frame on the metal cleat



T-screw

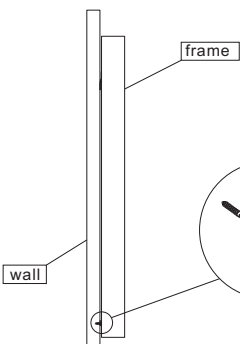

#### Step 5

Rotate the T-screw as shown

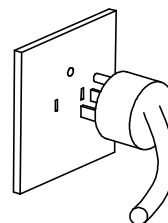

#### Step 6

Make sure that the product is connected to an outlet having the same configuration as the plug

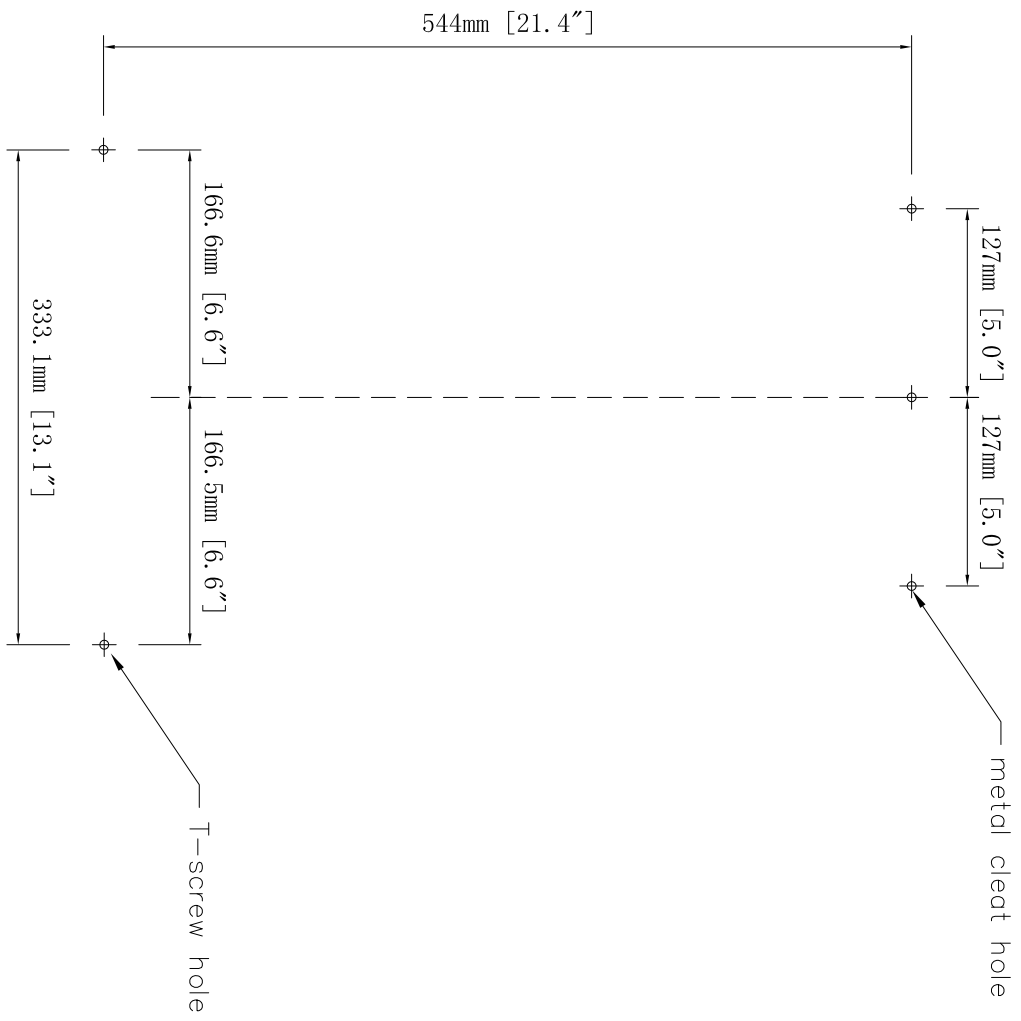

# INSTALLATION GUIDELINES

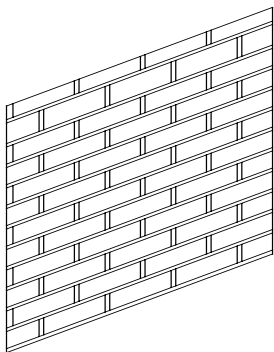

**This product can be installed directly on a Cement wall.**

**Any other installation method will void the product warranty and can lead to injuries.**



## SAFETY INFORMATION

Please read and understand this entire manual before attempting to assemble, operate or install the product.

- Handle the glass with caution! Improperly handling the glass can cause it to break.
- You will need at least two people to install this unit properly.
- Distributor is not responsible for any damage to the unit or personal property caused by improper installation.
- Carefully remove product from packaging and keep packaging until installation is complete.
- Inspect all parts for damage; if there is damage to the unit prior to installation, please contact customer service at the number provided in this guide.
- Install the product on a leveled surface.



Make sure that the electricity is turned off at the power source before proceeding with the installation.

### IMPORTANT SAFETY INSTRUCTIONS

When using an electrical furnishing, basic precautions should always be followed, including the following:

Read all instructions before using this furnishing.

**DANGER** – To reduce the risk of electric shock

1. Always unplug this furnishing from the electrical outlet before cleaning.
2. If the product is broken, please turn off the power or unplug it and contact the supplier for maintenance.

**WARNING** – To reduce the risk of burns, fire, electric shock, or injury to persons:

- a. Close Supervisions necessary when this furnishing is used by, or near children, invalids, or disabled persons.
- b. Use this furnishing only for its intended use as described in these instructions. Do not use attachments not recommended by the manufacturer.
- c. Never operate this furnishing if it has a damaged cord or plug, if it is not working properly, if it has been dropped or damaged, or dropped into water. Return the furnishing to a service center for examination and repair.
- d. Keep the cord away from heated surfaces.
- e. Never operate the furnishing with the air openings blocked. Keep the air openings free of lint, hair, and the like.
- f. Never drop or insert any object into any opening.
- g. Do not use outdoors.
- h. **WARNING:** Risk of Electric Shock – Connect this furnishing to a properly grounded outlet only. See Grounding Instructions.
- i. Mount furnishings at the correct height.
- j. **CAUTION** – Risk of Electric Shock. This unit has two power supply cords. Disconnect both cords before mobbing or servicing this furnishing.
- k. To disconnect, turn all controls to the off position, then remove plug from outlet.
- l. Suitable for Damp Location.
- m. Unplug from outlet before putting on or taking off parts.

**SAVE THESE INSTRUCTIONS**

### GROUNDING INSTRUCTIONS

- a) For a grounded, cord-connected product rated max 15 amperes and intended for use on a nominal 120-volt supply circuit : This product is for use on a nominal 120-volt circuit and has a grounding plug that looks like the plug illustrated in sketch A (see Figure 77.1). Make sure that the product is connected to an outlet having the same configuration as the plug. No adapter should be used with this product.

Figure 77.1  
Grounding methods

