

FLEXSTEEL®

W1151-831

Dining Table

IMPORTANT NOTE

Carefully remove all the parts from the carton and put them individually on a soft cloth to prevent damage to the parts.

We have taken great care in the design of this product and request that you carefully and accurately follow our assembly instructions to ensure proper set-up. We recommend at least two adults assemble this product.

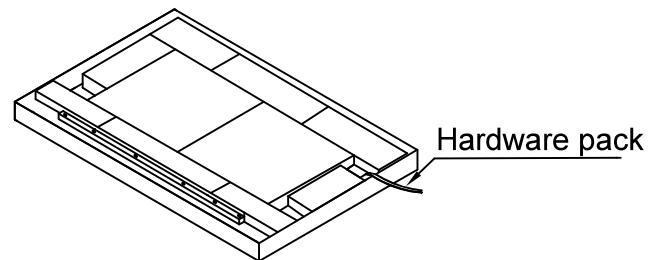
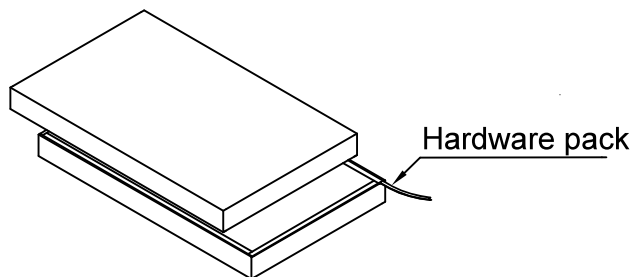
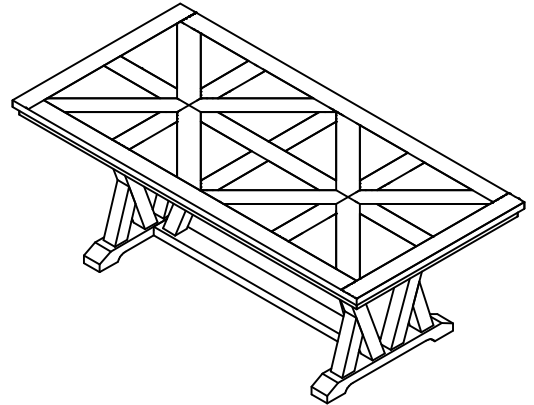

Part List

Assembly Instruction 1/5

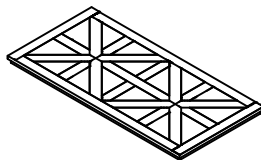

A. Table Top
1 piece

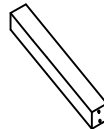

B. Legs
2 pieces

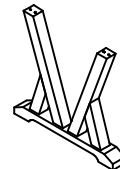

C. Legs
2 pieces

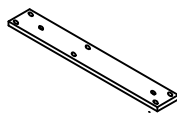

D. Connecting Panel
2 pieces



E. Connecting Panel
2 pieces

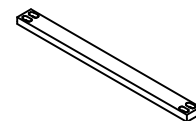

F. Shelf
1 piece

Hardware List



1. Long Bolt
Ø5/16" * 63.5mm
2 pieces

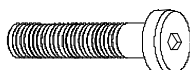

2. Medium Bolt
Ø5/16" * 50mm
4 pieces

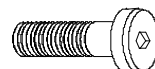

3. Short Bolt
Ø5/16" * 35mm
22 pieces



4. Spring Washer
Ø5/16" * 1.5mm
28 pieces



5. Flat Washer
Ø5/16" * 19mm
24 pieces



6. Curved Washer
Ø5/16" * 2mm
4 pieces

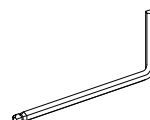

7. Hex Key
4mm
1 piece



8. Dowel
Ø10*30mm
8 pieces

IMPORTANT NOTES

- Do not tighten up all the bolts until each part is properly assembled.
- Keep the Hex Key in a safe place as you may need to tighten up the bolts in the future.
- Use a soft cloth between these parts and the floor.
- We recommend this product be assembled by at least two adults

STEP 1

Place Wood Dowel (8) into the holes in the Legs (C). Stack the Connecting Panel (D) on to the Legs (C) and fix with the Short Bolts (3), Spring Washers (4) and Flat Washers (5) by Hex key (7).
(See Figure 1)

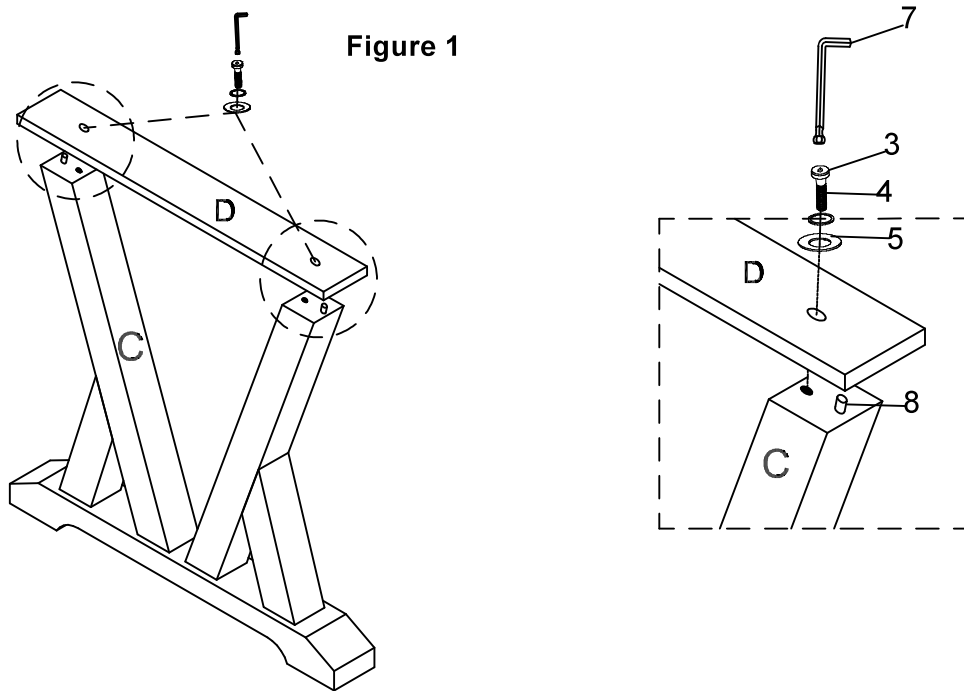

STEP 2

Attach Shelf (F) to the Leg (C) with the Medium Bolts (2), Spring Washer(4) and Curved Washer (6), and tighten with Hex Key (7).
(See Figure 2).

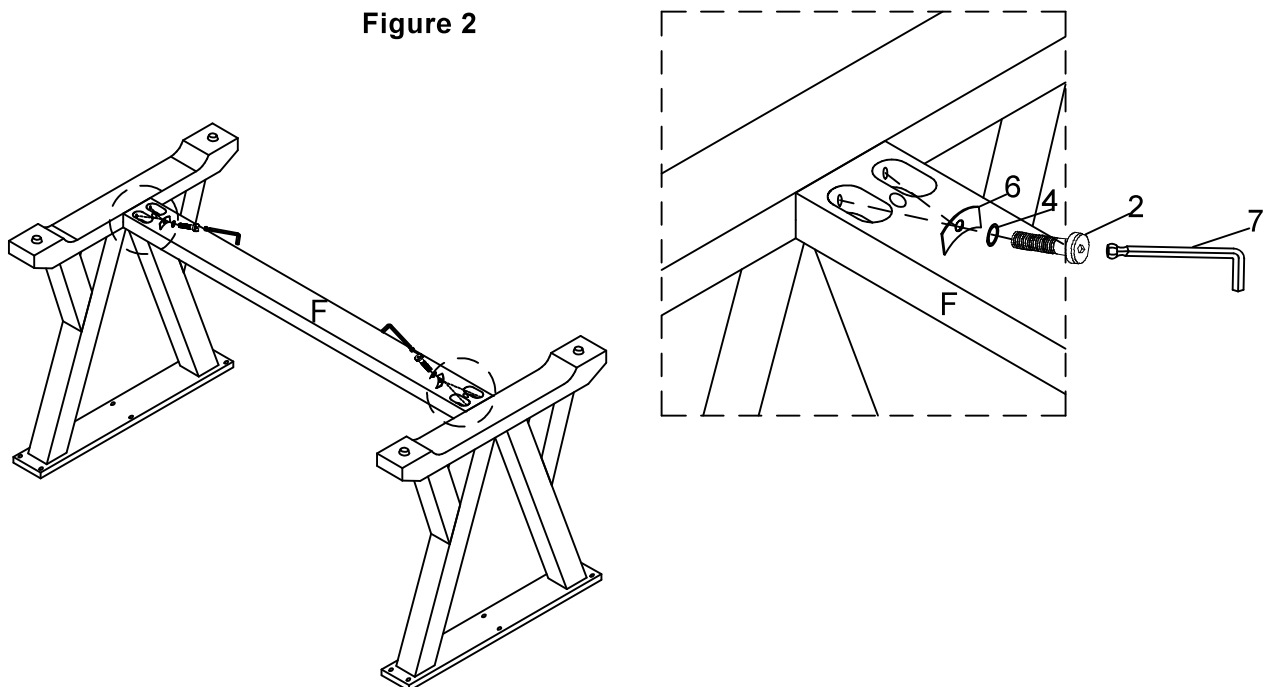

STEP 3

Place Wood Dowels (8) into the holes in the Legs (B). Stack the Connecting Panel (E) on to the Legs (B) and fix with Short Bolts (3), Spring Washers (4), and Flat Washers (5), and tighten with Hex Key (7). (See Figure 3)

Figure 3

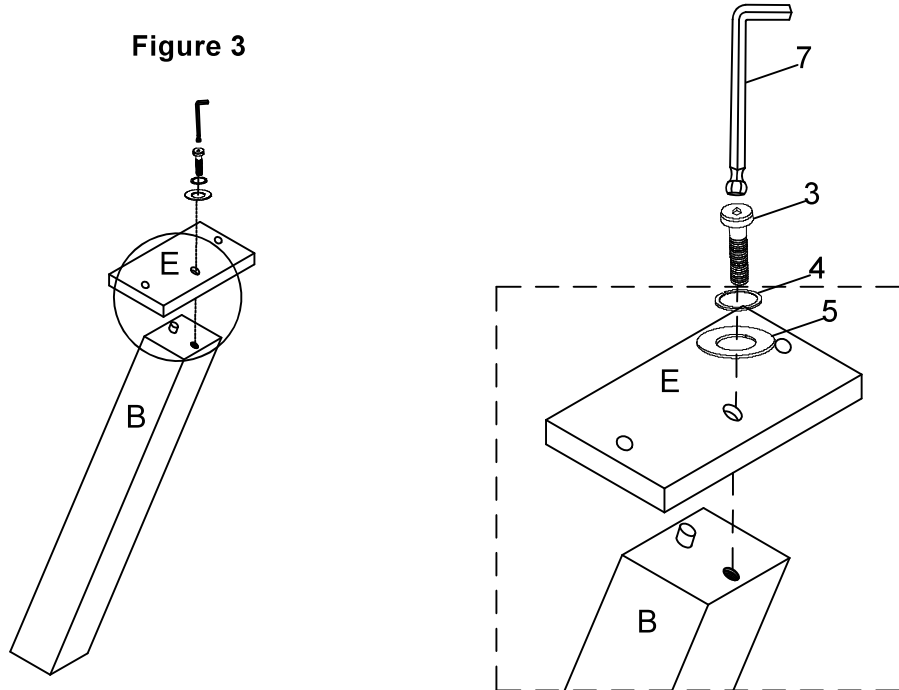

STEP 4

Place Table Top (A) upside down on a clean, smooth surface. Attach Legs (B) with the Short Bolts (3), Spring Washers (4) and Flat Washers (5). Use Hex Key (7) to tighten the Short Bolts (3). (See Figure 4)

Figure 4

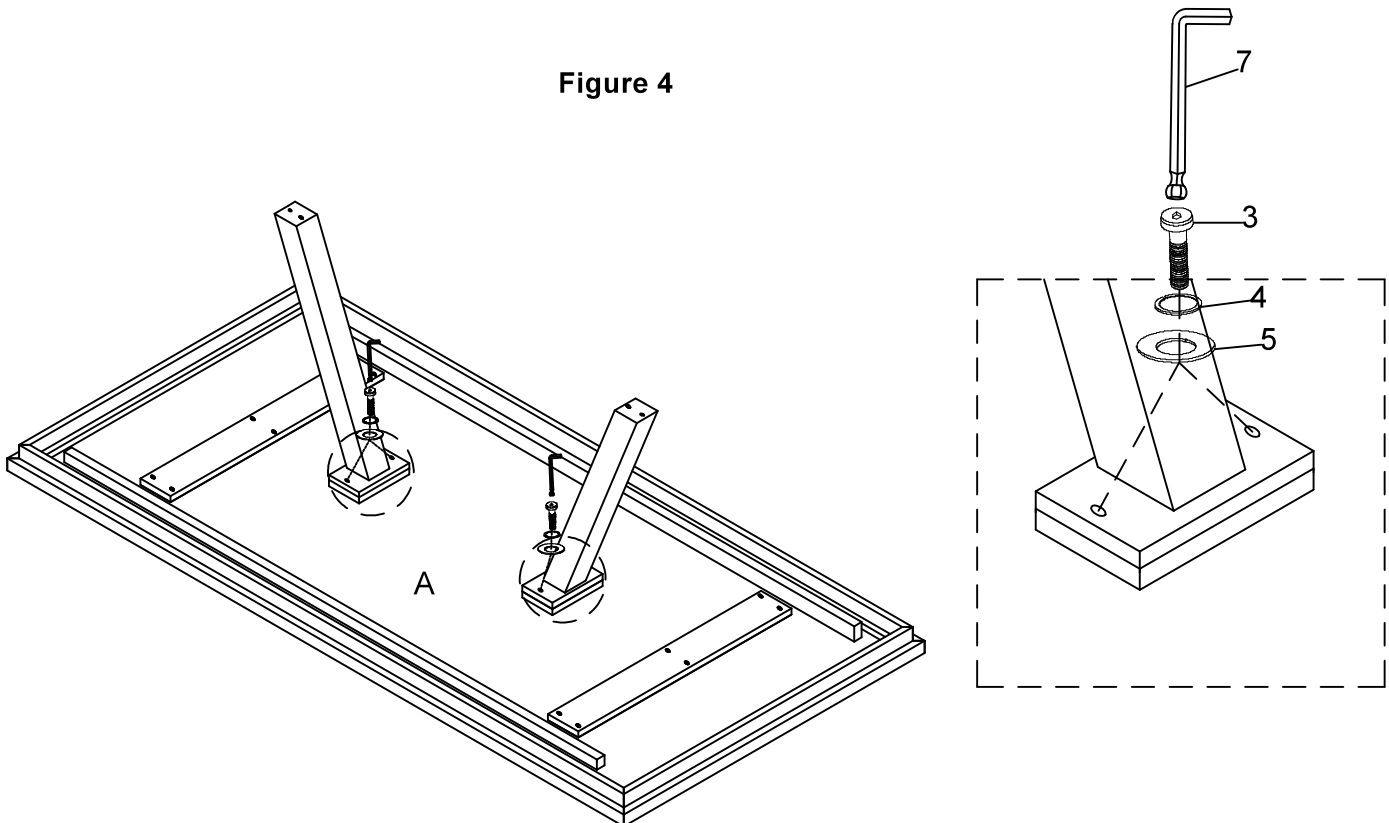

STEP 5

Stack the complete Table Base on to the Legs (B) with the help of another person. Attach Table Base to the Legs (B) with Long Bolts (1), Spring Washers (4) and Flat Washers (5) and tighten with by Hex Key (7). Attach Connecting Panels (D) to the Table Top (A) with Short Bolts (3), Spring Washers (4), and Flat Washers (5) and tighten with Hex Key (7).

(See Figure 5)

Figure 5

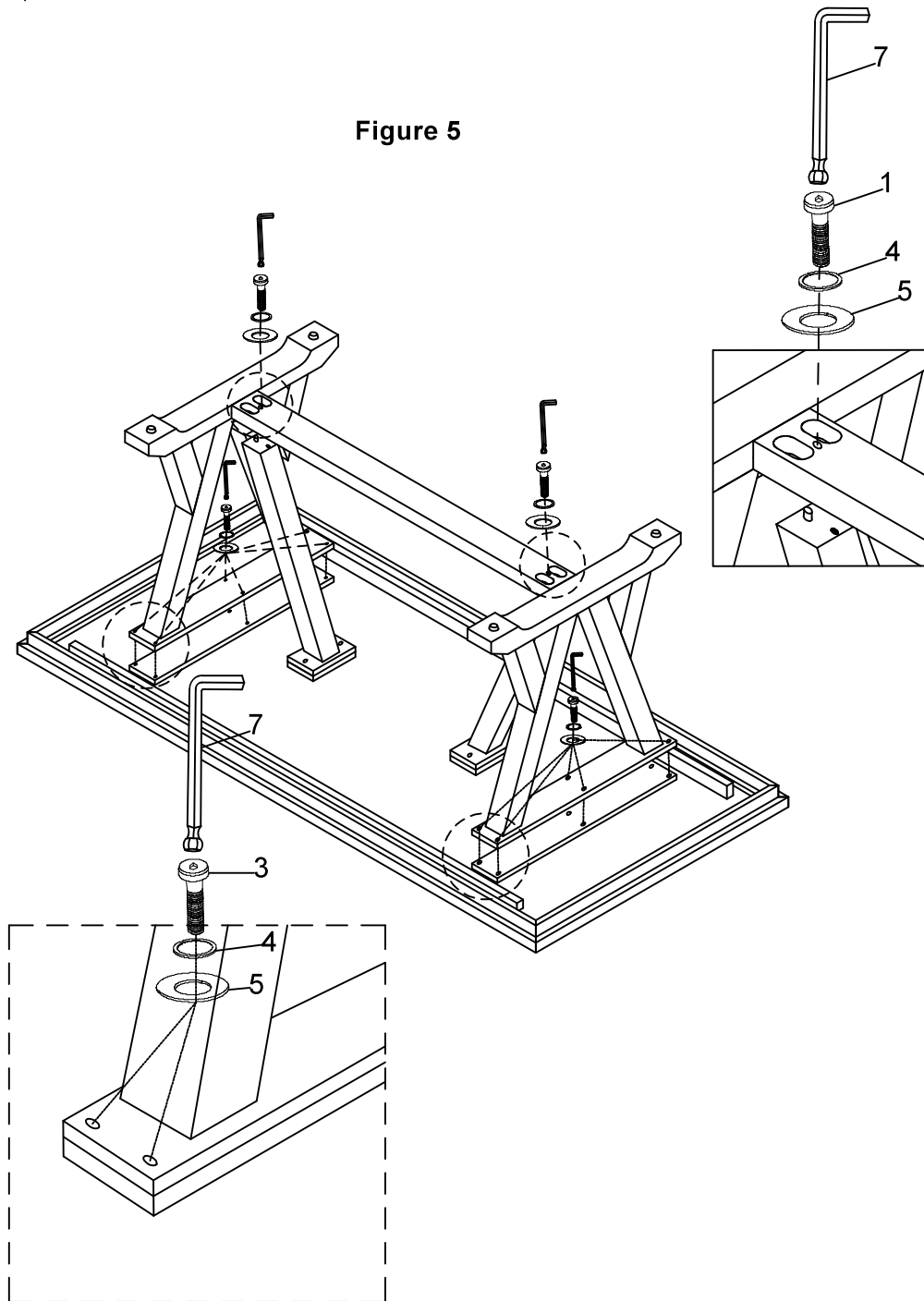

STEP 6

Adjust the levelers on the legs until the furniture is leveled. (See Figure 6)

Figure 6

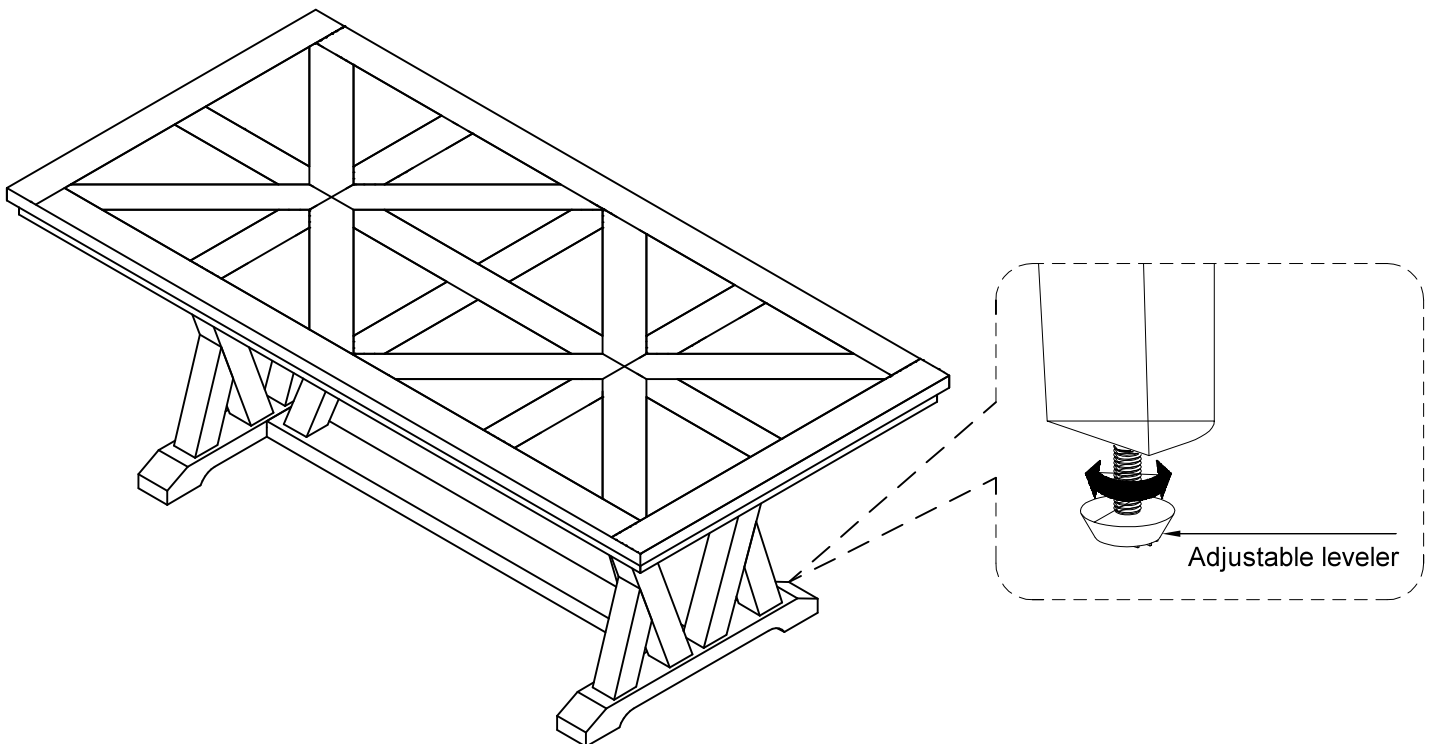

CARE INSTRUCTION

- To avoid scratches, do not place sharp or jagged objects directly on the table top.
- Do not place hot items directly on the tabletop.
- Use placements or trivets under hot items and coasters under beverages to prevent marks and stains.
- Avoid the use of harsh chemicals or abrasive cleaning materials.
- Wipe the table clean with a soft, dry cloth after each use.
- Wipe up spills quickly with a soft, dry cloth.

Flexsteel Industries, Inc.

For Parts or Customer Service, call toll-free: 1-888-415-3979

Monday-Friday 8:00-5:00 pm Central Time

Email: customersolutions@flexsteel.com

www.flexsteel.com