

# PINAR146SS

Hood Insert

**YALE**  
APPLIANCE



This model provides professional grade performance, while being discreetly mounted inside the cabinetry. It is available with a 1200 CFM blower for extraordinary ventilating power.

Plus the All-In-One design avoids the need purchase a stainless steel liner. Hidden metallic in/out knob controls operate the 4-speed blower and LED lighting. A cleaner kitchen is ensured by angled traditional baffle filters.

*\*Damp Location Approved.*

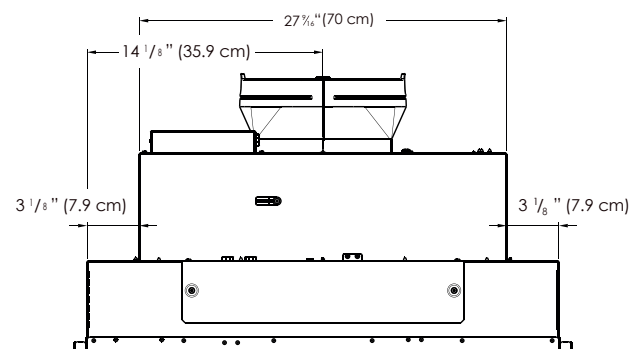
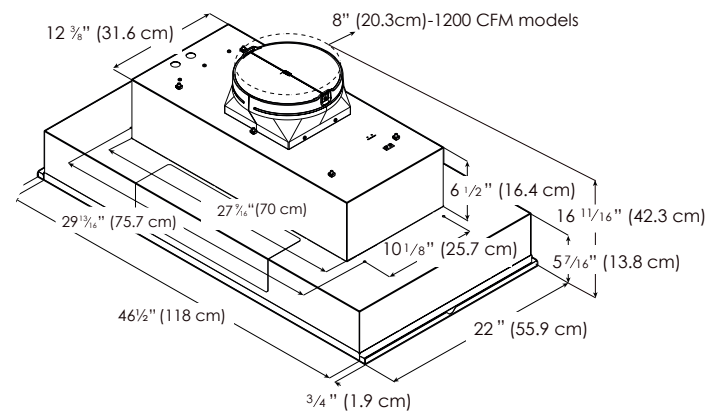

### SPECIFICATIONS

<b>Width:</b>	46" Unit
<b>Model:</b>	PINAR146SS
<b>Cut-Out Dimensions:</b>	46 1/2"W x 22"D
<b>Blower Type(internal):**</b>	1200 CFM(4-speed)
<b>Noise (sones):**</b>	2.5 - 8.5 Sones
<b>Finish:</b>	Stainless Steel
<b>Controls:</b>	Fully Retractable Rotating Knobs with White Backlighting
<b>Illumination: (Replaceable Lamps 1 Intensity)</b>	4 LED, 6.5 Watts 3000 KELVIN 540 LUMEN/Lamp
<b>Grease Filter:</b>	(3) Grease Collecting Stainless Steel Baffle
<b>Duct Transition:</b>	8" Round with Backdraft Damper (top only)
<b>Installation Type:</b>	Ducted or Recirculating with Kit
<b>Mounting Height Range:</b>	Electric ≥ 24", Gas ≥ 30"
<b>Electrical:</b>	120V - 60 Hz, 926 Watts
<b>ACCESSORIES:</b>	
<b>External Blower Shell Kit:</b>	ACC0179547 (8" or 10" duct size compatible, for use with 1200 cfm models)
<b>Inline Blower Shell Kit:</b>	ACC0179549(8" or 10" duct size compatible, for use with 1200 cfm models)
<b>RECIRCULATING KIT:</b>	
<b>Carbon Filters:</b>	ACC0192765 ( Contains 4 round carbon filters )
<b>Metal Deflector:</b>	ACC0192763 (8" round metal deflector for 1200 CFM models)
<b>Transition Reducer Kit:</b>	ACC0185271 (10" round down to 8" round - attaches to 10" round transition supplied w/ hood)
<b>WARRANTY:</b>	<b>Two (2) years parts &amp; in-home labor</b>

### FEATURES



Quiet system - Specialized technology that allows reducing sound levels of your hood, which can effectively decrease noise by more than 35%.



Grease Collecting Baffle Filters - Intended for high airflow cooking. Their "S" shape design and Stainless Steel finish is crafted to capture significant amounts of grease.



Thermal barrier - The system detects extreme temperatures above 158 degrees and automatically increases the blower speed to HIGH.



Fine precision - Constructed with great attention to detail with High-quality stainless steel, result in a seamless and flawless finish.



Superior performance - High performance ventilation with a 1200 CFM Blower.

### AIRFLOW CONTROL

Air Flow Control technology enables the user to reduce the maximum blower CFM of your hood achieving <300 CFMs, to meet local code requirements.

This model includes an Electronic Bypass Kit that needs to be placed at the moment of installing.