

# ASSEMBLY INSTRUCTIONS

Page 1/1

ah

## aspenhome®

Distributed by Furniture Values International, LLC



ITEM NO: I35-316 66" Credenza Desk

HARDWARE PACK			COMPONENTS LIST	
A	Bolt (Ø1/4"*2-1/2")	16 Pcs	Legs	8 Pcs
B	Lock Washer (Ø1/4")	16 Pcs		
C	Flat Washer (Ø1/4"*3/4")	16 Pcs		
D	Allen Wrench (4mm)	1 Pc		

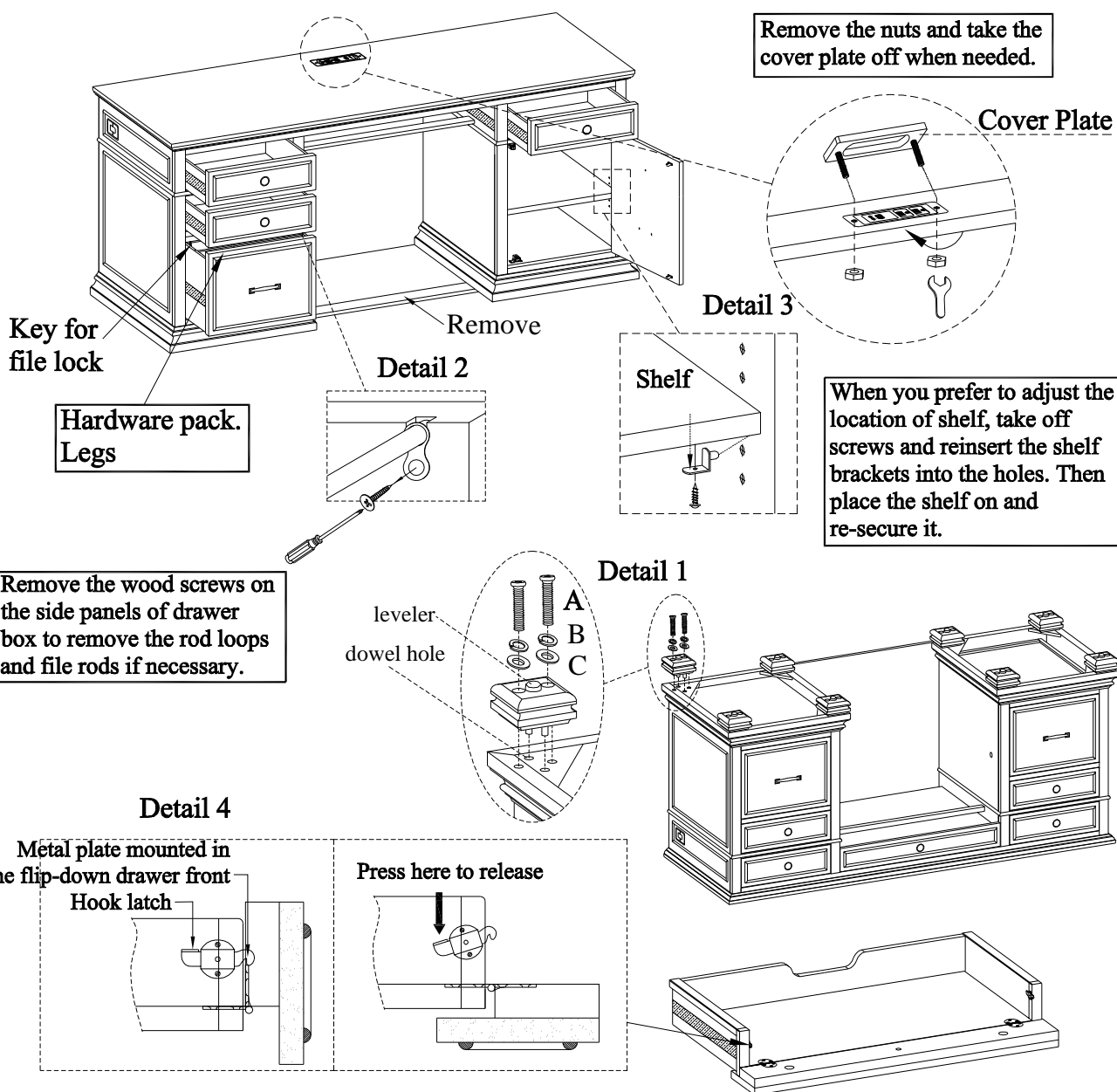

### ASSEMBLY STEP:

1. Put the desk upside down on a soft, clean surface.
2. Attach legs to the bottom of desk using bolts A, lock washer B and flat washer C. See detail 1.
3. Turn the desk to the upright position. Adjust the leveler when necessary

MADE IN VIETNAM

DATE: 2016-02-22

# ASSEMBLY INSTRUCTIONS

Page 1/2



## aspenhome®

Distributed by Furniture Values International, LLC

ITEM NO: I35-317 66" Credenza Hutch

### HARDWARE PACK FOR -317

- |   |   |               |       |
|---|---|---------------|-------|
| A |  | Metal Bracket | 2 PCS |
| B |  | Wood Screw    | 4 PCS |

### TOOLS REQUIRED (NOT PROVIDED)

PHILLIPS SCREWDRIVER

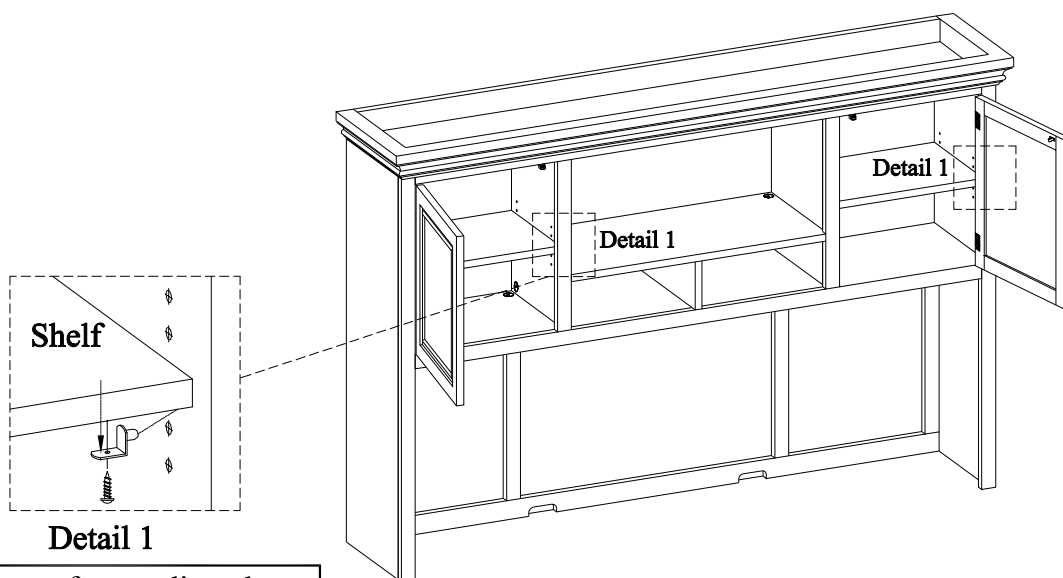

When you prefer to adjust the location of shelf, take off screws and reinsert the shelf brackets into the holes. Then place the shelf on and re-secure it.

### Detail 2

Take off one screw from each mounting plate and swing it to the proper location on the base before re-securing it with the screw.

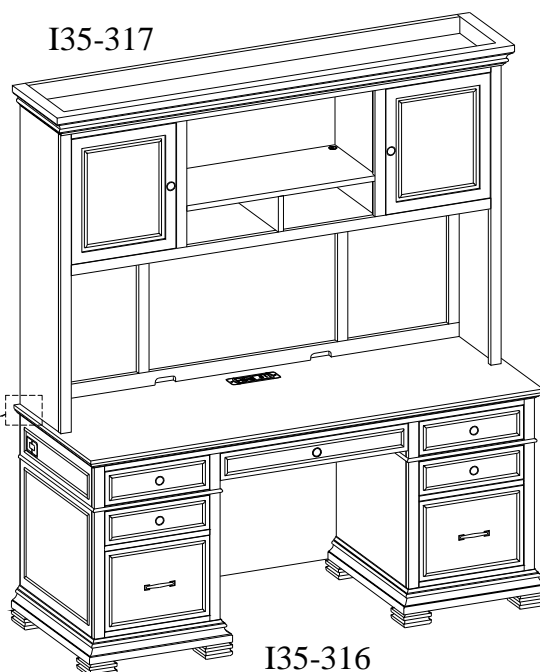
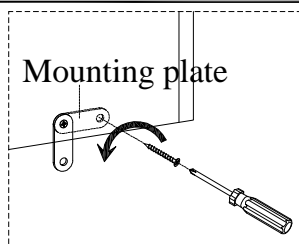

UNIT SHOULD BE INSTALLED BY 2 OR MORE PERSONS.

MADE IN VIETNAM

DATE: 2019-05-23

# ASSEMBLY INSTRUCTIONS

Page 2/2



## aspenhome®

Distributed by Furniture Values International, LLC

ITEM NO: I35-317 66" Credenza Hutch

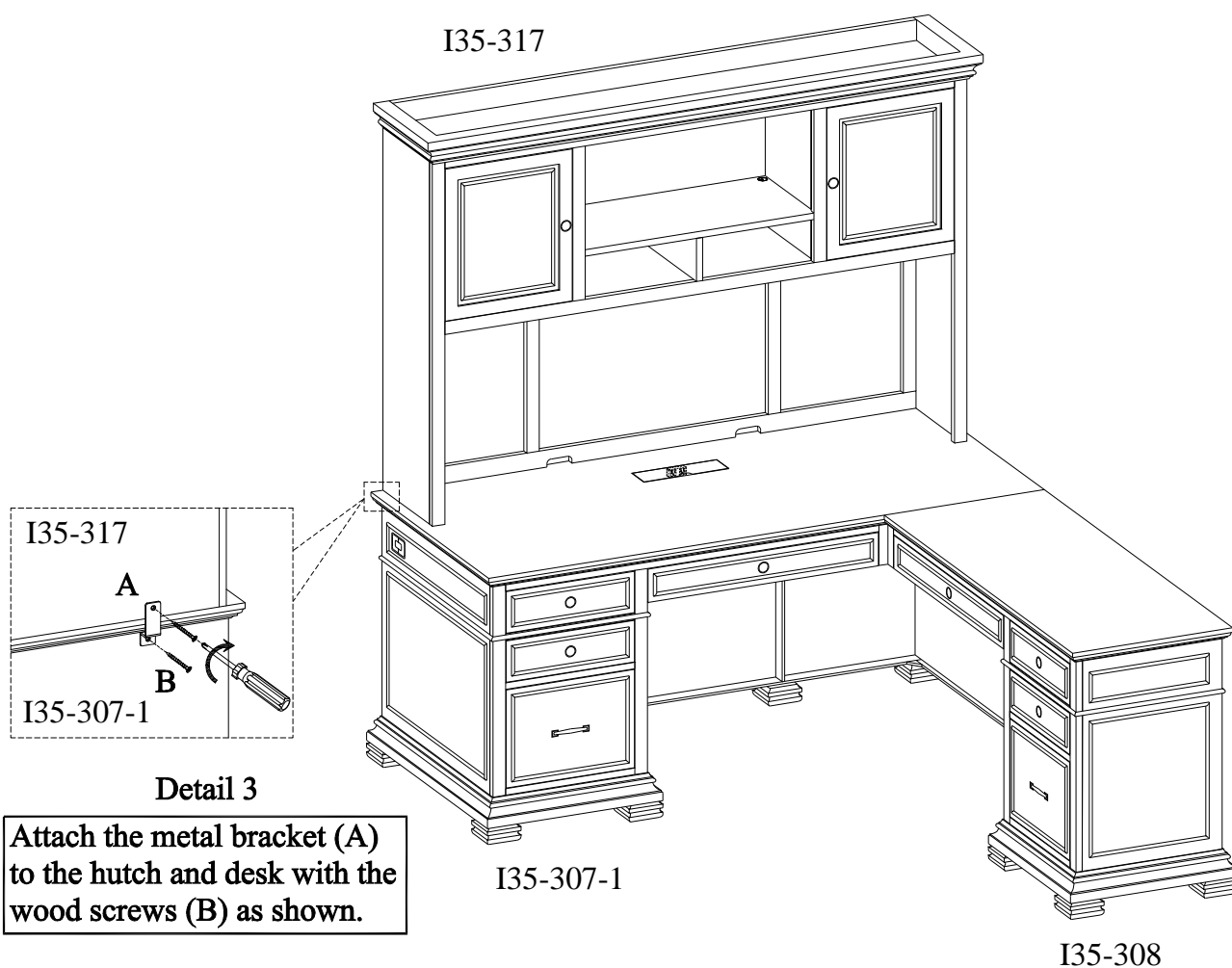

MADE IN VIETNAM

DATE: 2019-05-23