

# 36" Counter-Depth 3-Door Refrigerator

800 Series – Black Stainless Steel B21CT80SNB



**BOSCH**  
Invented for life



**B21CT80SNB**

Black Stainless Steel

Also available in:

Stainless Steel  
B21CT80SNS

**The Black Stainless Steel 3-Door Counter-Depth Refrigerator features extra-cold storage & humidity-controlled drawers to keep food fresh.**

## Features & Benefits

High quality black stainless steel helps guard against fingerprints and scratches.

A full-width Chiller Drawer provides extra-cold storage.

A retractable shelf allows you to easily store tall bottles and items.

Dual AirCool system provides even temperatures & minimal odor transfer.

Humidity controlled crisper drawers help keep food fresher longer.

## General Properties

Water filter	Yes
Lighting	LED
Defrost process refrigerator section	Frost-free
Number of shelves - refrigerator	5
Adjustable shelves - refrigerator	4 half-width
Shelf material - refrigerator	Tempered glass
Type of shelves - refrigerator	Tempered glass
Gallon storage bins	5
Humidity control drawer	2
Defrost process freezer section	Automatic
Number of drawers - freezer	1
Ice maker	Yes

## Capacity

Total unit gross capacity (cu. ft.) – AHAM	20.7
Refrigerator gross capacity (cu. ft.)	14.7
Freezer gross capacity (cu. ft.)	6.0

## Technical Details

Current (A)	15 A
Volts (V)	120 V
Frequency (Hz)	60 Hz
Power cord length (in.)	67
Plug type	120V-3 prong



## Dimensions & Weight

Appliance dimensions (H x W x D) (in.)	69 7/8" x 35 3/4" x 28 3/4"
Required cutout size (H x W x D) (in.)*	70" x 36" x 25"
Net weight (lbs)	294 lbs

## Efficiency

Energy consumption (kWh/yr)	623 kWh
-----------------------------	---------

## Accessories—Included

Included	2 Egg trays, Ice storage bin, Ice scoop, Toe kick trim cover, 1 Water filter
----------	--

\* Add 63/64" (2.5 cm) to the height dimension when leveling legs are fully extended

## Accessories—Optional

**BORPLFTR10**  
Replacement water filter  
(P/N 00740570)



**Accessories:** To purchase Bosch accessories, cleaners & parts please visit [www.bosch-home.com/us/store](http://www.bosch-home.com/us/store) or call 1-800-944-2904 (Mon to Fri 5 am to 6 pm PST, Sat 6 am to 3 pm PST).

**Notes:** All height, width and depth dimensions are shown in inches. BSH reserves the absolute and unrestricted right to change product materials and specifications, at any time, without notice. Consult the product's installation instructions for final dimensional data and other details prior to making cutout.

**Warranties:** Please see Use & Care manual or Bosch website for statement of limited warranty.

**For more information on our entire line of products, go to [www.bosch-home.com/us](http://www.bosch-home.com/us) or call 1-800-944-2904**

© BSH Home Appliances Corporation. All rights reserved. Bosch is a registered trademark of Robert Bosch GmbH.

# 36" Counter-Depth 3-Door Refrigerator

800 Series – Black Stainless Steel B21CT80SNB



**BOSCH**  
Invented for life

## Installation Details

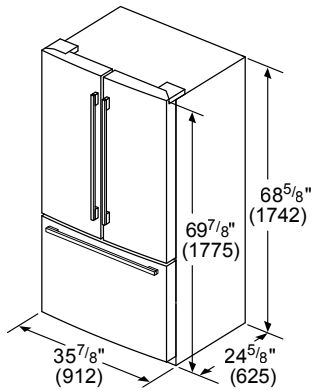

measurements in inches (mm)

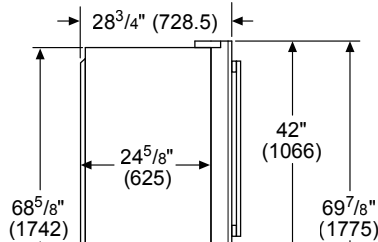

measurements in inches (mm)

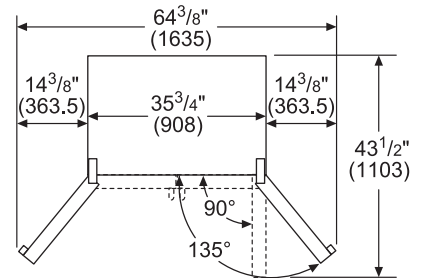

Drawers can be pulled out with door open 90°. Drawers can be taken out with door completely opened.

measurements in inches (mm)

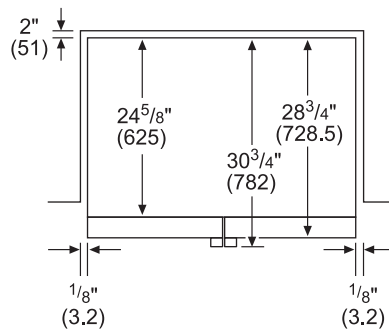

measurements in inches (mm)

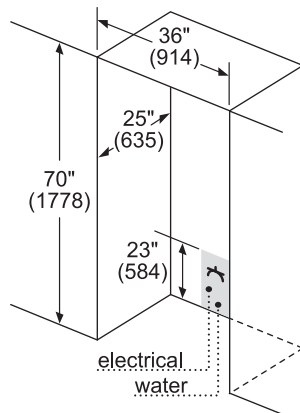

Leave 1/2" (12.7 mm) gap at the top and 2" (51 mm) behind the refrigerator for proper ventilation.  
For installation next to a wall, leave 3 3/4" (95.2 mm) minimum on wall side for opening the door.  
It is recommended that you do not install the refrigerator near a heat source such as an oven or a range.  
Maximum receptacle and water line height 23" (584 mm).

measurements in inches (mm)

**Accessories:** To purchase Bosch accessories, cleaners & parts please visit [www.bosch-home.com/us/store](http://www.bosch-home.com/us/store) or call 1-800-944-2904 (Mon to Fri 5 am to 6 pm PST, Sat 6 am to 3 pm PST).

**Notes:** All height, width and depth dimensions are shown in inches. BSH reserves the absolute and unrestricted right to change product materials and specifications, at any time, without notice. Consult the product's installation instructions for final dimensional data and other details prior to making cutout.

**Warranties:** Please see Use & Care manual or Bosch website for statement of limited warranty.

**For more information on our entire line of products, go to [www.bosch-home.com/us](http://www.bosch-home.com/us) or call 1-800-944-2904**

© BSH Home Appliances Corporation. All rights reserved. Bosch is a registered trademark of Robert Bosch GmbH.