

GENEVA STORAGE BED

FULL / QUEEN SIZE

ASSEMBLY INSTRUCTIONS

PARTS AND FITTING PACKAGING DETAIL

BOX #1

- P1. HEADBOARD 1 PC
P2. WOODEN LEG 2 PCS

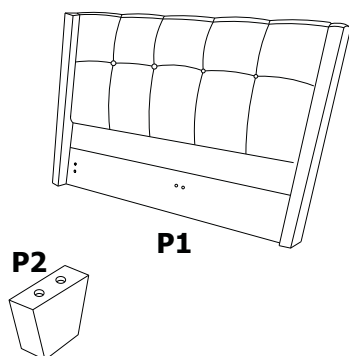

BOX #2

- P3. FOOTBOARD 1 PC
P4. SIDE RAIL 2 PCS
P5. METAL SUPPORT BRACE 1 PC
P6. CENTER SLAT SUPPORT 1 PC
P7. SLAT 26 PCS
P8. WOODEN LEG 2 PCS
P9. SIDE RAIL SLAT CLIP 26 PCS
P10. CENTER SUPPORT SLAT CLIP 13 PCS
P11. CENTER SUPPORT LEG 2 PCS
P12. METAL SUPPORT LEG 1 PC

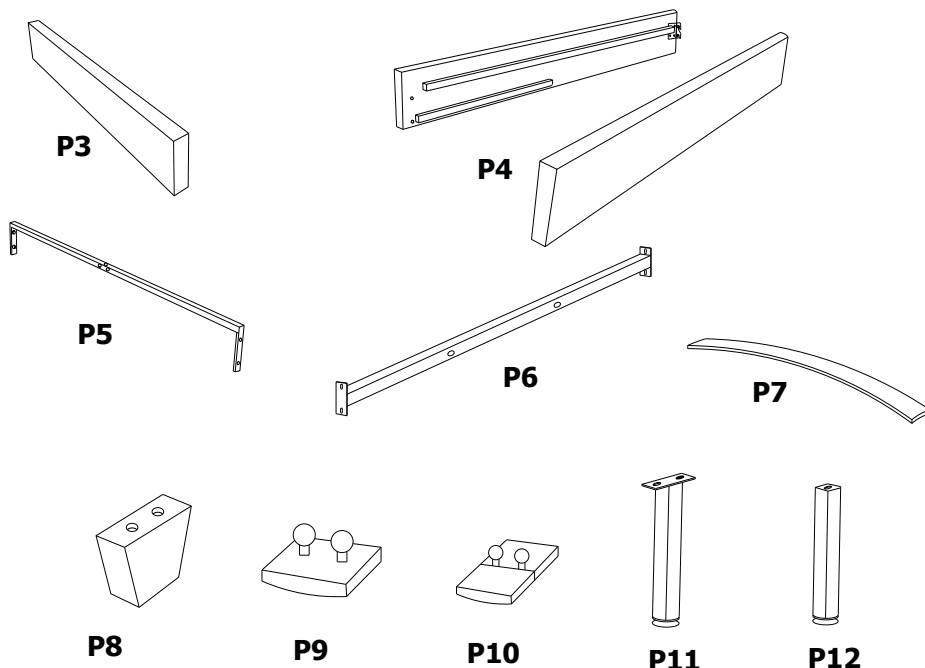

BOX #3

- P13. DRAWER BOX 2 PCS

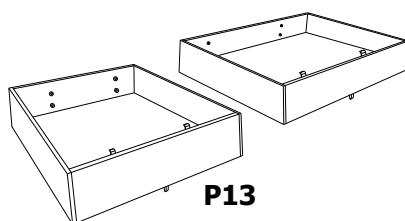

GENEVA STORAGE BED ASSEMBLED

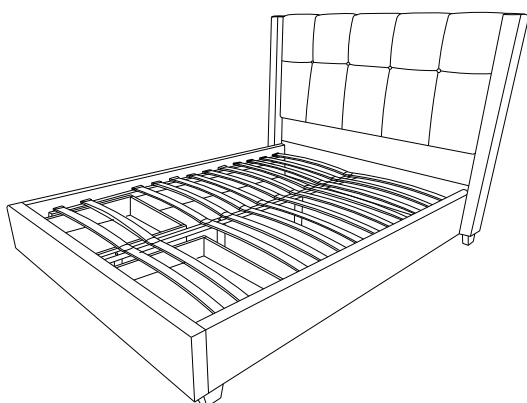

HARDWARE* PACKED IN BOX #1

A1	ALLEN KEY 5/16"	1 PC	A2	BOLT 5/16"*3.25"	4 PCS	A3	FLAT WASHER	4 PCS	A4	LOCK WASHER	4 PCS

HARDWARE* PACKED IN BOX #2

B1	ALLEN KEY 5/16"	1 PC	B2	SPANNER 5/16"	1 PC	B3	BOLT 5/16"*1"	6 PCS	B4	BOLT 5/16"*2.5"	7 PCS
B5	BOLT 5/16"*3.25"	2 PCS	B6	FLAT WASHER	21 PCS	B7	LOCK WASHER	21 PCS	B8	NUT 5/16"	6 PCS

HARDWARE* PACKED IN BOX #3

C1	ALLEN KEY 1/4"	1 PC	C2	BOLT 1/4"*1.25"	8 PCS	C3	FLAT WASHER	8 PCS	C4	LOCK WASHER	8 PCS

STEP 1:

REMOVE WOODEN LEGS (P2) FROM BACK OF HEADBOARD. ATTACH TO BOTTOM OF HEADBOARD (P1) FOLLOWING ILLUSTRATION.

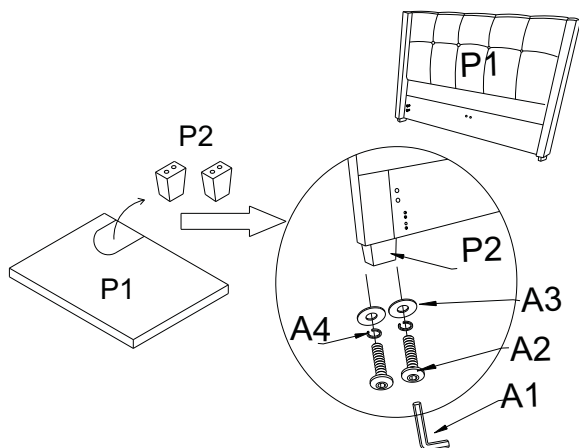
**STEP 2:**

ATTACH WOODEN LEGS (P8) TO THE BOTTOM OF THE SIDE RAILS (P4) FOLLOWING ILLUSTRATION.

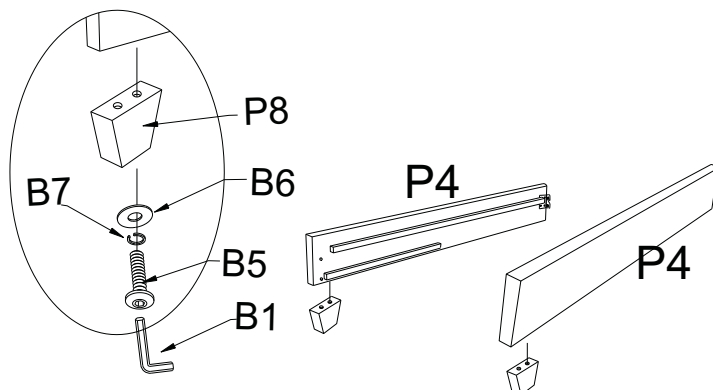
**STEP 3 :**

LOOSEN THE PREATTACHED BOLTS ON THE HEADBOARD AND CONNECT THE SIDE RAILS. TIGHTEN THE BOLTS WITH ALLEN KEY (B1).

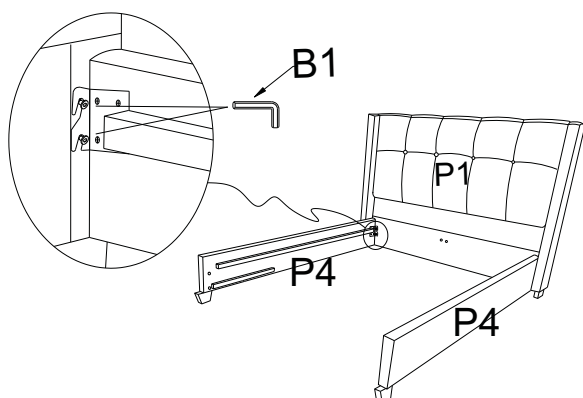
**STEP 4 :**

ATTACH METAL SUPPORT BRACE (P5) TO THE SIDE RAILS FOLLOWING ILLUSTRATION. TIGHTEN WITH ALLEN KEY.

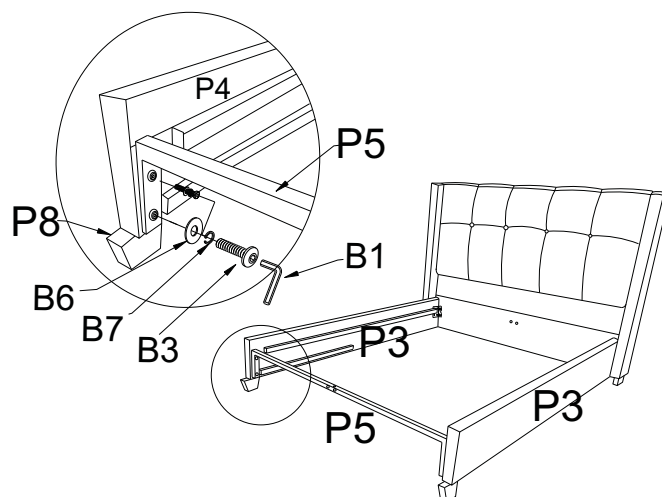
**STEP 5 :**

CONNECT CENTER SLAT SUPPORTS (P6) TO HEADBOARD AND METAL SUPPORT BRACE FOLLOWING ILLUSTRATION.

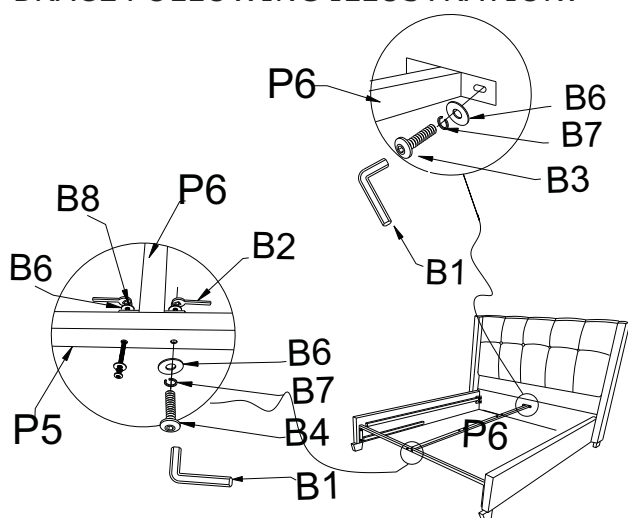
**STEP 6 :**

FOLLOWING ILLUSTRATION. ATTACH CENTER SUPPORT LEGS (P11) TO CENTER SLAT SUPPORT. ATTACH METAL SUPPORT LEG (P12) TO METAL SUPPORT BRACE.

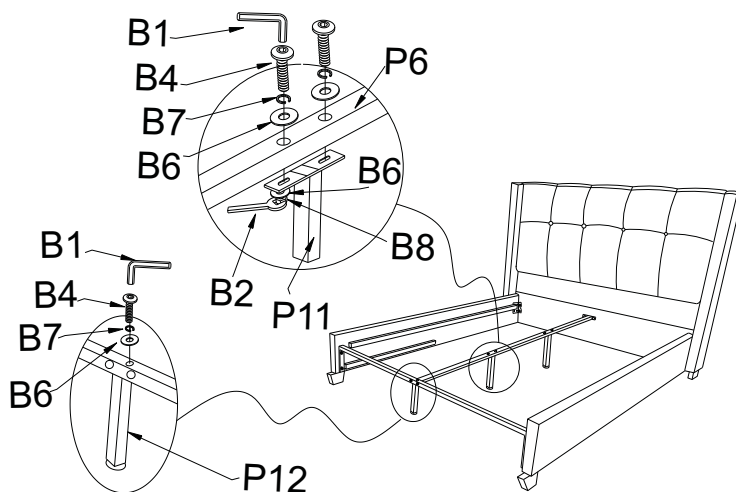

STEP 7 :

ATTACH SIDE RAIL SLAT CLIPS (P9) TO SIDE RAIL. INSERT SLATS (P7) INTO SIDE RAIL CLIPS THEN CONNECT THE SLAT SECTIONS WITH CENTER SUPPORT SLAT CLIPS (P10).

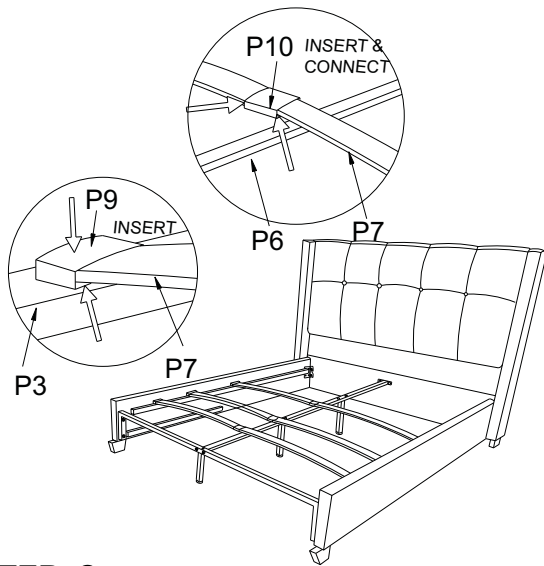
**STEP 9 :**

ATTACH DRAWER BOXES (P13) TO FOOTBOARD (P3) FOLLOWING THE ILLUSTRATION. TIGHTEN WITH ALLEN KEY (C1).

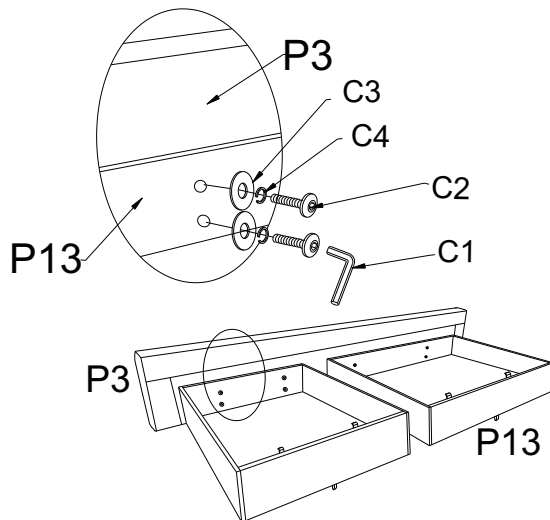
**STEP 8 :**

ATTACH CENTER SUPPORT CLIPS, WITH SLATS INSERTED, INTO CENTER SLAT SUPPORTS.

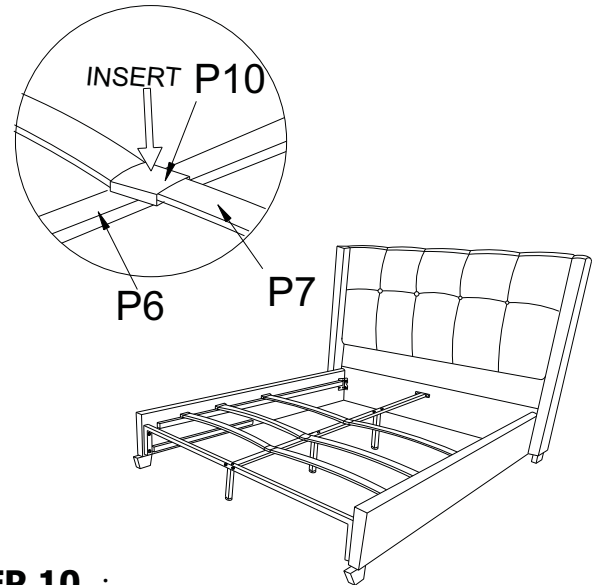
**STEP 10 :**

INSERT ASSEMBLED STORAGE DRAWER INTO FOOT OF BED.

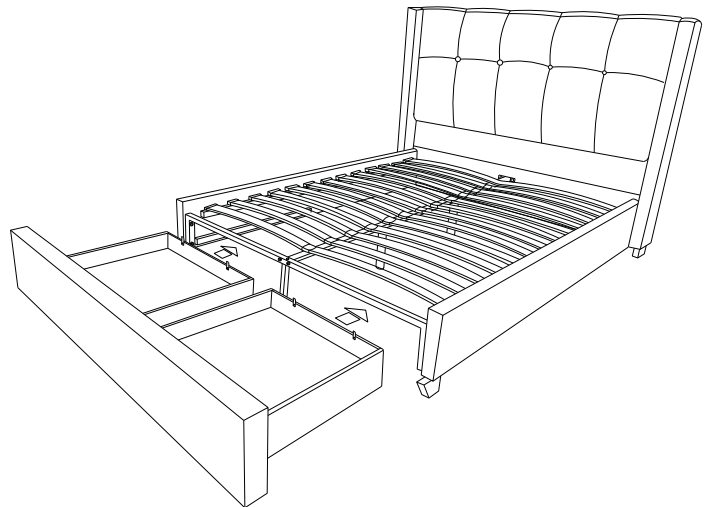
**INSTRUCTIONS FOR ADJUSTING LEVELERS :**

POSITION THE BED IN YOUR ROOM. LOCATE LEVELERS UNDER EACH SUPPORT LEG (P11/P12).

TURN COUNTER-CLOCKWISE TO EXTEND, CLOCKWISE TO CONTRACT.

ADJUST LEVELERS UNTIL EACH LEG SUPPORT IS APPLYING EQUAL UPWARD PRESSURE ON THE CENTER SLAT.

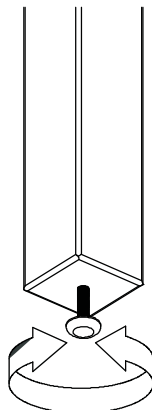
**MAINTENANCE INSTRUCTIONS :**

- REMOVE BOX SPRING AND MATTRESS BEFORE MOVING YOUR BED.
- LIFT YOUR BED WHEN MOVING IT. DRAGGING CAN DAMAGE CENTER SUPPORT.
- READJUST LEVELERS AFTER MOVING YOUR BED.