

ASSEMBLY INSTRUCTIONS

Read this instruction carefully. Refer hardware and furniture parts list for guidance. Be sure all parts are complete, before assembling. Place all wooden furniture part on a clean and flat soft surface to prevent scratcheds. Refer steps provided as assembling guide.

CAUTIONS :

- 1.Do not **FULLY-TIGHTEN** the nuts or nut bolts until all are in place.
- 2.To prevent thread damage.Ensure that nuts or nut bolts are not over-tighten.
- 3.Hardware are to be kept out of reach from children.

PART LIST			HARDWARE LIST		
ITEM	DESCRIPTION	QTY	ITEM	DESCRIPTION	QTY
A	NIGHT STAND	1 PC	1	JCBC SCREW M6 x 20MM (BLK)	8 PCS
B	METAL LEG	2 PCS	2	PAN HEAD SCREW M4 x 38MM	6 PCS
C	METAL LEG SUPPORT	2 PCS	3	PAN HEAD SCREW M4 x 12MM	8 PCS
			4	M4 ALLEN KEY (BALL SHAPE) LONG	1 PC

STEP 1

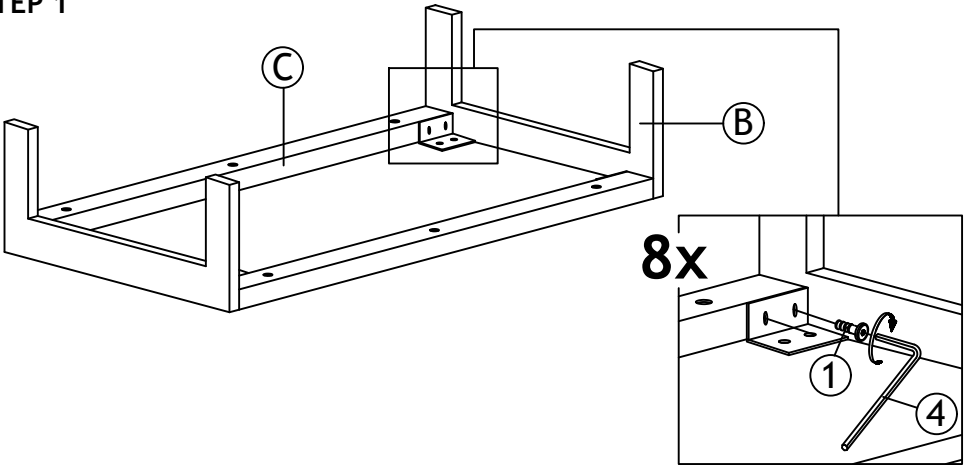

STEP 2

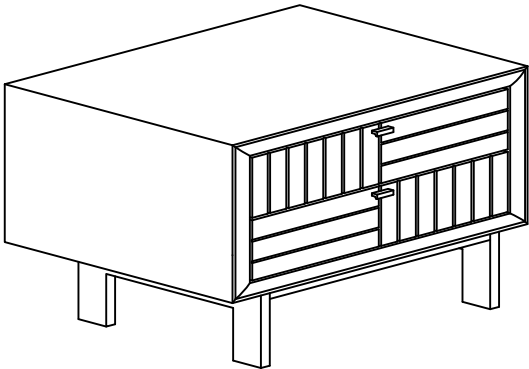
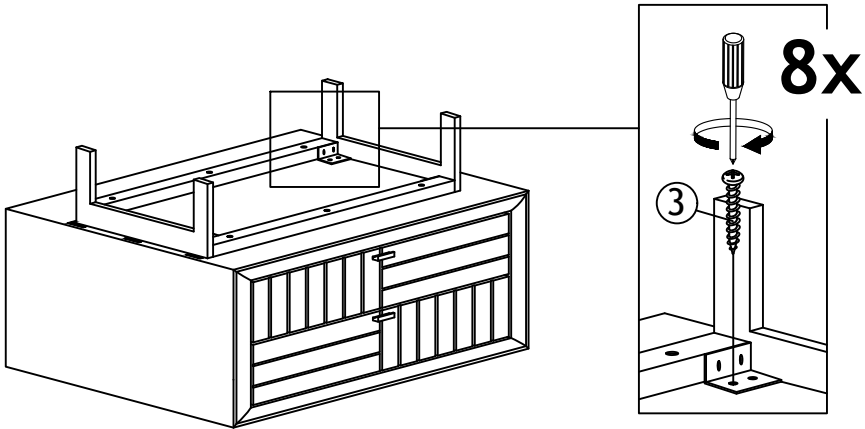
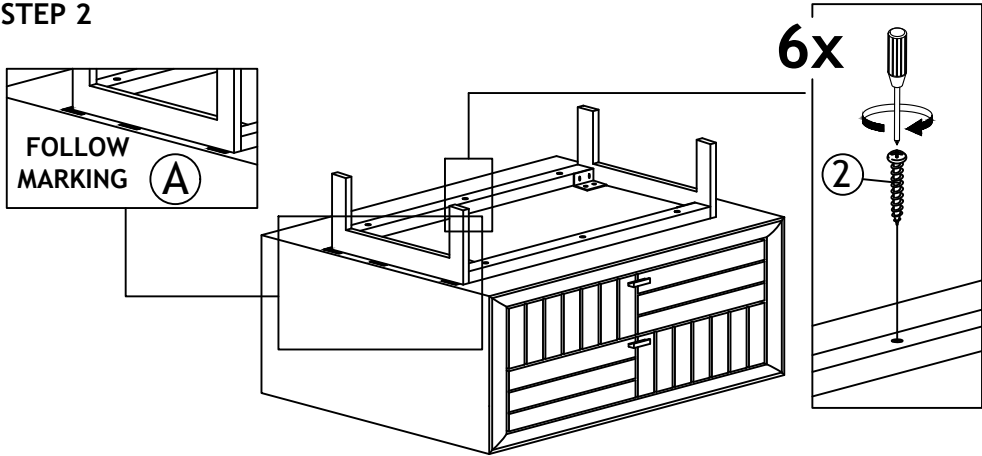

ASSEMBLY COMPLETED