



Parker House
FURNITURE

Assembly Instruction

Item No: CAT#450

Description : OUTSIDE CORNER BOOKCASE

Rev 2 :2021-11-11

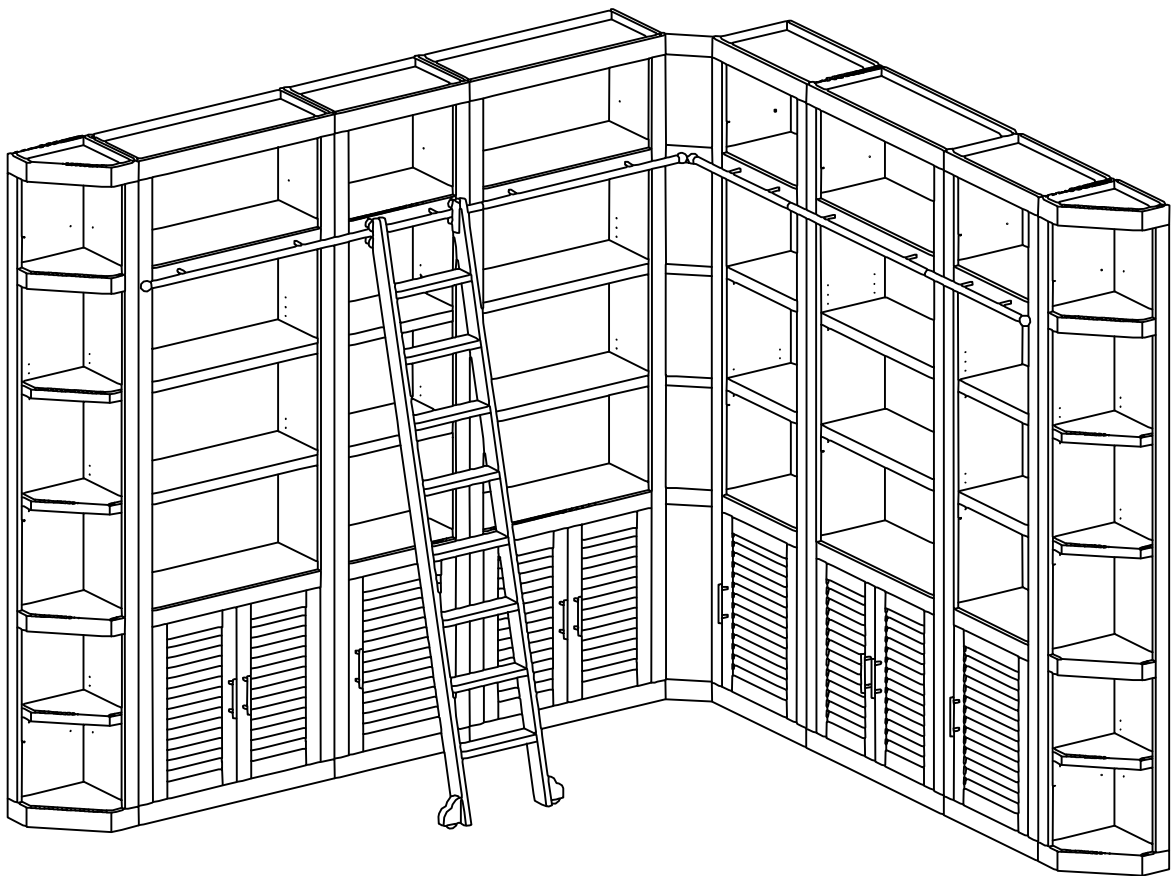



Parker House
FURNITURE

Assembly Instruction

Item No: CAT#450

Description : OUTSIDE CORNER BOOKCASE

Rev 2 :2021-11-11

HARDWARE LIST

No	Description	Sketch	Q'TY
A	Allen wrench 4mm		1PC
B	Bolt Ø 1/4"x1" (Ø15mm)		6PCS
C	Screw cap Ø 1/4" x5/8" Ø15mm		6PCS
D	Allen wrench 4mm		1PC

Hardware pack
is screwed here

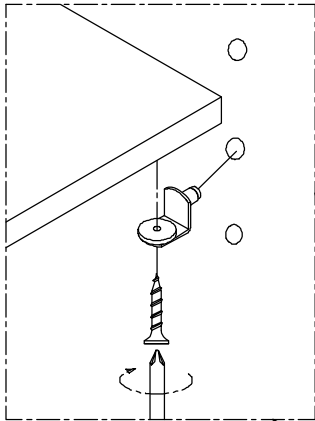

To adjust the shelf height,
remove the four screws under
each shelf pin. once removed,
place shelf pins at desired
height and re-screw shelf pins.

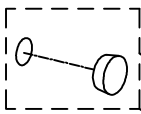

Remove the wood
plugs before connecting
the cabinets together.

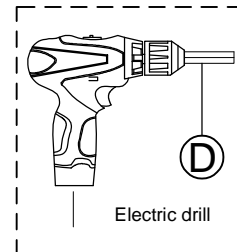
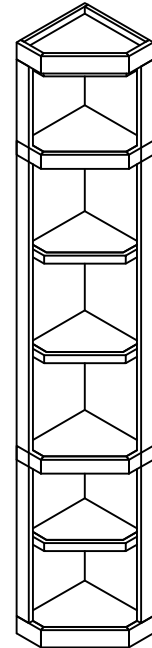
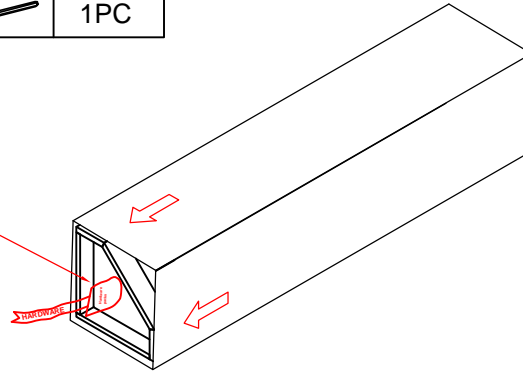
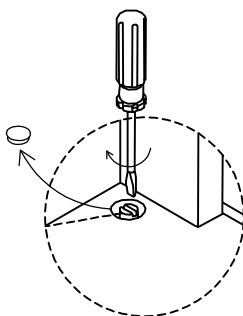

Electric drill

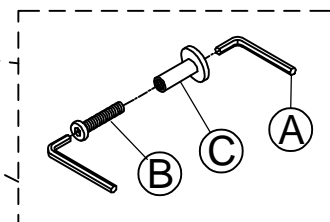

Align and connect cabinets with
Connector Bolt (B) and
Connector Cap (C).