

**DENON<sup>®</sup>**

**AH-C160W**

Operation / Battery charging temperature range: 5 °C – 40 °C  
Temperaturbereich für Betrieb/Akkuladevorgang: 5 °C – 40 °C  
Plage de température de fonctionnement/pour le chargement de la batterie : 5 °C – 40 °C  
Gamma di temperature di esercizio/di carica della batteria: da 5 °C a 40 °C  
Intervalo de temperatura de funcionamiento/carga de la pila: 5 °C – 40 °C  
Temperatuurbereik bediening / batterij opladen: 5 °C – 40 °C  
Vid bruk / Temperaturintervall för batteriladdning: 5 °C – 40 °C  
Диапазон рабочих температур/температур зарядки батареи: 5 °C – 40 °C  
Zakres temperatur pracy / ładowania akumulatora: 5 °C – 40 °C  
工作/電池充電溫度範圍：5°C - 40°C  
工作/電池充電溫度範圍：5°C - 40°C  
動作 / バッテリー充電温度範囲：5°C～40°C

1

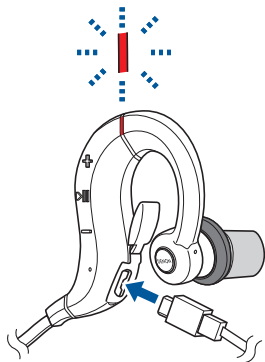

2

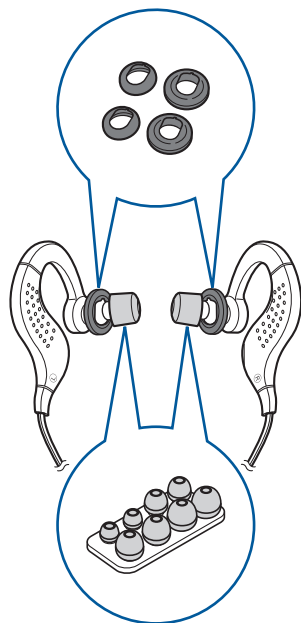
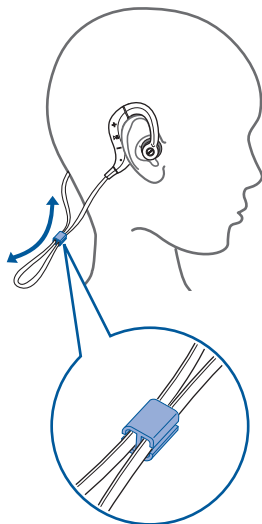
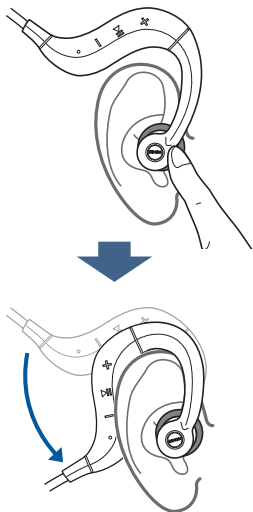

3

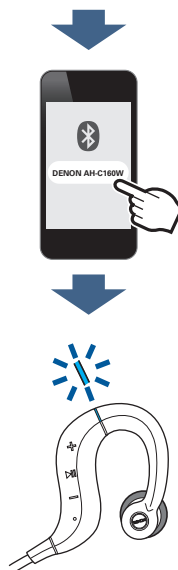
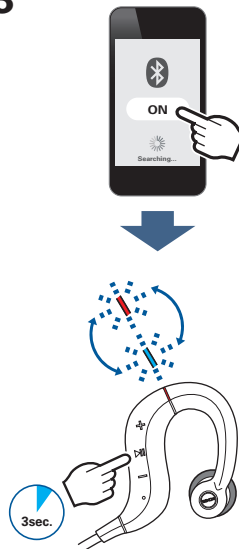

4

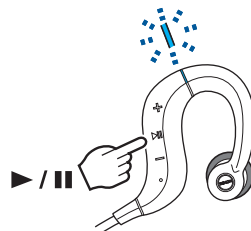

## 1. Charging

Charge the headphones using the supplied dedicated charging cable before use.  
The charging status can be checked from the status indicator LED on the headphones.

- Charging: Lights red
- Charging completed: Lights green

It will take approx. 2 hours from empty to full charge.

AH-C160W can be used for approximately 4 hours when the battery is fully charged.

## 2. Wearing

1. Insert the ear tip of the “L” of the headphones into the left ear, and the ear tip of the “R” into the right ear.
2. Lift the hook parts of the headphones over the ears and then hook them behind the ears as shown in the figure.

## 3. Pairing with Bluetooth device

Register (Pairing) a Bluetooth device to the headphones.

1. Activate Bluetooth function of the Bluetooth device to be connected.
2. With the headphone's power is off, press and hold the control button for approx. 3 seconds.  
The status indicator LED lights purple for approximately 1 second and then flashes red and blue alternately indicating that the headphones are in pairing registration mode.
3. Select the “DENON AH-C160W” appears on the Bluetooth device to be connected.  
When a connection is established, the status indicator LED on the headphones lights blue for approximately 5 seconds.



If you are requested to enter a PIN code (pass key), enter “0000” (four zeros).

## 4. Playback music

Playback operations can be performed from both the Bluetooth device and headphones. Here we will explain the operations using the control buttons on the headphones.

<b>Play/Pause</b>	Press the control button once.	<b>Increase volume</b>	Press the volume “+” button.
<b>Next track</b>	Press and hold the volume “+” button for approximately 1 second.	<b>Decrease volume</b>	Press the volume “-” button.
<b>Previous track</b>	Press and hold the volume “-” button for approximately 1 second.		

When the remaining power of the rechargeable battery is running low, the status indicator LED flashes red at approximately 3-second intervals together with a beeping sound.

Charge the headphones using the supplied dedicated charging cable.

### NOTE

To prevent the consumption of battery power, press and hold the control button for approximately 3 seconds after use to turn off the power of the headphones.

### Web Manual

Refer to the web manual for other functions information and operation procedure details, such as remaining battery indication, audio guidance, and so on.

Enter the following URL into your web browser:

[manuals.denon.com/AHC160W/ALL/EN/](https://manuals.denon.com/AHC160W/ALL/EN/)



DENON®

[www.denon.com](http://www.denon.com)

Printed in China 5411 11467 00AD  
Copyright © 2016 D&M Holdings Inc. All Rights Reserved.