

ID-36RP



FEATURES

- Air purification system fights spoilage, odors
- Crispers and deli drawers in low-temp, high-humidity zones for optimum freshness
- Every Sub-Zero integrated refrigerator or freezer comes ready to be fitted with custom panels and handles for seamless installation with surrounding cabinetry
- Smart-touch controls for streamlined access to more settings
- Soft-close doors and drawers
- Soft-on LED lights for varying degrees of brightness
- Rigorously tested in our U.S. manufacturing facilities to ensure at least 20 years of heavy use
- Exceptional 24/7 support from our Customer Care team based in Madison, Wisconsin and just footsteps from our factory

ACCESSORIES

- Crisper cover
- Dual installation kits
- Dozen egg container
- Stainless steel front panels with tubular or pro handles
- Stainless steel kickplate
- Stainless steel pro handles
- Stainless steel tubular handles
- Replacement air purification cartridge
- accessories-are-available-through-an-authorized-sz-dealer

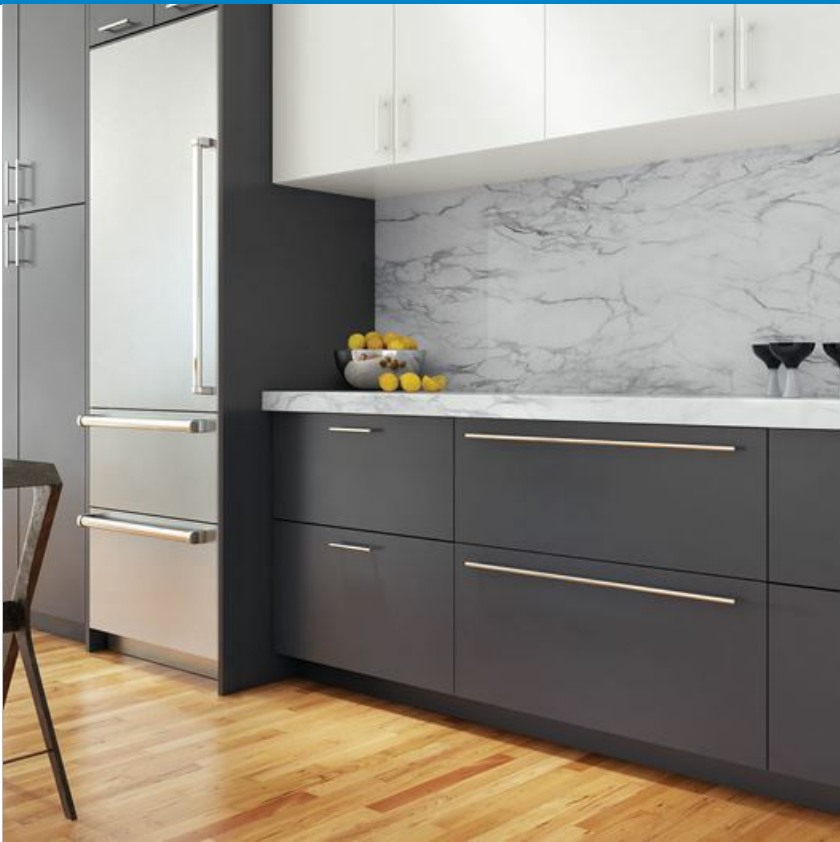

HANDLE ACCESSORIES

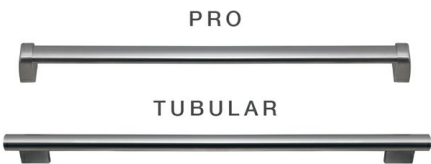

PRODUCT-DETAILS

REFRIGERATOR

- Adjustable drawer dividers
- 1 Sliding Crisper Cover

PRODUCT-SPECIFICATIONS

model	ID-36RP
dimensions	36"W x 34 1/2"H x 24"D
drawer-clearance	18 3/8"
weight	250 lb
refrigerator-capacity	6.6 cu ft
electrical-supply	115 VAC, 60 Hz
electrical-service	15 amp dedicated circuit

ELECTRICAL

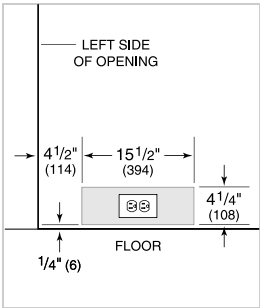

PANEL-SPECIFICATIONS

For complete panels specifications including width/height, weight requirements and thickness requirements visit subzero-wolf.com/integratedconfigurator.

INTERIOR-VIEW

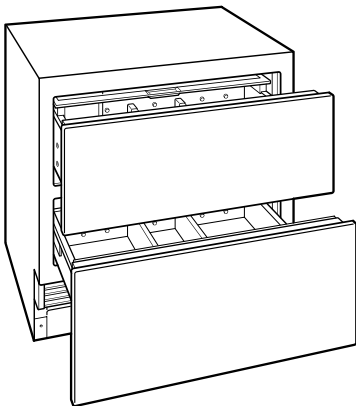

this-illustration-is-intended-for-interior-reference-only-not-represent-the-exterior

DIMENSIONS

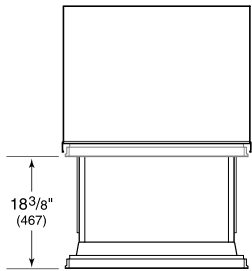
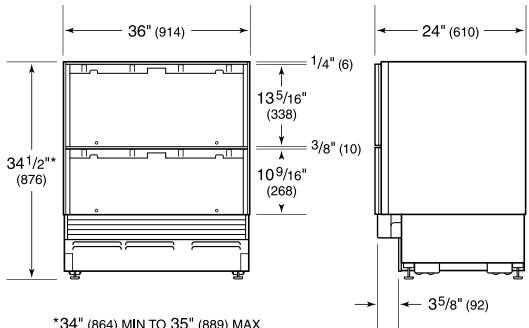

STANDARD INSTALLATION

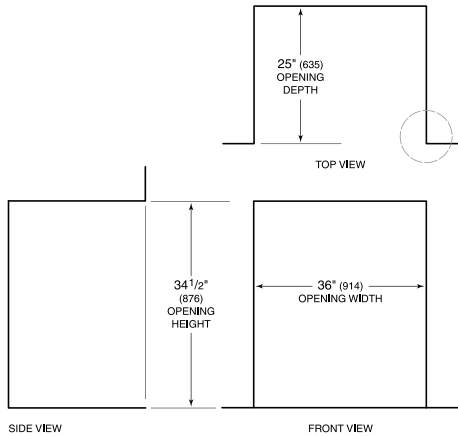

NOTE: 3 1/2" (89) finished returns will be visible and should be finished to match cabinetry.

