



24" Marvel Outdoor Refrigerated Drawers

Model # MO24RDS3NS



Premium Features

- Dynamic Cooling Technology™ rapidly cools and delivers the industry's most even temperature stability
- Marvel Prime™ controls for precise, frost-free temperature management between 34° and 42° F
- Audible alarms for door ajar and high/low temperature ensure your contents stay at optimal temperature
- Thermal-efficient insulated cabinet ensures optimum energy efficiency and cooling performance
- Drawer interior durably constructed from stainless steel, the most hygienic, easy-to-clean and stain-resistant of materials
- Drawer lock provides added security
- Efficient white LED lighting
- Close Door Assist System™ gently finishes closing the drawer
- Corrosion-resistant stainless steel exterior, sturdy pro-style handles and rugged 4" adjustable flat toe grill
- Height adjustment up to 1" with leveling legs
- 1-year warranty

Storage Capacity

Top Drawer:

Up to 73 12-oz cans

Bottom Drawer:

Up to 60 12-oz cans

Up to 133 12-oz cans in total

5.0 cu. ft.

Product Dimensions

23 7/8" W x 33 3/4" minimum H x 26 7/32" D (including handle)



Ordering Details*

Solid Stainless With Lock

Model Number

MO24RDS3NS

The Essential Elements of Outdoor Living



Certified for performance to withstand the elements

Tested to 115° F



Dynamic Cooling Technology™

Rapidly cools and delivers the industry's best temperature stability



Corrosion-resistant stainless steel exterior, sturdy pro-style handle and rugged toe kicks



Energy-efficient appliances with precise temperature management

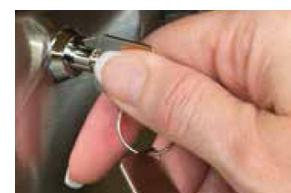

Security locks standard on all refrigerators and dispensers

Specifications

Width	23 7/8"
Interior Finish	Stainless Steel
Capacity	Up to 133 12-oz cans
Shelving System	N/A
Shelf Fronts	N/A
Other Storage	N/A
Interior Lighting	1 LED pod per drawer
Handle	Professional
Temperature Range	34° - 42° F
Lock	Yes
Length of Power Cord	5'
Product Dimensions without Door	23 7/8" W x 33 3/4" H x 21 1/2" D
Depth to Front of Door	23 23/32"
Depth to Handle	26 7/32"
Depth with drawer fully extended	41 21/32"
Shipping Weight	160 lbs

24" Rough-In Dimensions

"A"	"B"	"C"
24" (61 cm)	34" to 35" (86.4 cm to 88.9 cm)	24" (61 cm)

Cabinet Dimensions

"D"	"E"	"F"
23 7/8" (60.6 cm)	33 3/4" to 34 3/4" (85.7 to 88.3 cm)	23 23/32" (60.2 cm)

"G"	"H"
26 7/32" (66.6 cm)	39 5/32" (99.5 cm)

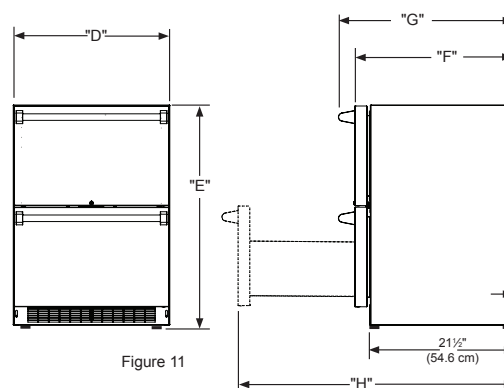
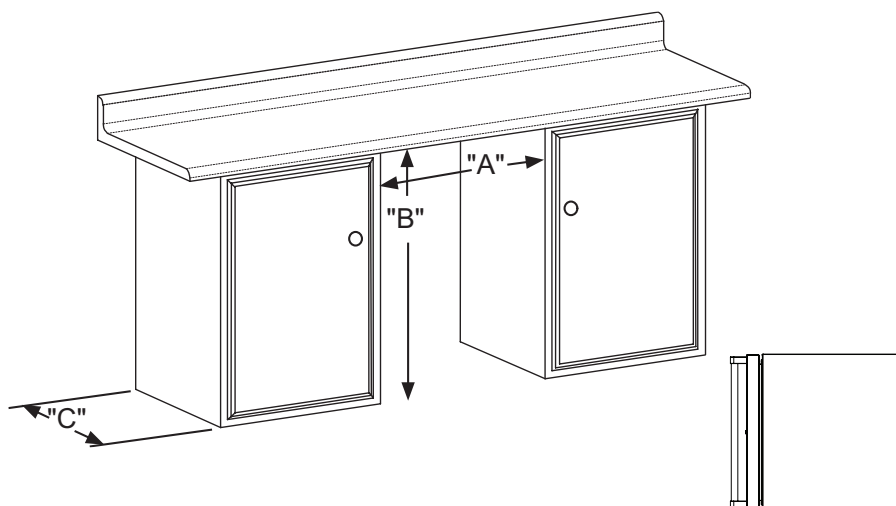

Figure 11