

Examine all packaging material for small parts that may have come loose during shipment. Periodic checks are recommended to insure that all components are in proper position, tight and free from damage. Keep this assembly instruction for future reference. Adult assembly is required. Customer Service Phone Number: 502-562-0000

**HARDWARE LIST**

- A (4) Long Allen Bolts
- B (8) Short Allen Bolts
- C (8) Spring Washers
- D (8) Flat Washers
- E (1) Allen Wrench

**PARTS LIST**

- F (1) Back Panel
- G (2) Side Panels

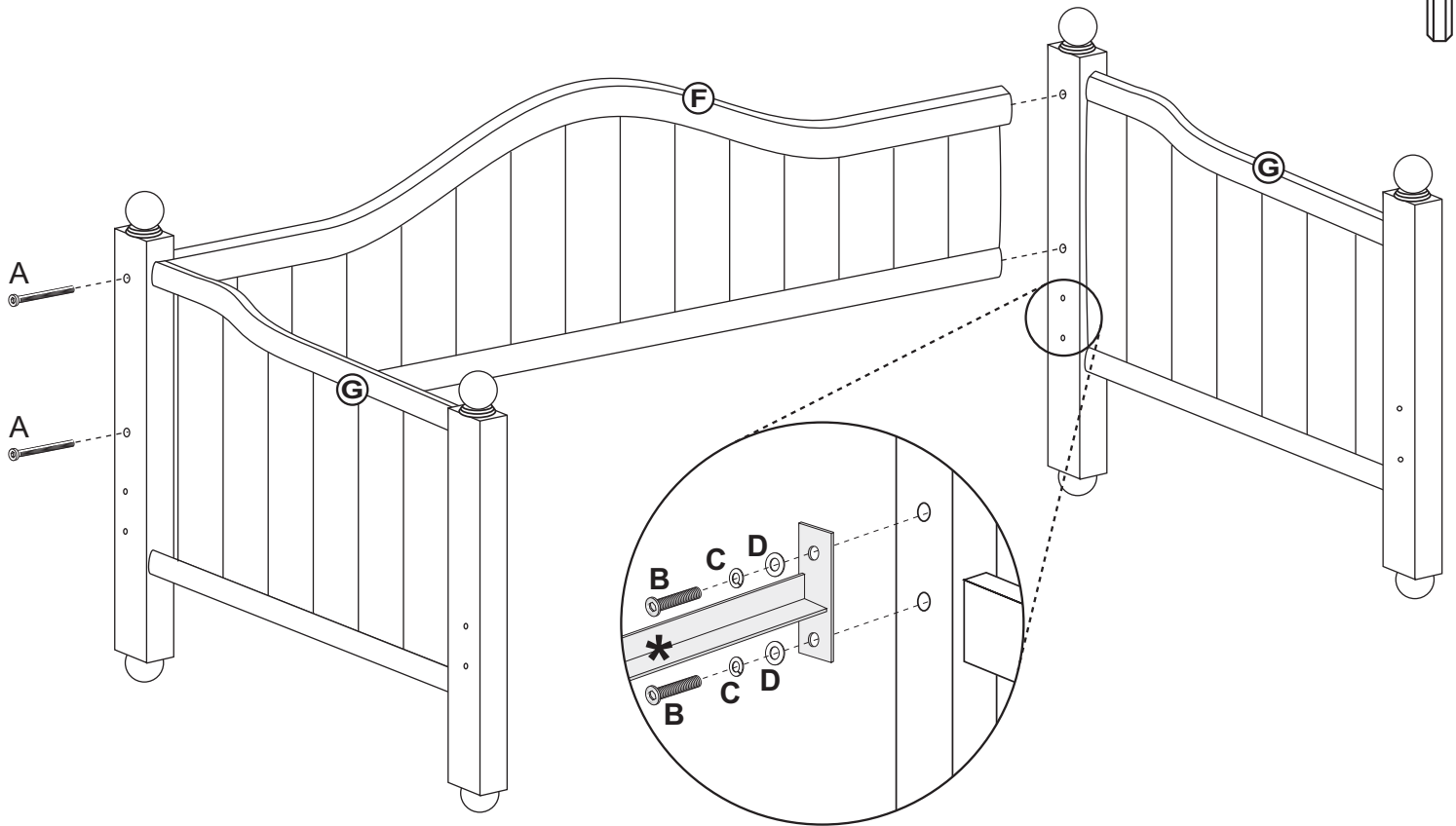
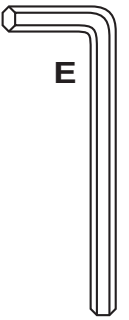
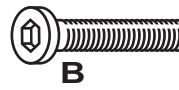

**STEP 1**

Begin assembly by attaching each Side Panel (G) to the Back Panel (F) using 2 Allen Bolts (A) per each side to hold in place. Tighten all bolts using the Allen Wrench (E) that has been provided.

**STEP 2**

Attach the Link Spring (\*Not Included) to each Side Panel (G) using 2 Short Allen Bolts (B), 2 Spring Washers (C) & 2 Flat Washers (D) per each post. Tighten all bolts. The assembly is now complete.