

FCC Compliance Statement

This device complies with Part 15 of the FCC Rules. Operation is subject to the following two conditions: (1) this device may not cause harmful interference, and (2) this device must accept any interference, including interference that may cause undesired operation.

Note: This equipment has been tested and found to comply with the limits for a Class B digital device, pursuant to Part 15 of the FCC Rules. These limits are designed to reasonably avoid harmful interference in a residential installation.

This equipment generates, uses and can radiate radio frequency energy. If not installed and used in accordance with the instructions, it may cause harmful interference to radio communications. However, there is no guarantee that such interference will not occur under certain installation conditions.

If this equipment does cause harmful interference to radio or television reception, which can be determined by turning the equipment off and on, the user is encouraged to try to correct the interference by one or more of the following measures:

- ▶ Adjust the direction or position of the receiving antenna.
- ▶ Increase the separation between the equipment and receiver.
- ▶ Connect the equipment into an outlet on a circuit different from that to which the receiver is connected.
- ▶ Consult the dealer or an experienced radio/TV technician for help.

Changes or modifications to this product not authorized by merchant could void the electromagnetic compatibility (EMC) and wireless compliance and void your authority to operate the product.

This product has been proven to comply with EMC regulations when using standard compliant peripherals and using shielded cables between system components. You must use standards-compliant peripherals and use shielded cables between system components to reduce the possibility of interference with radios, televisions, and other electronic equipment.

Deluxe massage Chair

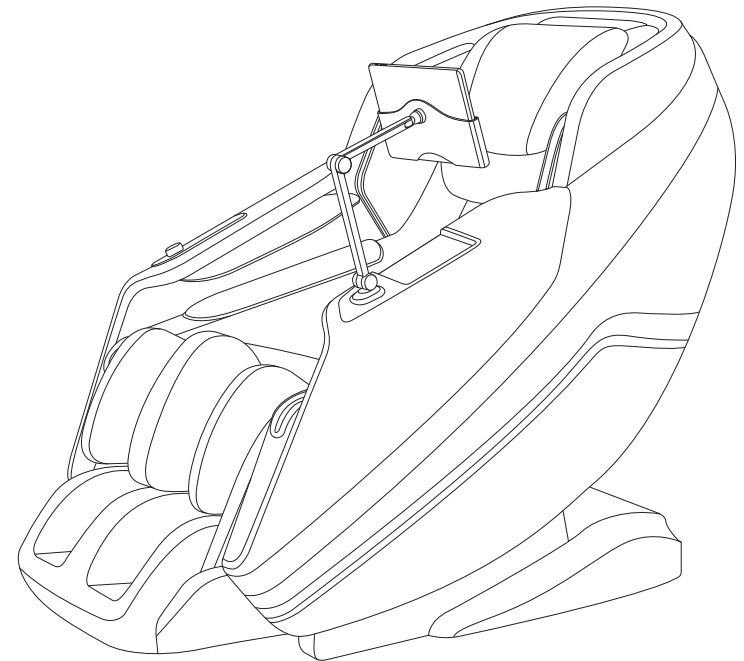

BM-R8L03
-User Manual-

Thank you for choosing our product and your support. In order to understand the directions fully, please read user's manual carefully. And after reading, please keep it for next browsing. We reserve the right of final explanation to the design of product. Dimensions and specifications are subject to change without notice for further improvement.

Contents

Safety	1-6
Preparation Before Use	7-10
Move the Chair	7
Site of Placement	7
Install Legrest	8
Install Backrest Pad and Pillow Pad	9
Remote Controller Connection	10
Connect Power	10
Components	11-17
Outer Structure	11
Shortcut Key	12
Controller	13
Corpus Summary	17
Troubleshoot	20
Cleaning and Maintenance	21
Specifications	21

Safety

IMPORTANT SAFETY INSTRUCTIONS

This massage chair is intended for household only .When using an electrical appliance, basic precautions should always be followed, including the following:

Read all instructions before using this massage chair.

DANGER-To reduce the risk of electric shock:

- 1) Always unplug this appliance from the electrical outlet immediately after using and before cleaning.
- 2) Never use pins or other metallic fasteners with this appliance.
- 3) Carefully examine the covering before each use. Discard the appliance if the covering shows any sign of deterioration, such as checking, blistering, or cracking.
- 4) Keep Dry - Do not operate in a wet or moist condition.

WARNING-To reduce the risk of burns, fire, electric shock, or injury to persons:

- 1) An appliance should never be left unattended when plugged in. Unplug from outlet when not in use, and before putting on or taking off parts.
- 2) Do not operate under blanket or pillow. Excessive heating can occur and cause fire, electric shock, or injury to persons.
- 3) Close supervision is necessary when this appliance is used by, on, or near children, invalids, or disabled persons. Keep children away from extended foot support.
- 4) Use this appliance only for its intended use as described in this manual. Do not use attachments not recommended by the manufacturer.
- 5) Never operate this appliance if it has a damaged cord or plug, if it is not working properly, if it has been dropped or damaged, or dropped into water.
Return the appliance to a service center for examination and repair.
- 6) Do not carry this appliance by supply cord or use cord as a handle.
- 7) Keep the cord away from heated surfaces.
- 8) Never operate the appliance with the air openings blocked. Keep the air openings free of lint, hair, and the like.
- 9) Never drop or insert any object into any opening.

Safety

- 10) Do not use outdoors.
- 11) Do not operate where aerosol (spray) products are being used or where oxygen is being administered.
- 12) To disconnect, turn all controls to the off position, then remove plug from outlet.
- 13) Temperatures sufficiently high to cause burns may occur regardless of the control setting. Do not use on an infant or invalid or on a sleeping or unconscious person. Do not use on insensitive skin or on a person with poor blood circulation. Check the skin in contact with the heated area of the appliance frequently to reduce the risk of blistering.
- 14) Do Not Crush - Avoid sharp folds.
- 15) Do not use massager in close proximity to loose clothing or jewelry.
- 16) Keep long hair away from massager while in use.
- 17) Connect this appliance to a properly grounded outlet only. See Grounding Instructions.
- 18) The apparatus shall not be exposed to dripping or splashing and that no objects filled with liquids, such as vases, shall be placed on the apparatus.
- 19) An apparatus with CLASS I construction shall be connected to a MAINS socket outlet with a protective earthing connection
- 20) The appliance coupler is used as the disconnect device, the disconnect device shall remain readily operable.
- 21) This appliance is not intended for use by persons (including children) with reduced physical, sensory or mental capabilities, or lack of experience and knowledge, unless they have been given supervision or instruction concerning use of the appliance by a person responsible for their safety.
- 22) If it is not in use for a long time or after use, please turn off the power and pull out the power plug.
- 23) Do not damage, break, over-bend, compress, tighten, wind, rotate or knot the power cord.

Safety

SAVE THESE INSTRUCTIONS

This massage chair is intended for household use only.

● Usage Environment

- Do not use the massage chair in an excessively humid or dusty environment as this may result in malfunction or electric shock.
- Do not use the massage chair in a room with a temperature of 104°F or higher.
- Do not expose the massage chair to heaters, stoves or direct sunlight.
- Place and use the massage chair on an even, non-slip floor.
- The massage chair is designed for home use and not for commercial purposes.

Caution

- The massage chair is to be used indoors only.
- If you use the massage chair in a cold room, do not increase the room temperature abruptly. It is recommended that you increase the temperature gradually to a normal level.
- If the massage chair is stored in a cold place and is being brought into a warm environment, it is advisable to wait one hour before use. This is because its performance may not be at optimum level, as there may be water droplets on the mechanical parts due to condensation. Using the massage chair under such conditions may result in malfunction.

IMPORTANT SAFETY INSTRUCTIONS

● Safety Precautions

- To ensure safe and correct use of the massage chair, do not operate it without reading this operation manual carefully.
- Do not use the massage chair when the upholstery or seat is removed. This may cause injury or malfunction.
- Do not use the massage chair in combination with other therapeutic equipment or electric blanket, etc., as this may result in ineffectiveness or injury.
- Do not use the massage chair an hour before or after eating as this may have adverse effects on the user.
- Do not allow children or pets to play around the massage chair, e.g., behind the backrest, under the seat or leg rest of the massage chair. This may result in injury.

Safety

- Do not rest or place heavy objects on the armrests, leg rest or backrest as this may result in malfunction or injury.
- Do not use the massage chair when your body is wet.
- Do not operate the massage chair with wet hands.
It is not recommended to use the massage for more than 15 minutes.
- Do not perform continuous massage on the same spot of your body for more than 5 minutes at a time as this may result in excessive stimulation and may have adverse effects.
- Do not insert your hand or foot along the paths of the massage rollers during use as this may cause injury.
- Stop operation immediately if you experience any discomfort.
- This product is not intended for self-treatment of conditions that should be managed by a qualified health care provider.
- People on medication or with medical conditions, please consult your doctor before use.
- Please do not use the product if you are not feeling well.
- Remove all scarves, neckties, necklaces and jewelry before using the massager.

● People with Medical Conditions

Consult your doctor before use if you:

- are under medical rest as ordered by a doctor.
- have spinal disorders, an abnormal spinal condition or have suffered a spinal injury.
- have back problems.
- have diabetes, osteoporosis or sensory impairment.
- have joint dysfunction.
- have a pacemaker or other electronic medical devices.
- may be pregnant.
- have phlebitis or thrombosis.
- have an increased risk for blood clots.
- had recent surgery.
- have surgical pins, screws, or anything mechanical implanted in your body.

Safety

● Instances When the massage chair Should Not Be Used

In the following events, please switch off the main power switch immediately and disconnect the power cord from the electrical outlet:

- If water is accidentally spilled onto the massage chair. This may result in electric shock or malfunction.
- If the fabric of the backrest is torn and the internal components are exposed.
- If pain or discomfort is felt during massage, stop operation immediately and consult your doctor.
- If you detect any malfunction or any other abnormal condition during operation.
- If there is a power failure. Injury may occur when power is restored unexpectedly.
- If there is lightning.

● Assembly and Repair of the massage chair

- Do not disassemble the backrest cover of the massage chair. Touching the internal components may result in malfunction or electric shock.
- The massage chair must only be professionally serviced or repaired. Do not attempt to disassemble or repair the massage chair yourself.

● Things to Note About the Power Plug and Cord

- Check that the Alternating Current (AC) voltage corresponds with the specifications indicated for the massage chair.
- Do not connect or disconnect the power plug from the electrical outlet with wet hands. This may result in malfunction or electric shock.
- When disconnecting the power plug, pull it by holding the plug, not the cord.
- Although operation will be stopped automatically by the Auto-Timer function, always remember to switch off the main power switch after use.
- Do not place the power cord under the massage chair or any other heavy objects.
- Do not wind the power cord around the massage chair as this may damage the cord and result in a fire or electric shock.
- Do not operate the massage chair with a damaged cord or extension cord.
- Do not use the massage chair if the electrical outlet is loose.
- If the power cord is damaged, it should be replaced by a qualified technician.

Safety

● Grounding Instructions

This product must be grounded. If it should malfunction or breakdown, grounding provides a path of least resistance for electric current to reduce the risk of electric shock. This product is equipped with a cord having an equipment-grounding conductor and a grounding plug. The plug must be plugged into an appropriate outlet that is properly installed and grounded in accordance with all local codes and ordinances.

DANGER - Improper connection of the equipment-grounding conductor can result in a risk of electric shock. Check with a qualified electrician or serviceman if you are in doubt as to whether the product is properly grounded. Do not modify the plug provided with the product - if it will not fit the outlet, have a proper outlet installed by a qualified electrician.

This product is for use on a nominal 120V~ circuit and has a grounding plug that looks like the plug illustrated in sketch A as following illustration. Make sure that the product is connected to an outlet having the same configuration as the plug. No adapter should be used with this product.

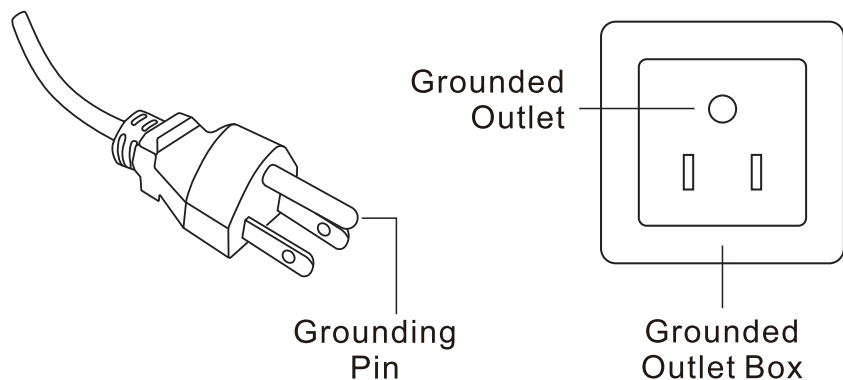

Preparation Before Use

Move the Chair

- Please turn off the main power and unplug the power from the electrical outlet.
- Tilt the chair backward as shown in the picture below and wheel it to the desired location.
- Please cover the floor with mat when move the massage chair in case of any damage of floor will be made.

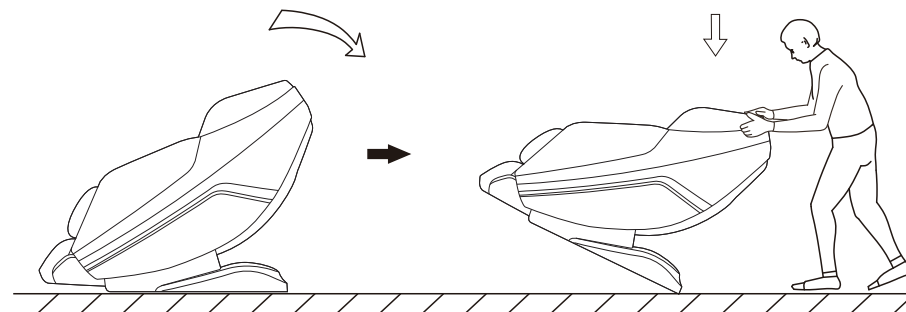

Site of Placement

Please make sure that there is an allowance of more than 5cm behind the massage chair, and more than 35cm in front of the massage chair to allow the backrest to recline without obstruction during operation.

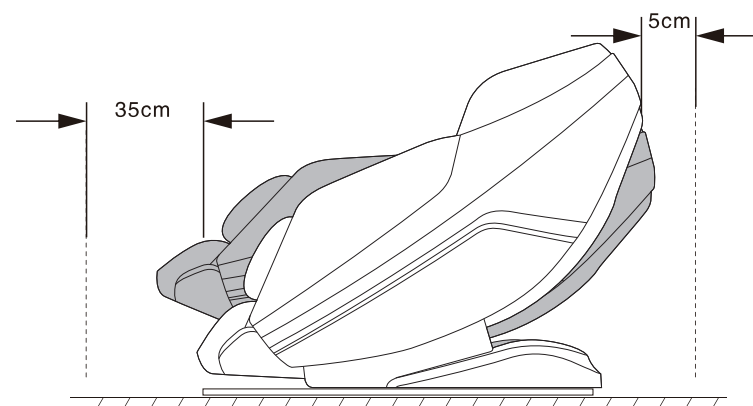

Preparation Before Use

Install Legrest

- As shown in the figure, insert the air tube ① and DC cable ② into the slots.

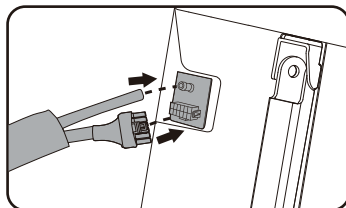
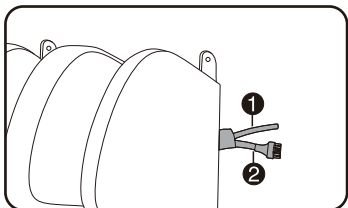

- As shown in the figure, install the slots ③ of legrest into fixed part ④.

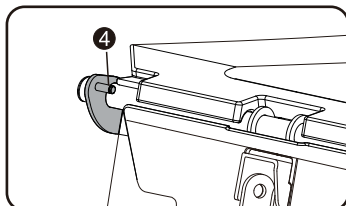
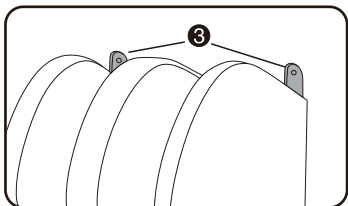

- As shown in the figure, insert the lock buckle ⑤ into each side, installation finished.

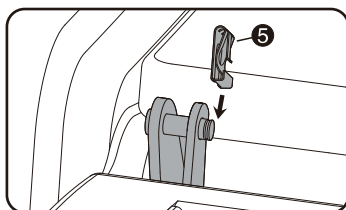
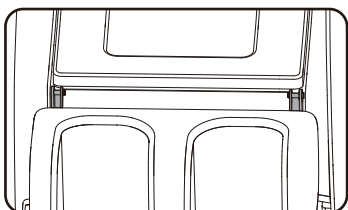

Preparation Before Use

Install Backrest Pad and Pillow Pad

- Attach the upper backrest pad to backrest with zipper.
- Attach the pillow pad to backrest with velcro.

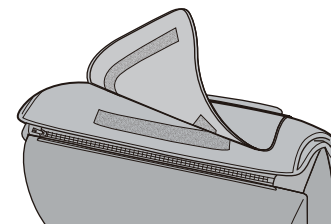
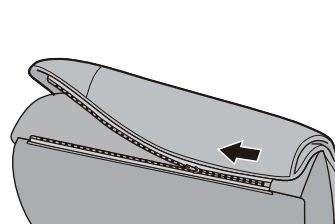

- Attach the left side of backrest pad to backrest with zipper, same as the other side.

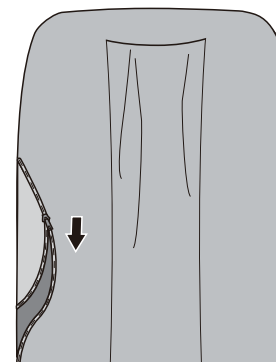

Preparation Before Use

Remote Controller Connection

- Connect the cable of remote controller with the cable under seat.

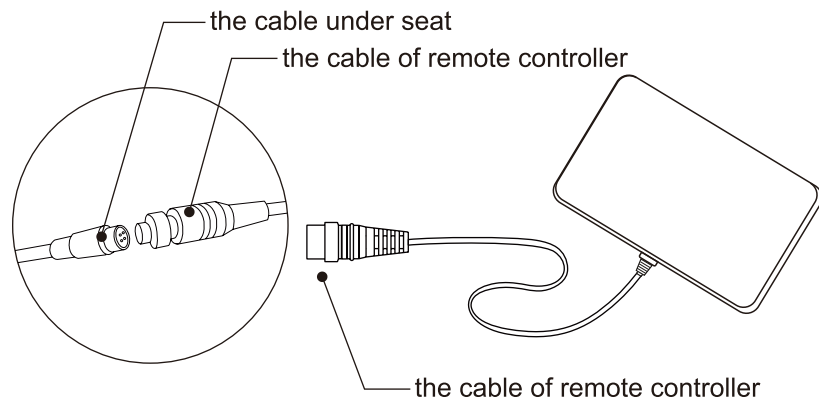

Connect power

- Plug the power cord into power inlet, turn on the power switch.

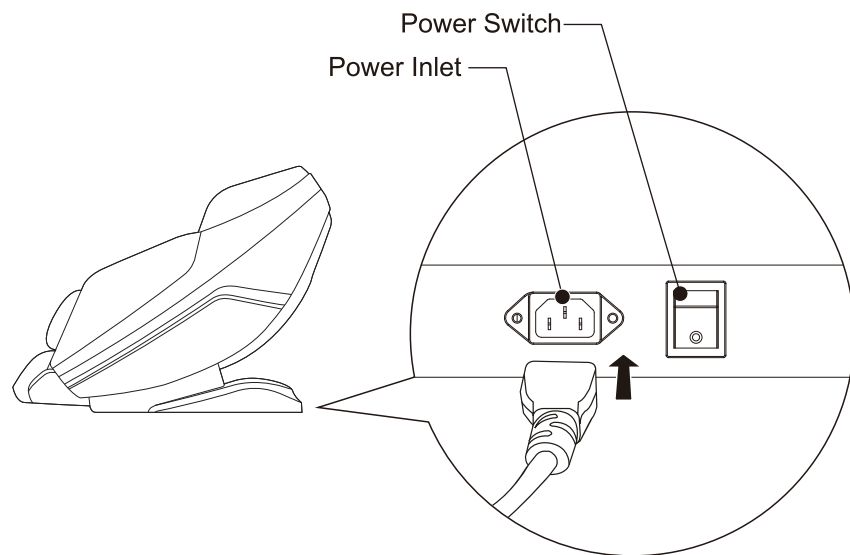

10

Components

Outer Structure

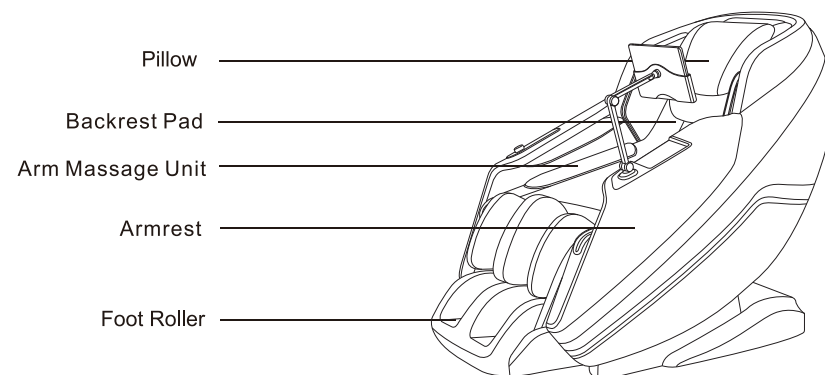
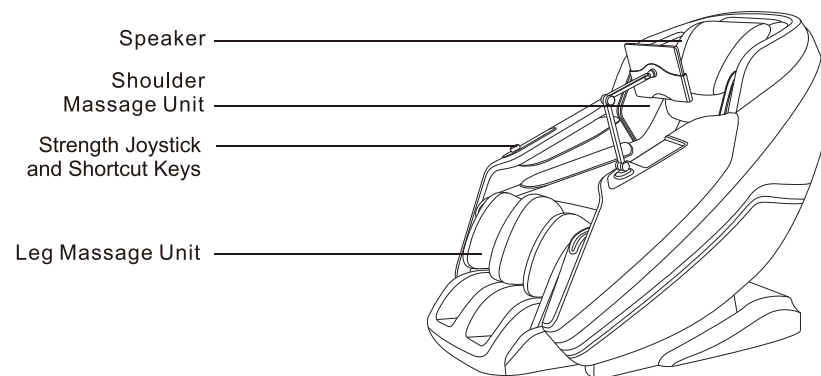

11

Components

Shortcut Key

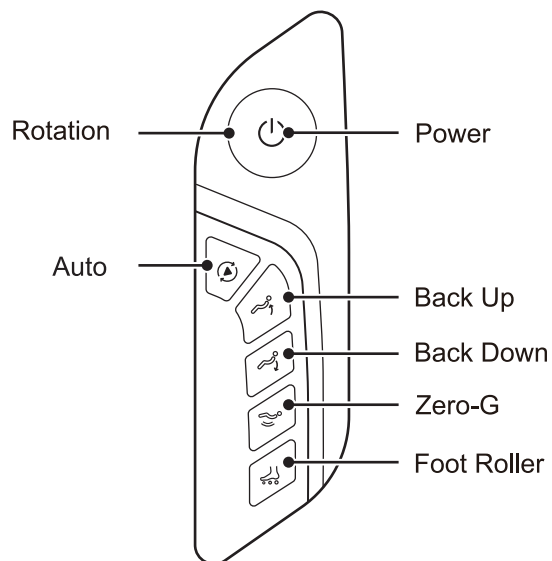

Function	Button	Instruction
Power		ON/OFF
Rotation		Rotate clockwise to increase stage, and counterclockwise to decrease stages. The stages are divided into 1-6 stage.
Auto		Press this button to switch between multiple automatic program functions. The specific display is subject to the actual product.
Back Up / Back Down		Press the Back Up/Down button to adjust the backrest angle.
Zero-G		Press this button to turn off or switch the zero gravity of stage 1-3.
Foot Roller		Press the button to activate Foot Roller, Press again to stop this function.

Components

● Connect to the power

1. Connect the chair to the power.
2. Turn the power switch to "I".
3. Press the power button on the top of the remote.
4. Please read the Instructions carefully, and press the "START" button to enter into the interface.
5. Select any function to start massage.

Components

● Auto Mode Interface



Click "AUTO MODE" to enter into the automatic massage programs interface.

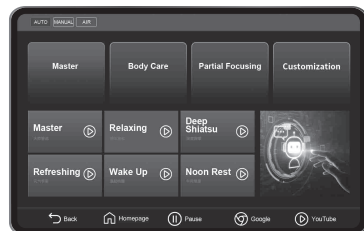

There are 24 preset massage programs in total. Select any one of it to start the massage.



On the Auto Mode operation interface, you can adjust below functions:
 4D: adjust the height of the back roller from level 1 to level 6.
 Calf Roller: adjust the intensity of the calf roller from level 0 to level 3.
 Foot Roller: adjust the intensity of the foot roller from level 0 to level 3.
 Zero Gravity: 3 levels of Zero-G position.

Heat: turn on/off the heating function, and select the heating function from level 1- level 3.
 Arrow Key: adjust the angle of backrest, legrest and the leg length.

Note:

Speed of the back roller is not allowed to adjust while running AUTO MODE.
 The Zero-G function, angle of backrest, legrest and the leg length are not allowed to adjust while running "STRETCHING" and "DEEP SLEEP" modes.

Components

● Body Scanning Interface

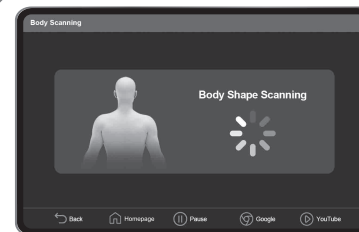

After selecting a massage program, it will automatically perform a body scan to map the key areas of the neck and back to detect your shoulders height.

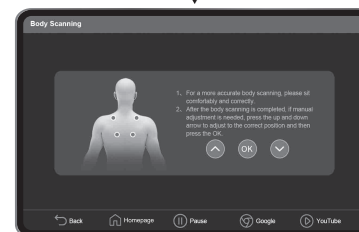

The scanning technology can be recalibrated once the scan is complete. Press and hold the "▲" and "▼" button to adjust the height of the back roller and press "OK" to start the massage.

● Manual Interface



Click "Manual program" to enter the interface of manual massage.



On the Manual Mode operation interface, you can adjust below functions:
 6 massage techniques: press any one of the massage technique to start, and press again to stop.
 4D: adjust the height of the back roller from level 1 to level 6.
 Speed: adjust the intensity of the back roller from level 1 to level 6.

Calf Roller: adjust the intensity of the calf roller from level 0 to level 3.
 Foot Roller: adjust the intensity of the foot roller from level 0 to level 3.
 Heat: turn on/off the heating function, and select the heating function from level 1- level 3.

Components

Arrow Key: adjust the angle of backrest, legrest and the leg length.

Whole: massage from neck to hip.

Patrial: massage in a small area, press the "Mechanism Position Adjustment" to adjust Point: massage at the point where the back roller stop, press the "Mechanism Position Adjustment" to adjust.

Width: press the buttons : "Widest" "Middle" and "Narrow" to adjust the width of the back rollers.

Note:

Speed of the back roller is not allowed to adjust while running "SHIATSU".

Width of the back roller is not allowed to adjust while running "KNEADING" and "KNOCKING".

● Air Massage Interface

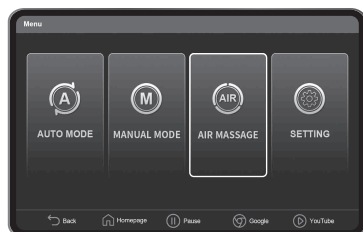

Click "Air Massage" to enter into the interface of the airbag massage.



On the Air Massage operation interface, you can adjust below functions:
Select the air massage position: press the button to start the air pressure massage, press again to stop.

Air intensity: adjust the intensity of the airbag from level 1 to level 3.

Calf Roller: adjust the intensity of the calf roller from level 0 to level 3.

Foot Roller: adjust the intensity of the foot roller from level 0 to level 3.

Zero Gravity: 3 levels of Zero-G position.

Heat: turn on/off the heating function, and select the heating function from level 1- level 3.

Arrow Key: adjust the angle of backrest, legrest and the leg length.

Components

● Settings Interface



Click "Setting" to enter into the setting interface.

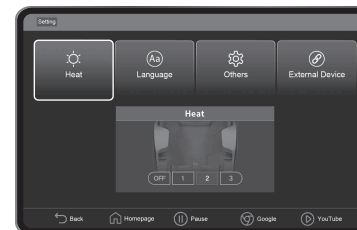

On the Setting interface, you can adjust below functions:
Heat: turn on/off the heating function, and select the heating function from level 1- level 3.

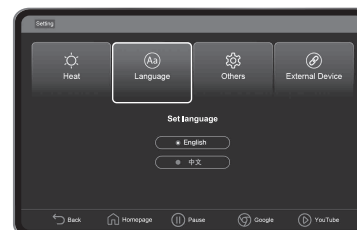

Language: press this button to select the language of the remote.



Prss "Others" to adjust below functions:
Speaker voice: adjust the Bluetooth speaker voice from level 1 to level 5.
Button voice: adjust the key tone of the remote from level 1 to level 5.
Luminance: adjust the light of the remote from level 1 to level 5.
Led light: turn on/off the led light on the chair.

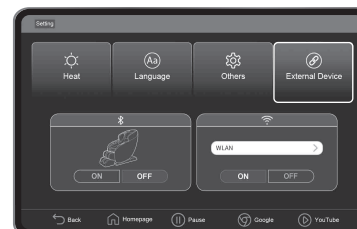

Click the "External Device" to adjust below functions:
Bluetooth: turn on/off the Bluetooth function. Pair you phone to the chair when it's on.
WLAN: turn on/off the WIFI function. Connect to your WIFI when it's on. And then you can use GOOGLE and Youtube.

Corpus Summary

Command Words	Response by Chair
Hello massage chair	Hello
Power ON	Please select your favorite program to start your massage.
Power off	During shutdown, please leave or restart the massage chair after the chair is completely reset. Thank you and hope you enjoy the massage.
Pause massage	Massage paused
Continue to massage	Massage resumed
Turn on Bluetooth	OK, Bluetooth on
Turn off Bluetooth	OK, Bluetooth off
Turn on foot roller	OK, Foot roller on
Turn off foot roller	OK, Foot roller off
Turn on Heating	OK, Heating on
Turn off Heating	OK, Heating off
Zero gravity	OK, command complete
Back up	OK, command complete
Back down	OK, command complete
Leg up	OK, command complete
Leg down	OK, command complete
Start airbag massage	OK, Start airbag massage
Stop airbag massage	OK, Stop airbag massage
Kneading massage	Kneading massage
Shiatsu massage	Shiatsu massage
Knocking massage	Knocking massage
Rolling massage	Rolling massage
Tapping massage	Tapping massage
Clapping massage	Clapping massage
Massage for fifteen minutes	OK, Massage for fifteen minutes
Massage for twenty minutes	OK, Massage for twenty minutes
Massage for twenty five minutes	OK, Massage for twenty five minutes
Massage for thirty minutes	OK, Massage for thirty minutes
Increase strength	Increase back roller intensity
Decrease strength	Decrease back roller intensity
Increase air intensity	Air intensity up
Decrease air intensity	Air intensity down
Whole body massage	Whole body massage
Local massage	Local massage
Spot massage	Spot massage
Increase foot roller intensity	OK, foot roller intensity up
Decrease foot roller intensity	OK, foot roller intensity down

Corpus Summary

Command Words	Response by Chair
Master massage	Start Master massage
Relaxing massage	Start Relaxing massage
Sport Care massage	Start Sport Care massage
Soft massage	Start Soft massage
Spa massage	Start Spa massage
Refreshing massage	Start Refreshing massage
Spine care massage	Start Spine care massage
Waist & Back massage	Start Waist & Back massage
Neck & Shoulder massage	Start Neck & Shoulder massage
Slim massage	Start Slim massage
Deep Shiatsu massage	Start Deep Shiatsu massage
Wake Up massage	Start Wake Up massage
Noon Rest massage	Start Noon Rest massage
Sole Relieving massage	Start Sole Relieving massage
Calf Care massage	Start Calf Care massage
Lumbar Care massage	Start Lumbar Care massage
Gentle Care massage	Start Gentle Care massage
Deep sleep massage	Start Deep sleep massage
Deep Stretch massage	Start Deep Stretch massage
Gentleman Care massage	Start Gentleman Care massage
Yoga massage	Start Yoga massage
Space massage	Start Space massage
TCM Recuperating massage	Start TCM Recuperating massage
Lady care massage	Start Lady care massage

Note:

If you want to use voice control, please say "Hello massage chair" to wake up the chair first, and then use the voice command after getting the reply "Hello".

The "SPEED", "WIDTH" and "POSITION" of the back roller are not allowed to adjust while running Auto Mode.

The angle of the chair is not allowed to adjust while running "STRETCHING" and "DEEP SLEEP" modes.

The chair will not return to the initial position while running "DEEP SLEEP" mode.

Troubleshoot

If there is still an abnormality after the following checks, to prevent any accident, please stop using the massage chair immediately. Please unplug the power cord from the outlet and contact with the dealer or the nearby customer service center.

Problem	Possible cause/action	
The massage rollers move up and then stop.	<ul style="list-style-type: none"> In order not to affect the body, the automatic timer function will move the massage roller to the upper end when the massage is over. 	Inevitable in structure, not abnormal
Noise during the massage	<ul style="list-style-type: none"> The sound of clapping; Friction sound of the massage wheel and fabric during kneading; The sound of the massage wheel when lifting and kneading; The sound during air pressure massage; The sound of the inflator pump; The sound of airbag exhausting; The sound of the backrest up and down. 	
The massage rollers will stop during the massage.	<ul style="list-style-type: none"> If the force applied to the massage rollers is too large, the massage rollers will stop running. Lift your body slightly when using it, or raise the backrest slightly. (especially those who weigh more than 100kg, please pay attention when using) 	After checking, if there is still an abnormality, please stop using the massage chair immediately.
Press the power button, but the massage chair doesn't work properly or cannot connect to the power.	<ul style="list-style-type: none"> Please check the following: <ol style="list-style-type: none"> Is the power plug fully inserted into the socket? Is the main power switch on the left rear of the unit turned on? 	
The power cord and plug are abnormally hot.	<ul style="list-style-type: none"> Please stop using immediately. 	
	Please contact with your dealer or customer service.	
	Do not disassemble or repair it yourself or by non-professionals.	

Cleaning and Maintenance

CLEANING

- ▶ Before cleaning, switch OFF power and remove the power plug from the wall outlet.
- ▶ Dip a soft, cotton cloth in neutral detergent and wring dry. Use it to wipe the pillow cushion, back cushion, armrests, legrests, and any plastic parts of the chair.
- ▶ Use a piece of wet cloth (without detergent) to re-wipe the pillow cushion and back cushion.
- ▶ Use a soft, dry cloth to re-wipe the armrests, legrests, and any plastic parts of the chair.
- ▶ Use a soft, dry cloth to wipe the controller, and the power supply box.
- ▶ To clean the foot/calf unit covers, remove them from the chair, hand wash with mild detergent and hang dry.



CAUTION

- ▶ Before any maintenance, always disconnect the power plug from the wall outlet.
- ▶ To avoid electric shock, never touch the power plug with wet hands.
- ▶ When cleaning the back cover of the massage chair, do not allow any detergent to seep into the power supply box.
- ▶ Do not use abrasive chemicals, such as benzene or alcohol, to clean this chair. Damage to the chair may result.
- ▶ Do not apply an iron or any other heated device to the chair.

STORAGE

When not in use, be sure to switch off power and detach the power plug from the wall outlet. Before putting into storage, wipe off all accumulated dirt and dust from the surface of the chair. Cover the entire surface of the chair with a dust cover (not included).



CAUTION

- ▶ Do not store the product under direct sunlight, nor in a location with high temperatures. Doing so may cause the upholstery to fade.
- ▶ Do not allow massage chair to remain in contact with vinyl or wallpaper for extended periods of time as this could lead to discoloration.

Specifications

Model	BM-R8L03
Rated Voltage	100-240V~
Rated Frequency	50-60Hz
Rated Power	200W
Upright Dimension	1570 mm × 767mm × 1160 mm(L × W × H)
Extended Dimension	1687 mm × 767mm × 972mm(L × W × H)