

5405-300, 5405-356

ASSEMBLY INSTRUCTION

Pg: 1/3

Ver: 01

PACKING LIST:

ITEM PARTS	Q'ty	U/M
P1. Table top	1	pc
P2. Table base	1	pc
HARDWARES	Q'ty	U/M
A. Allen bolt with washer	4	sets
B. Allen Wrench	1	pc

INSTRUCTIONS :

1. Unpack and check packing list if it is complete. Make sure to put carton free from debris that may cause damage to the item. Turn the table top (P1) upside down. Align & insert base (P2) to table top (P1).
2. Align and insert Allen bolt with Washer (A) to the holes, using Allen Wrench (C) by turning clockwise until it is fix or tighten. Refer *detail 'A'*.
3. Turn the table upright, item is ready to use. (Adjust glider for the table levelling if necessary, refer *detail 'B'*).

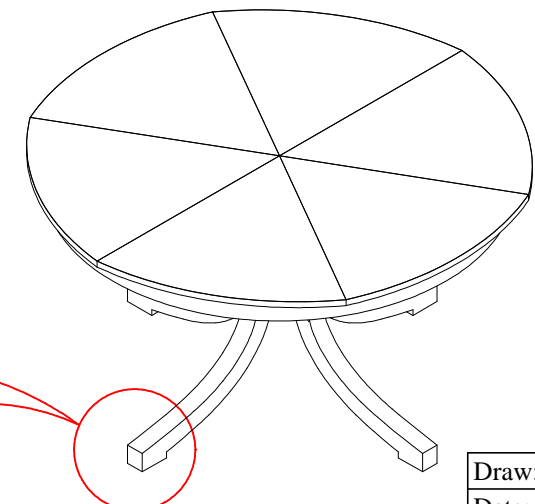
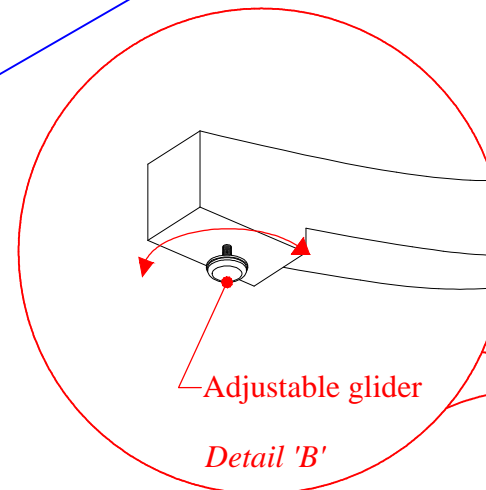
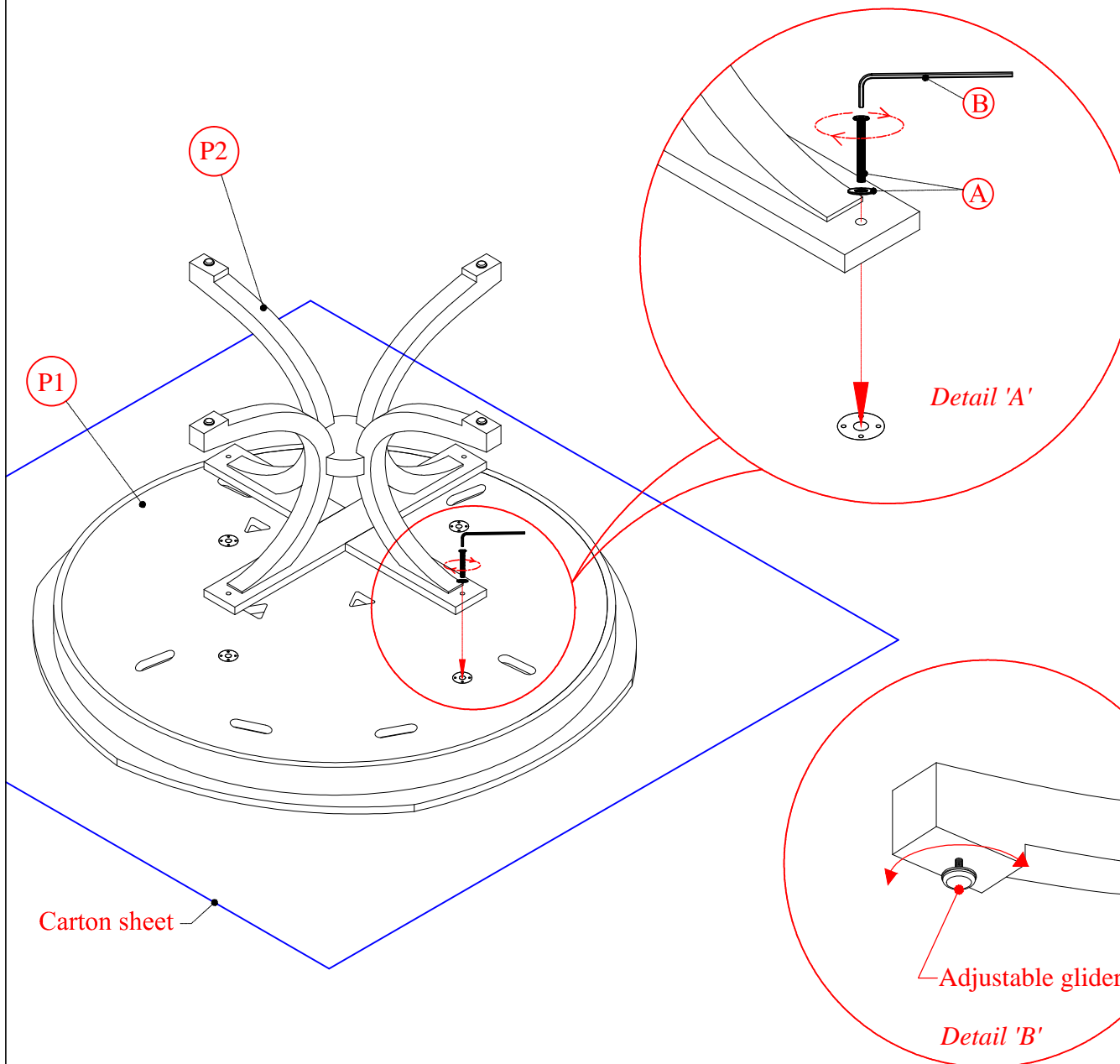

Draw: T.Tuyet
Date: Mar 25, 16

5405-300, 5405-356

ASSEMBLY INSTRUCTION

Pg: 2/3

Ver: 01

TOP PANEL UNFOLDING INSTRUCTION:

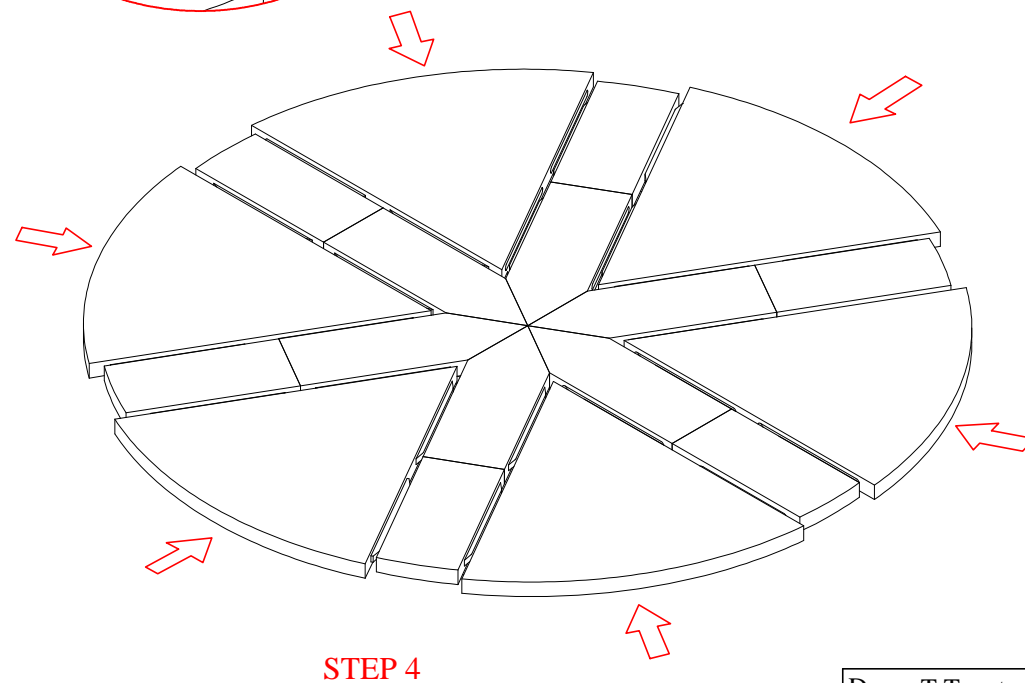
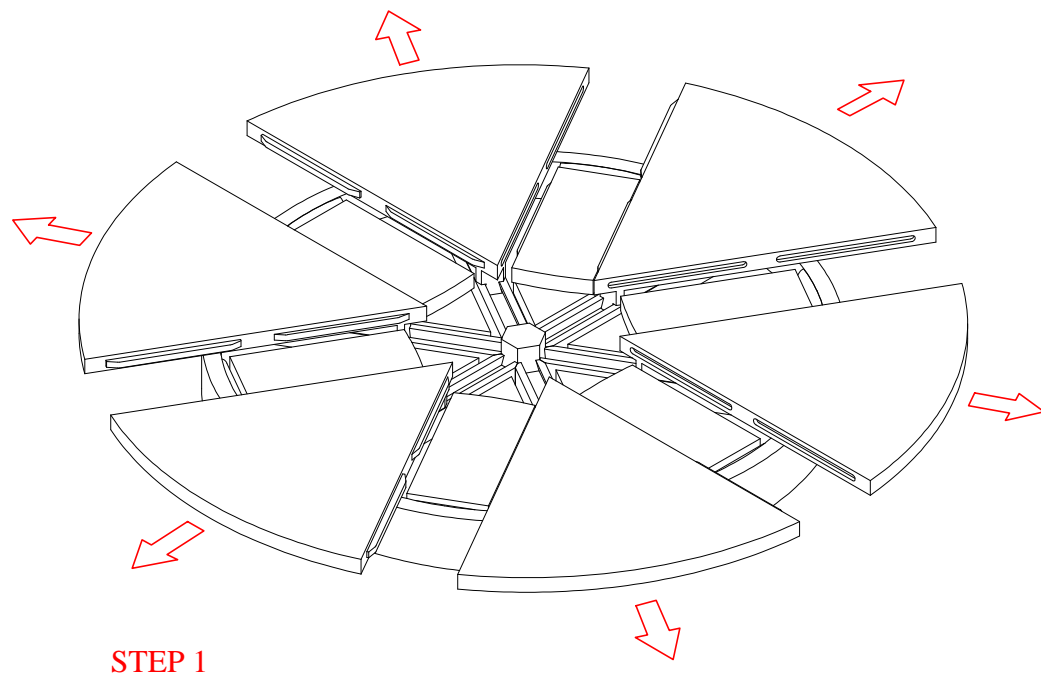
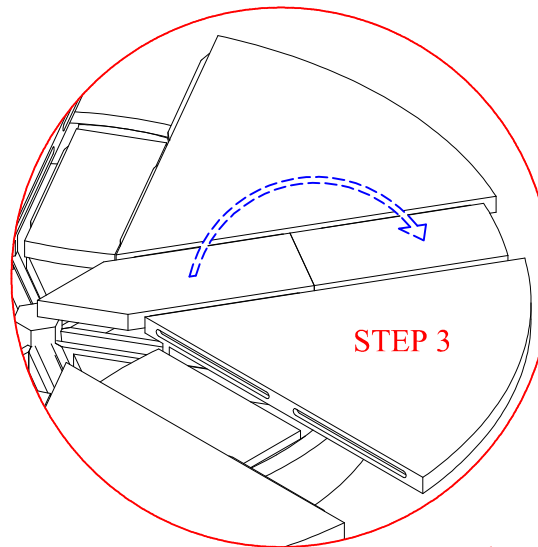
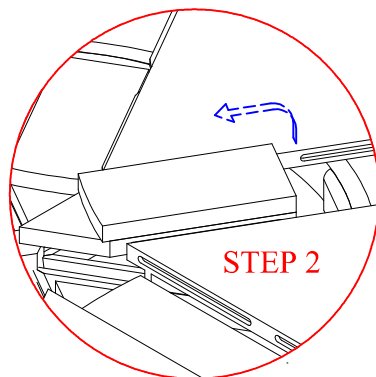

Draw: T.Tuyet
Date: Mar 25, 16

5405-300, 5405-356

ASSEMBLY INSTRUCTION

Pg: 3/3

Ver: 01

TOP PANEL FOLDING INSTRUCTION:

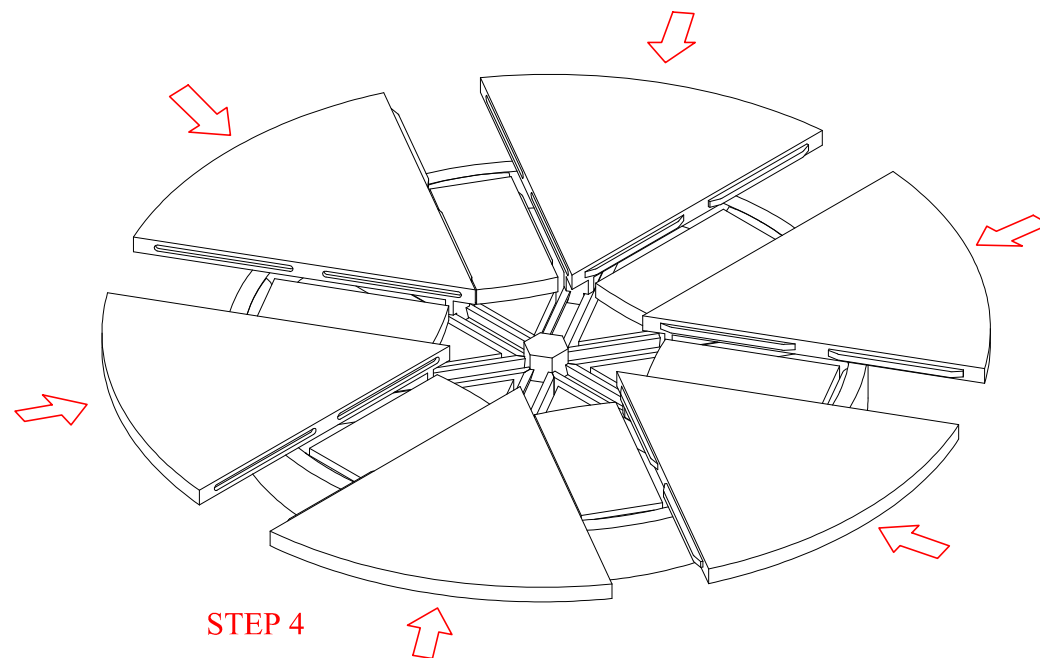
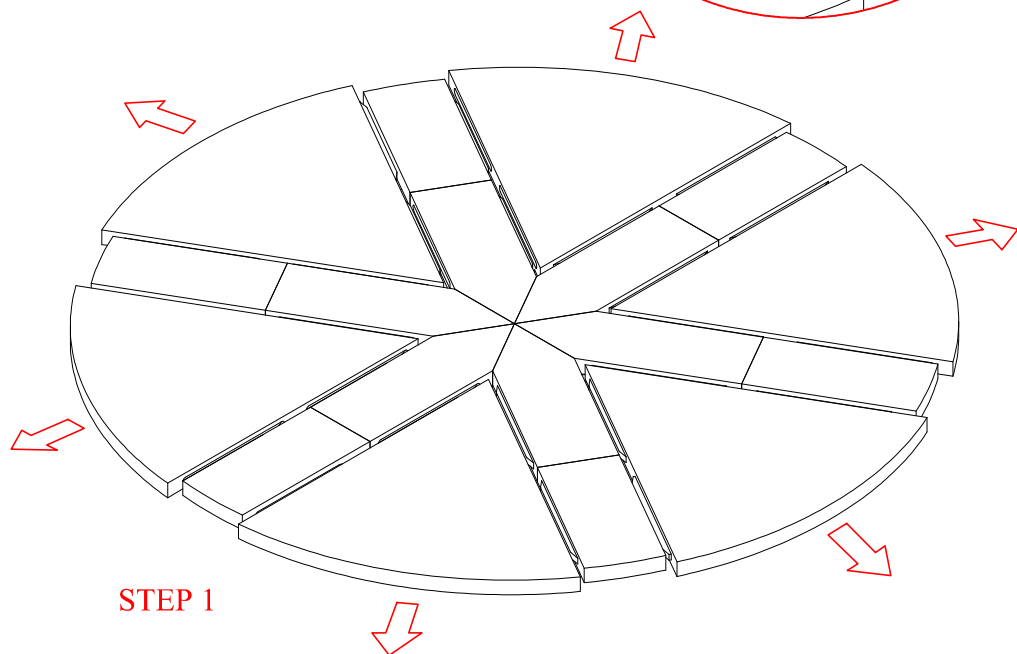
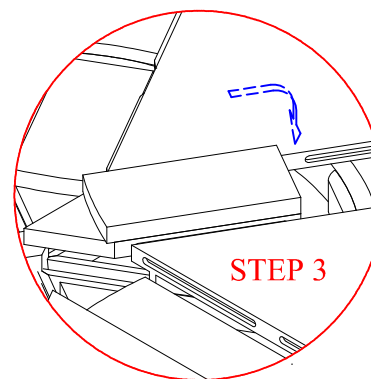
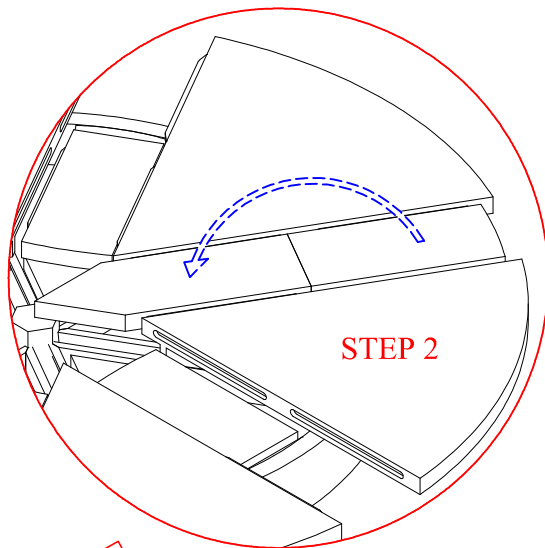

Draw: T.Tuyet
Date: Mar 25, 16

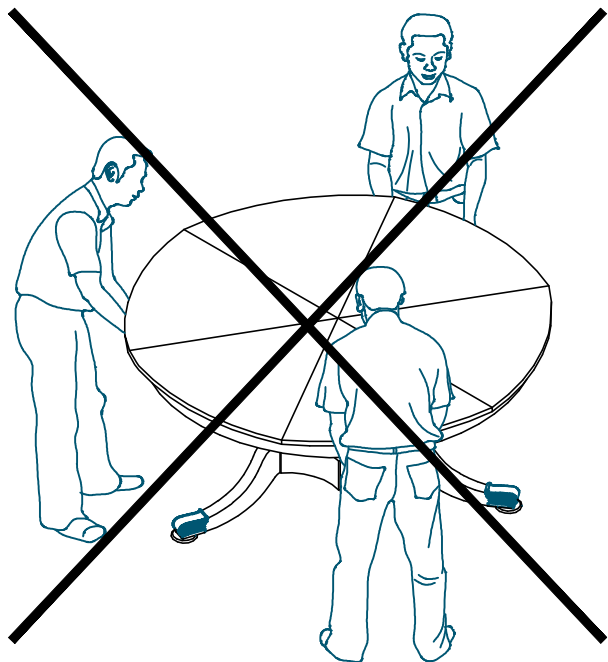

WARNING

1. The table should not be lifted with the base attached.
2. Do not assemble the table (top to base) until the base is placed where the table will remain, and then attach the top.
3. Do not move the table from one location to another without detaching the top so that the top and base are moved separately.
4. Do not lift or move the table by lifting on the outer edge of leaves of top panels. If the table must be moved slightly grasp under the apron instead of under the outer edge.

Never attempt to lift the table by grasping under the leaves when open.

Company is not responsible for any damage by not following the instruction.

5. See assembly and operation details inside this carton for more details.

