

RDF30 | REGENT SERIES DUAL FUEL RANGE

AEG

30" Stainless Steel Freestanding Dual Fuel Range, 5.7 Cu. Ft. Oven

FEATURES & BENEFITS

Cool Flow System

Unique Cool Flow System that generates a flow of cold air thanks to inner fans that are engineered to keep cool to the touch knobs, handle and exterior surfaces.

Five Burners

A total of 5 sealed gas burners offer a combined output of 45,600 BTUs. The special simmer burner offers an ideal 750 BTUs of output for a precise simmering temperature.

Black Enamel Surface

Exclusive one-piece tooled black enamel cooking surface, modern design, resilient to scratches, contains spills for easy cleaning.

Cast Iron Support Grates

Heavy duty cast iron grates, so pots and pans can be moved from one burner to another easily and without risk of tipping over.

Convection Oven

Oven features 2 convection fans to evenly circulate heat throughout the oven, producing tastier results than traditional radiant heating methods.

Large Panoramic Window

Triple-pane glass, large panoramic window provides clear view of what's cooking, cool touch surface.

AVAILABLE COLOURS



Stainless Steel with Black Enamel Cooktop

GENERAL PROPERTIES

Fuel Type	Dual fuel / Natural gas – Propane
Style	Freestanding
Stainless Steel Handle	Yes
Cooktop	Sealed Burners
Cooktop / Oven Control Type	Rotary Knobs
Control Panel Indicators	Thermostat Pilot Lamp, Oven Switch Pilot Lamp
Viewing Window	Yes
Door Type	Fully Flush
Removable Drip Tray	Standard
Wok Ring	Standard

CAPACITY

Number of Burners	5
Primary Oven Capacity	5.7 cu. ft.

COOKTOP FEATURES

Cooktop surface	Black Enamel
Continuous support grates	Yes
Cooktop Accessory	Wok Ring Adaptor, Espresso Trivet
LPG Conversion kit	Yes

OVEN FEATURES

Oven Type	Convection oven
Fans	2 Convection Fans
Racks	2 Heavy Duty Racks 6 Rack Positions
Glide Rack(s)	Yes
Temperature Display	°C & °F
Broiler Element Location	Top
Broiler Pan Included	Yes, Plus Grill Insert
Interior Oven Light	Side Wall Lighting
Removable Door	Yes
Self-Cleaning	No



AEG is a registered trademark used under license from AB Electrolux (publ)

BURNER PERFORMANCE

Simmer Burner	Yes
Power Burner	Yes
Burner 1 Output	11,000 BTU (Large Burner)
Burner 2 Output	6,500 BTU (Medium Burner)
Burner 3 Output	18,000 BTU (Power Burner)
Burner 4 Output	6,500 BTU (Medium Burner)
Burner 5 Output	3,600 BTU (Auxiliary)

OVEN FUNCTIONS

Cooking Functions	5 Functions, incl. True Fan Convection and Fan Broil Cookings
-------------------	---

TECHNICAL DETAILS

Volts (V)	120/240 V
Frequency (Hz)	60 Hz
Maximum Temperature	260 °C / 500 °F
Maximum Power	3460 W
Supplied with Range Cord and Plug	NEMA configuration 14-50P

DIMENSIONS

Product Dimensions (W / H / D) In / mm	29 7/8" / 35 7/8" / 26 7/8" (759mm / 911mm / 682mm)
Interior Dimensions (W / H / D) In / mm	24 1/4" / 20 1/2" / 19 13/16" (615mm / 520mm / 503mm)
Exterior Width Dimensions (W) In / mm	29 7/8" (759mm)

WARRANTY

Parts & Labour	2 Years
----------------	---------

Installation Details

PRODUCT DIMENSIONS

In (W / H / D)	29 ⁷ / ₈ " / min. 35 ⁷ / ₈ " - max. 37 ⁵ / ₁₆ " / 26 ⁷ / ₈ "
mm (W / H / D)	759mm / 911mm – 947mm / 682mm

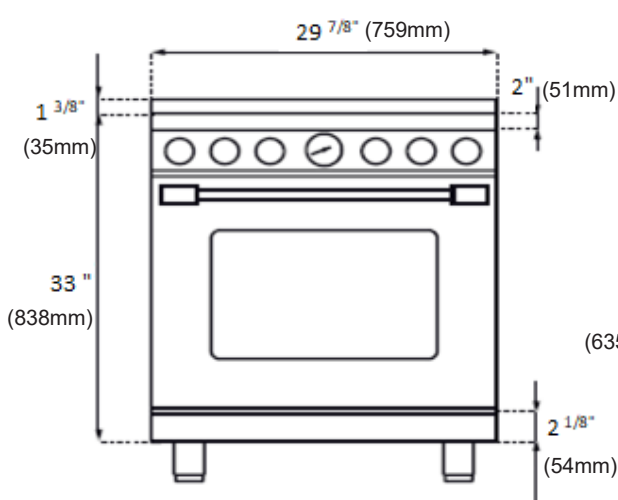

FRONT VIEW

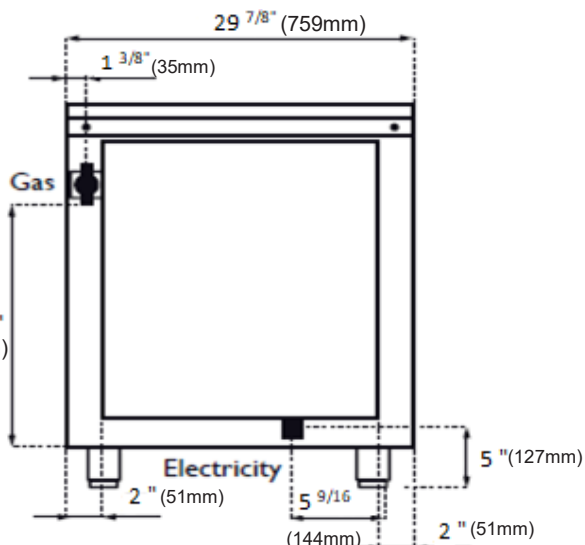

REAR VIEW

SIDE VIEW

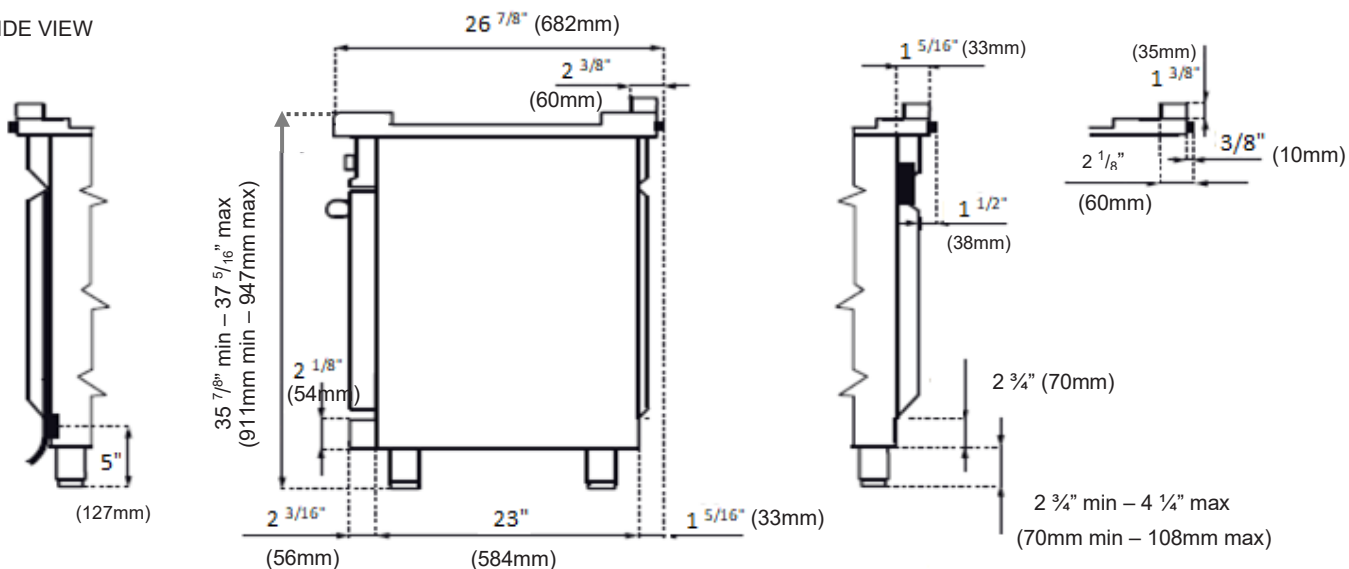

All gas ranges are equipped with 10mm (3/8") spacers on the back to provide ventilation and to prevent overheating the surrounding area.



WARRANTY INFORMATION

Each appliance is covered by a comprehensive 2-year parts and labor warranty. Refer to product warranty policy for complete terms and conditions.

FOR PARTS & SERVICE

Euro-Parts & Service

39822 Belgrave Road, Belgrave, ON. N0G 1E0 • 1 800 561 4614
www.euro-parts.ca • parts@euro-parts.ca • service@euro-parts.ca

AEG appliances are imported and distributed in North America by Euro-Line Appliances Inc. For more information, please visit one of our showrooms or www.ela.ca

EURO-LINE APPLIANCES INC.

871 Cranberry Court
Oakville, ON L6L 6J7
Tell: 905.829.3980
Toll-Free: 1.800.421.6332
Email: info@ela.ca

EURO-LINE APPLIANCES INC.

101-1014 Homer St.
Vancouver, BC V6B 2W9
Tell: 604.235.3980
Toll-Free: 1.855.352.9378
Email: infowest@ela.ca