

PRESRV™

## REFRIGERATOR FREEZER DRAWERS

DUAL ZONE



With superior versatility and the ability to blend perfectly into your existing cabinetry, these dual zone drawers are ready to chill at freezer, fridge, or pantry temps. Add 3-Color LED lighting and adjustable in-drawer organizers,

and these Full-Extension, Soft-Close Drawers are an organized kitchen's dream sidekick. Drawer handles sold separately; wood panels are customer-provided for a personalized finish.

# ZEPHYR

ZEPHYRONLINE.COM



Shown with overlay panel and custom handles (not included)

### How Presrv™ Stands Out:

-7°-65°

#### PreciseTemp™

Multiple internal sensors help maintain accurate temperatures and increase overall performance



#### Preset Temperature Modes

Each drawer can be converted to a fridge (32°F to 45°F), freezer (-7°F to 7°F), or pantry (46°F to 65°F) for ultimate flexibility



#### Inverter Compressor

Uses a BLDC motor to achieve lower temperatures while using less energy and performing more quietly than a fixed speed compressor



#### Soft-Close Drawers

Close more smoothly and quietly to prevent shifting of drawer contents

### Overlay Panel Dimensions\*

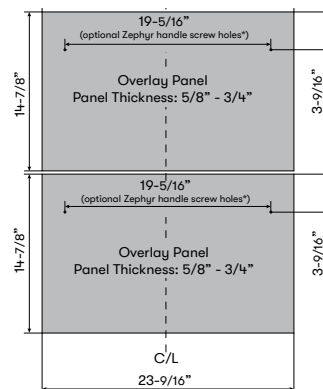

\* Hole locations are compatible with Zephyr handle accessory models PRHAN-Cxxx

## MODEL

Dual Zone

Refrigerator/Freezer Drawers

PRRFD24C2AP

## Size

24"

## Dimensions

23-7/8"W x 33-7/8"H x 24"D

## Weight

124

## Installation Type

Compact / Built-in

## Refrigerant Type

R600a

## FEATURES

Volume 3.9 cu/ft

Temperature Range -7° - 65° F (each zone)

Sound Level 37 dBA

Exterior Drawer Finish Panel-Ready no handle

Interior Drawer Finish Stainless Steel

Exterior Cabinet Finish Black

Interior Cabinet Finish Black

Full-Extension Drawers Yes

Soft-Close Drawers Yes

Removable Silicone Drawer Mats Yes

Drawer Organization Adjustable Bar Dividers +

Transparent Drawer Tray

Lighting 3-Color LED Lighting

Controls Backlit LED Electronic Touch

Preset Temperature Modes Freezer, Fridge, Pantry

Control Panel Lock Yes

Door Open Alarm Yes

Dual Evaporators Yes

Inverter Compressor\* Yes

Sabbath Mode Yes

ENERGY STAR® Certified Yes

PreciseTemp™ Yes

Active Cooling Technology Yes

## AC POWER

115V, 60Hz at Max. 1.5A

## OPTIONAL ACCESSORIES

Contemporary Handle\*\* PRHAN-C101 (Stainless Steel, x1)

Contemporary Handle\*\* PRHAN-C102 (Brushed Gold, x1)

Contemporary Handle\*\* PRHAN-C104 (Matte Black, x1)

Pro Handle\*\* PRHAN-C001 (Stainless Steel, x1)

Pro Handle\*\* PRHAN-C003 (Brushed Gold, x1)

Pro Handle\*\* PRHAN-C004 (Matte Black, x1)

## WARRANTY

2 years parts, 2 years labor

5 years compressor

\*An inverter compressor uses a BLDC motor to achieve lower temperatures while using less energy and performing more quietly than a fixed speed compressor

\*\*1 handle included, 2 handles needed

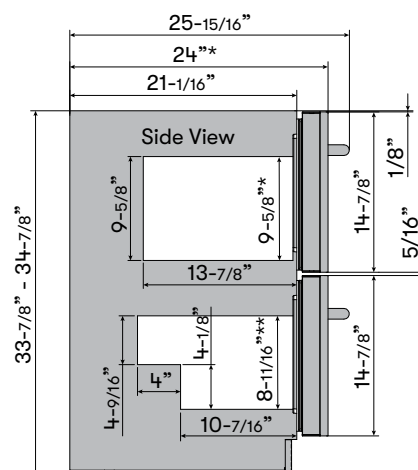
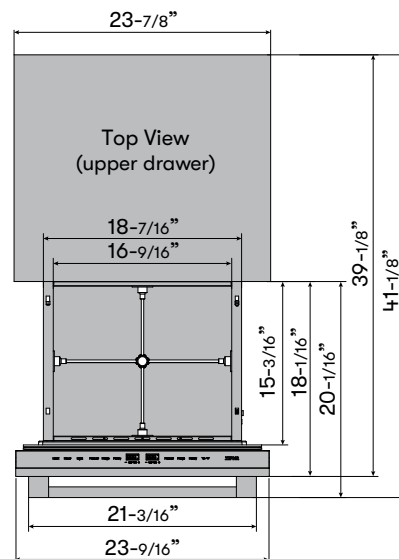

\*Depth with 3/4" thick overlay panel

\*\*Maximum clearance height inside drawers is 12"

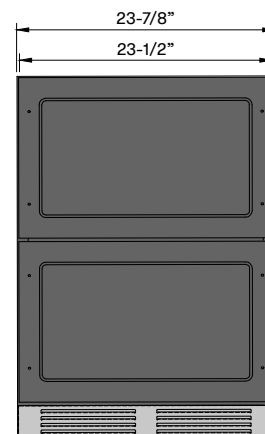

## Transforming the Kitchen through Design, Discovery, and Care

Specifications subject to change, check zephyronline.com for up-to-date information.  
Zephyr | 2277 Harbor Bay Parkway, Alameda, CA 94502 | 888.880.8368

AUG25.0301

