

Sola™ 6817 Multifunction Cabinet

bdiusa.com
customerservice@bdiusa.com



Product Registration

Registering your new BDI product allows us to send you important product updates, service information and helpful hints related to your BDI products. Register today and you will be entered to win free a BINK table from BDI. www.bdiusa.com/product-registration/

Placement and Maintenance

Sola™ Office furniture is designed for indoor use on level floors. Clean surfaces with a moist cloth.

Your Sola™ Office furniture is engineered for easy assembly. Carefully follow this procedure to prevent any damage. Do not use power tools for assembly of this product.

Step 1

Unpack and identify the parts listed below. The assembly workspace should be a non-marring surface such as carpet. For missing hardware pieces, please contact BDI Customer Service at: customerservice@bdiusa.com. For all other concerns, please contact your BDI retailer.

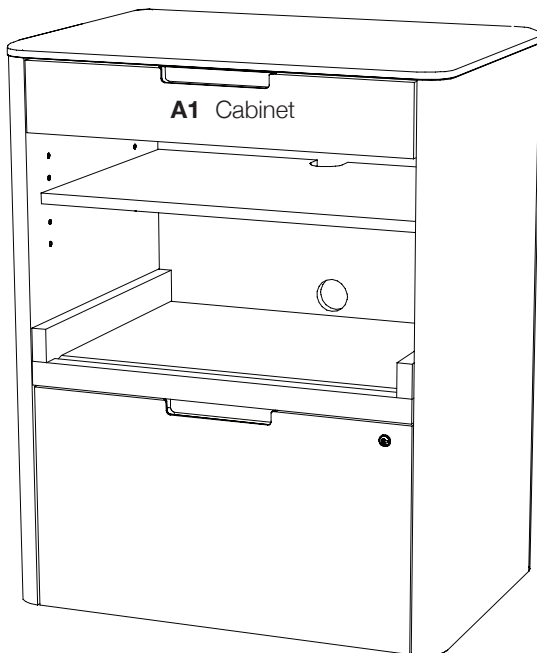

Tool Required:

Phillips screwdriver

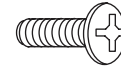
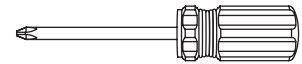

H5 Phillips Machine
Screw x 20

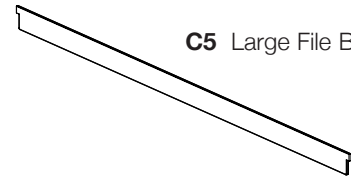

C5 Large File Bar x 1



C6 File Bar Clip x 2

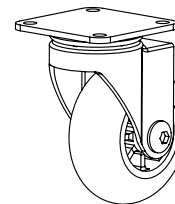

C7 Small Swivel Caster
x 1

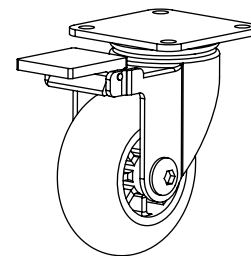

C8 Locking Swivel
Caster x 4

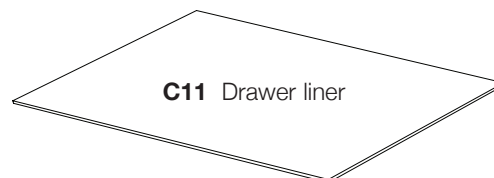

C11 Drawer liner

Designed by Matthew Weatherly.

These distinctive product configurations are protected by US and international patents, trade dress, and/or copyright laws. Sola & BDI are trademarks of Becker Designed, Inc. All rights reserved. ©2018, BDI

Patent: www.bdiusa.com/ip

Made in China. 6.14.2018 V1

Step 2 - Lay **Cabinet** on its back side. Attach **4 swivel locking casters C8** to the corners of the cabinet bottom panel using **16 screws H5** and tighten with a Phillips screwdriver. Attach **small swivel caster C7** to the drawer block as shown using **4 screws H5**.

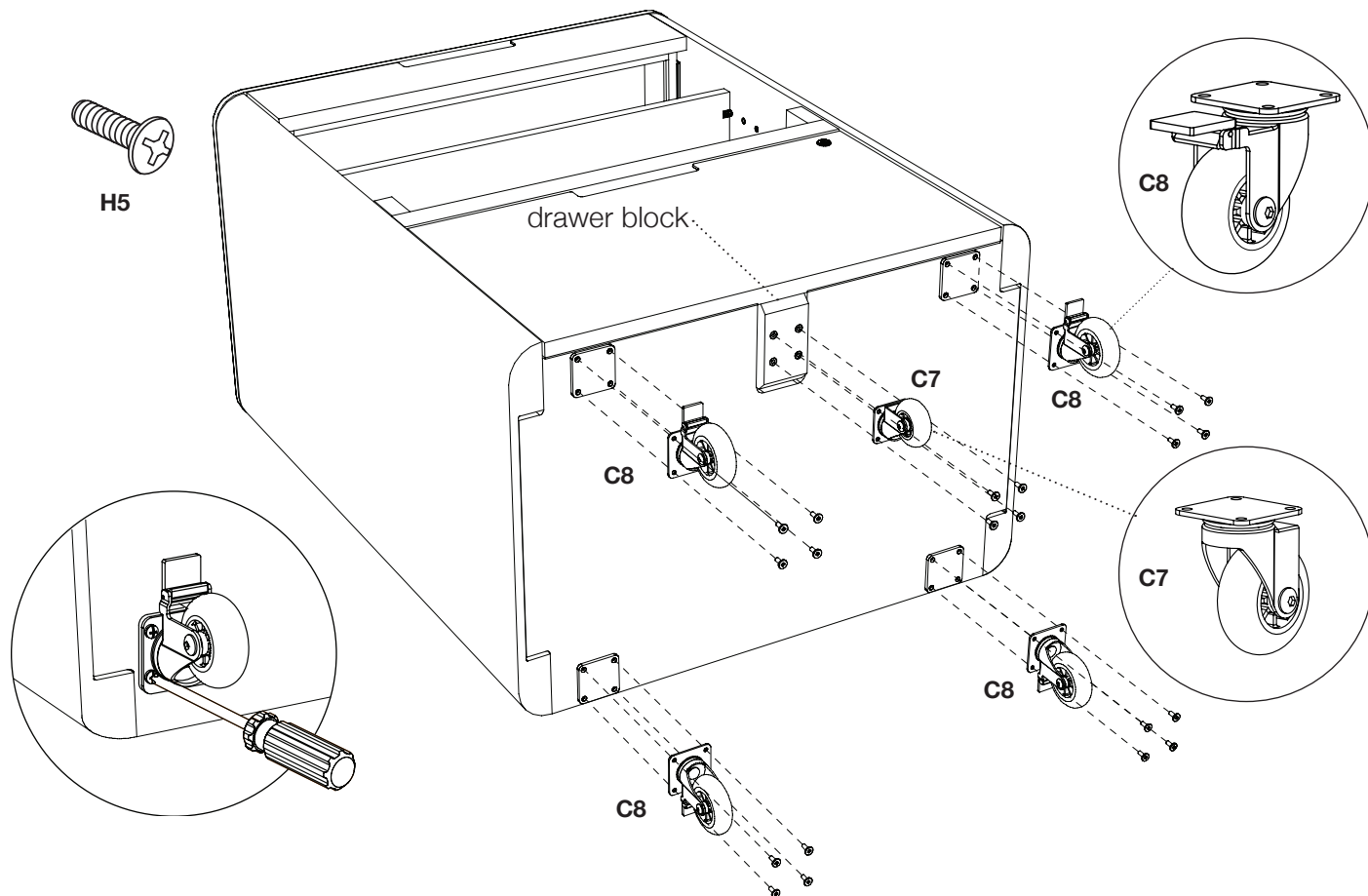

Step 3 - Adjust shelf if needed

The shelf position can be adjusted by unscrewing the 4 shelf pins and moving them up or down to the desired level.

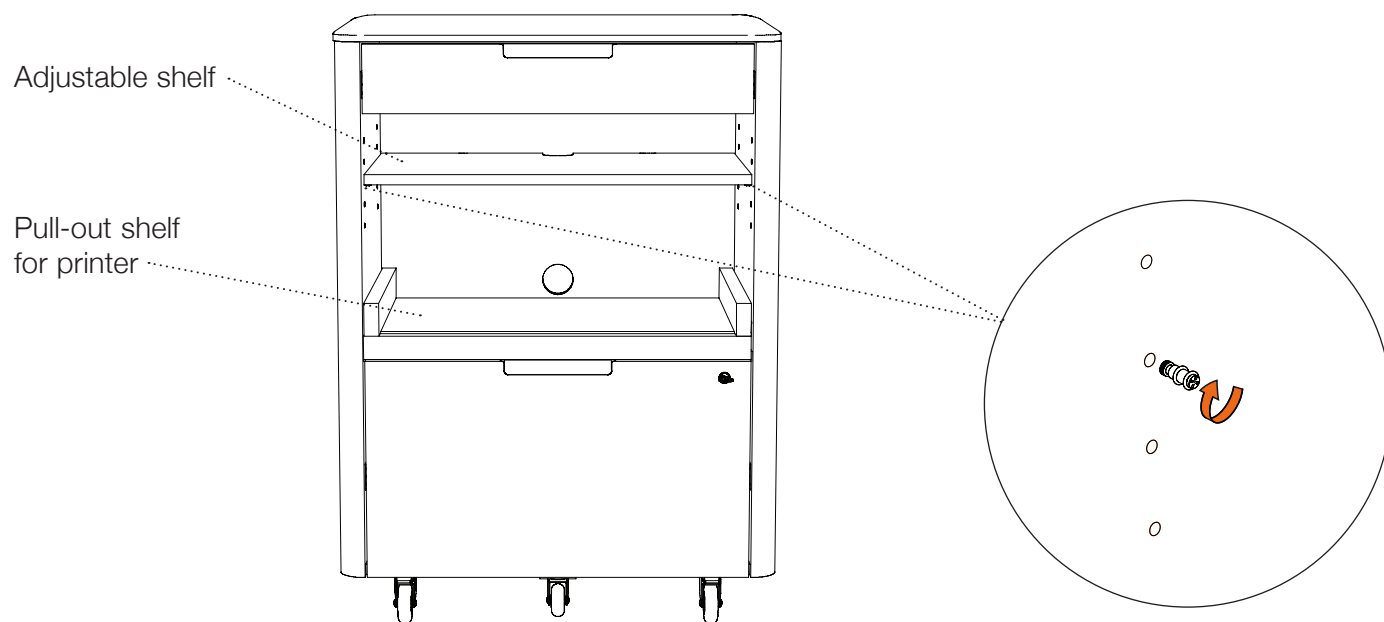

Step 4 - File Bar Installation (Letter File)

For letter files facing sideways, attach **File Bar Clip C6** to both ends of **Large File Bar C5** as shown. Place the file bar assembly in the notches located on the left and right drawer side panels. For legal files, remove the Large File Bar and hang file folders on the front and rear rails.

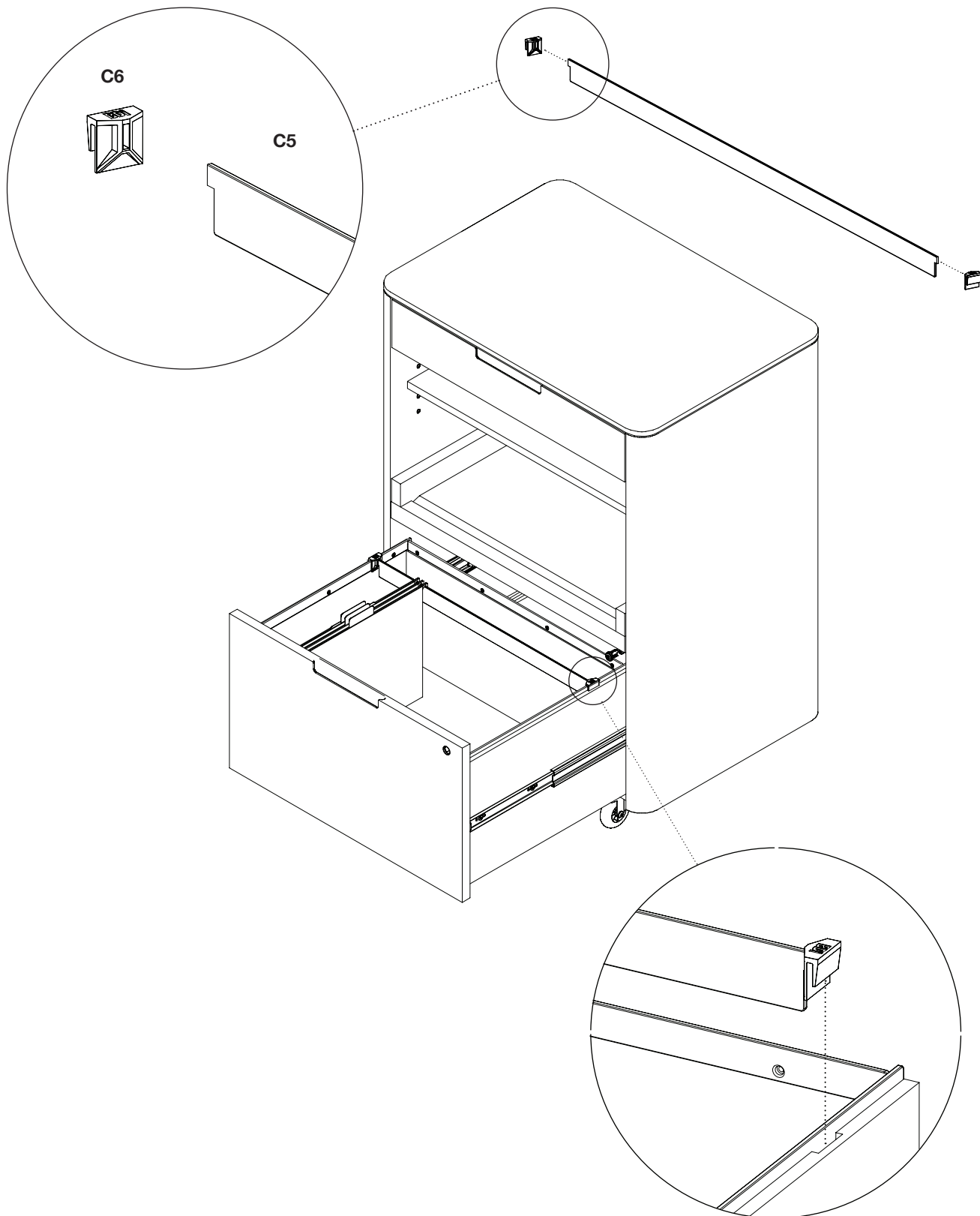

Step 5 - Install Drawer Liner

Open the top drawer and install the drawer liner. Place grippy side down.

