

## Description

Savant's in-wall wired charging dock for iPad®, ICC-2P00, transforms the Apple iPad® into a cost-effective wired in-wall touch panel.

The in-wall charging dock for iPad is comprised of an in-wall docking cradle paired with a low profile magnetically attached faceplate.

The iPad is powered via the dock, and its touch screen is used for navigation and control.

The ICC-2P00 supports Power-over-Ethernet (PoE) using the IEEE 802.3at standard.

The in-wall charging dock for iPad is comprised of an in-wall docking cradle paired with a low profile magnetically attached faceplate. The iPad is powered via the dock, and its touch screen is used for navigation and control.

## Feature Summary

- In-Wall Charging Dock (iPad® not included)
- Transforms an iPad into a fixed wired In-Wall Touch Panel
- Portrait or landscape installation
- PoE network powered (IEEE 802.3at)
- Scalable and expandable—add multiple in-wall charging docks through the installation
- Removable magnetically attached bezels
- Bezels available in white, black, almond or paintable primer finish
- Made for iPad WiFi/ Made for iPad 3G models
- Cost-effective solution that is simple to install—ideal for retrofits
- Readily placed in strategic installations
- Configured and customized using RacePoint Blueprint™



**Front View of ICC-2P00 (iPad® not included)**

009-0596-00

## Dimensions

The next figures show the dimensions of the ICC-2P00.

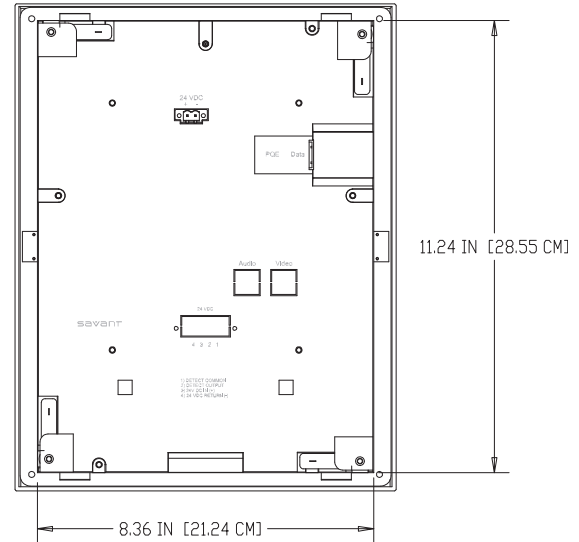
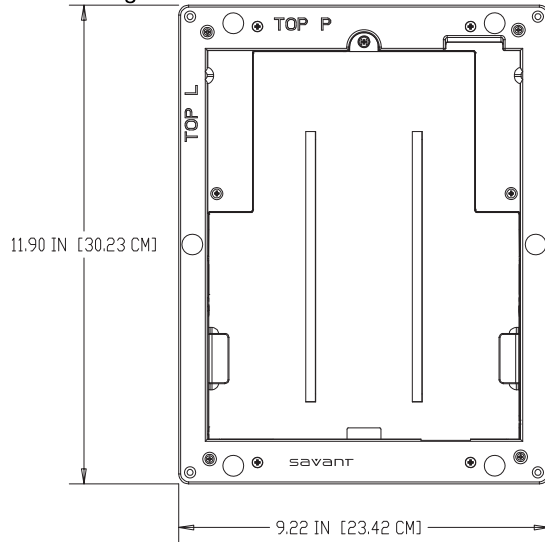

NO BEZEL

### Rear Views of ICC-2P00 (above)

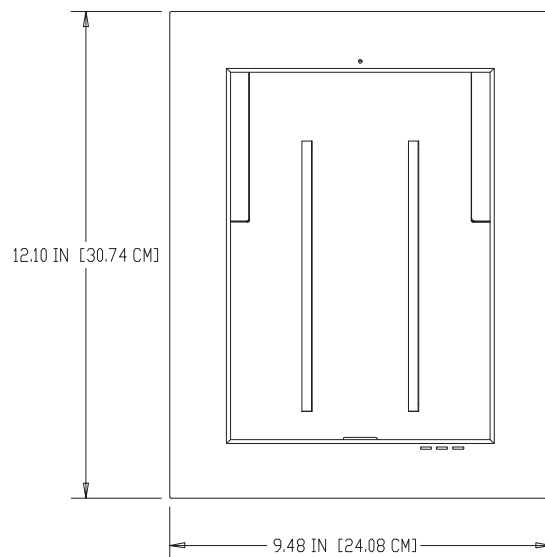

WITH BEZEL

### Front View of ICC-2P00

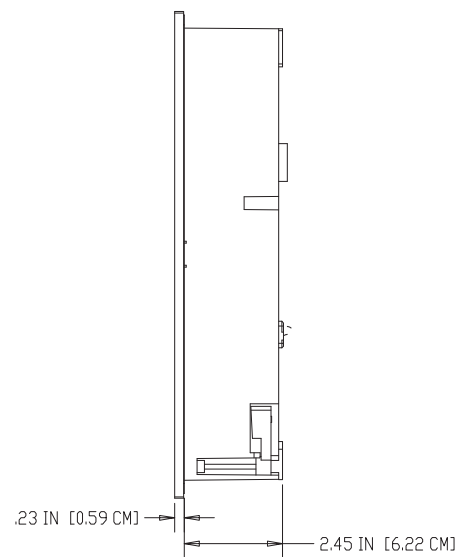

### Side View of ICC-2P00

## Specifications

009-0596-00

| Environmental         |  |
|-----------------------|--|
| Temperature           | 32° to 104° F (0° to 40° C)  |
| Humidity              | 10% to 90% RH (non-condensing)   |
| Dimensions and Weight |  |
| Height (with bezel)   | 12.10 in/30.74 cm  |
| Width (with bezel)    | 9.48 in/24.08 cm   |
| Depth                 | 2.45 in/6.22 cm plus .23 in/ .59 cm for bezel  |
| Weight                | 0.5 lb (0.26 kg)   |
| Power                 |  |
| Supply                | Power-over-Ethernet (PoE) using the PoE IEEE 802.3at standard                                    |
| Maximum Power Draw    | 16 Watts   |
| Compliance            |  |
| Safety and Emissions  | FCC Part 15<br>CE Mark<br>C-Tick   |
| RoHS                  | Compliant  |
| Rear Panel            |  |
| PoE/Ethernet          | RJ-45 10/100 Base-T<br>Power-over-Ethernet using the PoE IEEE 802.3at standard. See next figure. |

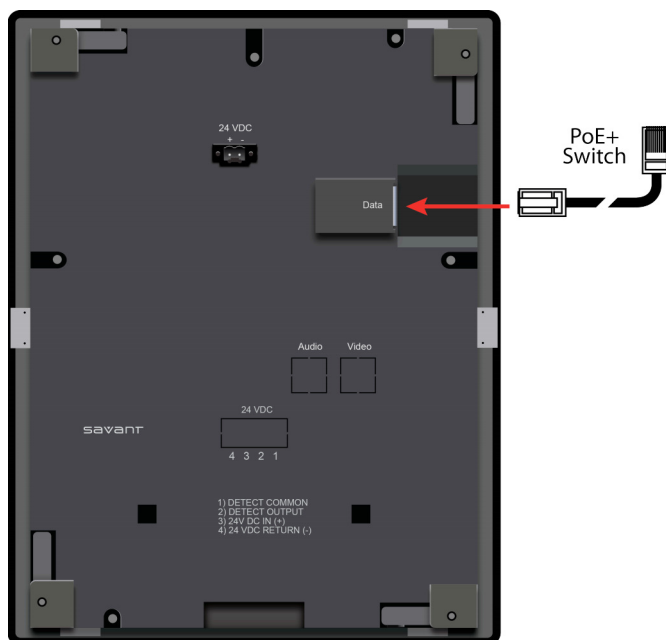

For the Power over Ethernet switch (in figure left), the TIA/IA-568-B. 1-2001 standard is used.

## Included Items

The items included with the ICC-2P00 are outlined in the next table.

| Description                      | Quantity |
|----------------------------------|----------|
| #8-32 X 2.25 Phillips Pan Screws | 4        |
| #6 X 1.5 Phillips Flat Screws    | 4        |
| Cut-out Template                 | 1        |
| Adaptor for the iPad2            | 1        |
| Instructions for iPad2 Adaptor   | 1        |
| Quick Reference Guide            | 1        |

## Required System Components

The system components required for use with the ICC-2P00 are outlined in the next table.

| Description      | Model Number                        |
|------------------|-------------------------------------|
| Host Controller  | HST-4001, HST-4002 or SVR-4100      |
| Ethernet Network | Enterprise-grade network deployment |

## Optional Accessories

The optional accessories available for use with the ICC-2P00 are outlined in the next table.

| Description  | Model Number |
|--|--------------|
| Pre-construction box   | RIB-IWCD     |
| Black In-Wall bezel for iPad (single pack)                   | BZB-1IPAD    |
| White In-Wall bezel for iPad (single pack)                   | BZW-1IPAD    |
| Almond In-Wall bezel for iPad (single pack)                  | BZA-1IPAD    |
| Paintable Primer Finish In-Wall bezel for iPad (single pack) | BZP-1IPAD    |
| Black In-Wall bezel for iPad (five pack)                     | BZB-5IPAD    |
| Black In-Wall bezel for iPad (five pack)                     | BZB-5IPAD    |
| White In-Wall bezel for iPad (five pack)                     | BZW-5IPAD    |
| Almond In-Wall bezel for iPad (five pack)                    | BZA-5IPAD    |
| Paintable Primer Finish In-Wall bezel for iPad (five pack)   | BZP-5IPAD    |

Copyright © 2012 Savant Systems, LLC. SAVANT and RacePoint Blueprint are trademarks of Savant Systems, LLC.

All brand names, product names and trademarks are the property of their respective owners.

Savant Systems, LLC reserves the right to change product specifications without notice.