

48-Inch Dual-Fuel Steam Range with Embedded Griddle

TRANSITIONAL



DOP48T963DS/DA – Silver Stainless, Natural Gas/Liquid Propane

Features & Benefits

- Dual Four-Part Pure Convection system
- Simmersear™ brass burners
- Steam-assist oven
- Motorized 7" LCD control panel with SmartThings Wi-Fi connectivity
- Embedded electric griddle
- Auto Connect to compatible ventilation through Bluetooth
- Air sous vide
- Digital temperature probe
- Self-clean oven
- Perma-Flame
- LP conversion kit
- Voice commands through Bixby/Alexa/Google

Controls

| | |
|-------------------------------------|--------------------------------------|
| CONTROL TYPE | 7" Motorized LCD Touchscreen & Knobs |
| CHEF MODE™ GUIDED COOKING | Yes |
| ILLUMINA™ KNOBS | White |
| WI-FI + SMARTTHINGS | Yes |
| BLUETOOTH AUTO CONNECT™ VENTILATION | Yes |
| CONTROL SHOWER LIGHTING | Yes |
| CLOCK | Yes |
| DELAY START | Yes |
| KITCHEN TIMER | Yes |
| CHILD LOCK | Yes |
| SABBATH MODE | Yes |

| Oven | |
|---------------------------|----------------------------------------------------|
| OVEN CAPACITY (CU. FT.) | 6.4 (Large Oven), 2.4 (Small Oven) |
| CONVECTION | Dual Four-Part Pure Convection |
| STEAM | Steam Assist |
| BAKE ELEMENT | 3,000W - 8 Pass (Large Oven), 1,000W (Small Oven) |
| BROIL ELEMENT | 4,400W - 10 Pass (Large Oven), 2,400W (Small Oven) |
| CONVECTION ELEMENT | 2 x 1,300W (Large Oven), 1,300W (Small Oven) |
| INSTANTHEAT™ (NO PREHEAT) | Yes |
| TEMPERATURE PROBE | Yes |
| LIGHTING | Brightvue™ - LED & Halogen |
| SELF-CLEAN | Self-Clean, GreenClean™ |
| SOFTSHUT™ | Yes |

| Cooktop | |
|---------------------------------|--------|
| NUMBER OF BURNERS | 6 |
| PERMA-FLARE™ (AUTO RE-IGNITION) | Yes |
| LEFT FRONT (BTU) | 18,000 |
| LEFT REAR (BTU) | 16,000 |
| CENTER FRONT (BTU) | 22,000 |
| CENTER REAR (BTU) | 9,000 |
| RIGHT FRONT (BTU) | 16,000 |
| RIGHT REAR (BTU) | 16,000 |
| BRASS BURNING CAPS | Yes |
| GRIDDLE | 1,630W |
| WOK RING | Yes |

| Weights & Dimensions | |
|------------------------------------------|----------------------|
| NET WEIGHT (LBS.) | 578 |
| SHIPPING WEIGHT (LBS.) | 660 |
| PRODUCT DIMENSIONS (W X H X D IN INCHES) | 47-7/8 x 36 x 28-3/4 |

| Technical Details | |
|------------------------------|-----------------------------|
| ELECTRICAL REQUIREMENT | 240V, 60 Hz |
| AVAILABLE FUEL TYPES | Natural Gas, Liquid Propane |
| LP CONVERSION KIT (INCLUDED) | Yes |

| Warranty | |
|---------------|---------|
| FULL COVERAGE | 2 Years |

48-Inch Dual-Fuel Steam Range with Embedded Griddle

TRANSITIONAL



Product Dimensions

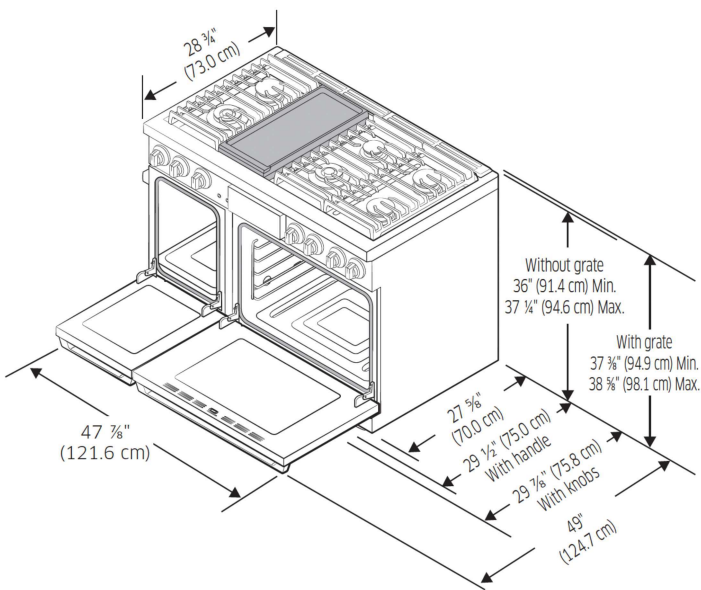

Installation Requirements

| | |
|--------------------------------------|------------------------------------------------|
| A - ELECTRICAL OUTLET (IN/CM) | 9 7/8" (W) x 6 5/8" (H) (25.1 cm x 17.5 cm) |
| B - GAS PIPING (IN/CM) | 17 15/16" (W) x 5 3/8" (H) (45.5 cm x 13.8 cm) |

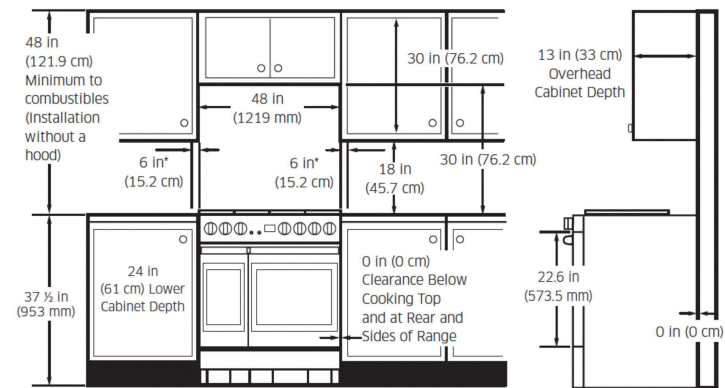

* Side clearance above cooking surface to any objects, i.e., wall.

