

# XO SINK PRO NANOGRIND

DISPOSAL SYSTEMS

TWO  
BUTTON  
OPTIONS



CATEGORY:  
Continuous Feed

## XODAIRSWITCH

The Remote Air Switch is a simple, reliable way to have a convenient activation switch next to the sink for your Disposer. Because the push button works using air pressure, it keeps electricity away from the area immediately around the sink, so it is inherently safer. It is only used with CONTINUOUS FEED Disposers. The product is easily installed and comes with two different, popular button finishes to match your decor.

MODEL: XODAIRSWITCH

OVERALL

2 7/8"  
W

6"  
H

1 7/8"  
D

ROUGH IN/CUT OUT

W

H

D

CATEGORY: Continuous Feed **Optional Accessory**

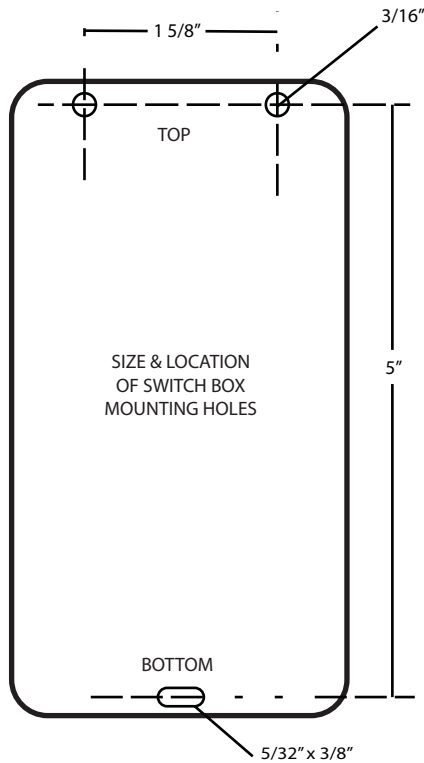

**Switch Box Mounting Holes**  
 The switch box has a rear flange with two (2) mounting holes at the top and one (1) mounting hole at the bottom to allow it to be fastened to the wall.

Mounting screws are not included.

**BUTTON MOUNTING HOLE**

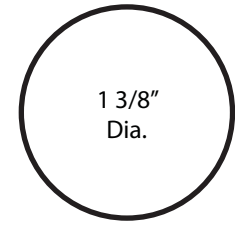

Standard size 1 3/8" faucet hole is required for the remote button.

For counters 1 3/8" thick or less, use lock nut supplied to fasten button in place.  
 For counters up to 1 1/2" thick use silicon sealant to hold button in place.

**1 YEAR WARRANTY**  
 Limited warranty see website for details

**LOVE IT OR LEAVE IT**  
**100% GUARANTEED**  
 For 90 days, all our products are backed by our unique Love It or Leave It Guarantee

**PRODUCT HIGHLIGHTS**

- Safe - Air Operated
- Easy to Install - no wiring required
- Includes two popular finish buttons

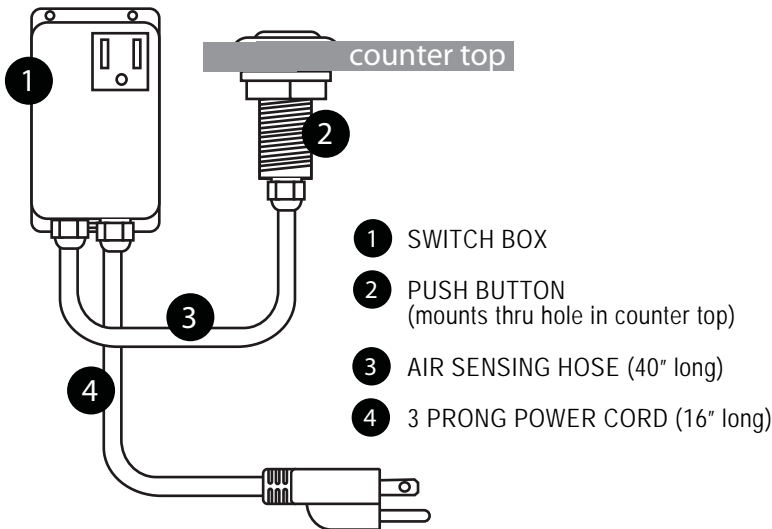

**SPECIFICATIONS**

- Use with all Continuous Feed Disposals
- 16" Long Prong Power Cord / 40" Long Air Hose
- Button Mounts in 1 3/8" Hole in Countertop  
Switch Box Mounts Under Sink
- 115 V / 60 Hz
- All XO Disposals are UL Listed

**XO** the next level in luxury appliances  
[www.xoappliance.com](http://www.xoappliance.com)

XO is exclusively distributed through  
 EASTERN MARKETING CORP.  
 24 Eisenhower Parkway, Roseland, NJ 07068  
 p. 973. 403.8900