

# PINAR140SS

Hood Insert



This model provides professional grade performance, while being discreetly mounted inside the cabinetry. It is available with a 1200 CFM blower for extraordinary ventilating power.

Plus the All-In-One design avoids the need purchase a stainless steel liner. Hidden metallic in/out knob controls operate the 4-speed blower and LED lighting. A cleaner kitchen is ensured by angled traditional baffle filters.

\*Damp Location Approved.

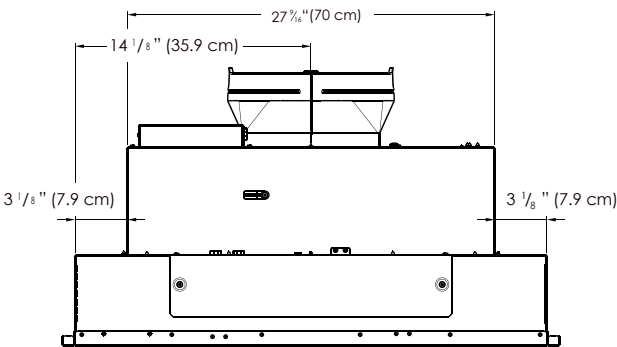
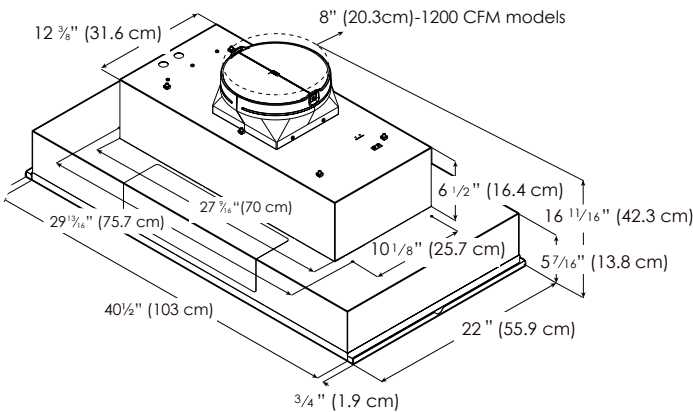

### SPECIFICATIONS

|  |  |
|--|--|
| Width:   | 40" Unit   |
| Model:   | PINAR140SS   |
| Cut-Out Dimensions:                              | 40 1/2"W x 22"D  |
| Blower Type(internal):**                         | 1200 CFM(4-speed)  |
| Noise (sones):**                                 | 2.5 - 8.5 Sones  |
| Finish:  | Stainless Steel  |
| Controls:  | Fully Retractable Rotating Knobs with White Backlighting                                   |
| Illumination:<br>(Replaceable Lamps 1 Intensity) | 4 LED, 6.5 Watts 3000 KELVIN 540 LUMEN/Lamp  |
| Grease Filter:                                   | (2) Grease Collecting Stainless Steel Baffle   |
| Duct Transition:                                 | 8" Round with Backdraft Damper (top only)  |
| Installation Type:                               | Ducted or Recirculating with Kit   |
| Mounting Height Range:                           | Electric ≥ 24", Gas ≥ 30"  |
| Electrical:                                      | 120V - 60 Hz, 913 Watts  |
| ACCESSORIES:                                     |  |
| External Blower Shell Kit:                       | ACC0179547 (8" or 10" duct size compatible, for use with 1200 cfm models)                  |
| Inline Blower Shell Kit:                         | ACC0179549 (8" or 10" duct size compatible, for use with 1200 cfm models)                  |
| RECIRCULATING KIT:                               |  |
| Carbon Filters:                                  | ACC0192765 ( Contains 4 round carbon filters )   |
| Metal Deflector:                                 | ACC0192763 (8" round metal deflector for 1200 CFM models)                                  |
| Transition Reducer Kit:                          | ACC0185271 (10" round down to 8" round - attaches to 10" round transition supplied w/ hood |
| WARRANTY:  | Two (2) years parts & in-home labor  |

### FEATURES



Quiet system - Specialized technology that allows reducing sound levels of your hood, which can effectively decrease noise by more than 35%.



Grease Collecting Baffle Filters - Intended for high airflow cooking. Their "S" shape design and Stainless Steel finish is crafted to capture significant amounts of grease.



Thermal barrier - The system detects extreme temperatures above 158 degrees and automatically increases the blower speed to HIGH.



Fine precision - Constructed with great attention to detail with High-quality stainless steel, result in a seamless and flawless finish.



Superior performance - High performance ventilation with a 1200 CFM Blower.

### AIRFLOW CONTROL

Air Flow Control technology enables the user to reduce the maximum blower CFM of your hood achieving <300 CFMs, to meet local code requirements.

This model includes an Electronic Bypass Kit that needs to be placed at the moment of installing.