

....

.....DF9D'H56 @'

---

PNC      MODEL

738G FAWA SÔPT VÍ €

| <b>Pag.</b> | <b>Indice</b> | <b>Index</b>     |
|-------------|---------------|------------------|
| 2           | Disegni       | Drawings         |
| 3           | Lista ricambi | Spare parts list |

**Brand / Marchio:** KELVINATOR

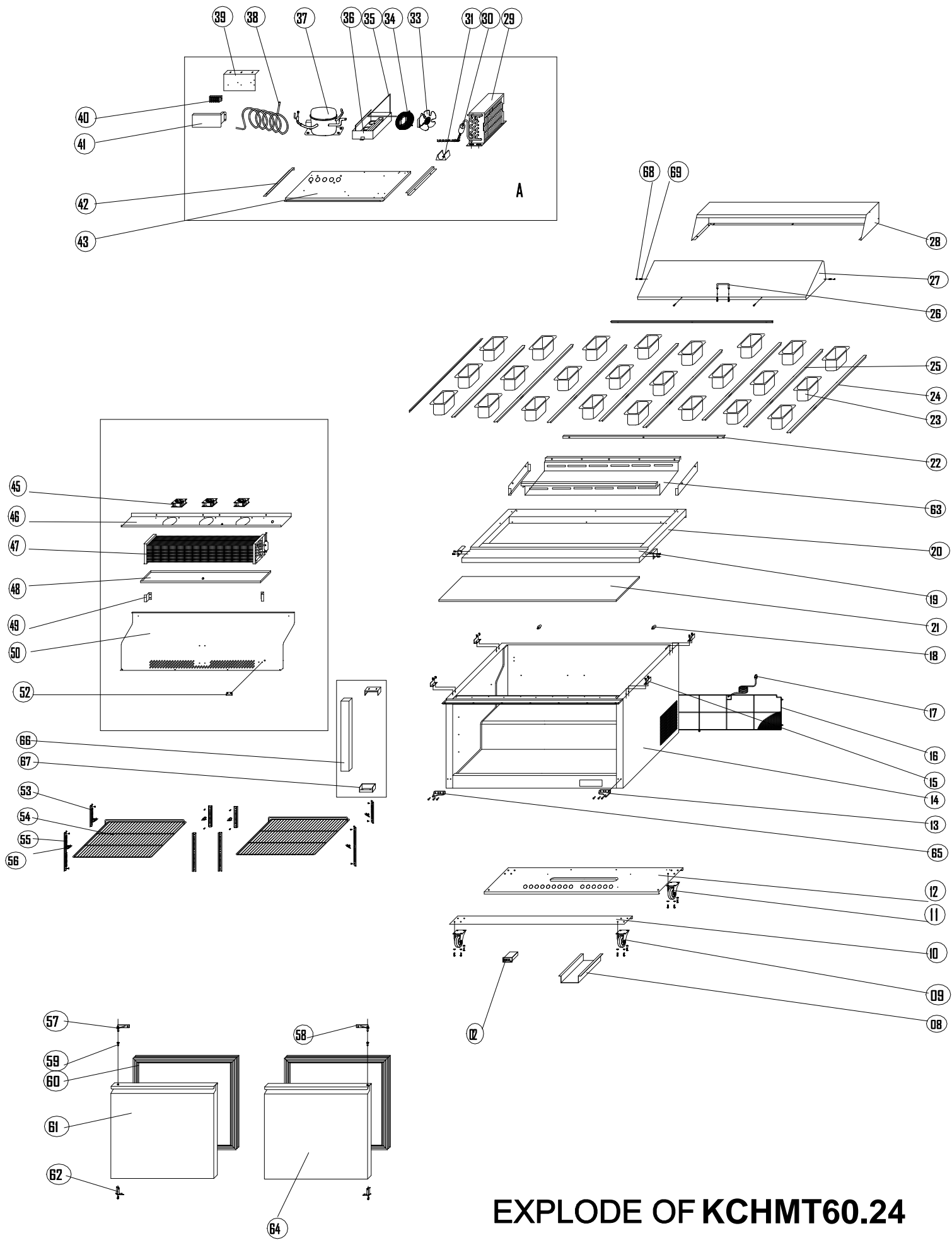

**EXPLODE OF KCHMT60.24**

**SPARE PARTS LIST OF KCHMT60.24**

| NO. | ELECTROLUX PNC | NAME                                 | ERP                          | QUY.  | MATERIAL         | REMARK       |
|-----|----------------|--------------------------------------|------------------------------|-------|------------------|--------------|
| 2   | 0USF42         | THERMOSTAT CONTROLLER                | 104020039                    | 1PC   |                  | D20-001M     |
|     | 0USC4C         | Inner Chest Temperature Sensor Probe | XR20C-TempSensorProbe-738263 | 1PC   |                  | BLACK        |
| 8   | 0USK07         | CABLE COVER                          | 5202003668                   | 1PC   |                  |              |
| 9   | 0USF03         | BRAKE WHEEL                          | 107050008                    | 2PCS  |                  |              |
| 10  | 0USJ61         | FRONT SUPPORT OF UNIT BOARD          | 5201006358                   | 1PC   |                  |              |
| 11  | 0USH63         | NORMAL WHEEL                         | 107050007                    | 2PCS  |                  |              |
|     | 0USK99         | Castor Mounting Bolt                 | 107210131                    | 16PCS | Galvanized STEEL | Hexagon Head |
|     | 0USL00         | Castor Mounting Locking Washer       | 107210244                    | 16PCS | Galvanized STEEL |              |
|     | 0USL01         | Castor Mounting Flat Washer          | 107210224                    | 16PCS | Galvanized STEEL |              |
| 12  | 0USJ62         | BACK SUPPORT OF UNIT BOARD           | 5201006359                   | 1PC   |                  |              |
| 13  | 0USF81         | LOWER DOOR HINGE/RIGHT               | 114020122                    | 1PC   |                  |              |
| 14  |                | BODY                                 | 5102002396                   | 1PC   |                  |              |
| 15  | 0USL80         | TOP CLIP                             | 5201007056                   | 4PCS  |                  |              |
| 16  | 0USI10         | UNIT ROOM COVER                      | 109040075                    | 1PC   |                  |              |
| 17  | 0USH67         | PLUG                                 | 104050013                    | 1PC   |                  |              |
| 18  | 0USH46         | LOCATION KNOB                        | 114010039                    | 2PCS  | RUBBER           |              |
| 19  | 0USG68         | FIXED CLIP OF CUTTING BOARD          | 5202003562                   | 2PCS  |                  |              |
| 20  | 0USH97         | TOP                                  | 5108000362                   | 1PC   |                  |              |
| 21  | 0USF49         | CUTTING BOARD                        | 106120007                    | 1PC   |                  |              |
| 22  | 0USJ35         | PAN SUPPORT /FRONT                   | 5203000287F                  | 1PC   |                  |              |
|     | 0USDEM         | PAN SUPPORT /BACK                    | 5203000287B                  | 1PC   |                  |              |
| 23  |                | STANDARD PAN                         | 106070007                    | 24PCS |                  |              |
| 24  | 0USM80         | PAN SUPPORT /LEFT/RIGHT              | 5203000114                   | 2PCS  |                  |              |
| 25  | 0USJ31         | PAN SUPPORT                          | 5203000183                   | 7PCS  |                  |              |
| 26  | 0USH09         | HANDLE OF COVER                      | 107210314                    | 1PC   | STAINLESS        |              |
| 27  | 0USH61         | MOVING COVER                         | 5202003600                   | 1PC   |                  |              |
|     | 0USL39         | MOVING COVER LINER                   | 5202005297                   | 1PC   |                  |              |
| 28  | 0USG72         | FIXED COVER                          | 5202003598                   | 1PC   |                  |              |
|     | 0USL70         | FIXED COVER LINER                    | 5202005296                   | 1PC   |                  |              |
| 29  | 0USF34         | CONDENSER                            | 113010368                    | 1PC   |                  |              |
| 30  | 0USG66         | FILTER DRIER                         | 107180004                    | 1PC   |                  |              |
| 31  | 0USI78         | DRIER SUPPORT                        | 108300116                    | 1PC   |                  |              |
| 32  | 0USM13         | CAPILLARY                            | 102050022                    | 1PC   |                  |              |
| 33  | 0USF40         | CONDENSER FAN                        | 104030019                    | 1PC   |                  |              |
|     | 0USC4J         | CONDENSER FAN BLADE                  | 104040001                    | 1PC   |                  |              |
| 34  | 0USI46         | BASKET GUARD GRILLS                  | 109030031                    | 1PC   | COATED STEEL     |              |
| 35  | 0USG14         | EVAPORATE PIPE                       | 113110265                    | 1PC   | COPPER           |              |
| 36  | 0USI29         | WATER BOX                            | 108140003                    | 1PC   | PLASTIC          |              |
| 37  | 0USF28         | COMPRESSOR                           | 104010249                    | 1PC   |                  |              |
| 38  | 0USH80         | SUCTION PIPE                         | 113100583                    | 1PC   | COPPER           |              |
| 39  | 0USDEE         | CONNECTOR SUPPORT                    | 5202003663                   | 1PC   |                  |              |
| 40  | 0USF09         | CABLE CONNECTOR                      | 104110005                    | 1PC   |                  |              |
| 41  | 0USJ98         | CONNECTOR COVER                      | 5202003545                   | 1PC   | ZINC             |              |
| 42  | 0USK50         | GUIDE OF UNIT BOARD/LEFT             | 5203000284                   | 1PC   |                  |              |
|     | 0USK49         | GUIDE OF UNIT BOARD/RIGHT            | 5203000283                   | 1PC   |                  |              |
| 43  | 0USK32         | UNIT BOARD                           | 5202004723                   | 1PC   |                  |              |
| 44  | 0USL13         | AIR FLOW CONDUCT BOARD               | 101060199                    | 2PCS  |                  |              |
| 45  | 0USF14         | CIRCLE FAN                           | 104030041                    | 3PCS  |                  |              |
| 46  | 0USK03         | CIRCLE FAN SUPPORT                   | 5202003595                   | 1PC   |                  |              |
| 47  | 0USG30         | EVAPORATOR                           | 5112000396                   | 1PC   |                  |              |
|     | 0USC6R         | Evaporator Temperature Sensor Probe  | XR20C-TempSensorProbe-738264 | 1PC   |                  | WHITE        |
| 48  | 0USG55         | EVAPORATOR WATER PAN                 | 5202003706                   | 1PC   | STAINLESS        |              |
| 49  | 0USK05         | FIXED SUPPORT OF EVAPORATOR COVER    | 5202003659                   | 2PCS  | STAINLESS        |              |
| 50  | 0USK02         | EVAPORATOR COVER                     | 5202005295                   | 1PC   | ss304            |              |
| 52  | 0USM10         | SENSOR FIXED CLIP                    | 108110315                    | 1PC   | PLASTIC          | GRAY         |
| 53  | 0USI66         | SHELF SUPPORT B                      | 107100019                    | 4PCS  | STAINLESS        |              |
| 54  | 0USC0K         | SHELF                                | 109020221                    | 2PCS  |                  |              |
| 55  | 0USI44         | SHELF SUPPORT A                      | 107100018                    | 4PCS  | STAINLESS        |              |
| 56  | 0USH19         | K SHAPE CLIP                         | 107090002                    | 8PCS  |                  |              |
| 57  | 0USI16         | UP HINGE/LEFT                        | 114020126                    | 1PC   |                  |              |
| 58  | 0USI17         | UP HINGE /RIGHT                      | 114020125                    | 1PC   |                  |              |
| 59  | 096268         | BUSHING                              | 108300029                    | 2PCS  | PLASTIC          |              |
| 60  | 0USG95         | GASKET                               | 108270292                    | 2PCS  | PVC              |              |
| 61  | 0USF67         | DOOR/LEFT                            | 5107001008                   | 1PC   |                  |              |
| 62  | 0USF83         | DOOR SPRING HINGE                    | 114030084                    | 2PCS  |                  |              |

**SPARE PARTS LIST OF KCHMT60.24**

|    |        |                          |             |      |  |  |
|----|--------|--------------------------|-------------|------|--|--|
| 63 | 0USK04 | CONDUCT BOARD            | 5202006368  | 1PC  |  |  |
|    | 0USL14 | CONDUCT BOARD SIDE PLATE | 5202006371  | 2PCS |  |  |
| 64 | 0USF69 | Door /Right              | 5107001007  | 1PC  |  |  |
| 65 | 0USF80 | LEFT DOWN HINGE          | 114020121   | 1PC  |  |  |
| 66 | 0USC6D | MIDDLE GIRDER            | 5118000269P | 1PC  |  |  |
| 67 | 0USH59 | MIDDLE GIRDER FIXER      | 108030547   | 2PCS |  |  |
| 68 | 0USG67 | FIXED BOLT               | 107210320   | 2PCS |  |  |
| 69 | 0USG73 | FIXED NUT                | 107070020   | 2PCS |  |  |
|    | 0USM14 | Shelf Support Screw      | 108300165   |      |  |  |

REV  
10.12.2020