



ALL REFRIGERATOR



MAR110W | MAR110BLS

Congratulations on the purchase of your new Marathon Refrigerator!

To activate your Warranty, please register your appliance at **www.stirlingmarathon.com** or by completing and mailing the enclosed Warranty Registration Card. We are confident you will have years of hassle free enjoyment and ask that you please retain the Use & Care Guide for future reference and your safety.





Before installing please, read your Use & Care guide carefully and pay special attention to the Safety & Warning information outlined in the following pages.

For immediate assistance: 1-844-309-9777
www.stirlingmarathon.com

Appliance Safety

Your safety and the safety of others are very important.

We have provided many important safety messages in this manual and on your appliance. Always read and obey all safety messages.

Icon	Caption	Description
	WARNING	Risk of serious injury or death
	RISK OF ELECTRIC SHOCK	Dangerous voltage
	FIRE	Risk of fire
	ATTENTION	Risk of injury or material damage
	IMPORTANT/NOTE	Information on correct operation of the system

Disposal of your old machine



The symbol on the product or on its packaging indicates that this product may not be treated as household waste. Instead it shall be handed over to the applicable collection point for the recycling of electrical and electronic equipment. By ensuring this product is disposed of correctly, you will help prevent potential negative consequences for the environment and human health, which could otherwise be caused by inappropriate waste handling of this product. For more detailed information about recycling of this product, please contact your local city office, your household waste disposal service or the shop where you purchased the product.

Important Safety Information



WARNING



Before installing please read your Use & Care Guide carefully and pay special attention to the Safety and Warning information outlined in the following pages.

To reduce the risk of fire, electrical shock, or injury follow these basic precautions when using your appliance.

- 1) **WARNING----**Keep ventilation openings, in the appliance enclosure or built-in structure, clear of obstruction.
- 2) **WARNING----**Do not use mechanical devices or other means to accelerate the defrosting process, other than those recommended by the manufacturer.
- 3) **WARNING----**Do not use electrical appliances inside the appliance
- 4) **WARNING----**DANGER: Never allow children to play with, operate, or crawl inside the appliance. Risk of child entrapment.

Before you discard or recycle your old freezer

- Completely remove the doors
 - Leaves the shelves in place so that children not may easily climb inside
- 5) **WARNING----GROUNDING INSTRUCTIONS** This appliance must be grounded. In the event of an electrical short circuit, grounding reduces the risk of electrical shock by providing an escape wire for the electrical current. This appliance is equipped with a cord having a grounding wire with a grounding plug. The plug must be plugged into an outlet that is properly installed and grounded.
 - 6) **DO NOT USE AN EXTENSION CORD**
 - 7) Use an exclusive 115V wall outlet. Do not connect your refrigerator to extension cords or together with any other appliance in the same wall outlet. Do not splice the cord.
 - 8) Always unplug before any maintenance or service on the appliance.
 - 9) If a component is damaged, it must be replaced by the manufacturer, its service agent or similar qualified persons to avoid a hazard.
 - 10) Follow local regulations regarding disposal of the appliance due to flammable refrigerant and blowing gas. All refrigeration products contain refrigerants, which under the guidelines of federal law must be removed before disposal. It is the consumer's responsibility to comply with federal and local regulations when disposing of this product.
 - 11) This appliance is intended to be used in household and similar environment such as:
 - Staff kitchen, workshop, office and other working environments;
 - Farmhouses and by clients in hotels, motels and other residential type environments;
 - Bed and breakfast type environments;
 - Catering and similar non-retail applications.
 - 12) Do not store or use gasoline or any inflammable liquors and liquids inside or in the vicinity of the refrigerator.
 - 13) Do not use an extension cord with this appliance. If the power cord is too short, have a qualified electrician install an outlet near the appliance. The use of an extension can negatively affect the appliance's performance.

Model Description

- 1) Control panel
- 2) Wine rack
- 3) Refrigerator shelves
- 4) Crisper cover
- 5) Crisper
- 6) Levelling feet
- 7) Large items bin
- 8) Door bin
- 9) Egg holder

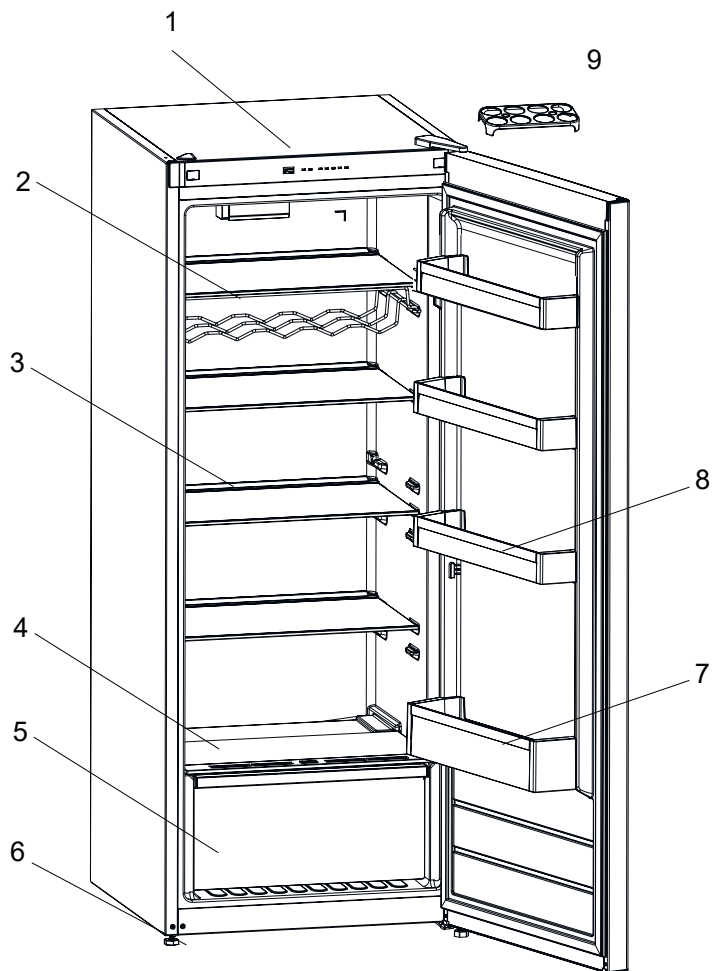

This image is only for information about the parts of the appliance.
Parts may vary according to the product.

Installation

Installation guideline

- Use two or more people to move and install the appliance. Failure to do so can result in back or other injuries.
- Locate the refrigerator away from direct sunlight and sources of heat (stove, heater, radiator, etc.). Direct sunlight may affect the acrylic coating and heat sources may increase electrical consumption. Do not use where the room temperature is below -15°C or in high heat/humidity locations.
- **This fridge is not designed or approved for outdoor use.**
- The appliance must be installed with all electrical and drain connections following with state and local codes. A standard electrical supply (115 V AC only, 60 Hz), properly grounded following the National Electrical Code and local codes and ordinances are required.
- The fuse (or circuit breaker) size should be 15 amperes.
- It is important for the appliance to be levelled to work properly. You may need to make several adjustments to level it.
- Plug into a grounded 3-prong outlet, do not remove grounding prong, do not use an adapter, and do not use an extension cord.
- We recommend that your unit be on its own circuit. Please make sure to use a receptacle not controlled by a light switch
- Place your unit on a floor that is strong enough to support the unit when it is fully loaded. To level your unit, adjust the levelling legs at the bottom of the unit.
- Install the plastic distance guide(s) on the condenser (black vanes at the rear of the appliance) by turning it 90° (as shown in the figure) to prevent the condenser from touching the wall.
- Allow 3 inches of space between the back and sides of the unit, which allows the proper air circulation to cool the compressor and condenser. Clearance of at least 6 inches is required at the top of your appliance. Do not place anything on top of your appliance.
- Avoid locating the unit in moist areas.
- Before connecting the unit to the power source, let it stand upright for approximately 2 hours. This will reduce the possibility of a malfunction in the cooling system from handling during transportation.

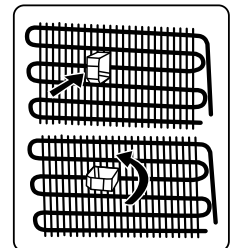

How to reverse your freezer door

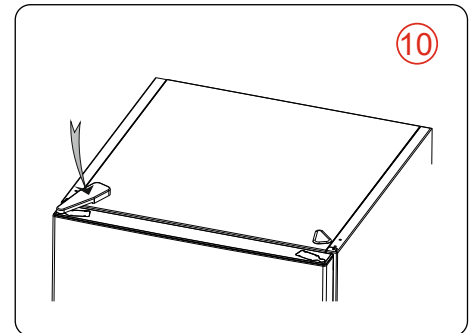
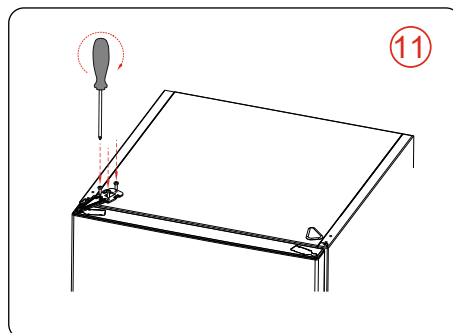
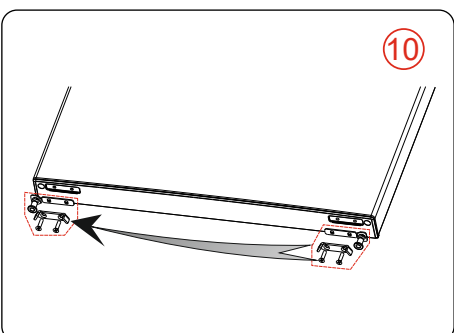
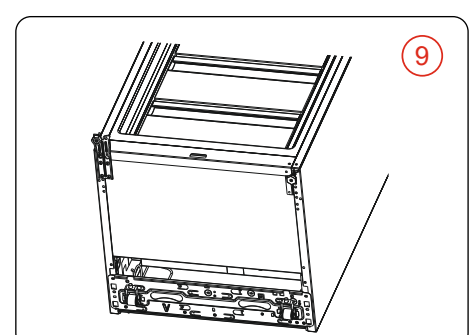
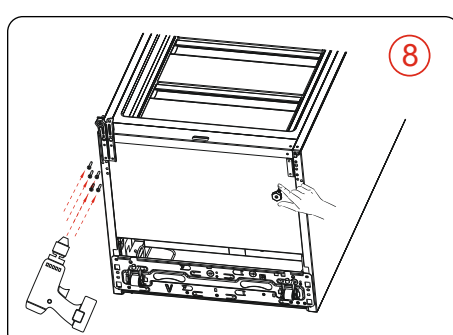
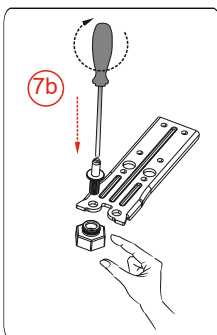
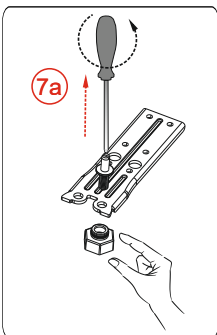
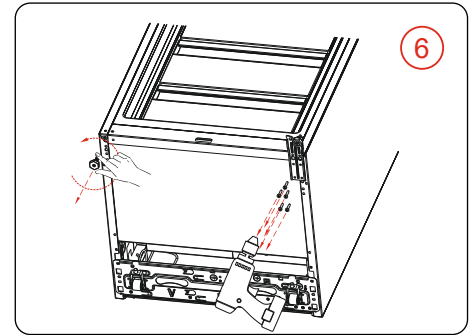
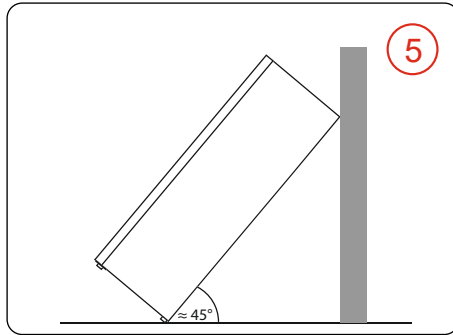
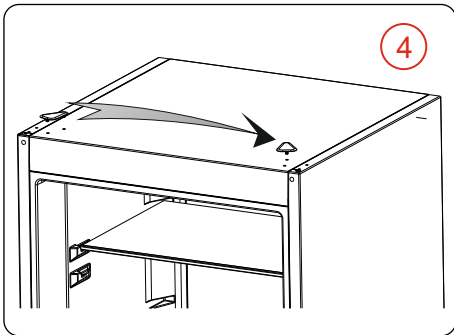
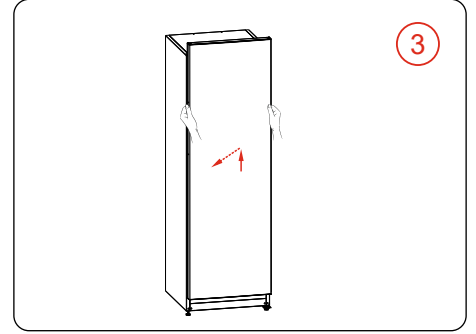
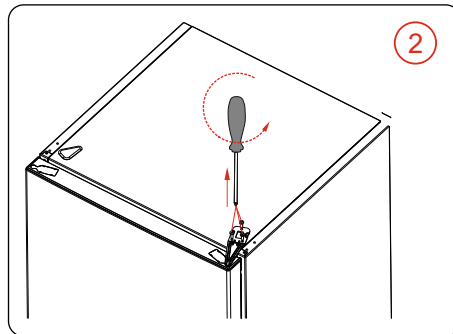
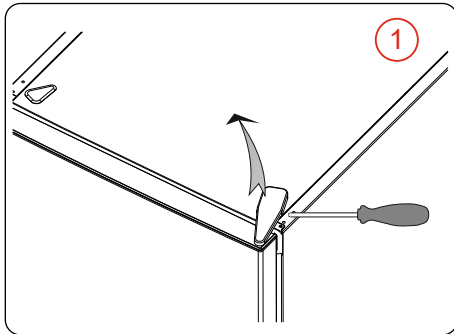

Before first use

- Remove the exterior and interior packing.
- Clean the interior surface with lukewarm water using a soft cloth. Do not use solvent-based cleaning agents or abrasives on the interior. These cleaners may damage or discolour the interior.
- After plugging the appliance into a wall outlet, allow the unit to cool down for 2-3 hours before placing food in the refrigerator compartment.

Using the appliance

Display and Control Panel

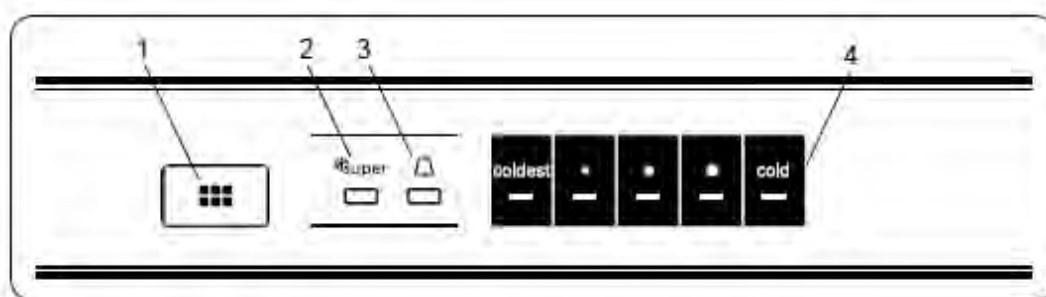

Using the Control Panel

- | | |
|----------------------------------|---------------------------------|
| 1. Fridge temperature set button | 3. Alarm symbol |
| 2. Super cooling mode | 4. Fridge temperature indicator |

Operating your Fridge

Lighting

When the product is plugged in for the first time, the interior lights may turn on 1 minute late due to opening tests.

Fridge Temperature Set Button

This button allows setting temperature of the fridge. In order to set values for fridge partition, press this button. Use this button also to activate super cooling mode.

Alarm symbol (Alarm LED)

In case of a problem within the fridge, the alarm led will release red light.

Super Cooling Mode

When would it be used?

- To cool large quantities of food.
- To cool food quickly.

How to use?

- Press temperature set button until super cooling light comes on.
- Super cooling LED will stay lit during this mode.
- For optimal appliance performance

in maximum cooling capacity, set the appliance to active super cooling mode 6 hours before you put the fresh food into the fridge.

During this mode:

If you press temperature set button, the mode will be cancelled and the setting will be restored to setting 2.



The super cooling mode will be cancel automatically after 5 hours.

Fridge Temperature Settings

The initial temperature of the setting display is middle 41 °F (5 °C).

- Press fridge setting button once.
- Every time you press the button, the setting temperature will increase:

Setting coldest: 36 °F (2,22 °C)

Setting between coldest-middle: 39 °F (3.88 °C)

Setting middle: 41 °F (5 °C)

Setting between middle-cold: 43 °F (6.11 °C)

Setting cold: 46 °F (7.78 °C)

How to Activate Stand-By Mode

- Set "Coldest" set value and push set button until all LED lights blink three times. This means it is in active stand by mode

Cleaning and maintenance



Disconnect the unit from the power supply before cleaning.



- Do not wash your appliance by pouring water on it.
- Do not use abrasive products, detergents or soaps for cleaning the appliance. After washing, rinse with clean water and dry carefully. When you have finished cleaning, reconnect the plug to the mains supply with dry hands.

- Make sure that no water enters the lamp housing and other electrical components.
- The appliance should be cleaned regularly using a solution of bicarbonate of soda and lukewarm water.
- Clean the accessories separately by hand with soap and water. Do not wash in a dish washer.
- Clean the condenser with at least one brush or vacuum cleaner twice a year. This saves money energy and improve performance.
- Defrosting occurs automatically in the refrigerator compartment during operation. The water is collected by the evaporation tray and evaporates automatically.
- The evaporation tray and the water drain hole should be cleaned periodically with the defrost drain plug to prevent the water from collecting at the bottom of the refrigerator instead of flowing out.

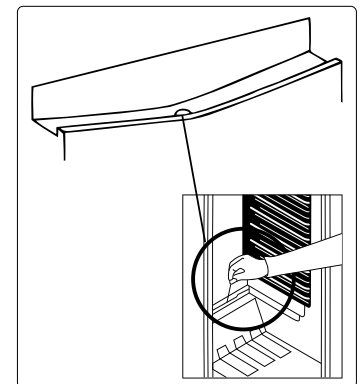
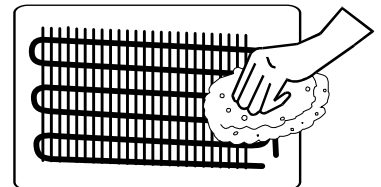

Replacing LED Lighting

To replace any of the LEDs, please contact the nearest Authorized Service Centre.

Important Warning

- △ Keep ventilation openings, in the appliance enclosure or built-in structure, clear of obstruction.
- △ Do not change or damage the refrigerant circuit.
- △ Do not store explosive substances such as aerosol cans with a flammable propellant in this appliance.
- △ During transportation and installation of the appliance, be certain that none of the components of the refrigerant circuit have become damaged.
- △ It is dangerous to alter the specifications or modify this product in any way.
- △ Any damage to the cord may cause a short circuit, fire and/or electric shock.
- △ This appliance is intended to be used in residential household, office or light commercial applications such as Hotels and College Dorms.
- △ All electrical components (plug, power cord, compressor and, etc.) must be replaced by a certified service agent or qualified service personnel.
- △ The refrigerant contained within the compressor of the appliance is isobutene (R600a) which is environmentally friendly but flammable.
- △ Make sure that the power cord is not crushed or damaged at the back of the appliance. A crushed or damaged power cord may overheat and cause a fire.
- △ The power cord must not be lengthened.
- △ Make sure that you can come to the power cord of the appliance.
- △ Do not disconnect from electrical outlet by pulling the power cord.
- △ If the electrical outlet is loose, do not insert the power cord. There is a risk of electric shock or fire. This appliance is heavy. Care should be taken when moving it.
- △ Do not remove or touch items from the freezer compartment if your hands are damp/wet, as this could cause skin abrasions or frost/freezer burns.
- △ Avoid prolonged exposure of the appliance to direct sunlight.



Locate the refrigerator away from direct sunlight and sources of heat (stove, heater, radiator, etc.). Direct sunlight may affect the acrylic coating and heat sources may increase electrical consumption. Ambient temperature below 59°F (15°C) or above 85°F (29.4°C) will hinder the performance of this appliance. **This unit is not designed for use in a garage or any other outside installation.**

Troubleshooting

You can solve many common refrigerator problems easily, saving you the cost of a possible service call. Try the suggestions below to see if you can solve the problem before calling for service.

Problem	Possible cause	Solution
The refrigerator does not work	The temperature regulation knob is set at number "0".	Set the knob to another number.
	The power cord is not plugged in or is the fuse.	Re-insert power cord.
	The fuse has blown or is defective.	Check the fuse, replace if necessary.
	The electrical outlet is defective or controlled by a light switch.	Check if power is controlled by a light switch or contact an electrician.
The food is too warm.	The temperature is not properly adjusted.	Please look in the initial Temperature Setting section.
	The door was open for an extended period.	Open the door only as long as necessary.
	A large quantity of warm food was placed in the appliance within the last 24 hours.	Turn the thermostat to a colder setting temporarily.
	The appliance is near a heat source.	Please look in the installation location section.
Appliance cools too much	The temperature is set too cold.	Turn the thermostat to a warmer setting temporarily.
Unusual noises	The appliance is not level.	Re-adjust the feet.
	The appliance is touching the wall or other objects.	Move the appliance slightly.
	A component, e.g. a pipe, on the rear of the appliance is touching another part of the appliance or the wall.	If necessary, carefully bend the component
Water on the floor	Defrost drain is plugged in the refrigerator compartment.	See the Cleaning section.

For any questions or concerns, please contact us at customerservice@stirlingmarathon.com or visit us at www.stirlingmarathon.com



2 Years Limited Warranty

When operated and maintained according to the instructions in the Use & Care Guide, MARATHON a registered trademark of Stirling Marathon Limited agrees to repair this product for 2 years from the date of original purchase and/or agrees to pay for parts and service/labour required to correct defects in materials or workmanship. Any Service must be approved and provided by an Authorized Stirling Marathon Service provider. YOUR EXCLUSIVE REMEDY UNDER THIS LIMITED WARRANTY SHALL BE PRODUCT REPAIR OR REPLACEMENT AT THE SOLE DISCRETION OF STIRLING MARATHON LIMITED AS PROVIDED HEREIN. This limited warranty is valid only in Canada and the Continental United States with proof of original purchase and confirmed warranty registration.

TERMS OF WARRANTY BY PRODUCT	Capacity/Type	Warranty Type
Refrigeration & Freezer	Less than 6 cu.ft	Carry-In
Refrigeration & Freezer	Greater than 6 cu.ft.	In-Home
Electric & Gas Ranges	All Sizes	In-Home

How to Obtain Service

Carry-In: The original purchaser must deliver or ship the defective product to an authorized Stirling Marathon Service present a copy of the original bill of sale or Warranty Registration Confirmation.

In-Home: Contact Authorized Service Center and provide a copy of the Original bill of sale or Warranty Registration Card. If you are in a remote area or the closest Authorized Service Center is further than 100 km (60 miles), you will be required to deliver the appliance to the closest Service Center at your expense.

Stirling Marathon is not responsible or liable for any spoilage or damage to food or other contents of this appliance, whether due to any defect of the appliance, or its use, whether proper or improper.

Items Excluded from Warranty

- Damages due to shipping or improper installation.
- Damages due to misuse or abuse.
- Content losses due to failure of the unit.
- Commercial or Rental Use Limited to 90 days Parts & Labour.
- Plastic parts such as door bins, panels, door shelves, racks, light bulbs, etc.
- Punctures to the evaporator system due to improper defrosting of the unit.
- Service or Repair by a unauthorized service technicians.
- Service calls that do not involve defects in material and workmanship such as instruction on the proper use of the product, door reversal or improper installation.
- Replacement or resetting of house fuses or circuit breakers.
- Delivery costs incurred as the result of a unit that fails.
- Expenses for travel and transportation for product service if your appliance is located in a remote area where service by an unauthorized service technician is not available.
- The removal and reinstallation of your appliance if it is not installed correctly or is in an inaccessible location, as per the published installation instructions.
- Liability under this warranty is limited to repair, replacement or refund. If a replacement unit is not available or the unit cannot be repaired, liability is limited to the actual.
- Purchase price paid by the consumer.
- This warranty applies only to the original purchaser and does not extend to any subsequent owner(s) and is non-transferable.
- No warranty or insurance herein contained or set out shall apply when damage or repair is caused by any of the following: accident, alteration, abuse or misuse of the appliance such as inadequate air circulation in the room or abnormal operating conditions (extremely high or low room temperature).
- Use for commercial or industrial purposes (i.e. If the appliance is not installed in a domestic residence). Fire, water damage, theft, war, riot, hostility, acts of God such as hurricanes, floods etc.
- Service calls resulting in customer education.
- Improper installation (ie. Building-in of a free-standing appliance or using an appliance outdoors that is not approved for outdoor application).

For Service or Assistance please contact us at:
warranty@stirlingmarathon.com or visit us at www.stirlingmarathon.com.

V.08/2024