

**30" 4 Burner Built-In Induction Cooktop, Front Touch Controls, Frameless Black Glass****CTI30412SS****Key Features & Benefits****Bridge Element**

The Bridge Element combines two individual heating zones into one extended cooking surface, perfect for griddles and large pans.

Induction Technology

Induction Technology delivers faster cooking, precise temperature control, and effortless cleaning for a superior cooking experience.

Power Boost

Power Boost your element to quickly bring water to a boil or heat a pan fast, perfect for searing or frying.

Child Lock

The Child Lock function keeps your little ones safe by preventing accidental activation of the cooktop.

GENERAL PROPERTIES

Size	30"
Finish	Frameless Black Glass
Control Type	LED Display - Touch Slider
Control Location	Front
Fuel Type	Induction

FEATURES & PERFORMANCE

# of Cooking Zones	4 Induction Elements
Power Levels	9
Front Left (Standard / Boost)	7" (2,100 W / 3,700 W)
Front Right (Standard / Boost)	9" (2,300 W / 3,700 W)
Center (Standard / Boost)	N/A
Back Left (Standard / Boost)	7" (2,100 W / 3,700 W)
Back Right (Standard / Boost)	11" (2,600 W / 3,700 W)
Expandable Elements	No
Bridge Element	Yes
Boost Function	Yes
Automatic Pan Detection	Yes
Residual Heat Indicators	Yes
On/Off Light	Yes
Digital Display for Power Level Indication	Yes
Display Lock	Yes

DIMENSIONS

Product Dimensions (H x W x D)	2 11/32" x 30 45/64" x 20 15/32"
Required Cutout Size (W x D)	29 17/32" x 19 5/16"
Product Weight	22.04 lbs.

TECHNICAL DETAILS

Total Power Consumption	7,400 W
Volts	240/208 V
Frequency	60 Hz
Minimum Circuit Breaker / Rated Amps	40 A
Electrical Connection	Flexible Conduit, 3-Wire or 4 Wire

**30" 4 Burner Built-In Induction Cooktop, Front Touch Controls, Frameless Black Glass****CTI30412SS**

Dimensions and Installation

Top View

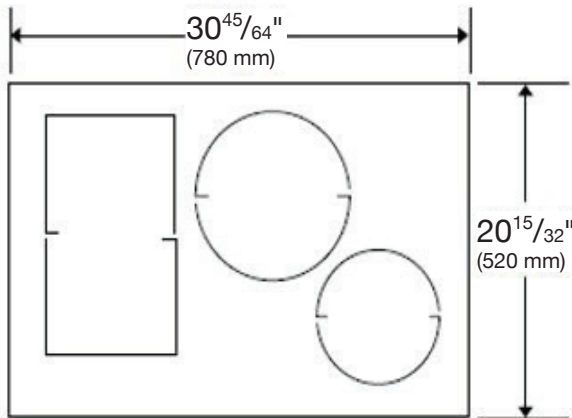

Side View

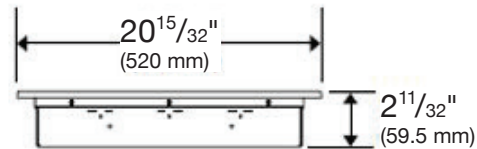

Front View

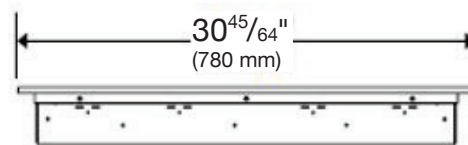

Countertop Cutout

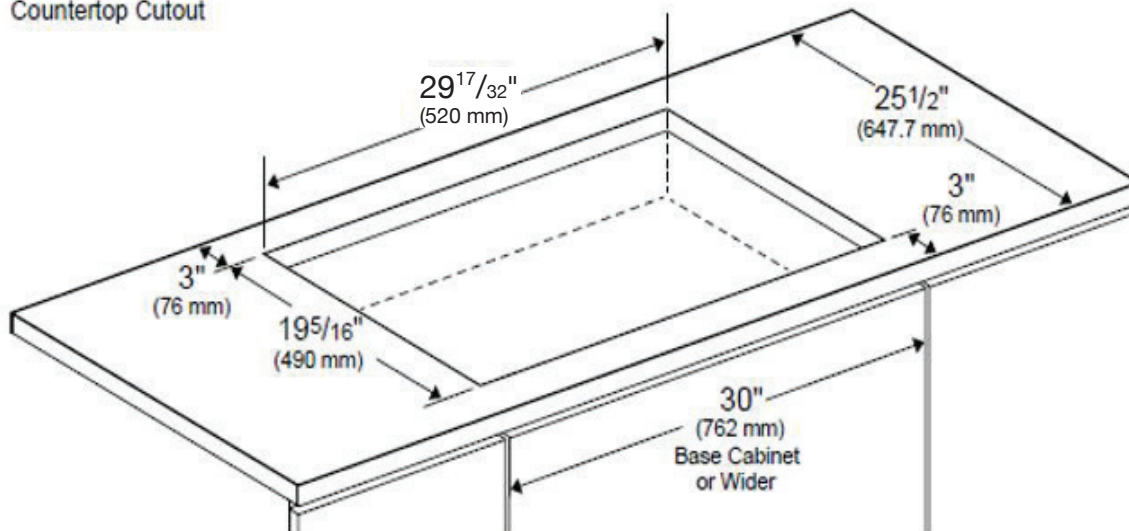

1 YEAR	2 YEARS
FULL WARRANTY	PARTS WARRANTY

NOTE TO THE INSTALLER: All height, width and depth dimensions are shown in inches (as well as metric). Beko Canada Inc. and Beko US Inc., reserves the absolute and unrestricted right to change product materials and specifications, at any time, without notice. Please visit our website (Canada) www.blombergappliances.ca / (USA) www.blombergappliances.com or call (Canada) 855-643-2356 / (USA) 888-352-2356 to verify the latest specifications with final dimensional data and other details prior to installation and making a cutout. Applicable product limited warranty information may be found in accompanying product materials or you may contact your account manager for further details. Proper installation is the responsibility of the installer. Product failure due to improper installation is not covered under the Limited Warranty.

Canada: 855-643-2356 | www.blombergappliances.ca
USA: 888-352-2356 | www.blombergappliances.com