

36" Counter-Depth Side-by-Side Refrigerator



300 Series – Stainless Steel B20CS30SNS



B20CS30SNS
Stainless Steel

This counter-depth Side-by-Side refrigerator installs nearly flush in a freestanding cutout, offering uninterrupted stainless steel luxury.

Features & Benefits

Easy clean stainless steel resists smudges and cleans easily.

MultiAirflow™ cooling system boosts air circulation for even temperature throughout.

ENERGY STAR® qualified for energy efficiency.

LED lighting and transparent storage provide ideal visibility throughout.

Dispenses fresh-tasting filtered water, crushed ice and cubed ice.

General Properties

Easy Clean Stainless Steel	Yes
Water filter	Yes
Lighting	LED
Defrost process refrigerator section	Frost-free
Number of shelves - refrigerator	4
Adjustable shelves - refrigerator	1
Shelf material - refrigerator	Tempered glass
Type of shelves - refrigerator	Framed Tempered Glass
Gallon storage bins	3
Defrost process freezer section	Automatic
Number of drawers - freezer	2
Adjustable shelves - freezer	3
Shelf material - freezer	Tempered glass
Type of shelves - freezer	Framed Tempered Glass
Ice maker	Yes

Capacity

Total unit capacity (cu. ft.) – AHAM	20.2
Refrigerator capacity (cu. ft.)	13.2
Freezer capacity (cu. ft.)	6.96



Technical Details

Current (A)	15 A
Volts (V)	115 V
Frequency (Hz)	60 Hz
Power cord length (in.)	76.8
Plug type	120V-3 prong

Dimensions & Weight

Appliance dimensions (H x W x D) (in.)	69 11/16" x 35 15/16" x 27 1/2"
Required cutout size (H x W x D) (in.)	70" x 36" x 25.9"
Net weight (lbs)	245 lbs

Efficiency

Energy consumption (kWh/yr)	594 kWh
-----------------------------	---------

Accessories—Included

Included	Egg tray 1 Water Filter
----------	----------------------------

Accessories—Optional

Appliance model number	Replacement Water Filter
B20CS30SNS/01	BORPLFTR30
B20CS30SNS/02	BORPLFTR30
B20CS30SNS/03	BORPLFTR55
B20CS30SNS/04	BORPLFTR55
B20CS30SNS/05	BORPLFTR55



Accessories: To purchase Bosch accessories, cleaners & parts please visit www.bosch-home.com/us/store or call 1-800-944-2904 (Mon to Fri 5 am to 6 pm PST, Sat 6 am to 3 pm PST).

Notes: All height, width and depth dimensions are shown in inches. BSH reserves the absolute and unrestricted right to change product materials and specifications, at any time, without notice. Consult the product's installation instructions for final dimensional data and other details prior to making cutout.

Warranties: Please see Use & Care manual or Bosch website for statement of limited warranty.

For more information on our entire line of products, go to www.bosch-home.com/us or call 1-800-944-2904

© BSH Home Appliances Corporation. All rights reserved. Bosch is a registered trademark of Robert Bosch GmbH.

36" Counter-Depth Side-by-Side Refrigerator



BOSCH
Invented for life

300 Series – Stainless Steel B20CS30SNS

Installation Details

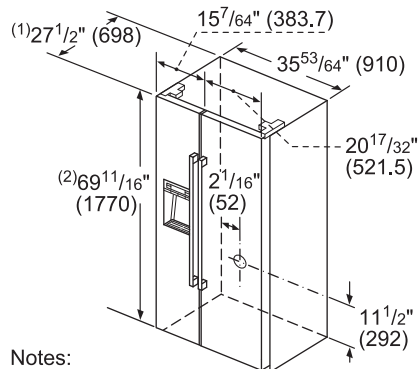

Notes:

(1) Depth 29 1/2" with spacers

(2) Front height adjustable from 69 3/8" to 70"

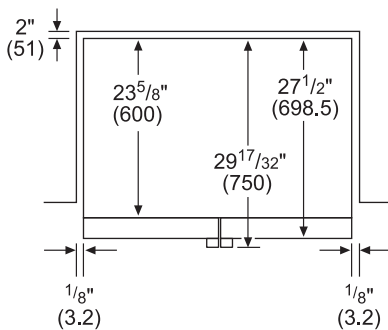
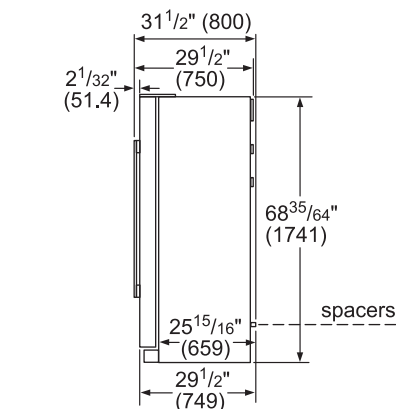

measurements in inches (mm)

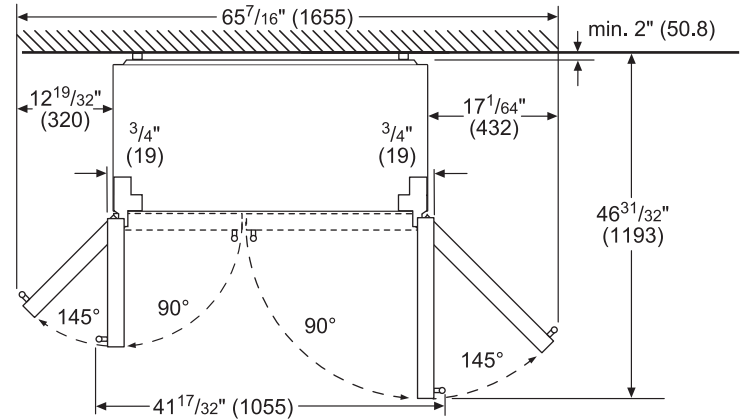

Drawers can be pulled out fully at door opening of 145°

measurements in inches (mm)

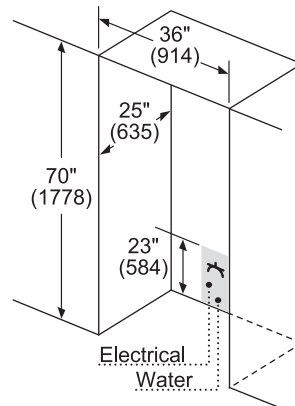

Leave a 1/2" (12.7 mm) gap at the top and 2" (51 mm) behind the refrigerator for proper ventilation.
For installation next to a wall, leave a minimum gap of 3 3/4" (95.2 mm) on the wall side for opening the door.
It is recommended that you do not install the refrigerator near a heat source such as an oven or a range.
Maximum receptacle and waterline height 23" (584 mm).

measurements in inches (mm)

Accessories: To purchase Bosch accessories, cleaners & parts please visit www.bosch-home.com/us/store or call 1-800-944-2904 (Mon to Fri 5 am to 6 pm PST, Sat 6 am to 3 pm PST).

Notes: All height, width and depth dimensions are shown in inches. BSH reserves the absolute and unrestricted right to change product materials and specifications, at any time, without notice. Consult the product's installation instructions for final dimensional data and other details prior to making cutout.

Warranties: Please see Use & Care manual or Bosch website for statement of limited warranty.

For more information on our entire line of products, go to www.bosch-home.com/us or call 1-800-944-2904

© BSH Home Appliances Corporation. All rights reserved. Bosch is a registered trademark of Robert Bosch GmbH.