



# *ASSEMBLY INSTRUCTIONS*

## *COASTER FINE FURNITURE*



*Fine Furniture for every stage of life*

**122342**  
**Dining Side Chair**

ITEM:122342



## ASSEMBLY INSTRUCTIONS

### ASSEMBLY TIPS:

1. Remove hardware from box and sort by size.
2. Please check to see that all hardware and parts are present prior to start of assembly.
3. Please follow attached instructions in the same sequence as numbered to assure fast & easy assembly.



### WARNING!

1. Don't attempt to repair or modify parts that are broken or defective. Please contact the store immediately.
2. This product is for home use only and not intended for commercial establishments.



ASSEMBLY TIME

15 MINUTES

## PARTS IDENTIFICATION

A BACK FRAME

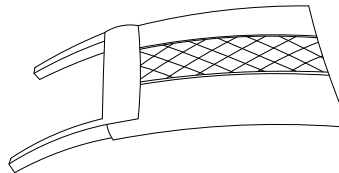

1PC

B SEAT CUSHION WITH FRAME

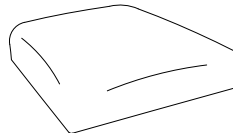

1PC

C FRONT LEG

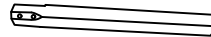

2PCS

## HARDWARE IDENTIFICATION

1 LONG BOLT  
(M6 X 80MM RBW)



4PCS

2 MEDIUM BOLT  
(M6 X 60MM RBW)



4PCS

3 SHORT BOLT  
(M6 X 40MM RBW)

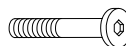

2PCS

4 LOCK WASHER  
(M6 X 13MM RBW)



10PCS

5 FLAT WASHER  
(M6 X 19MM RBW)



10PCS

6 ALLEN WRENCH  
(M4 X 110MM RBW)



1PC

### NOTE:

Quantities shown are for one chair.

STEP 1

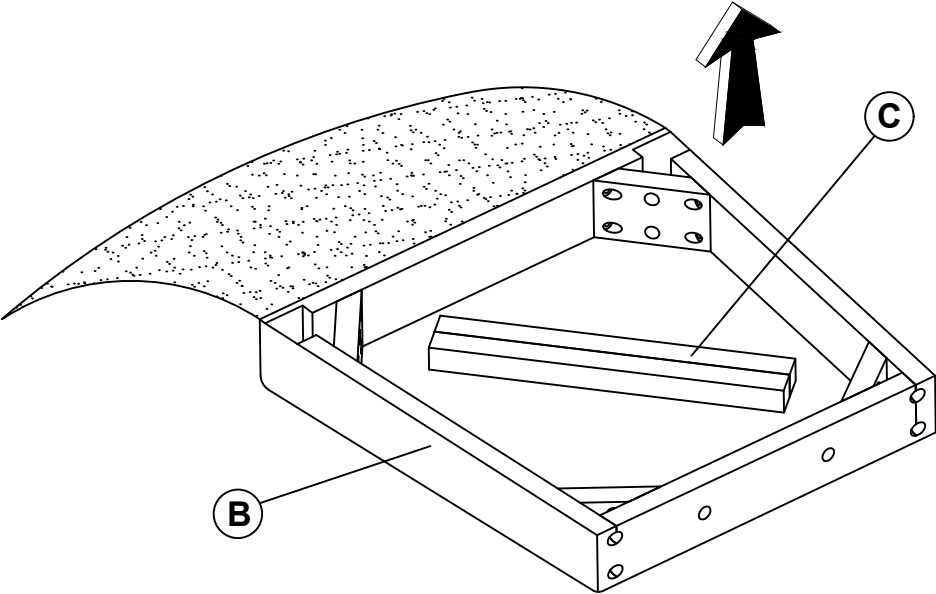

STEP 2

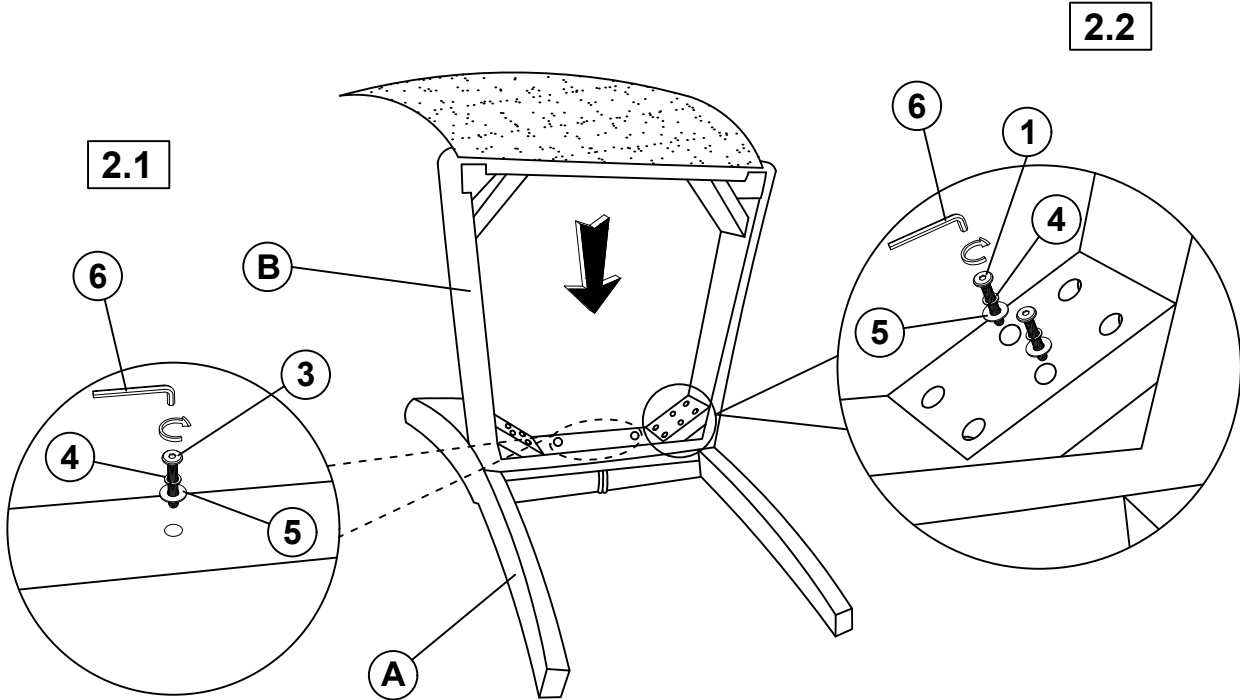

ITEM:122342

ASSEMBLY INSTRUCTIONS



STEP 3

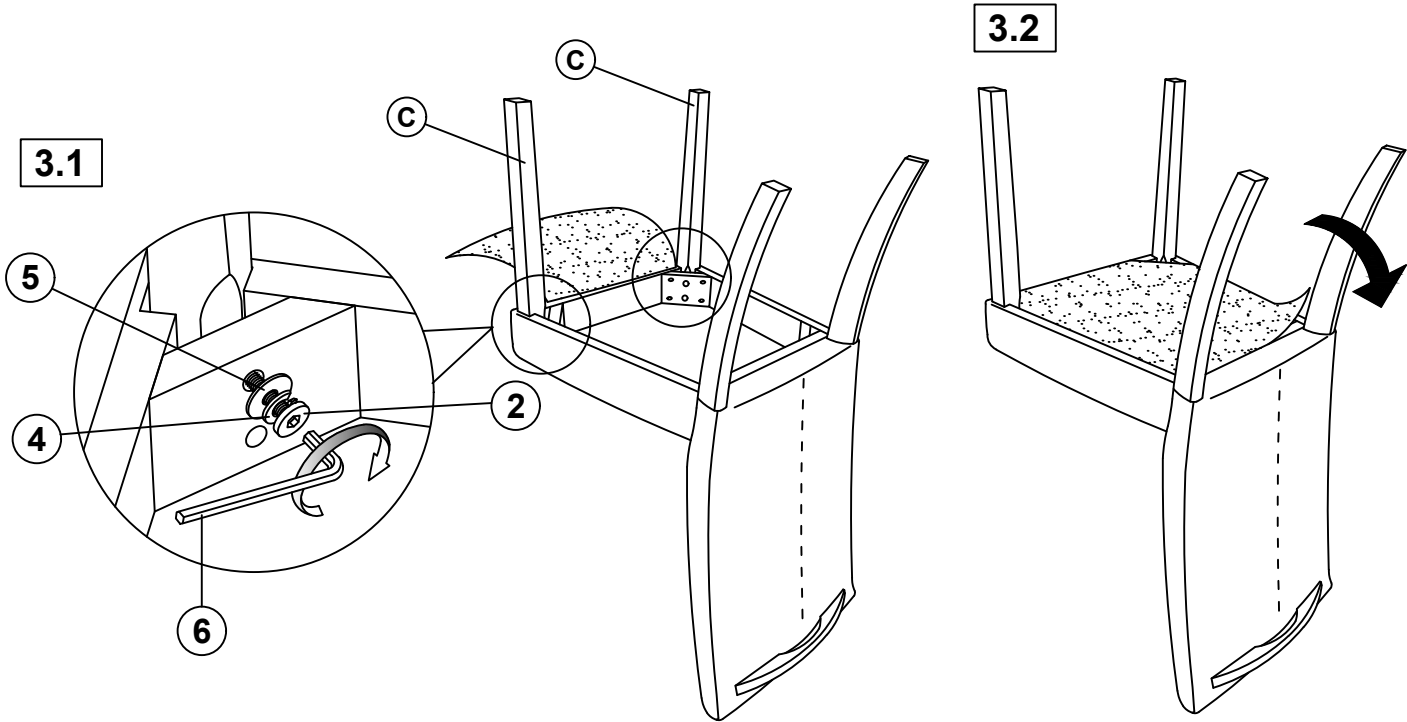

STEP 4  
COMPLETE

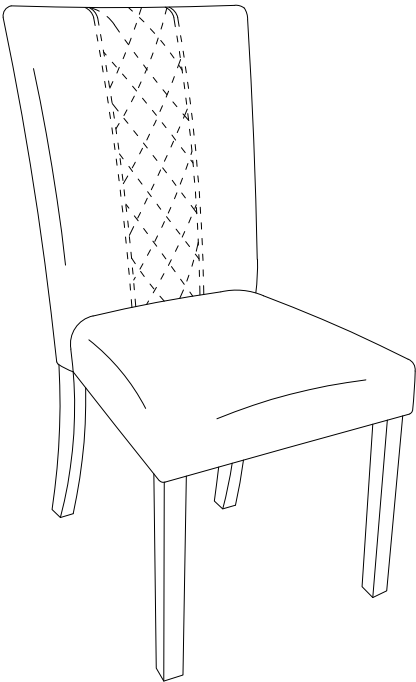

ITEM:122342

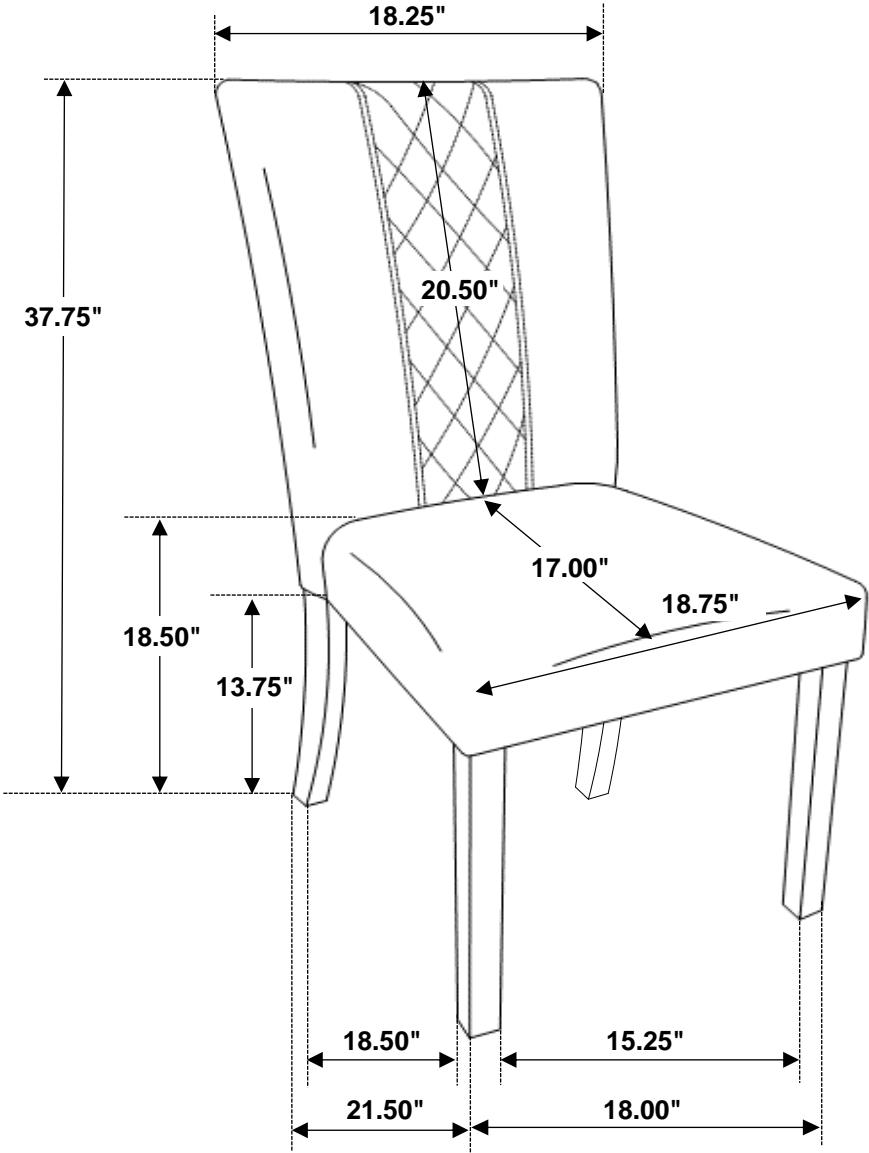

**Note: Dimension tolerance  $\pm 5\%$**