

Warning :

- Be sure to check all packing material carefully for small parts, which may have come loose inside the carton during shipment.
- To prevent possible scratches and damage, this furniture **MUST BE ASSEMBLED BY TWO PEOPLE** on a soft surface such as a blanket or carpet.

Important Use Information: We recommend using coasters, placemats and trivets when placing hot or cold containers on this item. It is also recommended to quickly cleanup any spills to minimize exposure to moisture. Doing so will prolong the life and look of the item for many years.

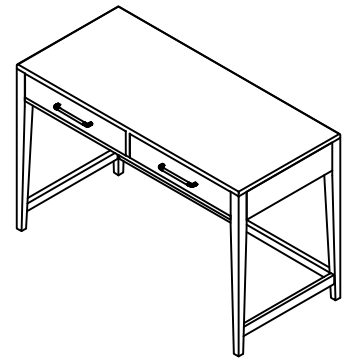

46230
Writing Desk

Components and Hardware List

 Desk Top 1 pc.	 Leg Frame (Left) 1 pc.	 Leg Frame (Right) 1 pc.	 Back Stretcher 1 pc.	 Allen Head Bolt 5/16"-18 x 1-3/8" 12 pcs.	 Allen Head Bolt 5/16"-18 x 5/8" 8 pcs.	 Spring Washer 5/16" x Ø14 20 pcs.
 Flat Washer 5/16" x Ø18 20 pcs.	 Allen Key 4mm 1 pc.	 'L' Bracket 4 pcs.	 Furniture Tipping Restraint Kit 1 pc.	 Tool Required (Not provided) Phillips Screwdriver	 DOWN	

Step 1: Remove both drawer

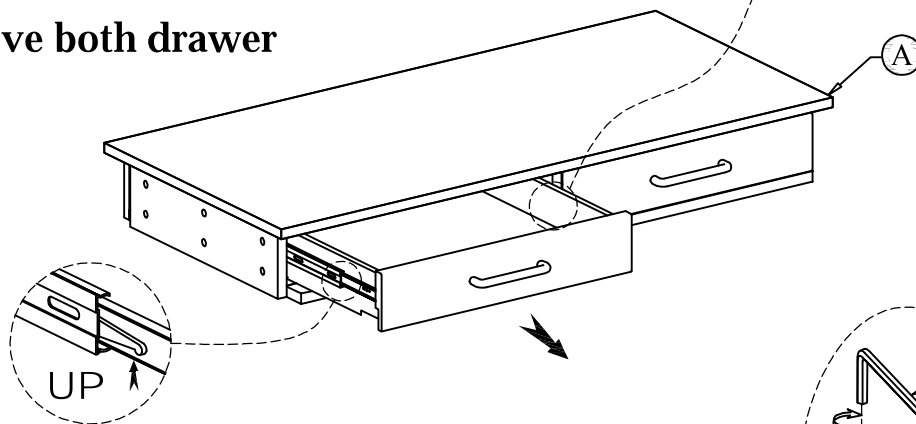

Step 2: Do not fully tighten the bolts

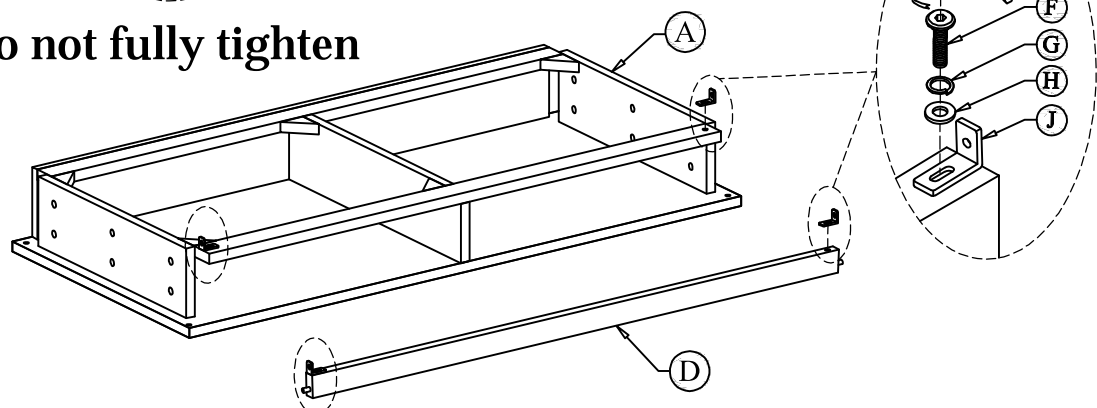

Step 3: Do not fully tighten the bolts

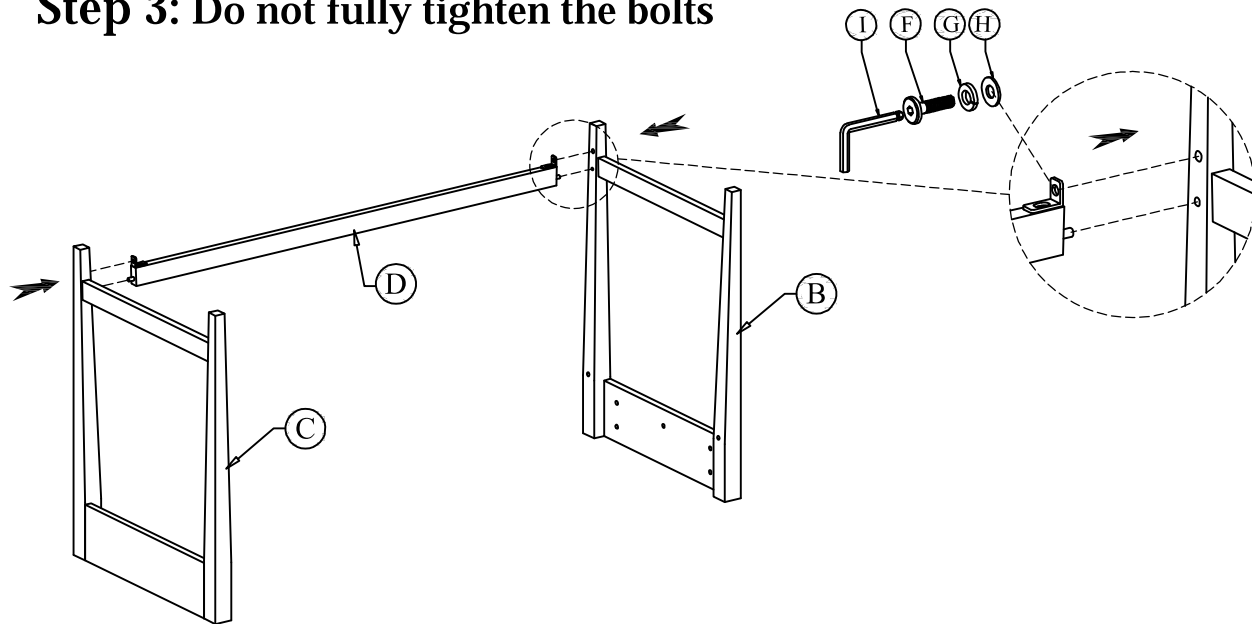

Step 4

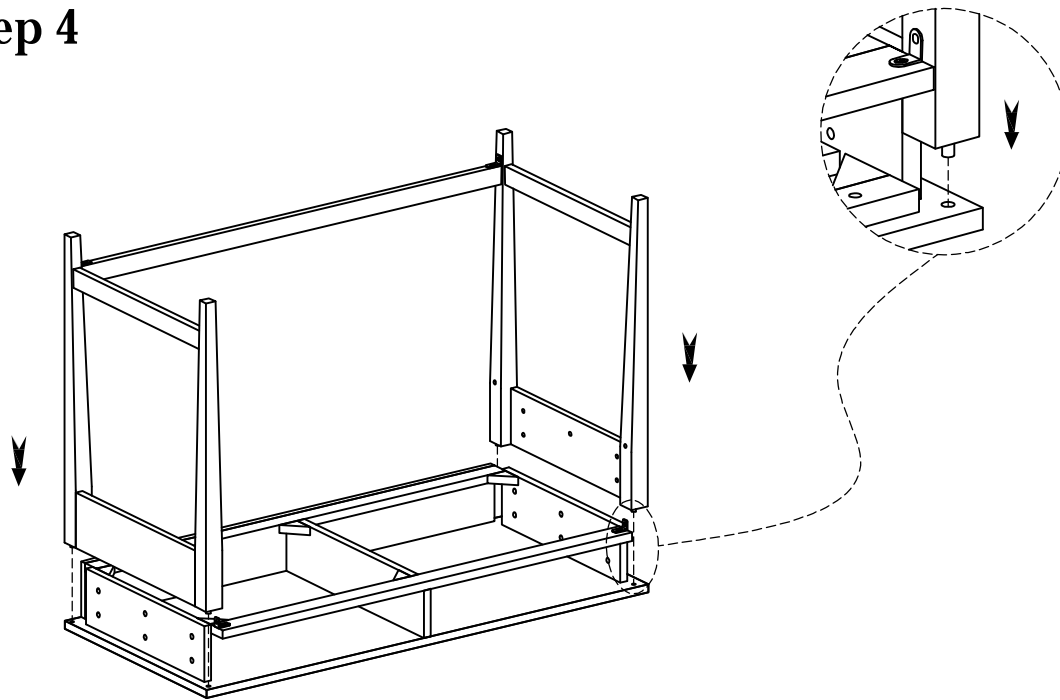

Step 5: Using the Allen key to tighten all bolts

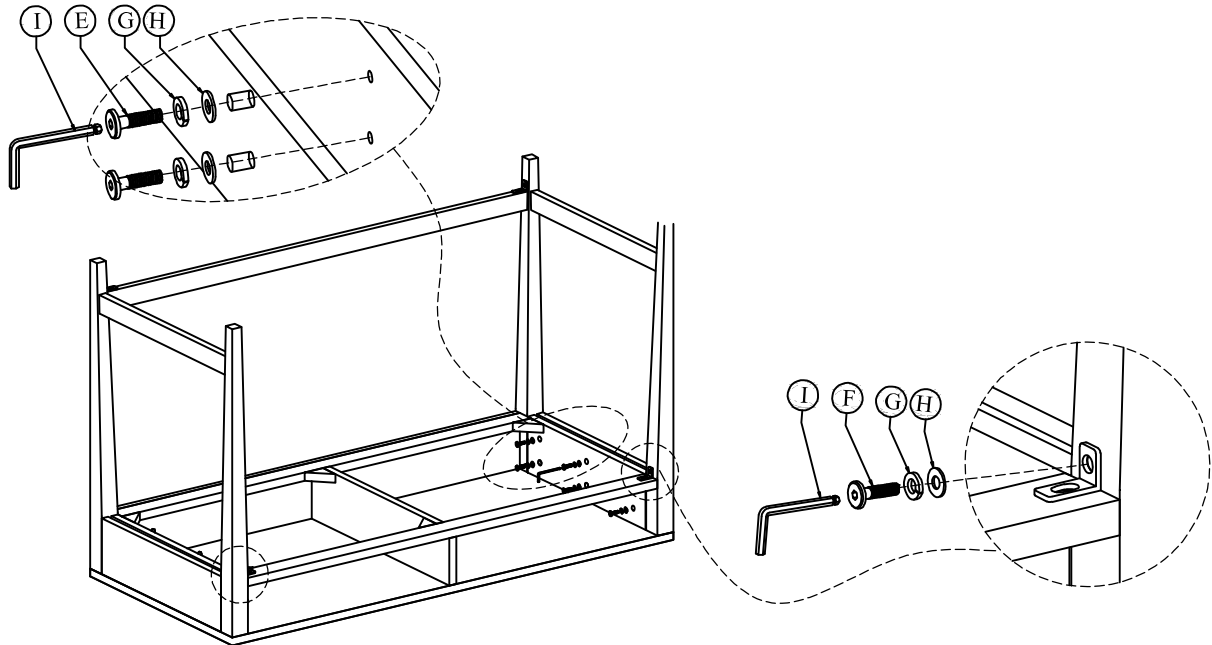

Step 6

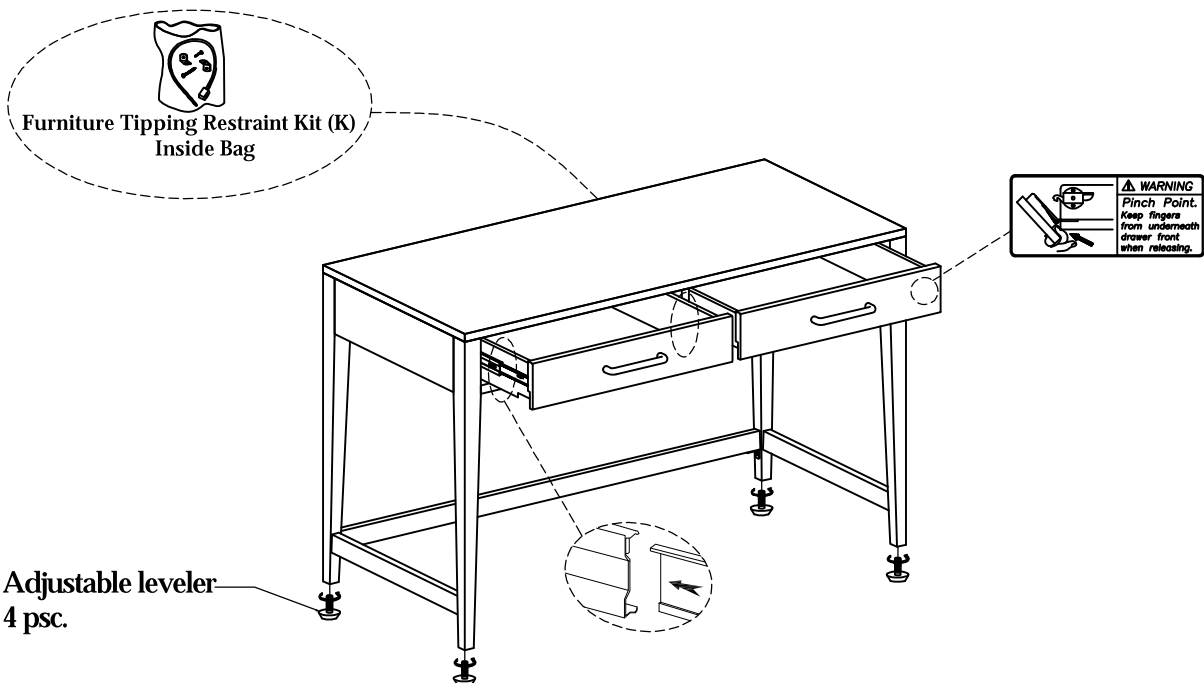

For product and personal safety, a Furniture Tipping Restraint kit has been included with this unit which can help to minimize the risk of the unit accidentally tipping forward, if used and properly installed per the kit manufacturer's instructions.