

### Remote Configuring

**After charging the remote fully, proceed with the setup by following these steps:**

- 1) Remove endcap and slide the power switch right to the “off” position.
- 2) Plug in the provided mini-USB cable to the remote USB port located on the left side behind the endcap (see figure one for location).
- 3) Plug the other end of the USB cable into a computer or chassis with compatible software already installed and running.
- 4) Slide the power switch left to the “on” position.
- 5) Enter the password requested on the HR200 screen using the following numeric buttons in this sequence: 3526 enter.
- 6) You are now ready to proceed with configuration.  
Please refer to the HR200 integration note or your System Training Guide for more details.

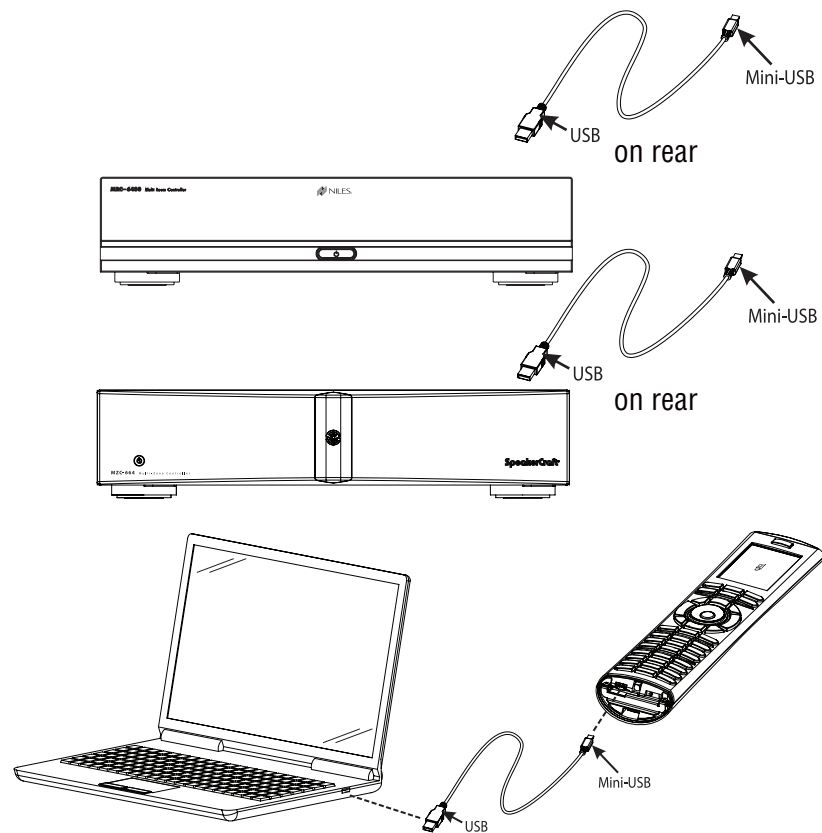

### Removal and Replacement of the battery

- 1) To access the battery locate the Endcap Release Button on the bottom of the remote. While depressing the Endcap release button pull the Endcap away from the body of the remote as illustrated.
- 2) Remove the two screws holding the Battery Retaining Bracket in place using a #1 Phillips Screwdriver. Slide out the old battery.
- 3) **CAUTION:** Danger of explosion if battery is incorrectly replaced. Replace battery with only Core Brands approved battery part number 2900008. (Contact your local dealer for replacement battery.)
- 4) Assure proper orientation while inserting replacement battery. Battery label should be faced down and gold plated charging contacts should enter the unit first. Refer to the illustration above. Improper installation of the battery will result in permanent damage to the remote.

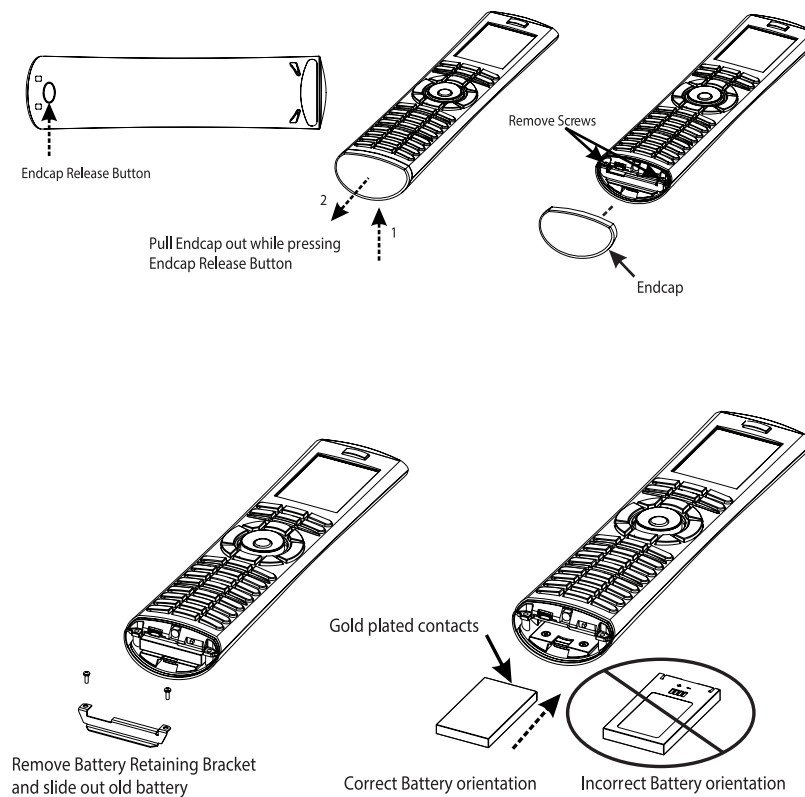

## HR200 Quick Reference Guide

English

# HR200 Quick Reference Guide

The HR200 allows users to enjoy wireless control of their system from any zone in the house. A few simple steps are required prior to using your new HR200 remote control.

**You will need the following items which are included in the HR200 kit:**

- A. Remote
- B. Charging Station
- C. USB to Mini-USB Cable
- D. 16VDC @ 1.5A Power Supply (2.1mm tip Positive)

**Required items not included in HR200 kit:**

System Controller with compatible software.

**Optional items purchased separately:**

- 2900008 – Additional Battery
- HR2CS – Additional Charging Station

**Please note:**

The HR200 requires a controller running with compatible software.

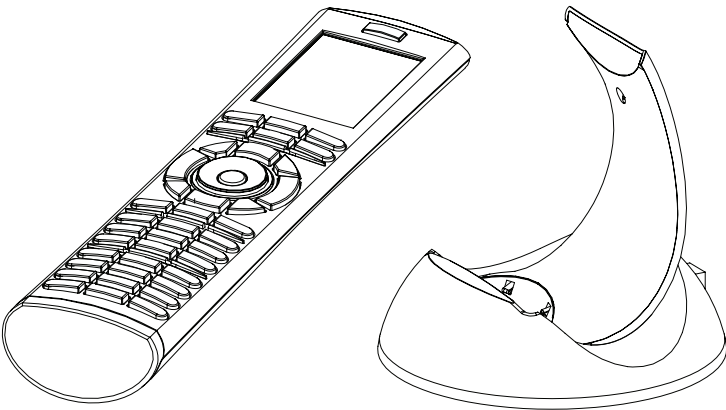

A

B

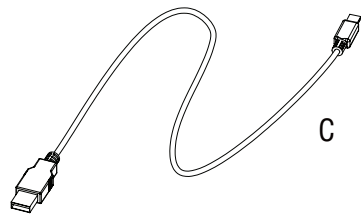

C

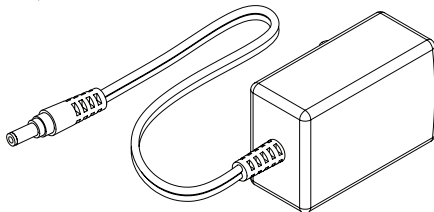

D

## 1

### Accessing the Mini-USB Programming Port, IR Receiver, and On/Off Switch

The HR200 is shipped with the power switch in the “off” position to conserve battery life. Prior to setup the endcap must be removed and the power switch must be changed to the “on” position. To access the power switch locate the Endcap Release Button on the bottom of the remote.

While depressing the endcap release button pull the endcap away from the body of the remote as illustrated. Move the On/Off power switch located on the right side to the “on” position. (For extended periods of non-use it is recommended to turn the remote off with this switch to conserve the battery life.) Note the location of the Mini-USB port and IR Receiver. Replace endcap and follow the charging instructions below.

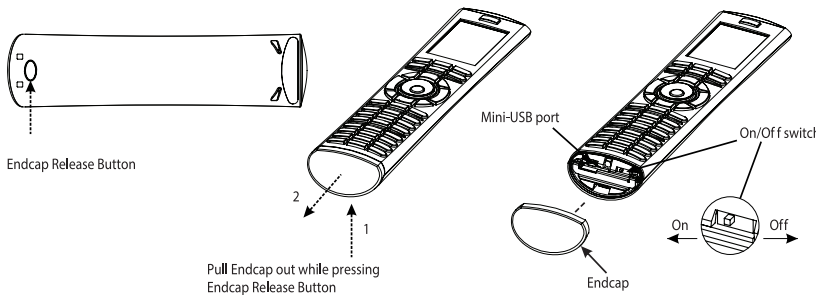

## 2

### Charging the Remote

Before configuring, the HR200 must be fully charged.

**Charge the remote in the included charging cradle for at least 2 hours prior to setup.**

To charge, place the remote in the charging cradle and connect the included power supply to the back of the charging cradle and wall outlet. The remote display may light up briefly while beginning to charge. It is recommended to place the remote in the charging cradle when not in use.

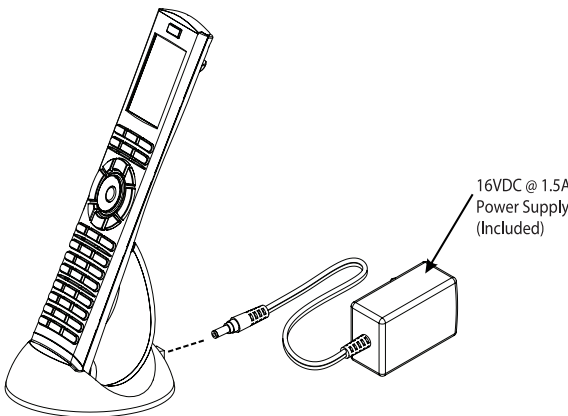

## Limited Warranty

Core Brands, LLC ( ‘CB’ ) warrants the HR200 to be free from defects in materials and workmanship for the period of two years (2 years) from the date of purchase. If within the applicable warranty period above purchaser discovers that such item was not as warranted above and promptly notifies ‘CB’ in writing, ‘CB’ shall repair or replace the item at the company’s option.

**This warranty shall not apply** (a) to equipment not manufactured by ‘CB’, (b) to equipment which shall have been installed by other than an ‘CB’ authorized installer, (c) to installed equipment which is not installed to ‘CB’s’ specifications, (d) to equipment which shall have been repaired or altered by others than ‘CB’, (e) to equipment which shall have been subjected to negligence, accident, or damage by circumstances beyond ‘CB’s’ control, including, but not limited to, lightning, flood, electrical surge, tornado, earthquake, or other catastrophic events beyond ‘CB’s’ control, or to improper operation, maintenance or storage, or to other than normal use of service. With respect to equipment sold by, but not manufactured by ‘CB’, the warranty obligations of ‘CB’ shall in all respects conform to the warranty actually extended to ‘CB’ by its supplier. The foregoing warranties do not cover reimbursement for labor, transportation, removal, installation or other expenses which may be incurred in connection with repair or replacement.

Except as may be expressly provided and authorized in writing by ‘CB’, ‘CB’ shall not be subject to any other obligations or liabilities whatsoever with respect to equipment manufactured by ‘CB’ or services rendered by ‘CB’.

THE FOREGOING WARRANTIES ARE EXCLUSIVE AND IN LIEU OF ALL OTHER EXPRESSED AND IMPLIED WARRANTIES EXCEPT WARRANTIES OF TITLE, INCLUDING BUT NOT LIMITED TO IMPLIED WARRANTIES OF MERCHANTABILITY AND FITNESS FOR A PARTICULAR PURPOSE.

### ATTENTION: TO OUR VALUED CUSTOMERS

**To ensure that customers obtain quality pre-sale and after-sale support and service, Core Brands products are sold exclusively through authorized dealers. Core Brands products are not sold online. The warranties on Core Brands products are NOT VALID if the products have been purchased from an unauthorized dealer or an online E-tailer.**

**To determine if your Core Brands reseller is authorized, please call Core Brands, LLC at (707) 283-5900.**

CORE  
BRANDS

CoreBrands.com