

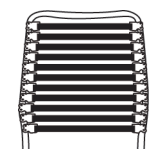

IMPORTANT NOTE #1: →
Screws and washers (Parts I) are preassembled into the underside of the seat (Part B). Remove screws and washers from seat and then use to attach Part D to Part B, as shown in step 1.

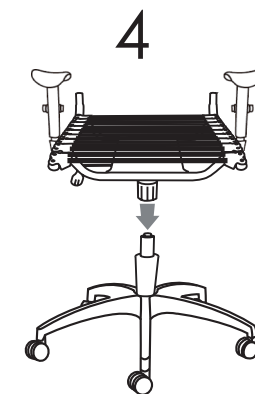

A (1 pc)

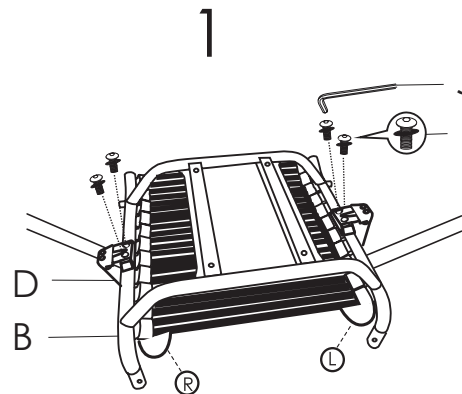

B (1 pc)

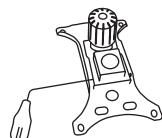

C (1 pc)

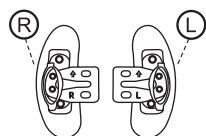

D (2 pcs)



E (1 pc)



F (1 pc)

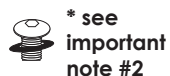

G (4 pcs)
M8 x 14mm



H (2 pcs)
1/4" x 5/8"

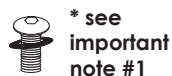

I (4 pcs)
M8 x 16mm

IMPORTANT NOTE #2: →
Screws and washers (Parts G) are preassembled into the underside of the seat (Part B). Remove screws and washers from seat and then use to attach Part C to Part B, as shown in step 2.

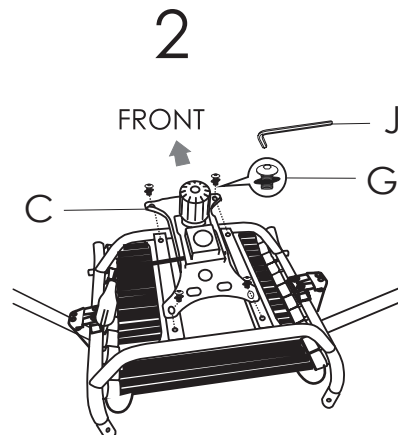

J (1 pc)
5mm



K (1 pc)
4mm

