



ASSEMBLY INSTRUCTIONS

COASTER FINE FURNITURE



Fine Furniture for every stage of life

108231
Dining Table

ITEM: **108231**



ASSEMBLY INSTRUCTIONS

ASSEMBLY TIPS:

- 1.Remove hardware from box and sort by size.
- 2.Please check to see that all hardware and parts are present prior to start of assembly.
- 3.Please follow attached instructions in the same sequence as numbered to assure fast & easy assembly.



WARNING

- 1.Don't attempt to repair or modify parts that are broken or defective. Please contact the store immediately.
- 2.This product is for home use only and not intended for commercial establishments.



ASSEMBLY TIME

10 MINUTES

PARTS IDENTIFICATION

A	TOP		1PC
B	LEAF		1PC
C	LEG FRAME		2PCS

HARDWARE IDENTIFICATION

1	BOLT (5/16" x 40mm - BLK)		20PCS
2	LOCK WASHER (5/16" - BLK)		20PCS
3	FLAT WASHER (5/16" x 19 x 1.5mm - BLK)		20PCS
4	ALLEN WRENCH (4mm - BLK)		1PC

ITEM: **108231**
ASSEMBLY INSTRUCTIONS



STEP 1

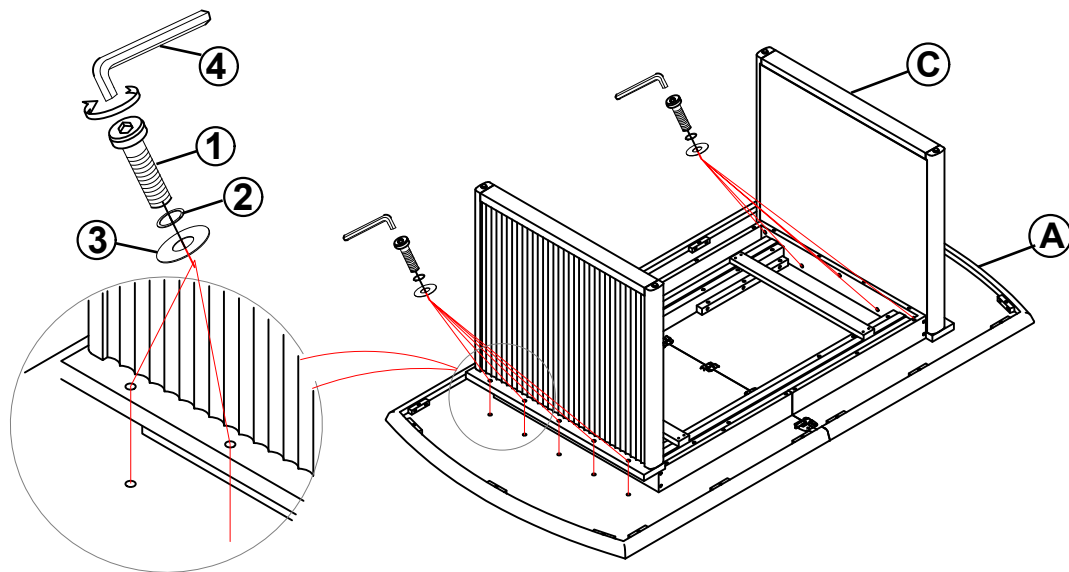

STEP 2

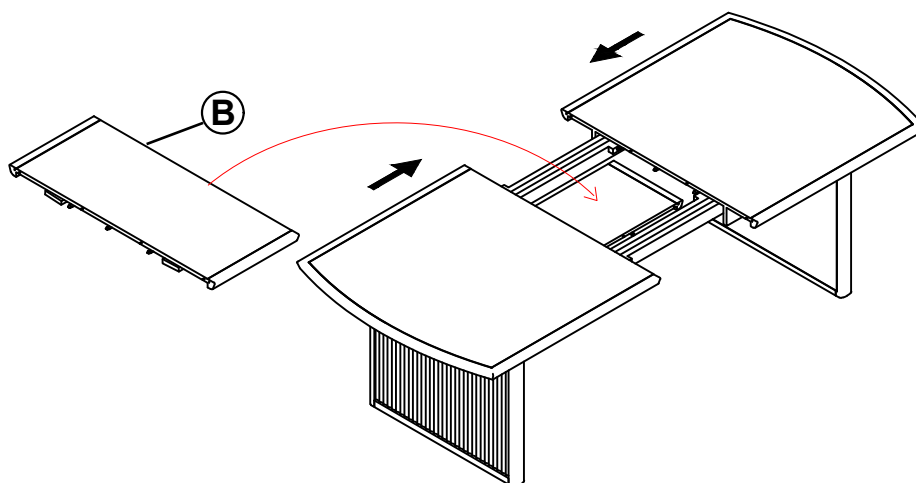

STEP 3
COMPLETE

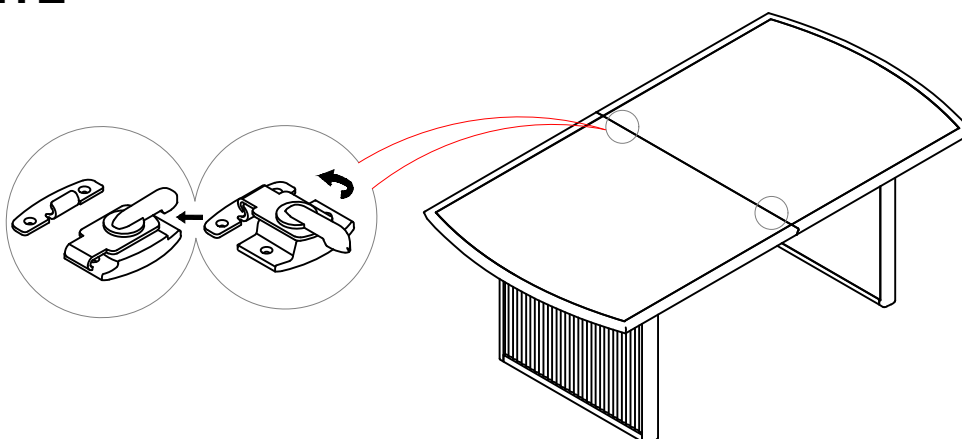

ITEM: **108231**



ASSEMBLY INSTRUCTIONS

STEP 4

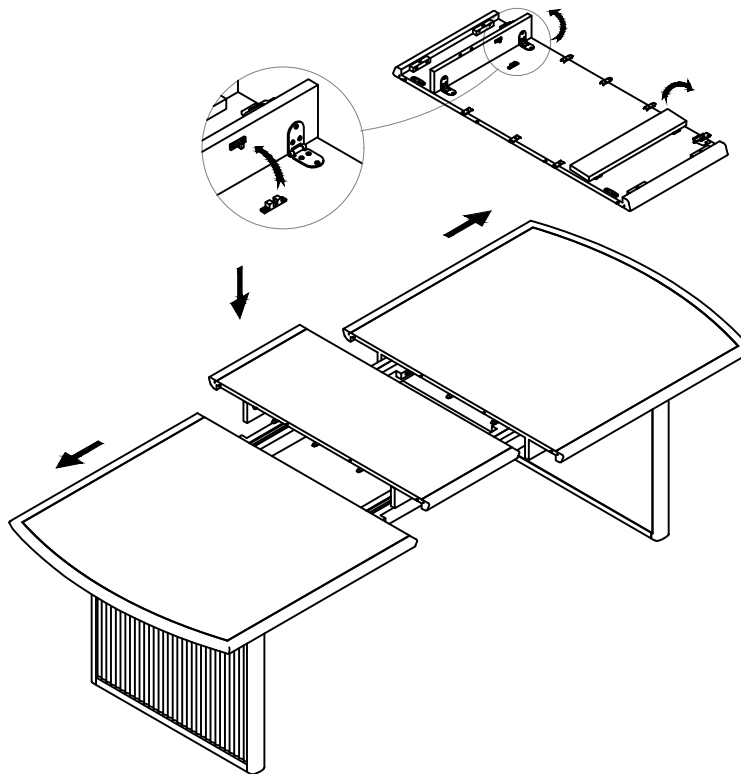

STEP 5

COMPLETE

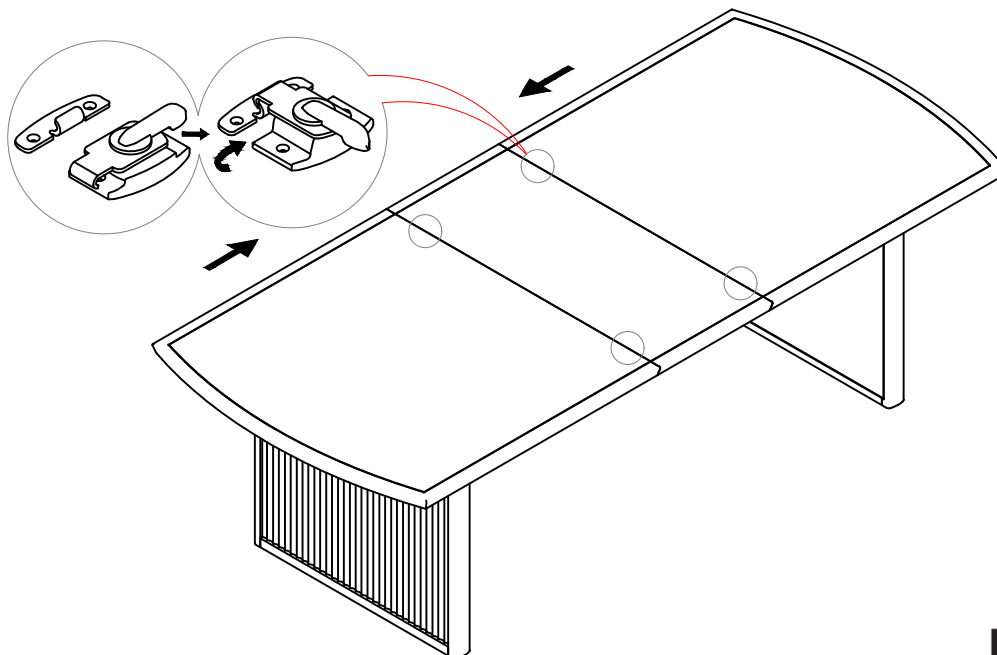

ITEM: **108231**

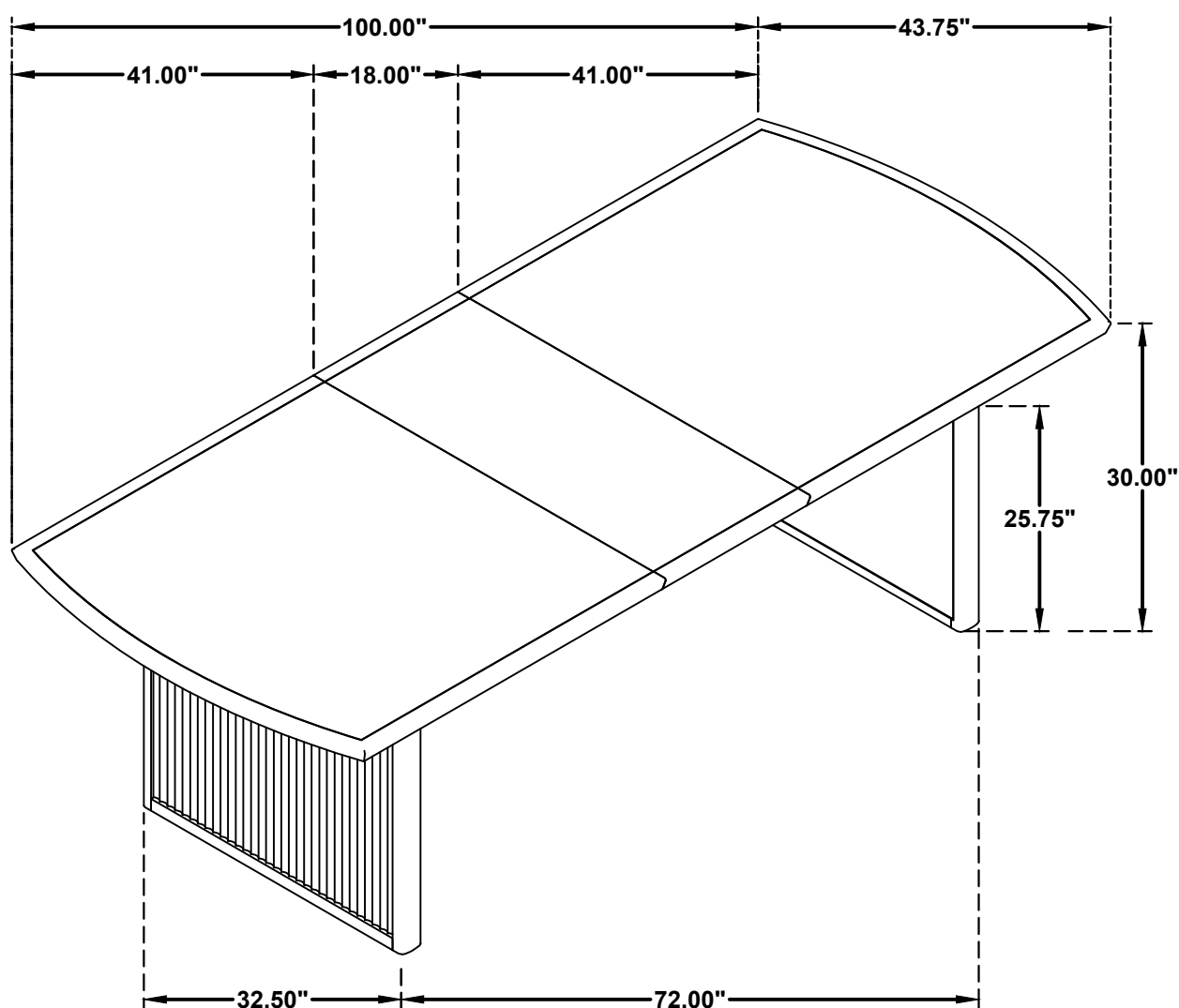

Note : Dimension tolerance $\pm 5\%$