



BRAMBLE

PRODUCT TEARSHEET



Chinois Bench

Shown in: **CCA**

SKU: **25675**

Size: **42W x 17D x 18H in**



Overview

From the Mary Tudor collection, the Chinois Bench offers traditional seating and beautiful style to the entry, living area, or dining room. This bench features solid mahogany with an intricate base design that imparts traditional elegance. This piece is offered with a vast array of finish and distress options to create a truly custom design.

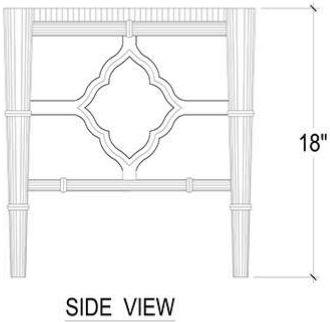
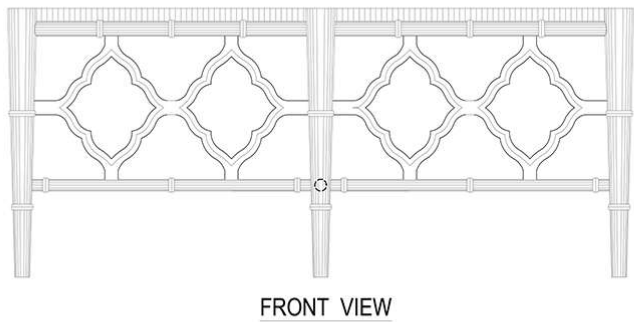
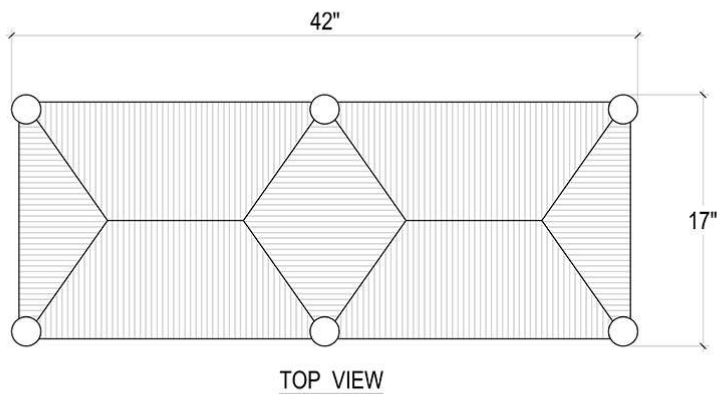

Visual Highlights





Technical Specification

Dimensions	42W x 17D x 18H in	CBM	0.276501
Number of Packages	1	Cubic Feet	9.76 ft³
Package 1 Dimensions	45.3 x 20.1 x 23.6 in	Package 1 Weight	29.76 lbs
Package Weight Total	29.76 lbs	Net Weight	24.25 lbs
Material	Mahogany, Rush Seat		

<https://www.brambleco.com/25675>