

PRESRV™

## REFRIGERATOR DRAWERS

DUAL ZONE



From snacks for the kids to the freshest produce to party-ready food and drinks, these stylish under-counter Panel Ready Dual Zone Refrigerator Drawers beautifully harmonize with your cabinetry and give you additional cold storage right where you need it. This large capacity refrigerator

maintains two distinct temperature zones and is loaded with features like Quick Chill to instantly lower overall refrigerator temperature; handy temperature presets; Full-Extension, Soft-Close Drawers; and the ability to blend into your kitchen cabinetry seamlessly.

**ZEPHYR**

ZEPHYRONLINE.COM



Quick Chill



Shown with overlay panel and custom handle (not included)

### How Presrv™ Stands Out:

33°

#### PreciseTemp™

Multiple internal sensors help maintain accurate temperatures and increase overall performance



#### Drawer Organizers

Customizable drawer organizers help keep everything in its place



#### Active Cooling Technology

An on-board computer controls active cooling fans to provide temperature stability and even cooling



#### Soft-Close Drawers

Close more smoothly and quietly to prevent shifting of drawer contents

### Overlay Panel Dimensions\*

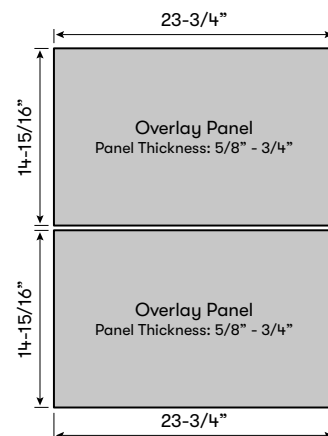

\*panel not included

**MODEL**

Dual Zone

Refrigerator Drawers

PRRD24C2AP

**Size**

24"

**Dimensions**

23-7/8"W x 33-7/8"H x 24"D

**Weight**

121 lbs.

**Installation Type**

Compact / Built-in

**Refrigerant Type**

R600a

**FEATURES****Volume**

5.1 cu/ft

**Temperature Range**

33° - 65° F (each zone)

**Sound Level**

38 dBA

**Exterior Drawer Finish**

Panel-Ready, no handle

**Interior Drawer Finish**

Stainless Steel

**Exterior Cabinet Finish**

Black

**Interior Cabinet Finish**

Black

**Full-Extension Drawers**

Yes

**Soft-Close Drawers**

Yes

**Removable Silicone Drawer Mats**

Yes

**Drawer Organization**Adjustable Bar Dividers +  
Transparent Drawer Tray**Lighting**3-Color LED Lighting  
Cloud White, Deep Blue, Amber**Controls**

3-Color Electronic Touch

**Preset Temperature Modes**

Produce, Beverage, Wine

**Quick Chill**

Yes, for faster cooldown

**Door Open Alarm**

Yes

**Dual Evaporators**

Yes

**Sabbath Mode**

Yes

**ENERGY STAR® Certified**

Yes

**PreciseTemp™**

Yes

**Active Cooling Technology**

Yes

**AC POWER**

115V, 60Hz at Max. 1.5A

**OPTIONAL ACCESSORIES****Drawer Pan Kit**

DRPAN241S

**Contemporary Handle\***

PRHAN-C101 (Stainless Steel, x1)

**Contemporary Handle\***

PRHAN-C102 (Brushed Gold, x1)

**Contemporary Handle\***

PRHAN-C104 (Matte Black, x1)

**Pro Handle\***

PRHAN-C001 (Stainless Steel, x1)

**Pro Handle\***

PRHAN-C003 (Brushed Gold, x1)

**Pro Handle\***

PRHAN-C004 (Matte Black, x1)

**WARRANTY**

2 years parts, 2 years labor

5 years compressor

\*1 handle included, 2 handles needed.

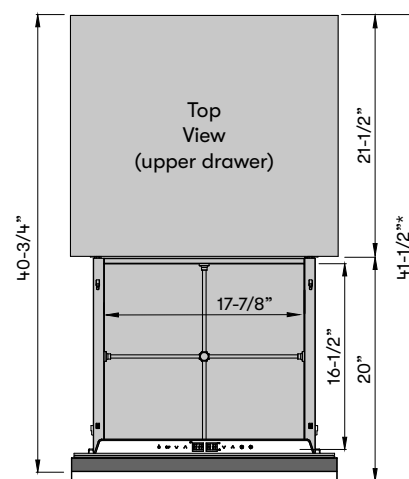

\*Depth with 3/4" thick overlay panel

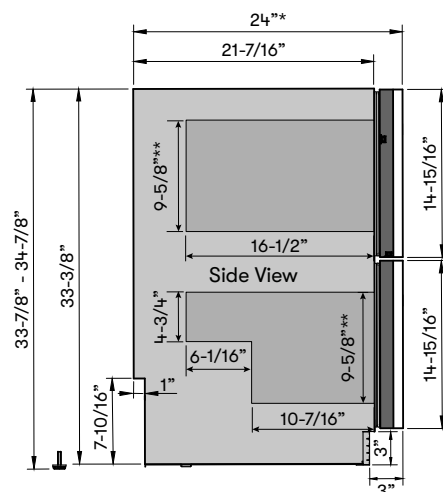

\*Depth with 3/4" thick overlay panel

\*\* Maximum clearance height inside drawers is 12"

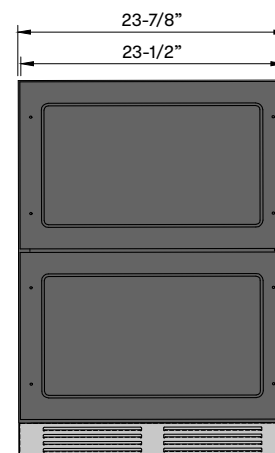
**Transforming the Kitchen through Design, Discovery, and Care**Specifications subject to change, check zephyronline.com for up-to-date information.  
Zephyr | 2277 Harbor Bay Parkway, Alameda, CA 94502 | 888.880.8368

AUG25.0101

