

ASSEMBLY INSTRUCTION

(for connecting the wire of the light on this curio)

ITEM: 3031-50001 Bunching Curio-Ebony Antiqued Oak

Thank you for purchasing this quality product. Be sure to unpack carefully looking for small parts which may have come loose during shipment.

Read all instruction and study the drawing carefully before starting the assembly process.

HARDWARE PACK

NO.	DRAWING	DESCRIPTION	SIZE	Q'TY
A		Anti - Tip Kit		1 PC

Tipping Restraint

The adjustable glass shelves are packed in inner box to avoid damage during transit. Take out glass shelves from box and place them on wood shelf frames.

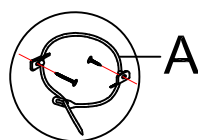

Anti-tip kit is included for use. We recommend installing for safety reason.

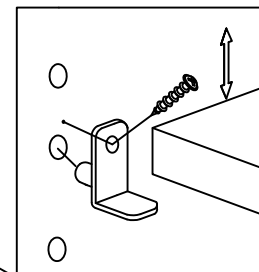
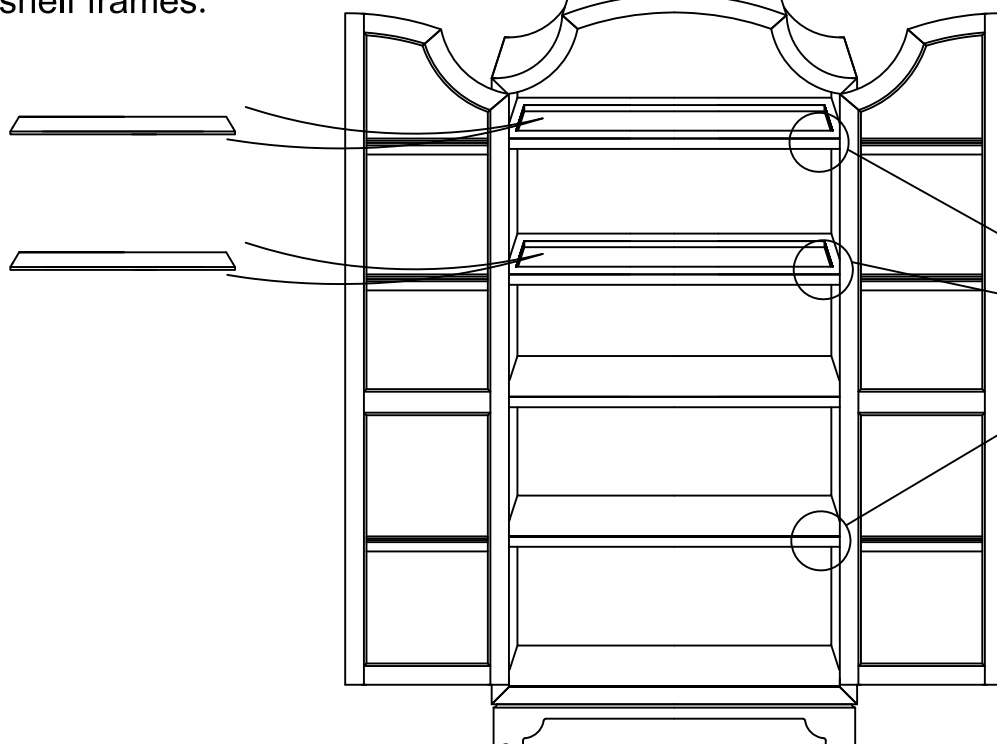

To adjust the shelf height, take out shelf pins then place shelf pins in the desired level.

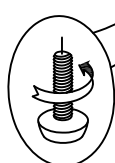

Adjust leveler if needed to level curio on uneven floor.

Note: Anti-tip kit restraint is provided.
Please follow the instructions enclosed with the pack.

ASSEMBLY INSTRUCTION

(for connecting the wire of the light on this curio)

ITEM: 3031-50001 Bunching Curio-Ebony Antiqued Oak

Thank you for purchasing this quality product. Be sure to unpack carefully looking for small parts which may have come loose during shipment.

Read all instruction and study the drawing carefully before starting the assembly process.

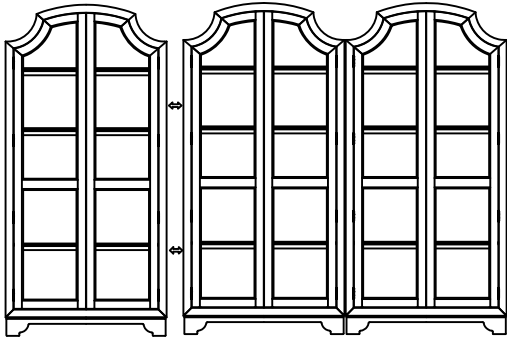

- A—— male connector (of the power switch)
- B—— female connector (of the power switch)
- C—— male connector (of the can light)
- D—— female connector (of the can light)
- E—— male connector (of the power wire)
- F—— female connector (of the power wire)

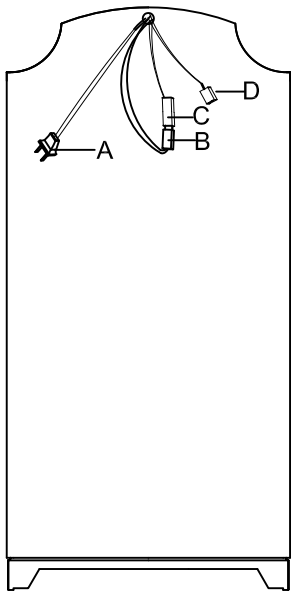

Diagram 1

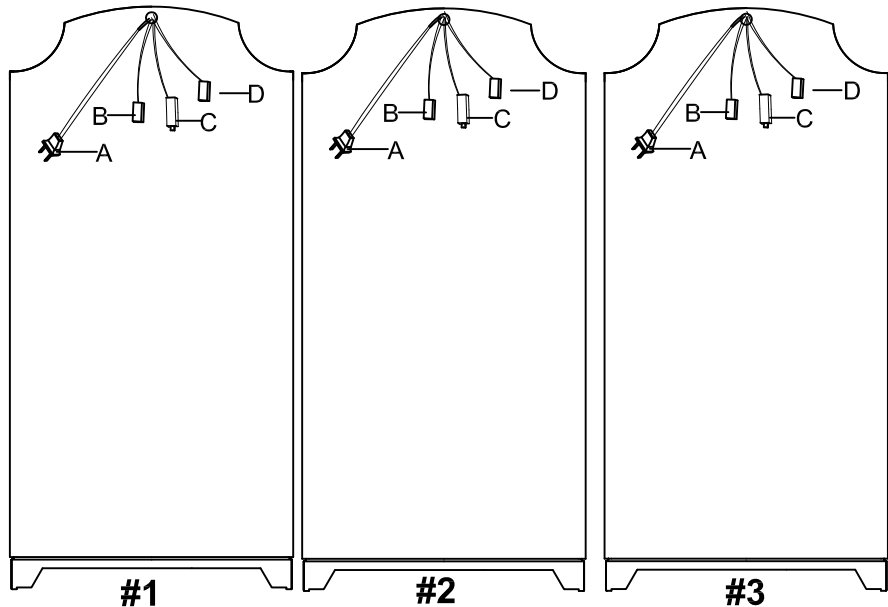

Diagram 2

Assembly Steps

1. When each piece of curio is used alone, attach male connector of the power switch (A) to a wall plug. (See Diagram 1)
2. Touch dimmer is at the inside of right post.
3. If you want to bunch two or more curios together, place them all side by side in a desired location.
4. Leave male connector of the can light (C) and female connector of power switch (B) for the first curio (#1) as it is. Keep male connector of the can light (C) and female connector of power switch (B) off for the rest curios (#2, #3, and so on). (See Diagram 2)

ASSEMBLY INSTRUCTION

(for connecting the wire of the light on this curio)

ITEM: 3031-50001 Bunching Curio-Ebony Antiqued Oak

Thank you for purchasing this quality product. Be sure to unpack carefully looking for small parts which may have come loose during shipment.

Read all instruction and study the drawing carefully before starting the assembly process.

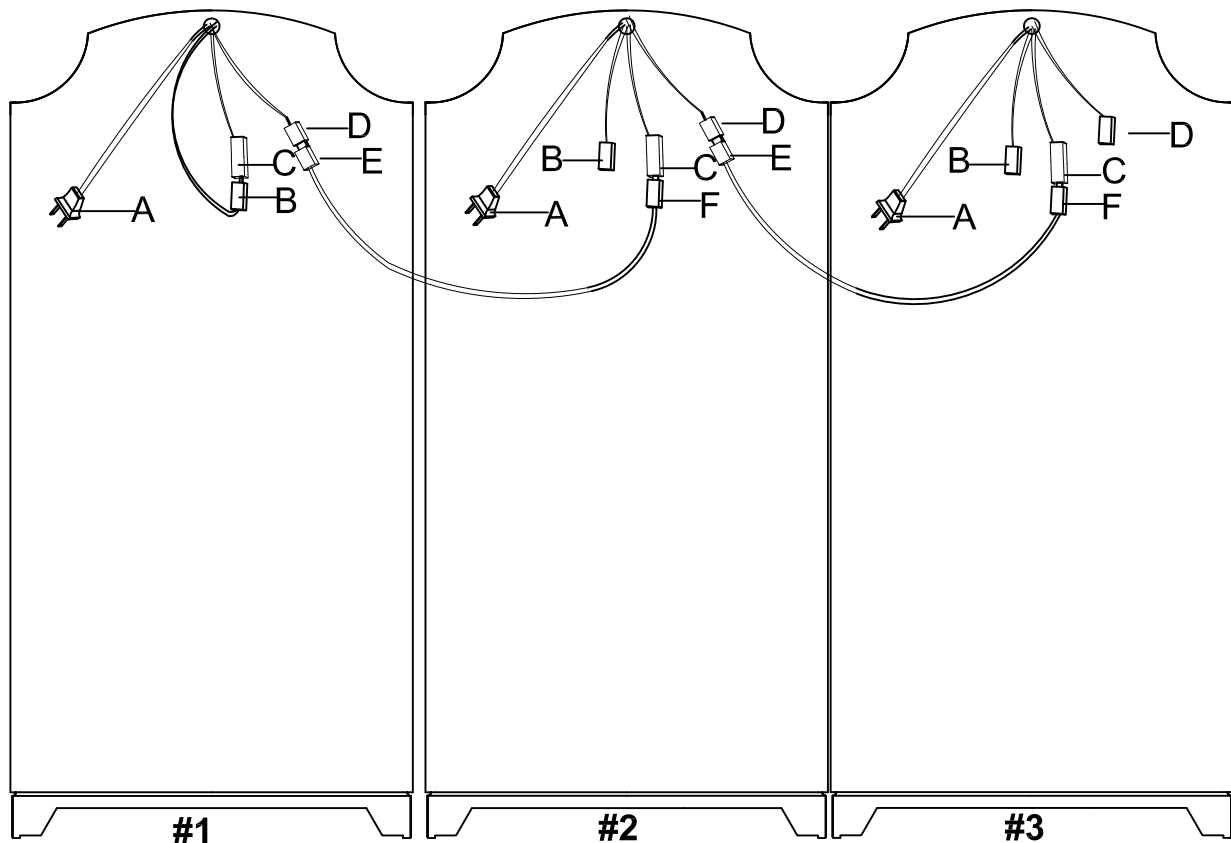

Diagram 3

Assembly Steps

5. Connect female connector of the can light (D) (#1 curio) with male connector of power wire (E), then have female connector of power wire (F) connected to male connector of can light (C) (the #2 curio). (See Diagram 3)
6. Repeat step 5 for the 3rd curio and the rest ones when more than two are bunched together till each one is connected.
7. Plug in male connector of power switch (A) (#1curio).
8. Touch the dimmer of the #1 curio, all can lights connecting together will be on at the same time.