

Assembly Instructions

Momentum Power Recliner

BEFORE ASSEMBLE

Thank you for purchasing this quality product. This product has been designed for easy assembly and constructed for durability. Please take the time to read and follow the assembly instructions carefully.

Power Recliner

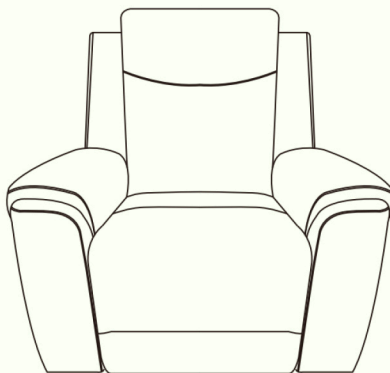

Part List

When unpacking, please be careful not to discard any parts with the packaging. Before continuing, please make sure you have the following parts:

No	Description	Sketch	Qty
A	Body		1 PC
B	Back Cushion		1 PC
C	LAF Wing		1 PC
D	RAF Wing		1 PC
E	Wall plug transformer		1 PC

Step 1

Before removing the product from the carton, detach and remove the plywood from the frame using screw driver as shown in the diagram.

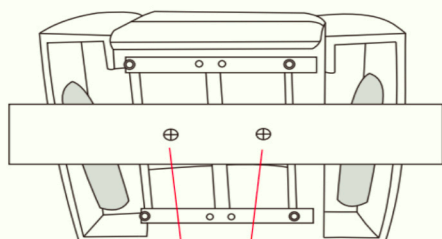

Screws' dim:5x80mm

Step 2

1. Remove LAF Wing and RAF Wing from under seat. Meanwhile, untie the wall plug transformer.

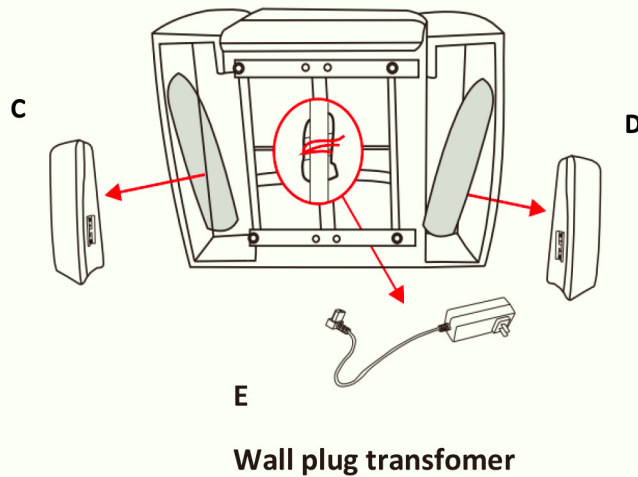

Step 3

1. Install the Backrest (B) into the Seat (A) by positioning the female metal receiver brackets over the male metal posts. Ensure that female metal receiver brackets on each side of the backrest line up with the seat metal posts. Push the female brackets down male posts simultaneously until each side is locked into place and an audible "click" is heard.

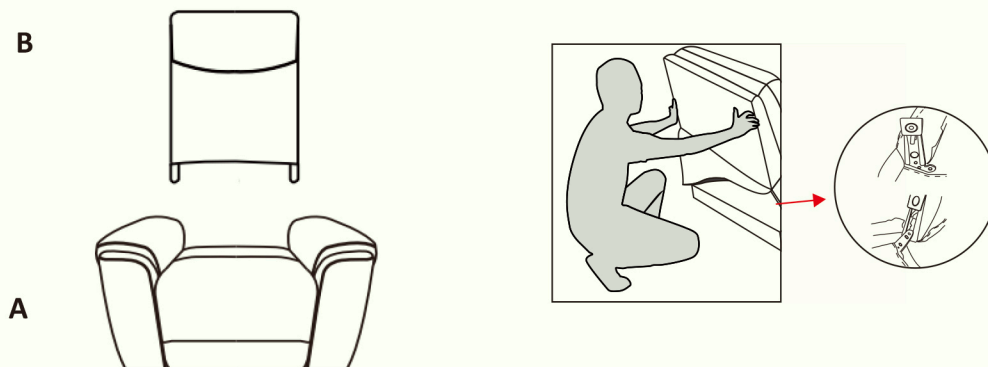

2. Install the LAF Wing (C) and RAF Wing (D) by sliding wing in a downward motion along the side of the seat back to connect the brackets.

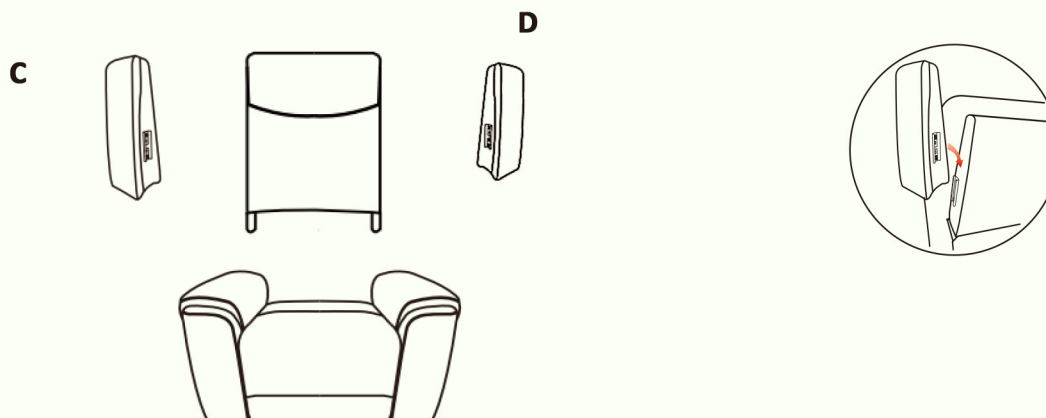

Step 3

3. Connect the wire. A wire with yellow lable for headrest motor connect with yellow, C wire in green lable for seat motor connect with green, B in round shape for heat massage and hand control.

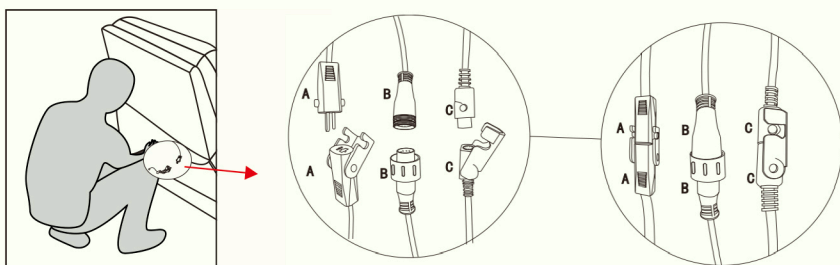

Seat contains 2.2 Density Foam, Back Cusion contains 100% Fiber.

4. Attach the flap to the seat frame by pulling the flap down, and pressing the bottom hem under the seat base, connecting the velcro.

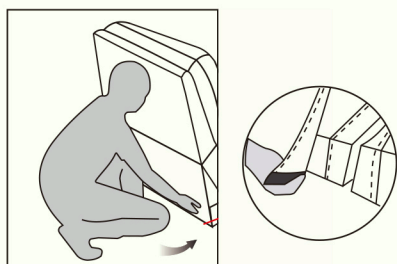

Power Connection

Connect firmly one end of the wall plug transformer cord into the DC adapter located in the lower back corner of Recliner and plug the other end into a power outlet/wall socket and enjoy.

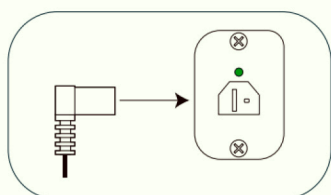
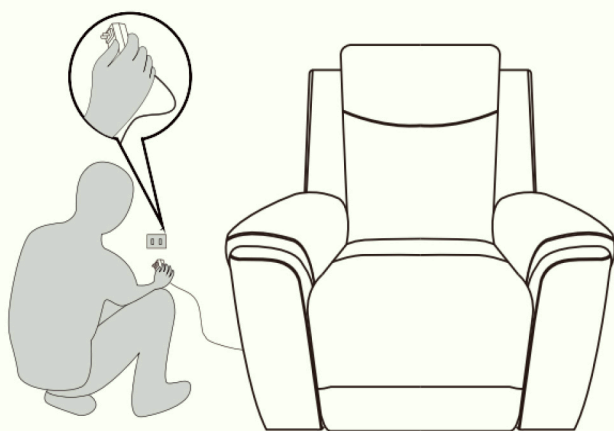

Easy to use hand control

