

5.0 cu. ft. Mega Capacity Smart Front Load Washer with TurboWash® 360° and AI DD® Built-In Intelligence

- 5.0 cu. ft. Mega Capacity
- Built-In Intelligence: AI Fabric Sensor / Smart Pairing™
- TurboWash® 360° Technology
- Allergiene® Cycle
- Pet Care Cycle

AVAILABLE COLORS

- GRAPHITE STEEL
- ALPINE WHITE



LG ThinQ®

Enjoy new ways to control your home with LG smart appliances

- Use the ThinQ® app to start the laundry while you're out
- Get alerts when the cycle is finished
- With Smart Pairing™, the washer can tell the dryer to select a compatible drying cycle



SUMMARY		APPERANCE		MATERIALS AND FINISHES	
Type	Front Load Washer	Control & Display	Electronic Control Panel with LCD Display	NeveRust® Stainless Steel Drum	Yes
Capacity	5.0 cu.ft	Touch Buttons	Yes	Cabinet	Painted Steel (One Unit)
Matching Electric Dryer	DLEX5800X	Dial-A-Cycle®	Yes	Control Panel	
Matching Gas Dryer	DLGX5801X	FABRIC CARE FEATURES		Top Plate	Painted Steel
Matching Heat Pump Dryer	N/A	AI DD®	Yes	Door/Rim	Glass/Chrome
Color	Graphite Steel (V) Alphine White (A)	TurboWash® 360 Technology	Yes	Door Cover	Tempered Glass Door
WASH PROGRAMS		Steam Technology	Yes	All Available Colors	Graphite Steel (V) Alpine White (A)
No. of Programs	29	Allergiene® Cycle	Yes	ENERGY	
Wash Programs	Normal, AI Wash, Bedding, Delicates, Towels, Quick Wash, Heavy Duty, Allergiene™ Perm. Press, Tub Clean, ColdWash™, Pet Care, Microplastics care, BrightWhites™, Sanitary, Rinse & Spin, Spin Only, Hand/Wool, Activewear, Swimwear, Kids Wear, Jeans, Dresses, Color Care, Sweat Stains, Small Load, Large Load, XL Load	Sanitary Cycle	Yes	ENERGY STAR® Most Efficient	Yes
		CONVENIENCE FEATURES		ENERGY STAR® Certified	Yes
		Vibration sensing (Cabinet Vibration sensor)	Yes	CEE Tier	Tier 3
		TrueBalance®	Yes	IMEF	3.1
		Anti-Vibration System		IWF	2.9
		POWER SOURCE			
No. of Options	13	4 Tray Dispenser	Prewash, Main Wash (with liquid detergent cup), Bleach, Fabric Softener	Ratings	UL Listed
Options	TurboWash®, Steam, Fresh Care, Pre-wash, Remote Start, Delay, Wi-Fi, Extra Rinse, Control Lock, Drum Light, Soak, Signal, "More Cycles" Edit, Overnight Wash	End of Cycle Signal	Yes	Electrical Requirements	120 V, 60 Hz, 10 A
		Load Sense	Yes	Type	Electric
		Control Lock	Yes	OPTIONS/ ACCESSORIES	
		Auto Suds Removal	Yes	Pedestal	WDP6V, WDP6A
		Leveling Legs	4 Adjustable Legs	Pedestal (WxHxD)	27" x 13 5/8" x 28" (43 7/8" D with door open)
WASH DETAILS		SMART FEATURES (ThinQ® TECHNOLOGY)		LG Sidekick® Pedestal Washer	WD300CV, WD300CA
No. of Wash/Rinse Temps	5	Drumlight	Yes	LG Sidekick® Pedestal Washer (WxHxD)	27" x 14 1/8" x 30 3/4" (50 1/2 with drawer open)
Wash/ Rinse Temps	Extra Hot/ Hot/ Warm/ Cold/ Tap Cold	MOTOR		Stacking Kit	KSTK4
No. of Spin Speed	5	Proactive Cutomer Care	Yes	LIMITED WARRANTY	
Spin Speeds	Extra High/ High/ Medium/ Low/ No Spin	Smart Diagnosis (v3.0)	Yes	Parts & Labor	1 Year
Max RPM	1300	Wi-Fi	Yes	Drum	3 Years
Water Levels	Load Sensing	NFC Tag on Technology	No	Direct Drive Motor	10 Years
No. of Soil Levels	5	Energy Monitoring	Yes	UPC CODES	
		Tub Clean Coach	Yes	WM5800HVA (Graphite Steel)	048231349796
		Motor Type	Inverter Direct Drive Motor	WM5800HAA (Alpine White)	195174122358
		Axis	Horizontal		

DIMENSION / CLEARANCES

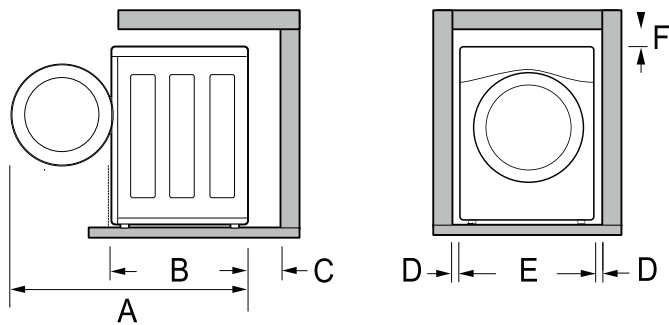

DIMENSIONS	
Product (WxHxD)	27" x 39" x 33 1/8"
Depth with Door Open	57 3/4"
Carton Dimensions (WxHxD)	29 1/8" x 41 7/8" x 33 3/8"
Approx. Weight (Product / Carton)	203.9 lbs / 224.9 lbs
A	57 3/4" (146.6cm)
B	33 1/8" (84cm)
C	4" (10cm)
D	1" (2.5cm)
E	27" (70cm)
F	1/4" (0.5cm)

DIMENSION / CLEARANCES

To ensure sufficient clearance for water inlet hoses, drain hose and airflow, allow minimum clearances of at least 1" (2.5 cm) at the sides and 4" (10 cm) behind the appliance. Be sure to allow for wall, door, or floor moldings that may increase the required clearances.

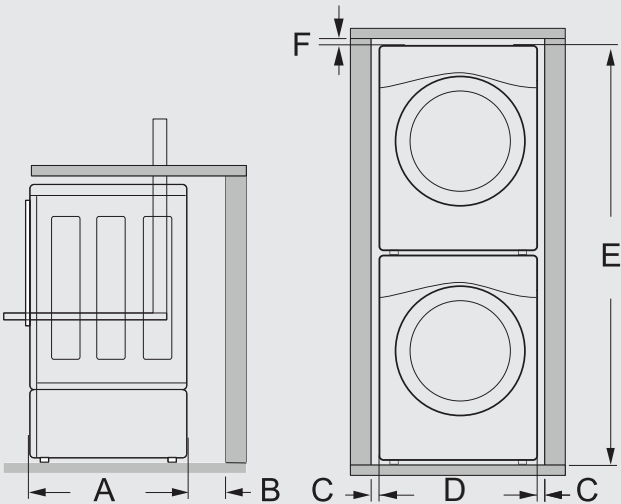

Stacking or Pedestal Installation

- The washer can be stacked under a dryer or on top of a pedestal or pedestal washer.
- Refer to the instructions packaged with the optional pedestal kit before stacking appliance on pedestal.
 - Do not use a drain pan with a pedestal or pedestal washer installation as it can block the drawer. Using a drain pan may result in increased vibration and noise during operation.

DIMENSIONS	
A	33 1/8" (84cm)
B	4" (10cm)
C	1" (2.5cm)
D	27" (70cm)
E	77 1/2" (196.8cm)
F	1/4" (0.5cm)

CONNECTING THE WATER INLET HOSE

- Check the fittings and seals. Inspect the threaded fitting on each hose and make sure there is a rubber seal ❶ in place in both ends of each hose to prevent leaking.
- Connect the water inlet hoses to the hot and cold water faucets tightly by hand and then tighten another 2/3 turn with pliers.
- Connect the blue hose to the cold water faucet and the red hose to the hot water faucet.

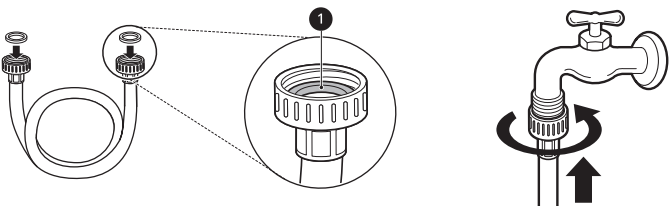

Flush out the inlet hoses.

- After the hoses are connected, turn on the water faucets and flush out any foreign substances such as dirt, sand, or sawdust. Foreign substances can damage washer inlets and lead to leakage.
- Let the water drain into a bucket, and check the water temperature to make sure you've connected the hoses to the correct faucets.

Attach the inlet hoses to the back of the washer.

- Attach the hot water inlet hose to the hot water inlet on the back of the washer. Attach the cold water inlet hose to the cold water inlet on the back of the washer.
- Tighten the fittings securely. Turn on both faucets all the way and check for leaks at both ends of the hoses.

