

## CSOP2450TE/S/T

### FEATURES

The elegant, modern aesthetics pair perfectly with a full suite of similarly styled Sub-Zero, Wolf, and Cove appliances.

Plumbed and non-plumbed options for maximum installation flexibility.

Full-color touchscreen simplifies use

Save up to 50 personalized favorite recipe presets.

Cooking modes include Steam, Convection, Broil, Slow Roast

1750-Watt recessed broil element.

The 24" model offers a 1.7 cubic-foot interior--space enough to prepare multiple dishes at once (or a 15-lb turkey).

Three full-extension rack positions and one standard position allow easy access and increased cooking flexibility.

The temperature probe alerts you when your dish has reached the desired temperature.

### ACCESSORIES

Broil Rack

Descaling Solution

Perforated Pan - 12 3/4" x 1 1/2" x 7"

Perforated Pan - 17 3/4" x 1 1/4" x 15"

Porcelain Steam Enameled Broil Pan

Pro Handle

Solid Pan - 12 3/4" x 1 1/2" x 7"

Solid Pan - 17 3/4" x 1 1/4" x 15"

Standard Oven Rack

Temperature Probe

Accessories available through an authorized dealer.

For local dealer information, visit [subzero-wolf.com/locator](https://subzero-wolf.com/locator).



**PRODUCT SPECIFICATIONS**

|                          |   |
|--------------------------|---|
| Model                    | CSOP2450TE/S/T  |
| Dimensions               | 23 1/2"W x 17 7/8"H x 22 1/2"D                        |
| Oven Interior Dimensions | 17 1/2"W x 10 3/4"H x 15 1/8"D                        |
| Overall Capacity         | 1.7 cu. ft.   |
| Usable Capacity          | 1.2 cu. ft.   |
| Door Clearance           | 14 3/16"  |
| Weight                   | 91 lbs  |
| Electrical Supply        | 240/208 VAC, 60 Hz                                    |
| Electrical Service       | 20 amp dedicated circuit                              |
| Plumbing Supply          | 3/8" OD copper, braided stainless steel or PEX tubing |
| Plumbing Pressure        | 15–145 psi  |
| Conduit Length           | 4 Feet  |

**DIMENSIONS**

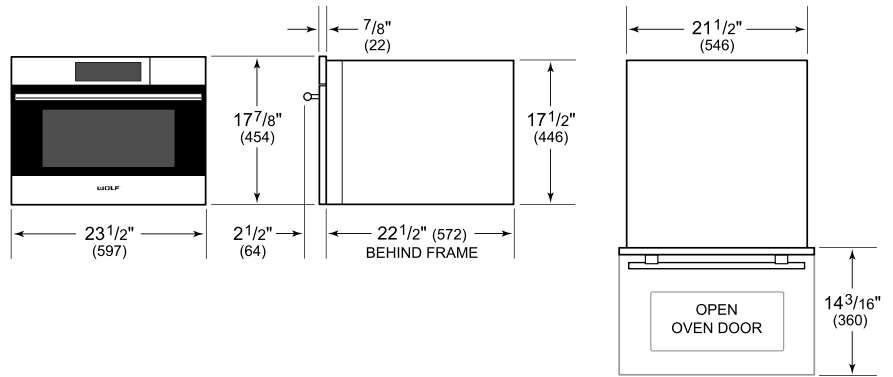

**ELECTRICAL**

**PLUMBING**

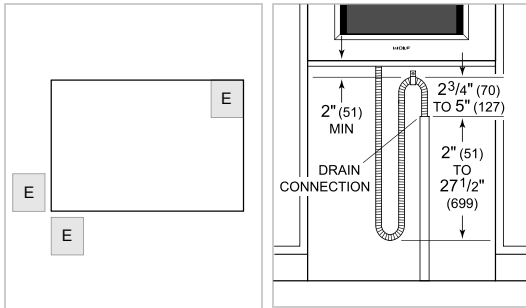

**NOTE:** Dimensions in parenthesis are in millimeters unless otherwise specified

**STANDARD INSTALLATION**

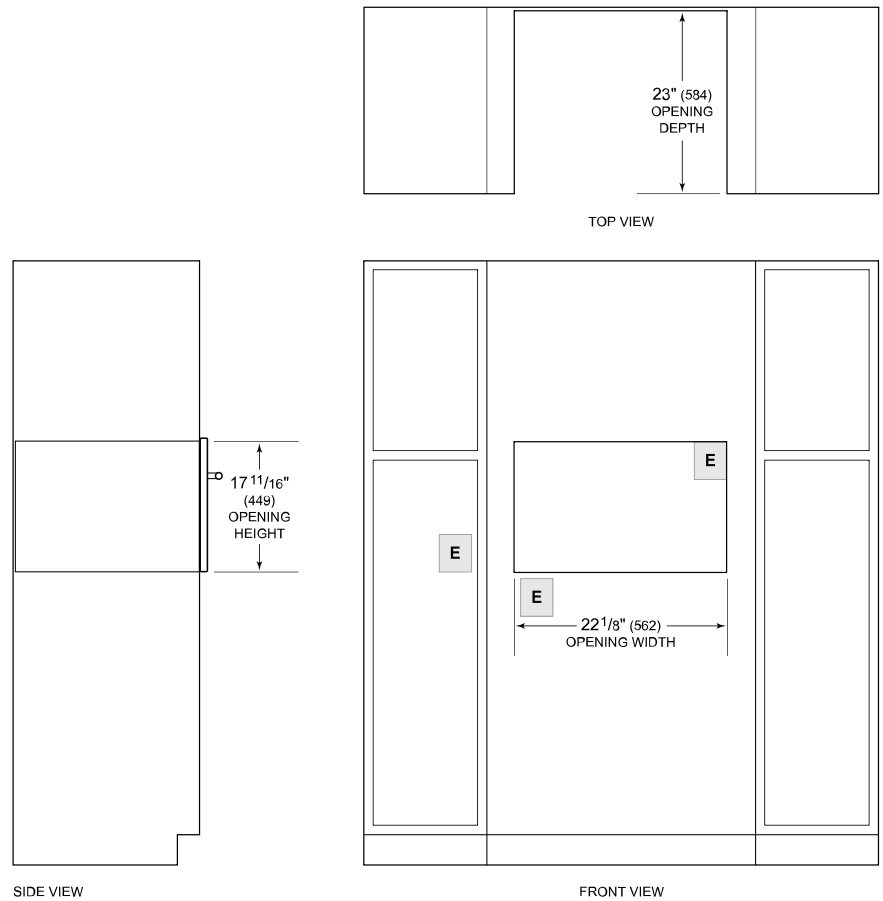

**NOTE:** Location of electrical supply within opening may require additional cabinet depth.