



ASSEMBLY INSTRUCTIONS

COASTER FINE FURNITURE



Fine Furniture for every stage of life

225052
Nightstand

ITEM: **225052**

ASSEMBLY INSTRUCTIONS

ASSEMBLY TIPS:

1. Remove hardware from box and sort by size.
2. Please check to see that all hardware and parts are present prior to start of assembly.
3. Please follow attached instructions in the same sequence as numbered to assure fast & easy assembly.



WARNING!

1. Don't attempt to repair or modify parts that are broken or defective. Please contact the store immediately.
2. This product is for home use only and not intended for commercial establishments.

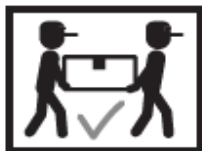

ASSEMBLY TIME

5 MINUTES

PARTS IDENTIFICATION

A NIGHTSTAND



1PC

B RIGHT FRONT LEG



1PC

C LEFT FRONT LEG



1PC

D RIGHT BACK LEG



1PC

E LEFT BACK LEG



1PC

HARDWARE IDENTIFICATION

1 BOLT
(Φ5/16" x 45mm - RBW)

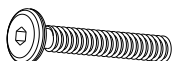

8PCS

3 FLAT WASHER
(Φ5/16" - RBW)



8PCS

2 LOCK WASHER
(Φ5/16" - RBW)



8PCS

4 ALLEN WRENCH
(4MM x 60MM - RBW)



1PC

ITEM: **225052**

ASSEMBLY INSTRUCTIONS

STEP 1

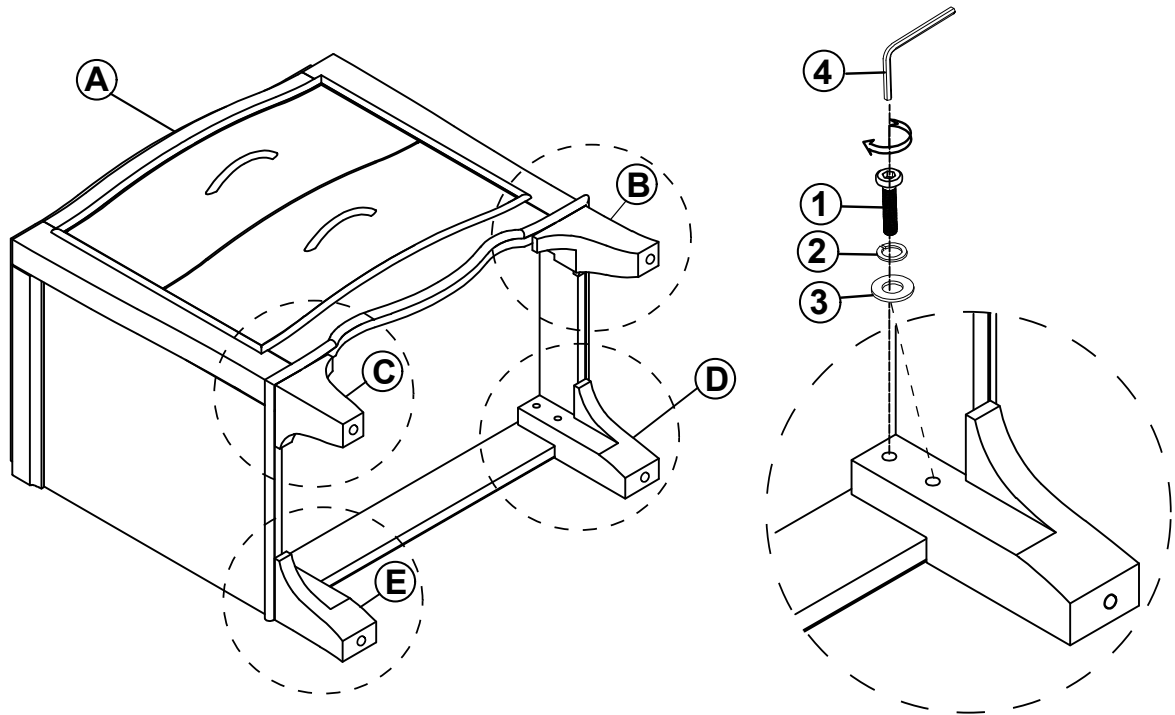

STEP 2 COMPLETE

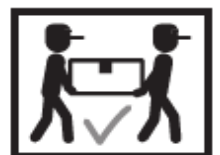
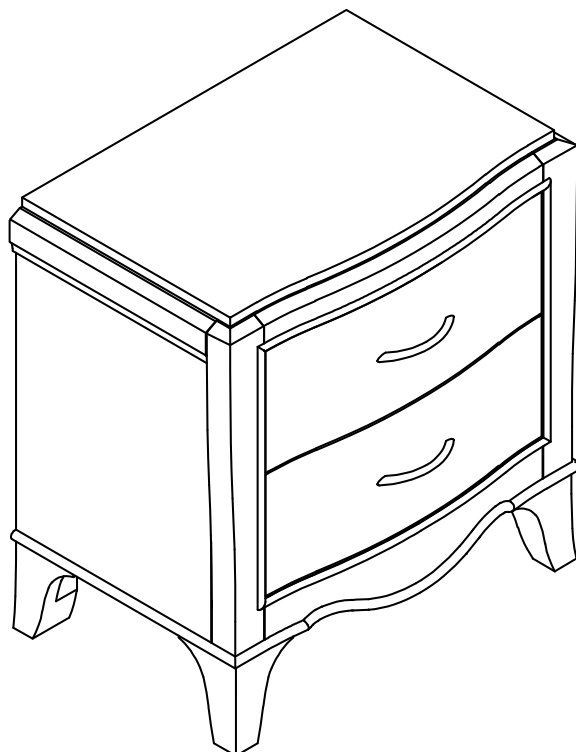

ITEM: **225052**



Inner Size of Drawer : 19.25"W X 13.50"D X 6.00"H X 0.50"T

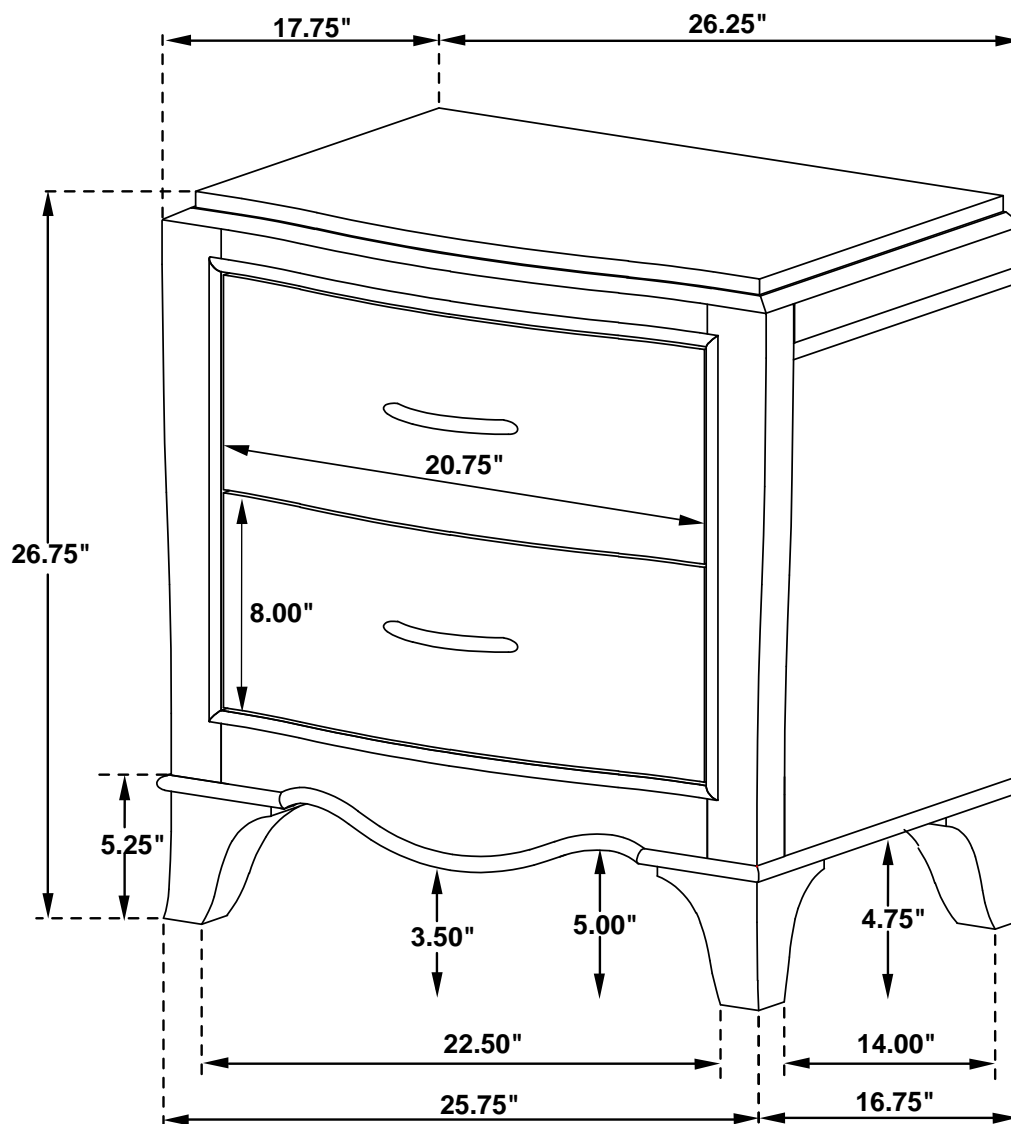

Note: Dimension tolerance $\pm 5\%$