

The Savant® On-Wall Media Dock is available in two colors: Black OWM-210B or White OWM-210W. This Quick Reference Guide provides the information necessary to install the On-Wall Media Dock for Apple iOS devices.

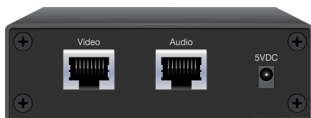
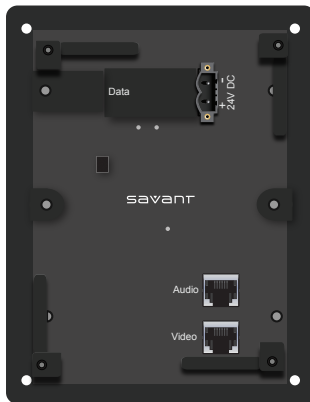

Media Dock Receiver – Front and Rear View

Box Contents

- (1) On-Wall Media Dock Assembly (OWM-210X)
- (1) Cut out template (009-0247-xx)
- (1) On-Wall Media Dock Bezel (074-0191-xxB/W)
- (1) Installation Kit (075-0118-xx for Black/075-0119-xx for White)
 - (1) Power cord, detachable 10A Plug, 1.83 M, 1250W (064-0048-xx) or appropriate international cord.
 - (1) 24V DC 60 Watt Power Supply (025-0046-xx)
 - (1) 5V DC 2.5 Amps power supply (025-0098xx)
 - (8) #6 x 1/4 Screw (039-0143-xx)
 - (4) #6 x 1.5 Screw (039-0068-xx)
 - (4) #6-32 x 1.75 Screw (039-00209-xx)
 - (2) 2-position phoenix connector (028-9160-xx)
 - (1) Media Dock Filler Plate (074-0225-xxB/W)
 - (2) Side Mounting Brackets for Extender Boxes (071-0494-xx)
- (1) Media Dock Receiver (068-0305-xx)
- (1) Quick Reference Guide (this document)

Specifications

Environmental	
Operating Temperature	32° to 104° F (0° to 40° C)
Operating Humidity	10% to 90% Non-condensing
On-Wall Media Dock – Dimensions, Weight and Power	
Dimensions (H x W x D)*	6.5 in x 5.0 in x 2.7 in (16.5 cm x 12.7 cm x 6.85 cm)
Weight	0.5 lb/0.23 kg
On-Wall Media Dock – Power	
Supply	24V DC, 120-230V AC, 50/60 Hz
Maximum Power Draw	8 Watts
Media Dock Receiver – Dimensions, Weight and Power	
Dimensions (H x W x D)	1.27 in x 4.23 in x 6.20 in (3.23 cm x 10.73 cm x 15.74 cm)
Weight	1.5 lb/0.68 kg
Media Dock Receiver – Power	
Supply	5V DC, 120-230V AC, 50/60 Hz
Maximum Power Draw	2 Watts
Compliance	
Safety and Emissions	FCC Part 15/CE Mark/C-Tick
RoHS	Compliant

* Overall dimensions for dock, not cut out dimensions.

Connections

On-Wall Media Dock	
Data (Input from Network)	Port Type: RJ-45 Cable: Cat 5, use for system control (data)
24VDC port (input power)	24V DC, 120-230V AC, 50/60 Hz
Audio (Output to Media Dock Receiver)	Port Type: RJ-45 Cable: Cat 5, use with MDR-200 for audio transmission up to 100 meters.
Video (Output to Media Dock Receiver)	Port Type: RJ-45 Cable: Cat 5, use with MDR-2000 for video transmission up to 100 meters.
Media Dock Receiver – Front	
Video (Input from On-Wall Media Dock)	Port Type: RJ-45 Cable: Cat 5, use for video transmission up to 100 meters.
Audio (Input from On-Wall Media Dock)	Port Type: RJ-45 Cable: Cat 5, use for audio transmission up to 100 meters.
5VDC (Input power from power source)	Port Type: 4 mm x 1.35 mm 5V DC barrel power jack/connector 120-230V AC, 50/60 Hz
Media Dock Receiver – Rear	
Audio L, R (Output)	Port Type: RCA (Stereo)
Video R, B, G (Output)	Port Type: RCA (Component)

Typical Configuration

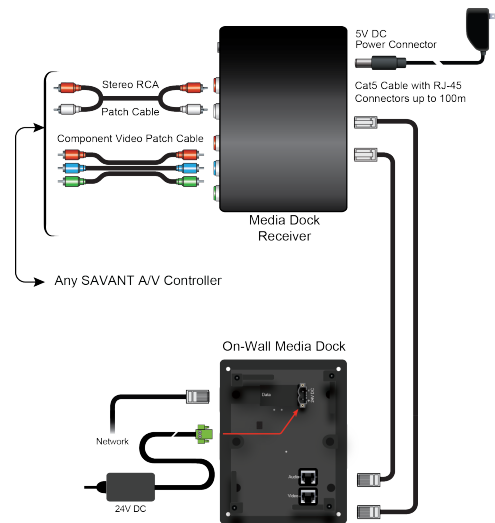

⚡ SURGE PROTECTION: Use a surge-protected circuit for all components requiring 120V AC, 50/60 Hz source power.

⚡ ELECTRICAL DISCONNECT: The 120V AC, 50-60 Hz source power outlet and input power sockets should be easily accessible in the event of an electrical hazard or malfunction condition.

⚡ ELECTRICAL DISCONNECT: The 5V DC power adapter on the Media Dock Receiver should be easily accessible in the event of an electrical malfunction.

Interconnecting the Components

When interconnecting components, refer to *Interconnecting Information* above.

1. Plug the DC power adapter to the Power Strip (surge protected).
2. Route the Cat 5 cables and the power cable from the Media Dock Receiver to inside the wall opening.
3. Connect the Cat 5 cables from the Media Dock Receiver to the On-Wall Media Dock ports as follows:

Media Dock Receiver	On-Wall Media Dock
Audio	Audio
Video	Video

4. After making the connections to On-Wall Media Dock, position the unit in the opening and secure with the two rotating mounting tabs.
5. Turn the tab screws clockwise; the tabs will grab the interior wall. Tighten until snug. **Do not over tighten.**

Caution: Do not use a powered screwdriver to tighten the tabs; the tabs can be easily over tightened.

Note: The On-Wall Media Dock also has screw-mounting holes for optional stud mounting.

6. Position the bezel over the Media Dock Assembly and press, ensuring that the wall plate seats properly.
7. Plug in the 5V DC for the MDR-2000.
8. Plug in the 24V DC for the OWM-210X.
9. Then connect the 120V AC, 50 Hz connector end to the power strip.
10. Configure the installation using RacePoint Blueprint™.

Optional Pre/Post-Construction Box

Note: The On-Wall Dock Assembly is not a weather resistant unit. Do not locate in a damp or humid area.

The OWM-210X can be installed with or without an On-Wall construction box. The On-Wall construction box for the iPod (RIB-OWMD) is optional and can be used pre-or post-construction to save the space required for the OWM-210X and to terminate the roughed in wires.

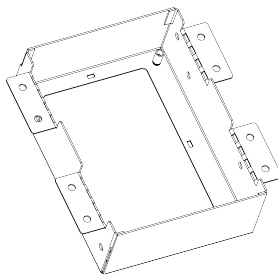

Installing the On-Wall Dock into the RIB-OWMD

1. Remove Retainer caps (4) from the back of the OWM-210X with pliers.
2. Remove flags (4) by removing the screws.
3. Place the OWM-210X into the RIB-OWMD and use the 6-32 screws (4) to attach.

MDR-2000 Mounting Bracket Installation

Use the supplied screws to install the Side Mounting Brackets (071-0494-xx) to the MDR-2000 as shown.

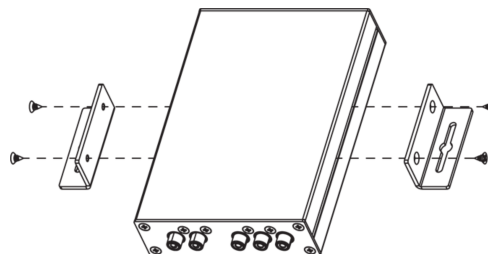

Additional Documentation

For more documentation, go to SavantSystems.com and navigate as follows:

- > **Dealer Login > Knowledge Base > Products**
 - Refer to the **Construction Box for On-Wall Dock (RIB-OWMD) Quick Reference Guide**
 - Refer to the **RacePoint Blueprint™ Programming Guide**

