

49 1/4"

1 TEMPLATE

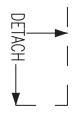
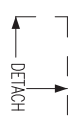

TEMPLATE 2 - THIS SIDE IS FOR BOTTOM OF THE CABINET

IMPORTANT
Read the instruction booklet for complete instructions before beginning installation. Template must be laid against the cabinet when locating the holes.

17 3/8"

INSTRUCTIONS

(See installation booklet for complete instructions)

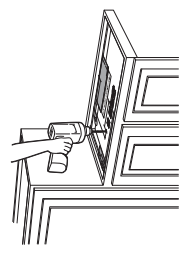

If you drill the 4 mounting holes from the bottom side of the cabinet—measure the thickness of the front rail and cut that amount of the template from the front side. Measure the distance from the front edge of the cabinet to the back side of the front rail and position. Drill the 4 holes 1/4" DIA. as described in the installation instruction booklet.

IMPORTANT
LAYOUT SIDE (THE LEFT AND RIGHT SIDES OF THIS TEMPLATE) MUST BE MARKED. THE LOCATION OF THE MOUNTING HOLES MUST BE MARKED. THE EXACT LOCATION OF THE MOUNTING HOLES MUST BE MARKED. OVERDEPEND ON WHETHER YOU CHOOSE TO DRILL FROM INSIDE THE CABINET (A) OR FROM THE BOTTOM SIDE OF THE CABINET (B). THE TEMPLATE SIDE (B) WILL MARK THE LOCATION OF THE HOLES ON THE OVER.

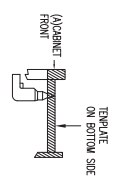

HOLE CENTER LINE

HOLE CENTER LINE

HOLE CENTER LINE

MICROWAVE SIDE B

MICROWAVE SIDE B

TEMPLATE CUT LINES

TEMPLATE CUT LINES

CABINET CORNER

MICROWAVE FRONT CONTROL PANEL SIDE

MICROWAVE FRONT DOOR SIDE

1 TEMPLATE

17 $\frac{5}{8}$ "

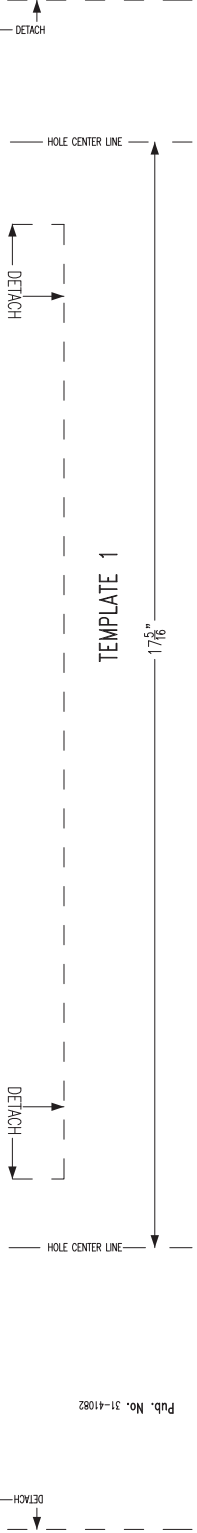

TEMPLATE 2 - THIS SIDE IS FOR INSIDE OF THE CABINET

IMPORTANT
Read the instruction booklet for complete instructions before beginning installation. Template must be held against the cabinet when locating the holes.

17 $\frac{5}{8}$ "

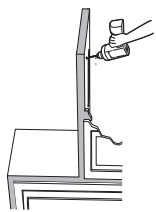

INSTRUCTIONS

(See installation booklet for complete instructions)

If you drill the 4 mounting holes from the inside of the cabinet, please refer to the instructions in the instruction booklet. Drill the 4 holes 1/4" DIA. as described in the installation instruction booklet.

IMPORTANT

MAKE SURE THAT THE LEFT AND RIGHT SIDES OF THIS TEMPLATE-MICROWAVE SIDE (A) OR (B)-ASSET WITH THE DESIRED, DESIRED LOCATION OF THE MOUNTED OVERLAPPING, ON WHETHER YOU CHOOSE TO DRILL FROM INSIDE THE CABINET OR FROM THE EXTERIOR SIDE OF THE CABINET. THE MICROWAVE SIDE (A) OR MICROWAVE SIDE (B) WILL INDICATE THE LOCATION OF THE SIDES OF THE MOUNTED OVERLAPPING.

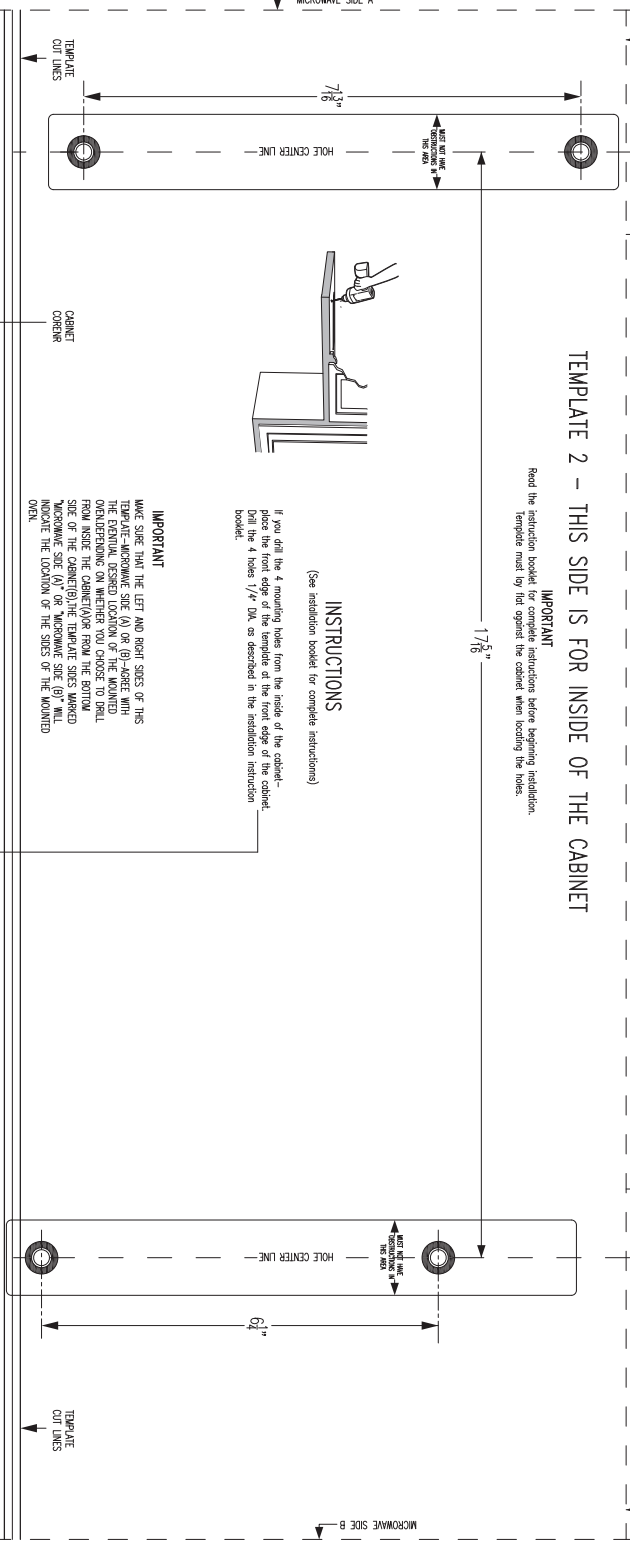

MICROWAVE FRONT DOOR SIDE

MICROWAVE FRONT CONTROL PANEL SIDE