

## STEP 1

WITH THE HELP OF SOMEONE ELSE TURN  
THE DESK AND PLACE THE TOP ON A  
FLAT SURFACE

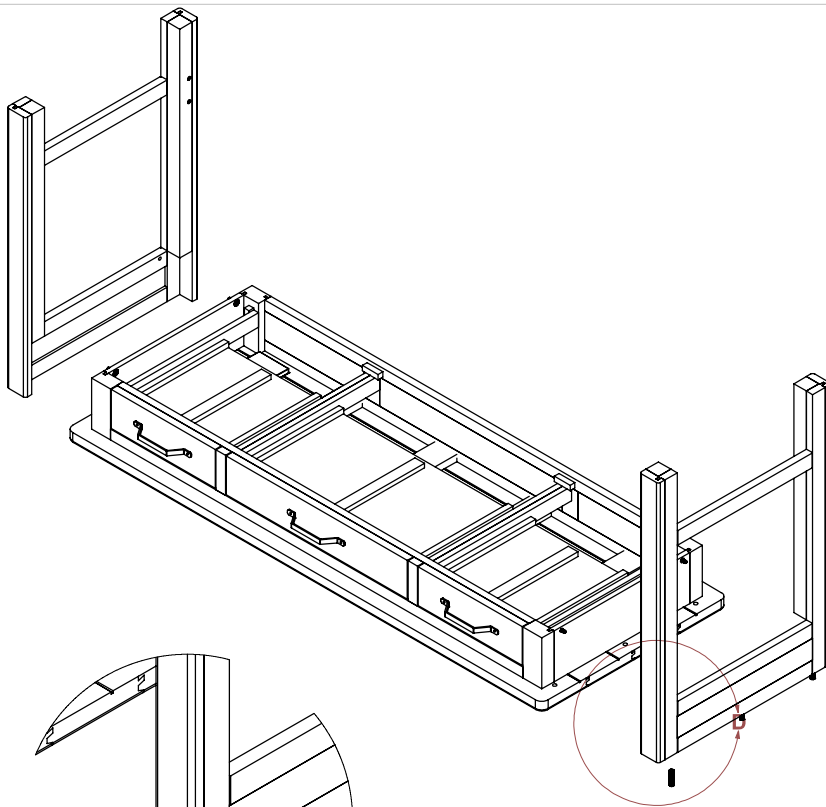

## STEP 2

TURN THE LATERALS AND  
WITH THE HELP OF THE WOOD BOLTS ALING  
THE LATERALS WITH THE TOP HOLES  
AS SHOWN IN FIGURE "A"

## STEP 3

ONCE THE LATERALS ARE IN  
POSITION PLACE THE  
SCREWS AS SHOWN  
IN FIGURE "A" AND TIGHTEN THE  
SCREWS INTO THE LATERALS

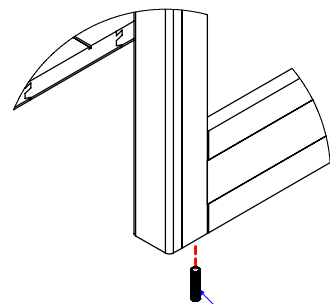

**A**

DETALLE D  
ESCALA 2 : 17

DOWEL 10 X 40 MM

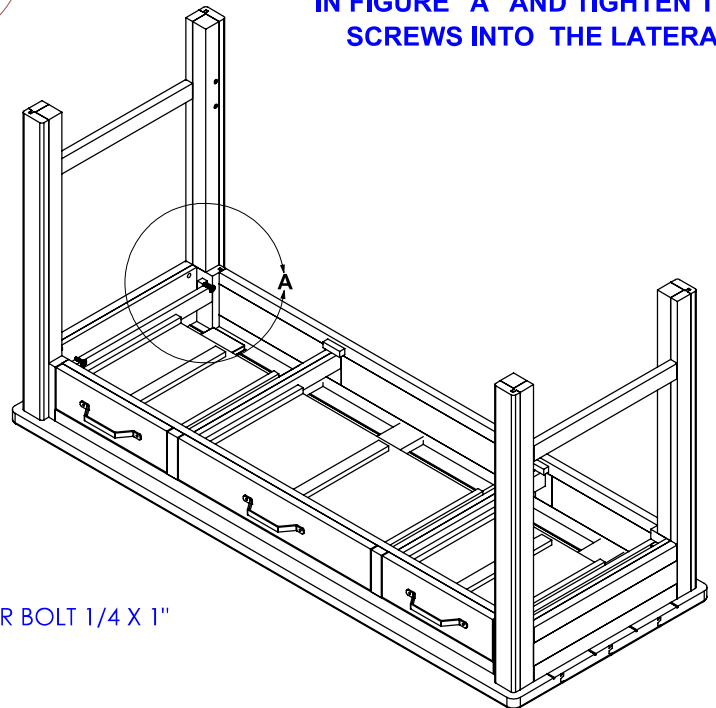

**B**

JOIN CONNECTOR BOLT 1/4 X 1"

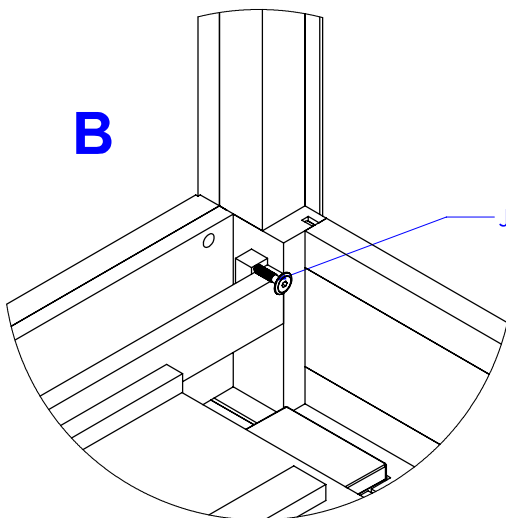

DESCRIPTION	#
JOIN CONNECTOR BOLT 1/4 X 1"	4
JOIN CONNECTOR BOLT 1/4 X 3/4"	4
DOWEL 10 X 40	6
ALLEN KEY 5/32	1

**STEP 4**

PLACE THE CROSSBAR ALING WITH THE BACK  
LEGS HOLES AS SHOWN IN FIGURE "B"

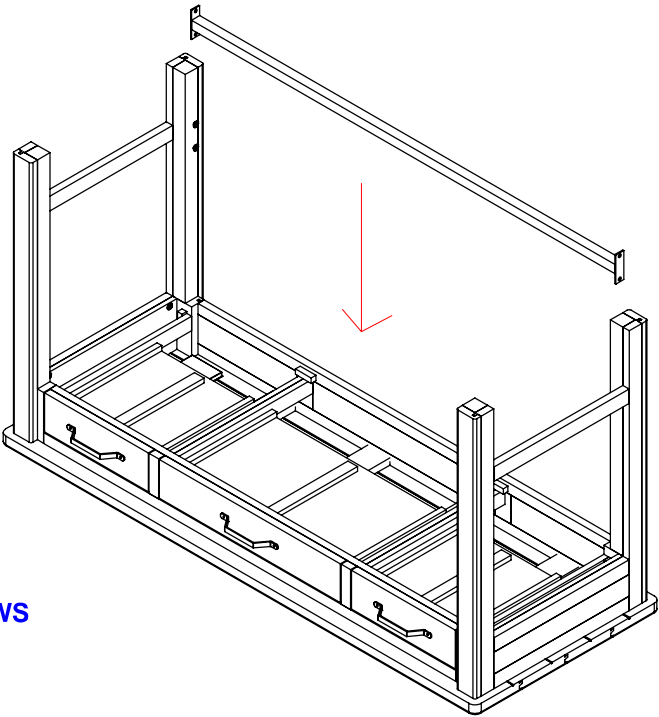

**STEP 5**

ONCE THE CROSSBAR IS IN POSITION PLACE THE SCREWS  
AND TIGHTEN THE SCREWS INTO THE LEGS

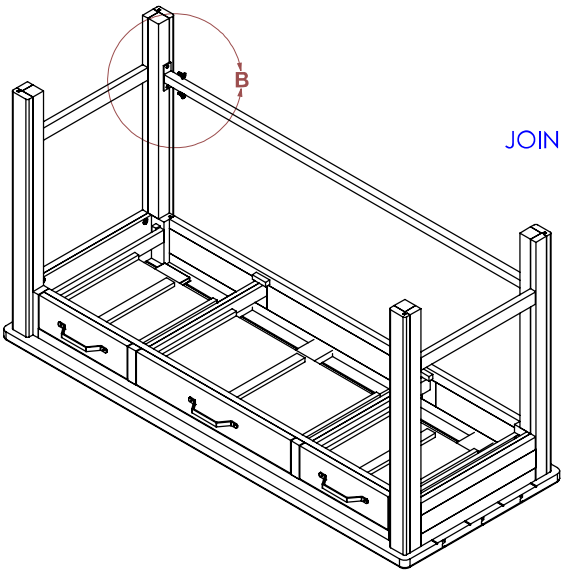

JOIN CONNECTOR BOLT 1/4 X 3/4"

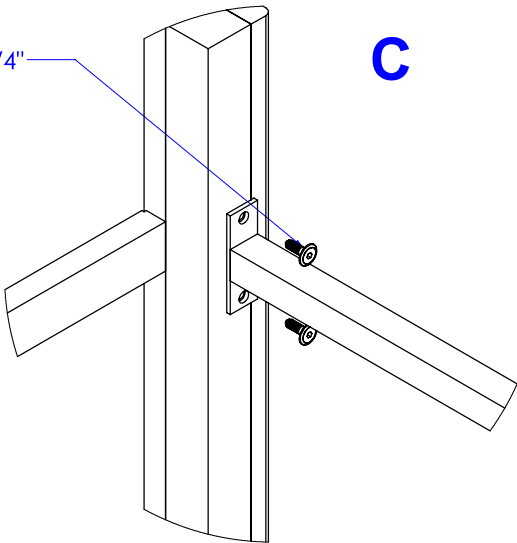

**NOTE: REMEMBER THAT ALL THE SCREWS ARE  
AND AT THE END THAT ALL THE SCREWS HAVE BEEN  
IN THEIR POSITION WE ADJUST.**

ASSEMBLING INSTRUCTIONS	DESCRIPTION		#
	JOIN CONNECTOR BOLT 1/4 X 1"		4
I-DSK-E016	JOIN CONNECTOR BOLT 1/4 X 3/4"		4
	DOWEL 10 X 40		6
	ALLEN KEY 5/32		1

ITEM	DESCRIPTION	#
1TOR035	PERNO UNION 1/4 X 19 MM	4
1TOR038	PERNO UNION 1/4 X 25 MM	4
1PER012	PERNO DE MADERA DE 10 X 40	6
1HER250	LLAVE ALLEN 5/32	1



**INTERNATIONAL**  
FURNITURE DIRECT, LLC

## ASSEMBLING INSTRUCTIONS

**I-DSK-E016**