

Furniture of America[®]

Assembly Instructions

CM3186CH/WH-T

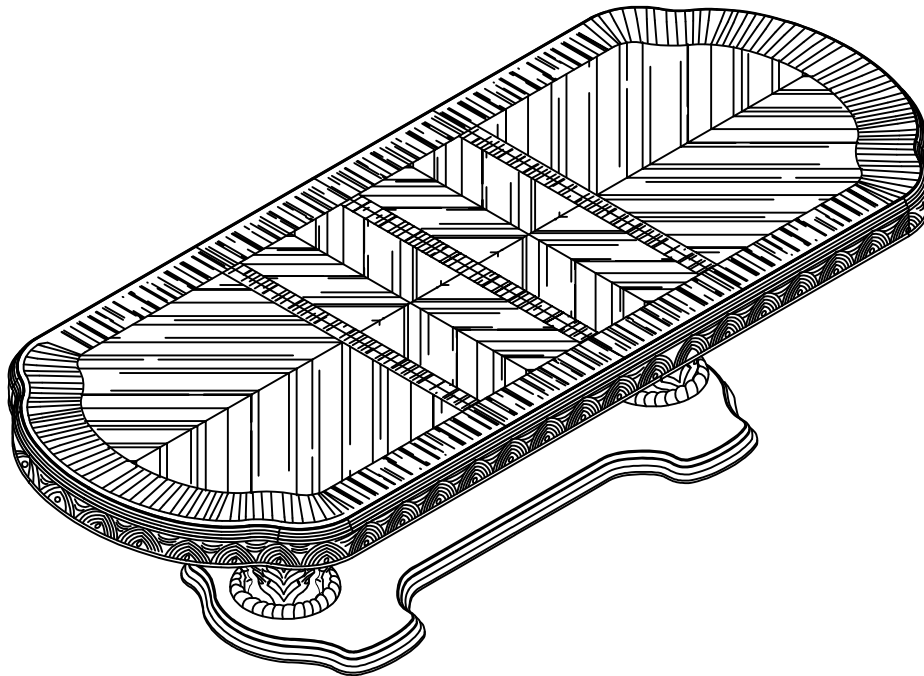

ASSEMBLY RATING

The Assembly Rating is a 5-point system that shows the degree of effort needed in assembling a specific product (with 1 being easy and 5 being difficult). For some products, two persons are recommended.

Tools Required For Assembly:

Allen Wrench

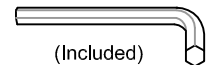

EASY

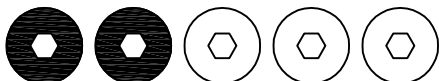

DIFFICULT

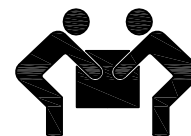

2 PERSONS RECOMMENDED

ASSEMBLY & CARE ADVICE

FOR YOUR FURNITURE TO LAST, CORRECT ASSEMBLY AND PROPER MAINTENANCE ARE NECESSARY. PLEASE FOLLOW THE INFORMATION PROVIDED BELOW TO FULLY ENJOY YOUR FURNITURE.

BASIC ASSEMBLY TECHNIQUES



When lock or spring washer is used in an assembly, please make sure the lock or spring washer is placed between the larger flat washer and the head of the screw or bolt.



Position each part correctly and insert screws or bolts into their respective holes by hand tighten or using the proper hand tool. Only tighten when step is completed or when instructed to do so.

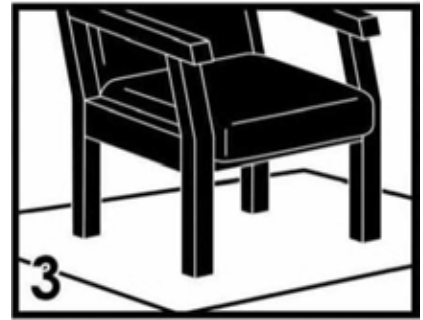

Use cardboard or carpet area when assembling furniture to prevent scratches. Make sure the furniture rests on a flat and level surface with each leg evenly touching the floor.

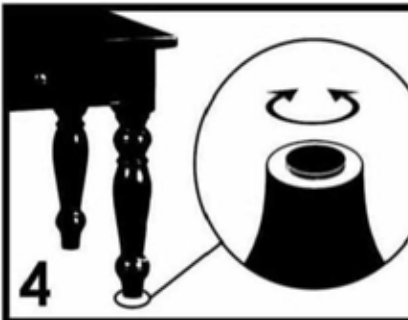

Some furniture comes with height adjustment knobs underneath each leg. To lower or to raise each leg, you need to turn clockwise or counterclockwise, respectively.

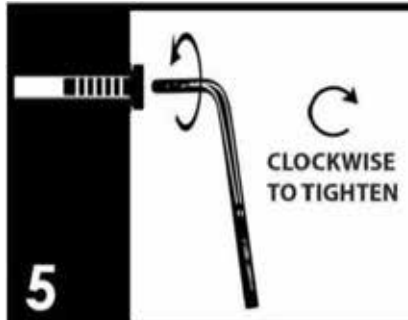

Make sure all parts are properly aligned, then use the appropriate hand tool to completely tighten the bolts or screws. Do not use power tools and do not overtighten.

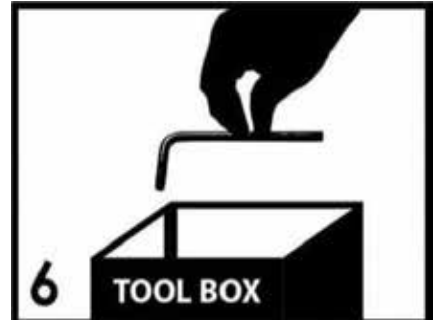

Save the instructions and store the Allen wrench or any supplied tool for later maintenance. After two weeks, check and tighten any loose hardware and repeat again every six months thereafter.

IT IS THE USER'S RESPONSIBILITY TO MAINTAIN THE FURNITURE. THE HARDWARE MAY LOOSEN OVER TIME AND MAY CAUSE THE FURNITURE TO BE WOBBLY AND UNABLE TO SUPPORT ITS INTENDED WEIGHT CAPACITY. THIS MAY LEAD TO COLLAPSE AND MAY CAUSE SERIOUS INJURY.

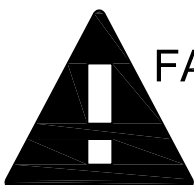

FAILURE TO FOLLOW THE GUIDELINES ABOVE MAY RESULT IN INJURY AND/OR PROPERTY DAMAGE.



Before you begin, please read Page 2 of "Assembly and Care Advice".

And remember, do not tighten until each step is completed or instructed.

Parts List

Hardware List

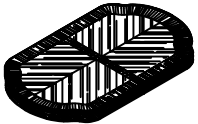

#1 x 1pc
Table Top

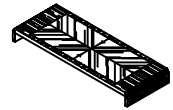

#2 x 2pcs
Leaf

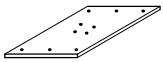

#3 x 2pcs
Table Base



#4 x 2pcs
Pedestal

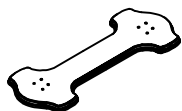

#5 x 1pc
Base

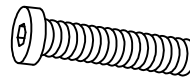

#A x 28pcs
BOLT Ø5/16"X1-3/4"

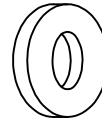

#B x 28pcs
Flat Washer



#Cx 28pcs
Lock Washer



#D x 1pc
Allen Wrench M5

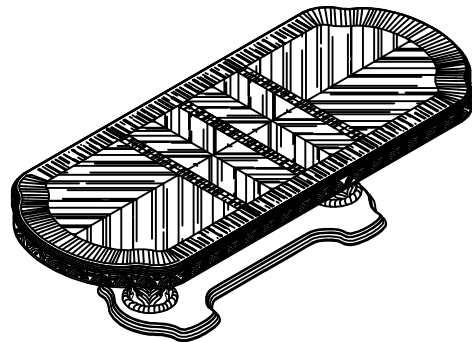



A x 8 pcs
B x 8 pcs
C x 8 pcs

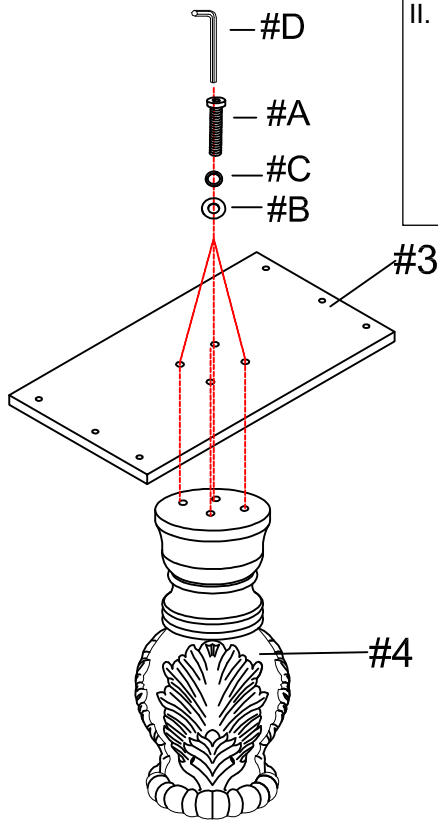

- I. Align the table base (#3) to the pre-drilled holes on top of the pedestal (#4).
- II. Prepare 8 bolt assemblies by FIRST inserting the lock washer (#C) onto the bolt (#A) then the flat washer (#B) onto that SAME bolt (#A), in that order. Secure using the Allen wrench (#D).

X 2



A x 12 pcs
B x 12 pcs
C x 12 pcs

- I. Carefully place the table top (#1) on a protected surface.
- II. Align both table bases (#3) to the pre-drilled holes located on the bottom of the table top (#1).
- III. Prepare 12 bolt assemblies by FIRST inserting the lock washer (#C) onto the bolt (#A) then the flat washer (#B) onto that SAME bolt (#A), in that order. Secure using the Allen wrench (#D).

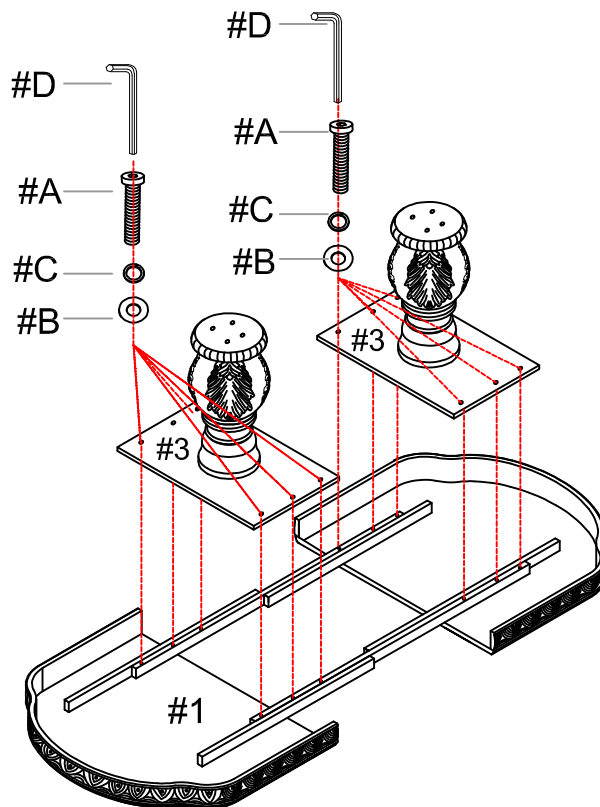



A x 8 pcs
 # B x 8 pcs
 # C x 8 pcs

- I. Align the base (#5) to the pre-drilled holes located on the bottom of the pedestals (#4).
- II. Prepare 8 bolt assemblies by FIRST inserting the lock washer (#C) onto the bolt (#A) then the flat washer (#B) onto that SAME bolt (#A), in that order. Secure using the Allen wrench (#D).

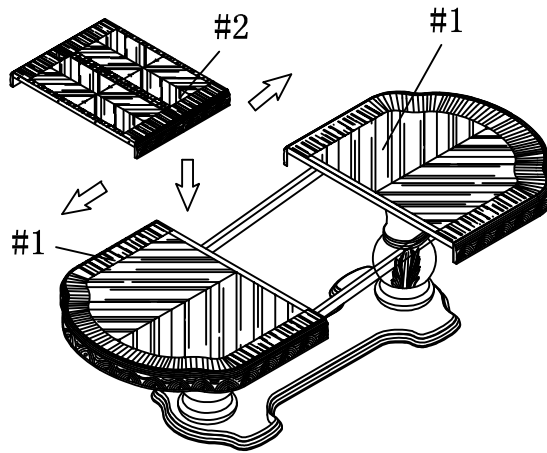
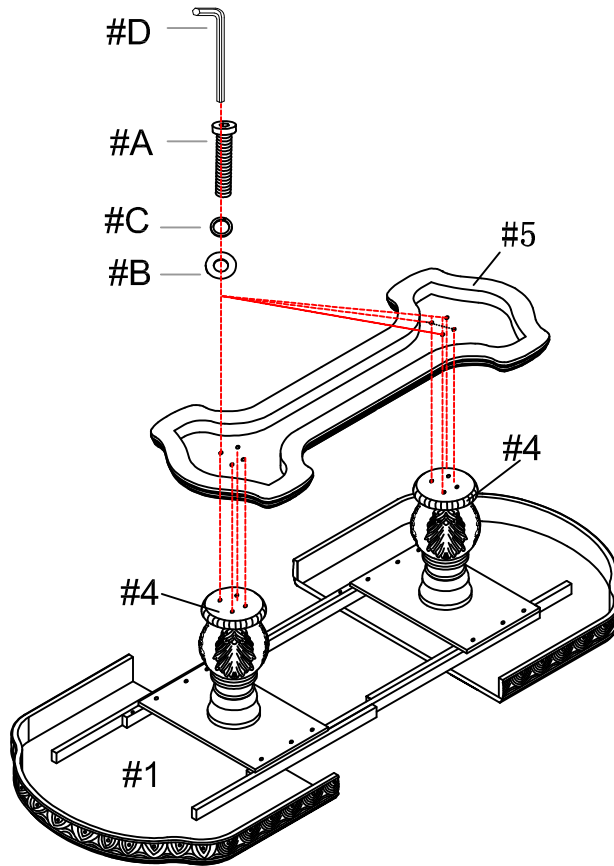

- I. Unlock the latches located under the table top (#1). Once unlocked, slide outward on both ends of the outer two-piece table top (#1) until there is sufficient opening to place the leaf (#2).
- II. Place the leaf (#2) then slide inward on both ends of the outer two-piece table top (#1) until they are touching and sitting flush with the leaf (#2). Lock latches.

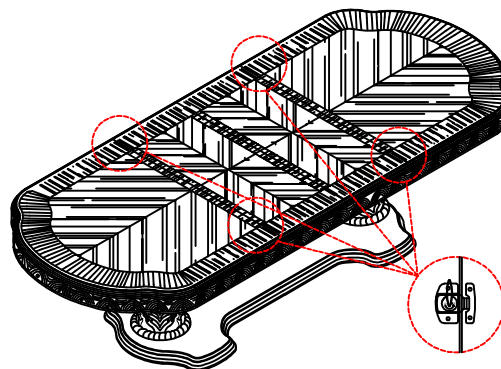

ASSEMBLY IS COMPLETED