



Installation Parts List

Wing Nuts (4) *



Thumb Screws (4) *



Vertical Support
Brackets (2) *



Corner Brackets (8)

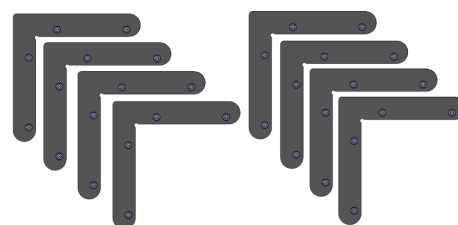

Splice Bars (4) *



Wall Bracket
Screws



Wall Brackets



Spare Parts

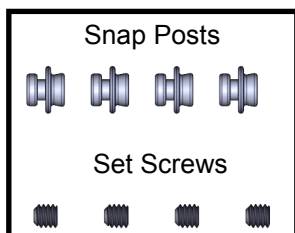

1/8" Hex Keys (2)



Gloves



* Only for larger screens which require split horizontal frames.

Note: In the visuals that accompany the following instructions, an item displayed in **green** denotes an action is required with that item.

Assemble the Frame

Note 1: Vertical supports and split horizontals are only for larger screens. If your screen only has 4 frame pieces then you can skip steps 2, 3, and 4.

Note 2: Leave the lighting spools attached to the lower horizontal frame piece until Step 7.

1) Lay the frame components face down on a clean floor as shown below.

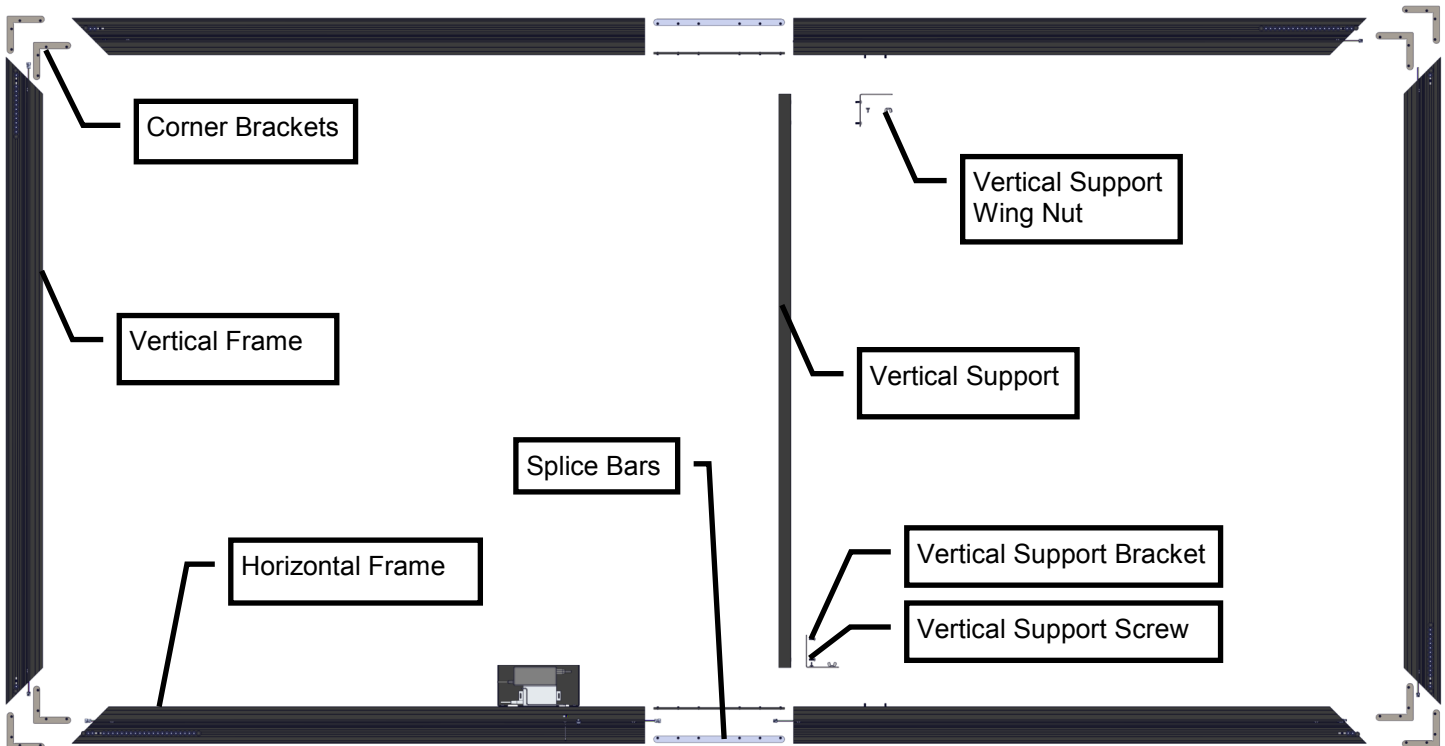

2) Slide the splice bars half way in to the slots in the frame as shown below. (Larger screens only)

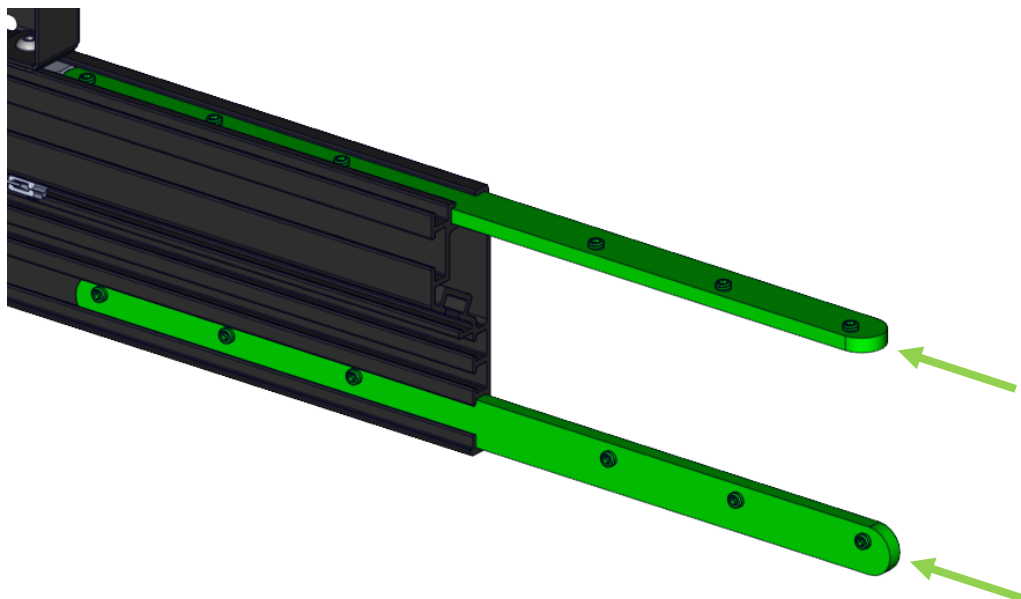

3) Slide the horizontal frame pieces together and lock down by tightening the set screws. (Larger screens only)

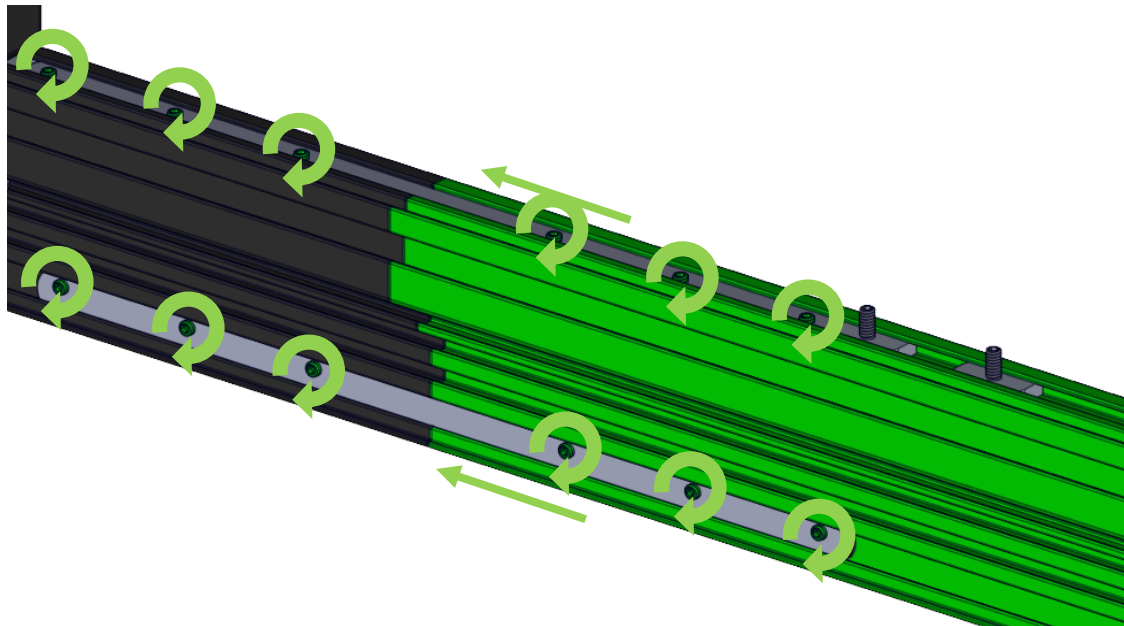

4 a) Attach the vertical support brackets to the vertical support with the thumb screws. (Larger screens only)

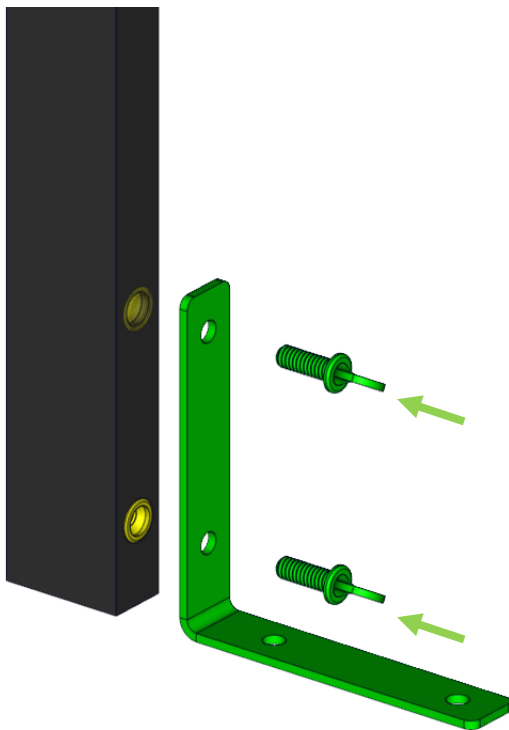

4 b) Attach the vertical support to the horizontal frames with the wing nuts. (Larger Screens only)

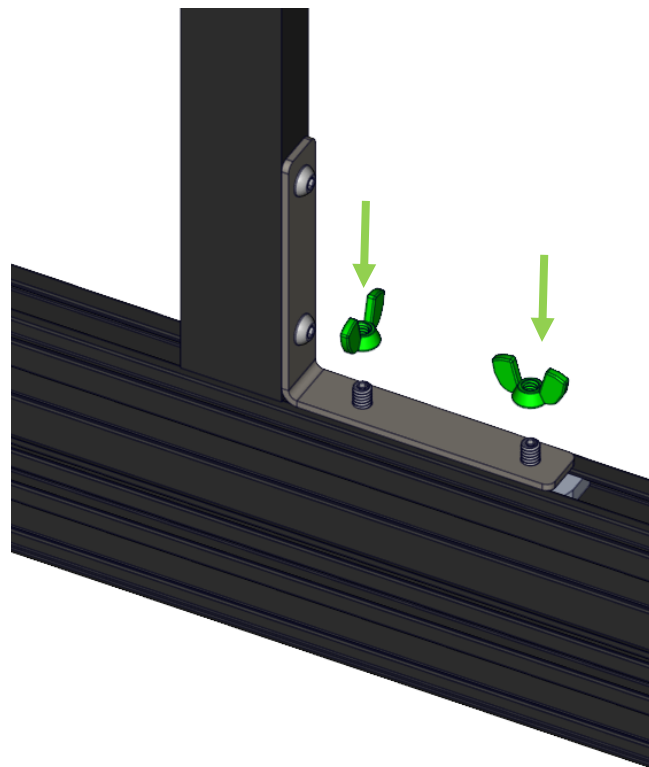

5) Slide the corner brackets into the slots in the vertical frame pieces; then insert the corner brackets into the slots in the horizontal frame pieces. Make sure that the points of the frame pieces meet up and that they butt up against each other. Finger tighten 2 set screws at each corner to hold the corner points together.

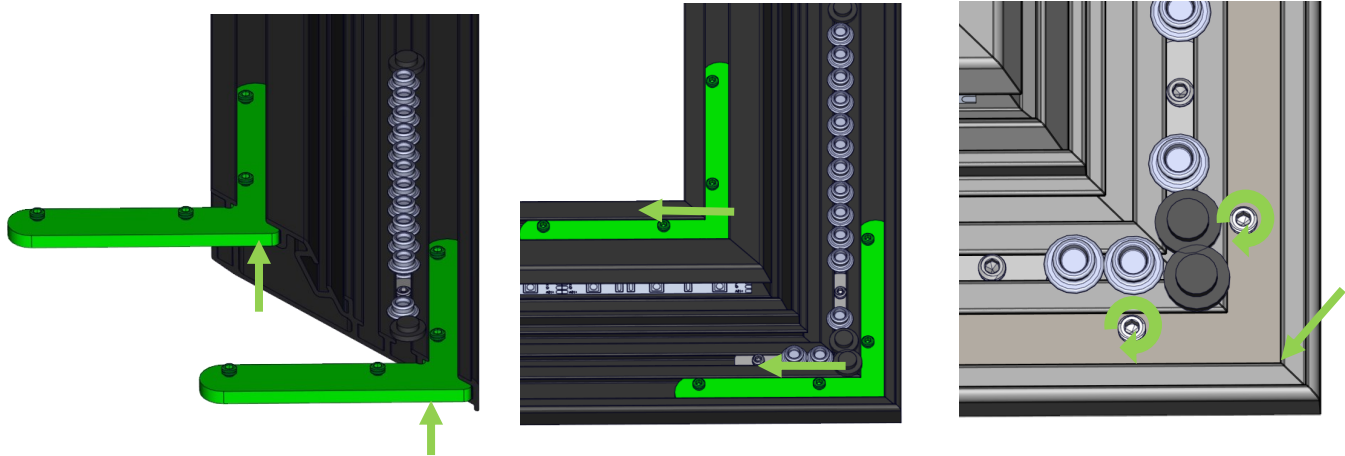

6) Measure the diagonals of the frame and make sure they are equal to within 1/8". If they are not then use two people to press towards each other on the ends of the longer diagonal. Once the frame is square tighten down all set screws to lock the frame in place. (Do not overtighten.)

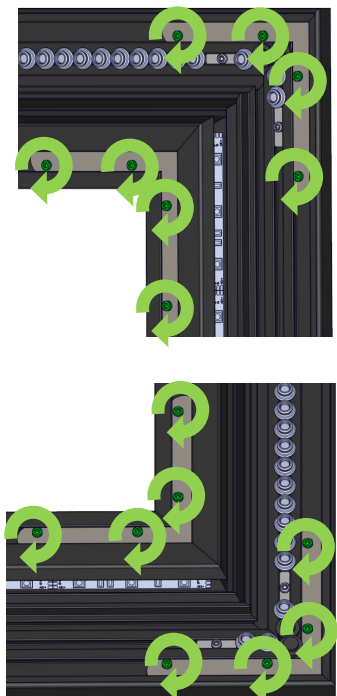
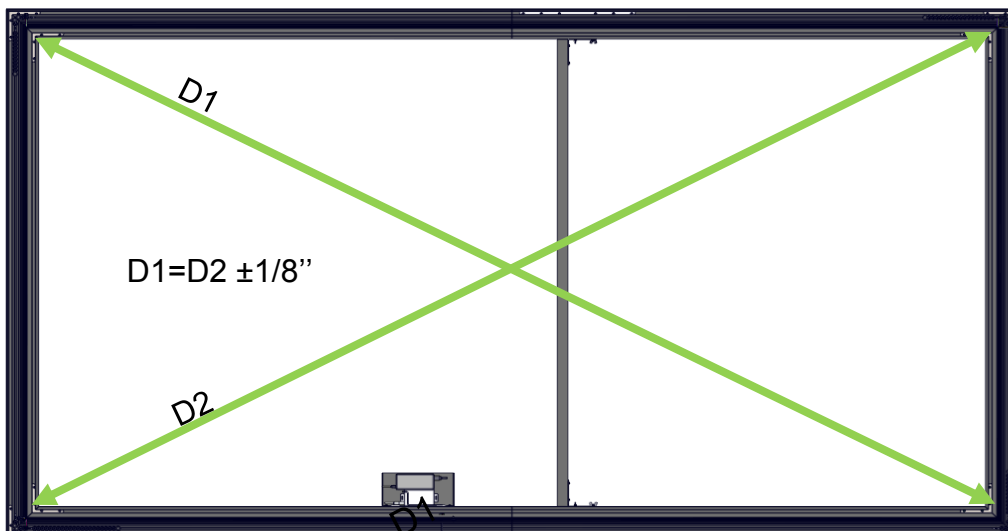
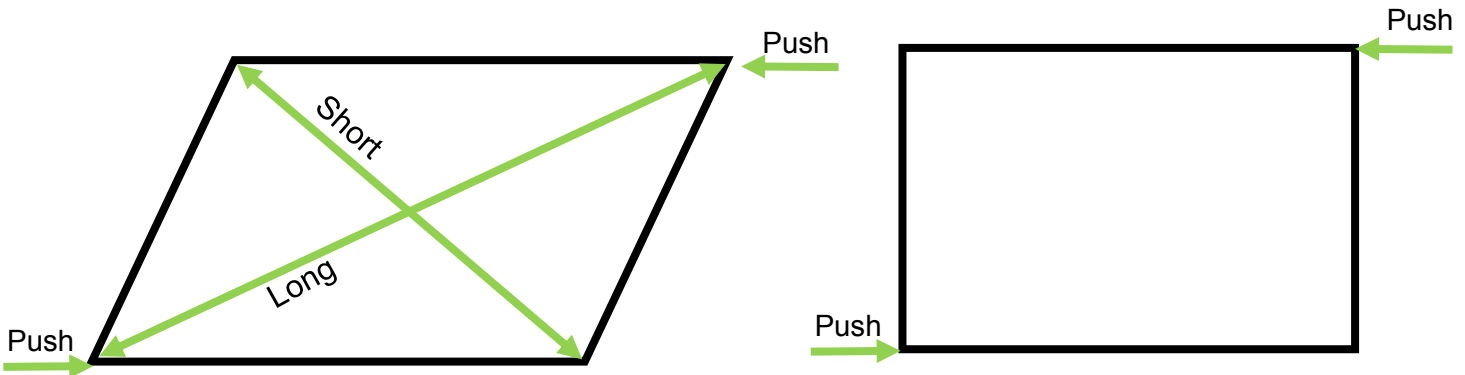

Install and test the Lighting (Note: Skip steps 7 and 8 if lighting was not ordered.)

7) Remove the lighting strips connected to the ends of the bottom frame piece from their packaging. Then follow the lighting channel and lay the bottom of the lighting strip in the channel. Finally, press in the top half of the lighting strips into the channel to secure. Follow the channel around until the two strips overlap on the opposite side of the frame.

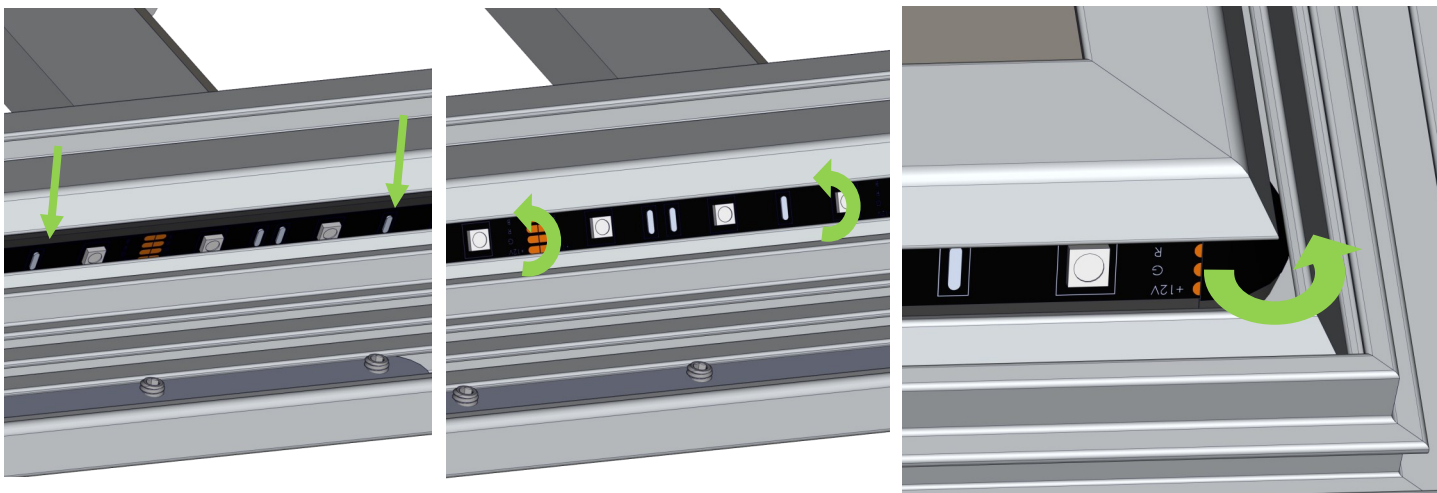

8) Plug the power supply into a power source and test the solid red, green, and blue, lights with the remote. See the hex codes below If you want to use a 3rd party control system or remote.

Note: The 3.5mm jack on the left side of the LED controller accepts IR input signals and overrides the connected primary IR eye.

LED Lighting Hex Codes

20 13 5C A3	20 13 5D A2	20 13 41 BE	20 13 40 BF
20 13 58 A7	20 13 59 A6	20 13 45 BA	20 13 44 BB
20 13 54 AB	20 13 55 AA	20 13 49 B6	20 13 48 B7
20 13 50 AF	20 13 51 AE	20 13 4D B2	20 13 4C B3
20 13 1C E3	20 13 1D E2	20 13 1E E1	20 13 1F E0
20 13 18 E7	20 13 19 E6	20 13 1A E5	20 13 1B E4
20 13 14 EB	20 13 15 EA	20 13 16 E9	20 13 17 E8
20 13 10 EF	20 13 11 EE	20 13 12 ED	20 13 13 EC
20 13 0C F3	20 13 0D F2	20 13 0E F1	20 13 0F F0
20 13 08 F7	20 13 09 F6	20 13 0A F5	20 13 0B F4
20 13 04 FB	20 13 05 FA	20 13 06 F9	20 13 07 F8

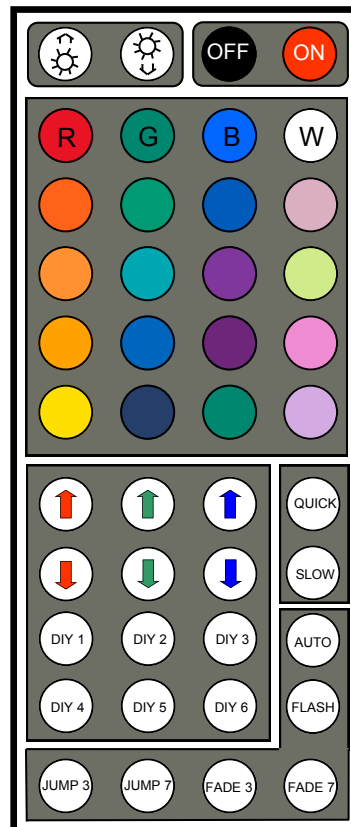

Prepare the Screen Material for Attachment

Caution: Use gloves when handling viewing material. Fingerprints will damage the viewing surface.

9) Remove the screen material from the cardboard tube and unroll onto a clean floor. The screen will unroll viewing side down on top of protective foam. This is the correct orientation for the next step.

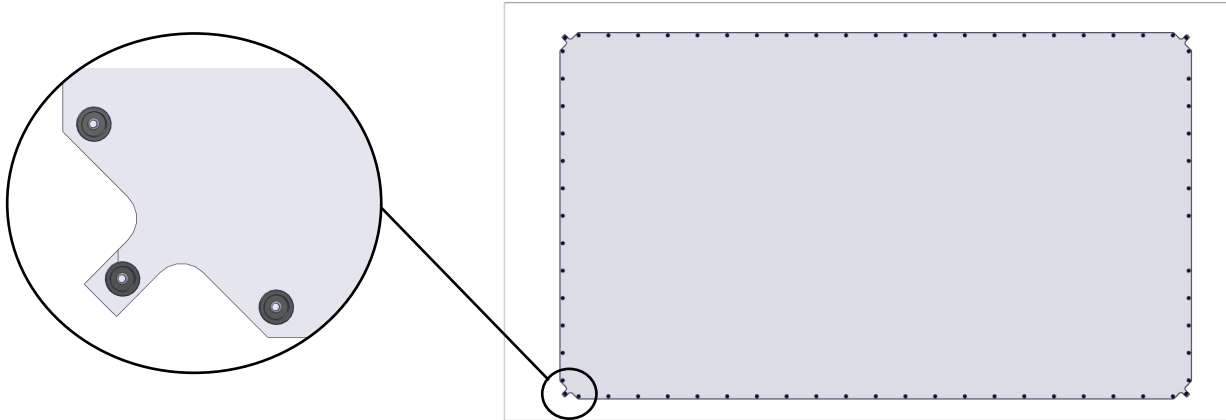

10) Carefully place the frame face down on top of the screen material. Make sure that the corners of the frame are evenly spaced away from the corners of the material. This will ensure that the frame is centered on the material.

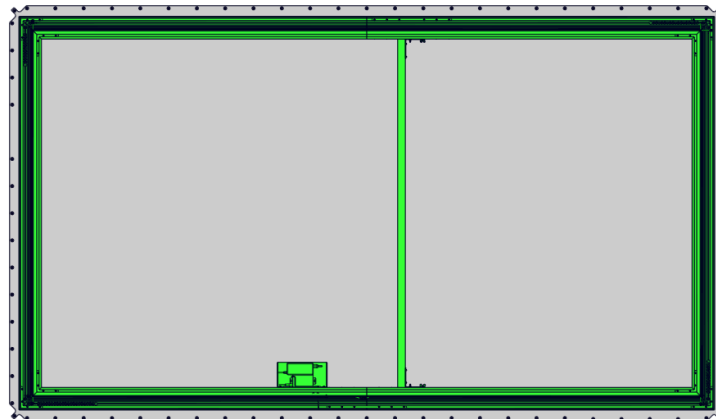

11) Remove the stick-on bumpers then position the snap posts in the frame so that they are in line with the snaps on the screen. Note that the snaps in the corners are already fixed in their correct position. One snap needs to also go in each corner.

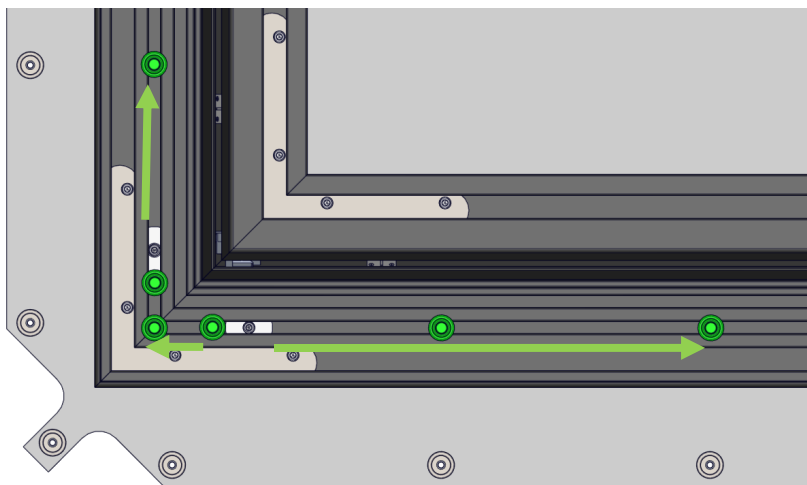



5 Series Slate and Pure Zero Edge Flex Installation Instructions

7

Stretch and Attach the Screen Material to the Frame

12) Attach the screen to the snap posts one away from the corner posts as shown below. Note: You do not snap in the tab at the very corner until all other snaps have been installed.

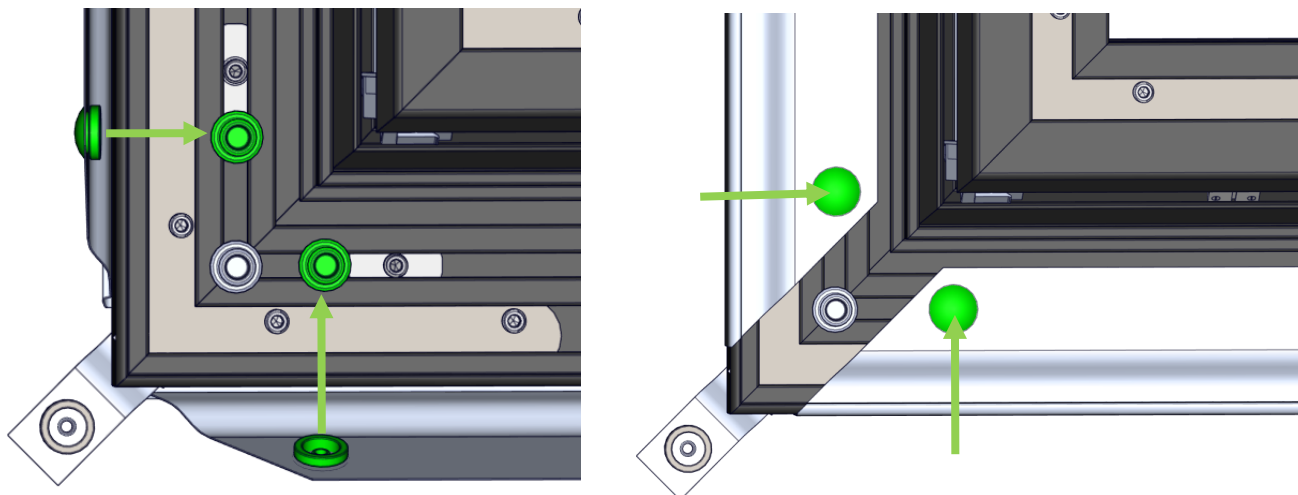

13) Attach the snaps, working from the middle out on all four sides. Finally attach the snaps connected to tabs at the corners (follow the pattern as shown below).

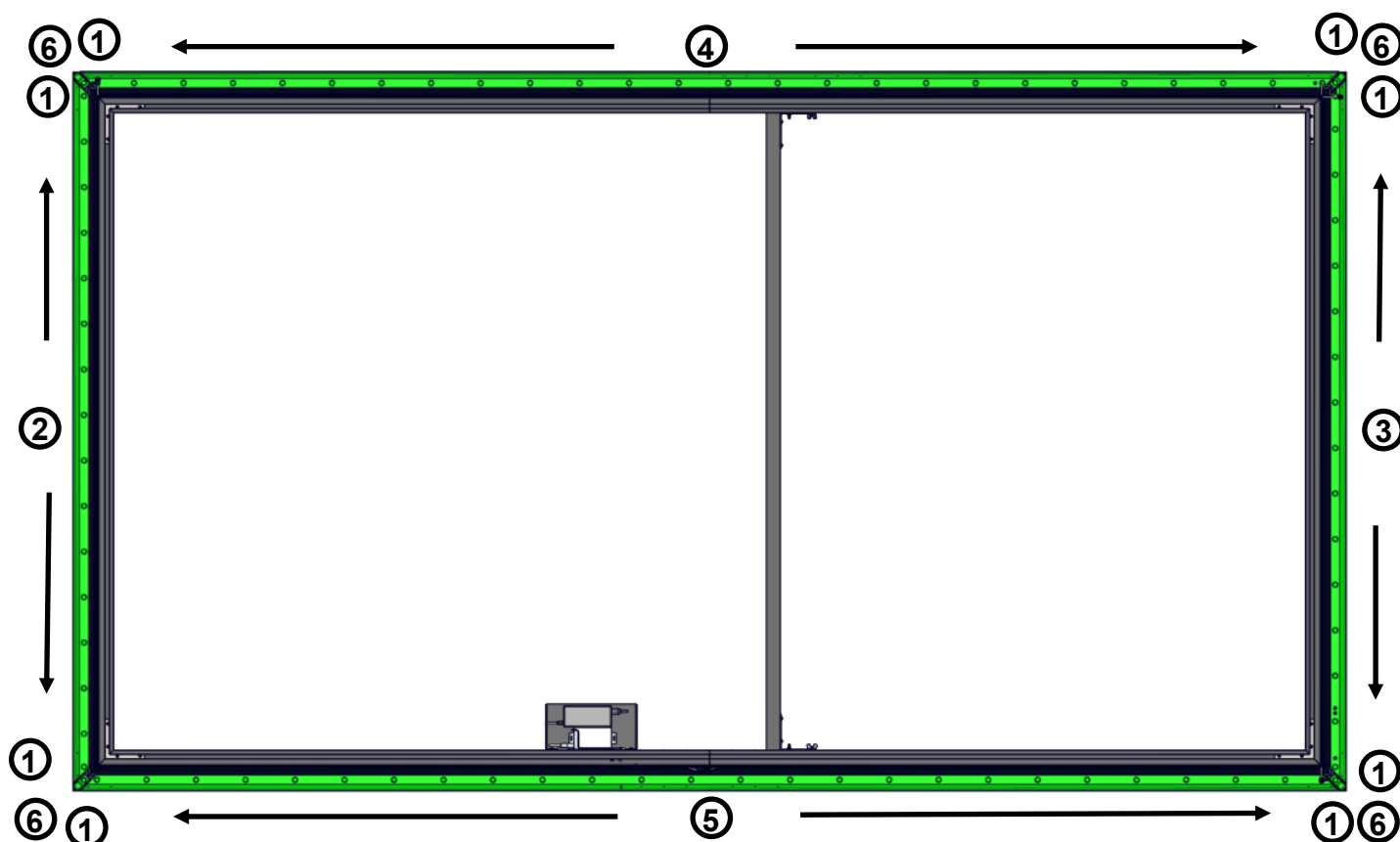

14) Turn the screen over so that the viewing side is facing up. Make sure that the screen was stretched properly. If there are wrinkles in the screen then smooth out the wrinkle and move the snap to a position where the screen is no longer wrinkled.

Attach the Trim

Note: The trim piece which has the logo on it goes on the bottom of the screen denoted by the side of the screen which has the lighting power and controls attached to it.

15) Snap the trim onto the screen. Make sure that the angled cuts are at the corners. Note that the trim should be able to slide relatively easily when it is properly pressed all the way on to the screen. Note that the trim snaps in over the front as well as at the back of the frame. Make sure the trim is snapped all the way in along the full perimeter.

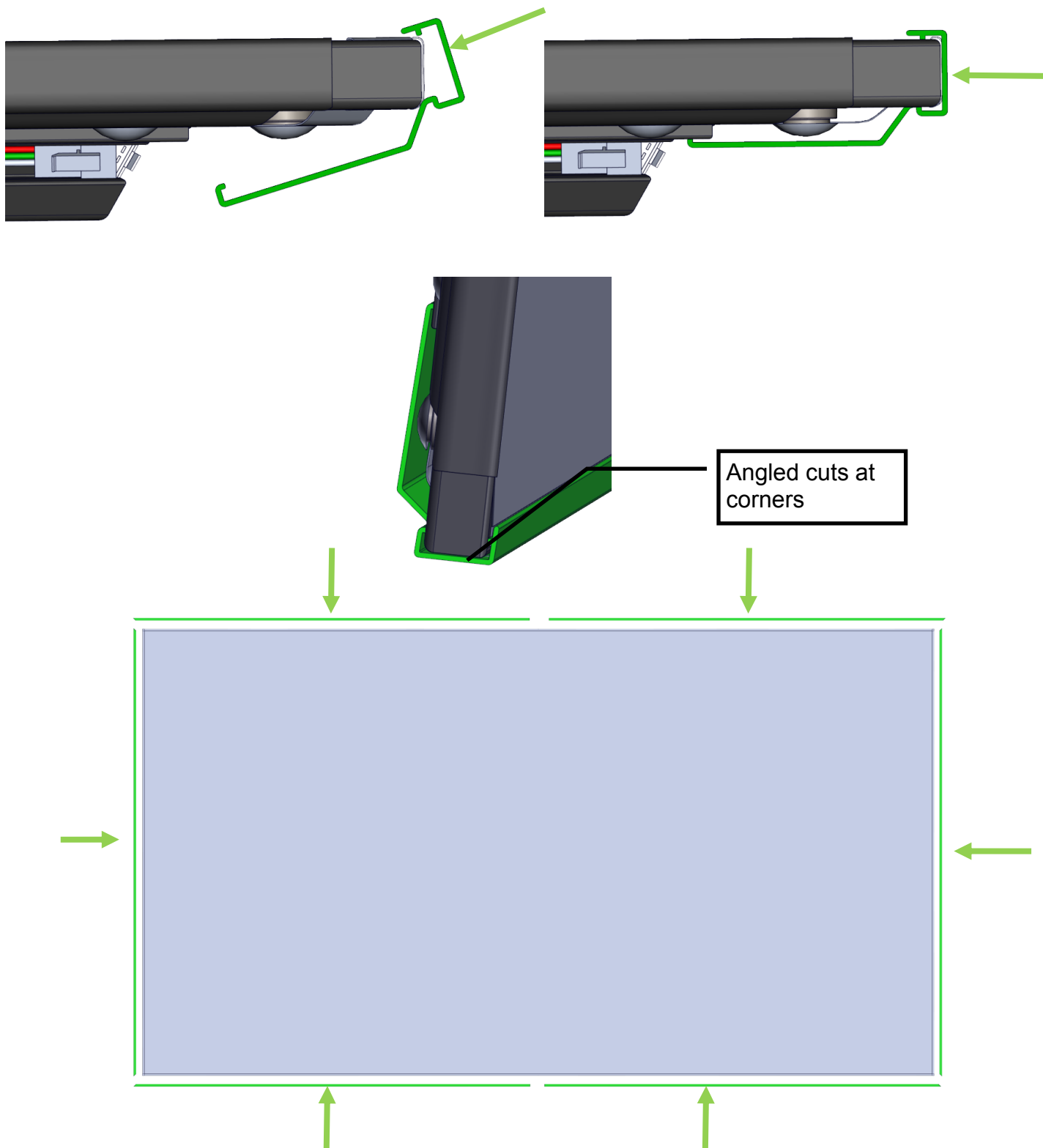



5 Series Slate and Pure Zero Edge Flex Installation Instructions

9

Hang Screen on Wall

16) Select evenly spaced wall bracket locations using the drawing below, screw them into structural supports, hang the screen on the wall brackets and enjoy.

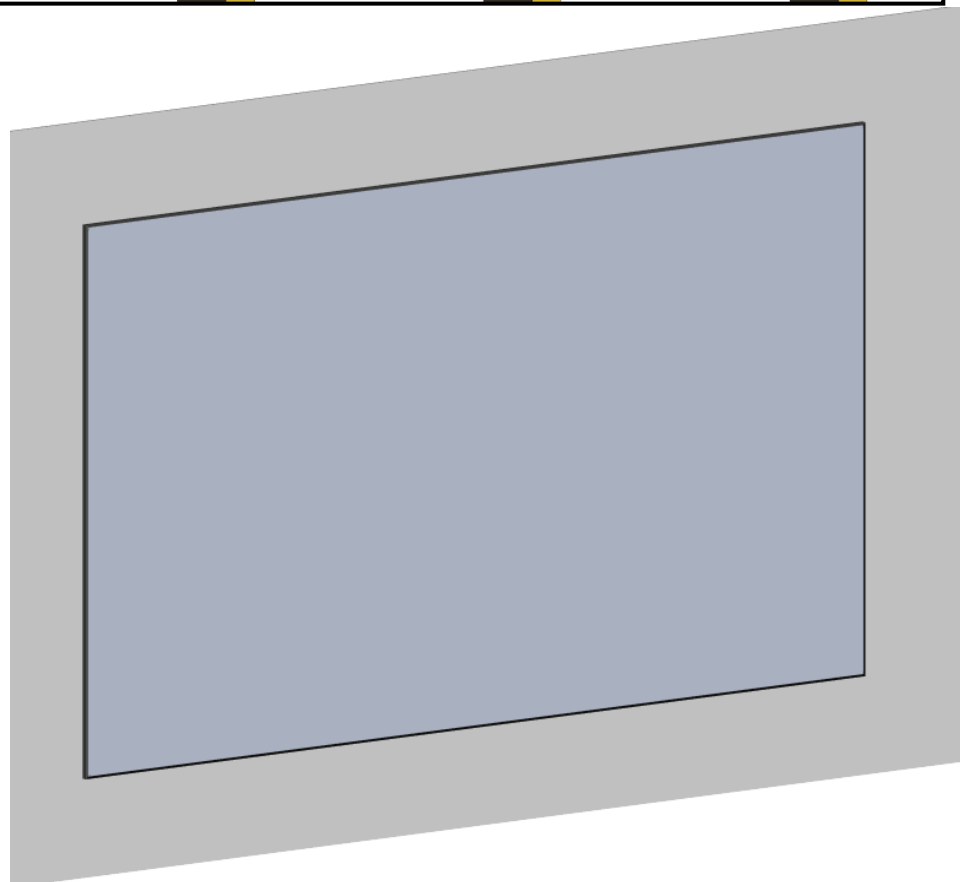
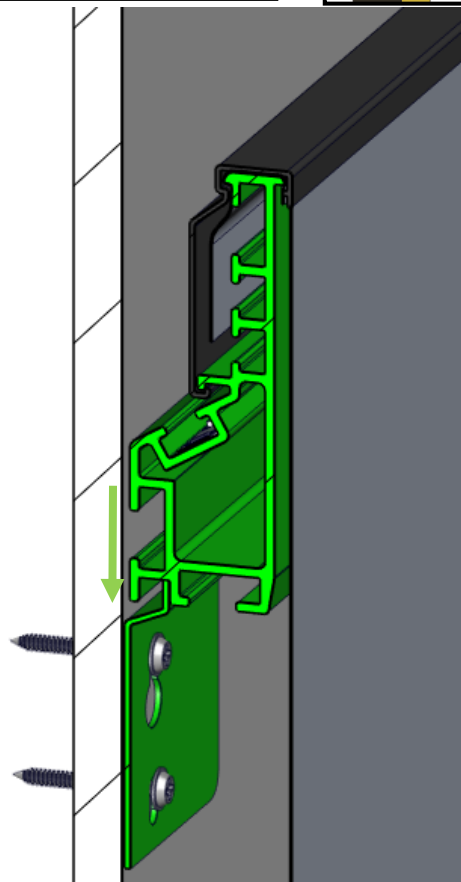
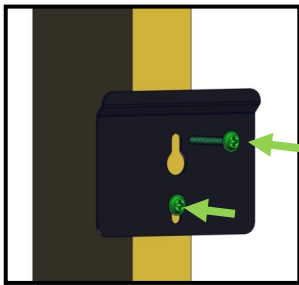
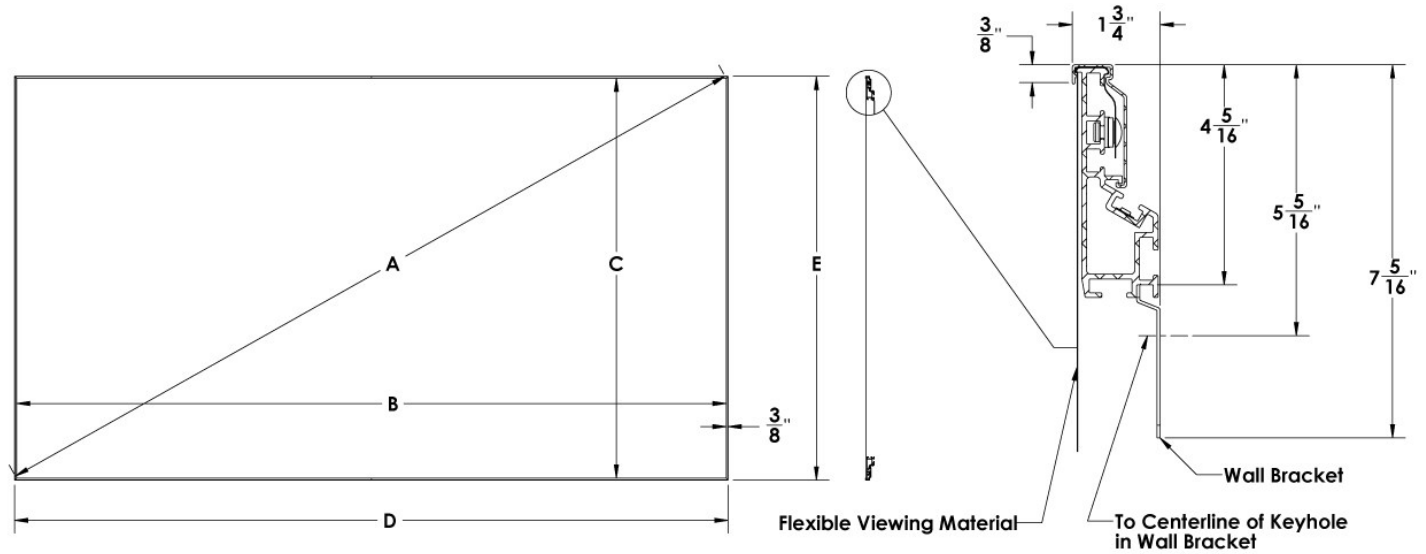

Screen Innovations Zero Edge™ LED Lights Using the Remote Control

LED remote operates with one CR2032 battery.

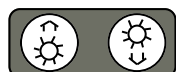

Increase / Decrease Brightness



Discrete OFF / ON



Static
Color
Keys

Increase / Decrease Speed of
Pre-programmed Sequence

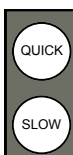

Pre-programmed
Sequences

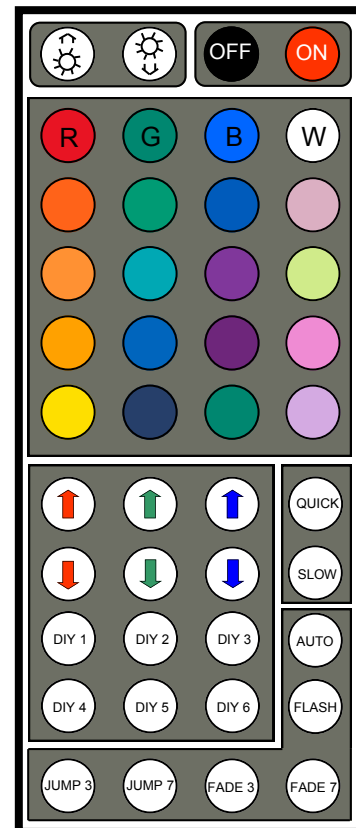
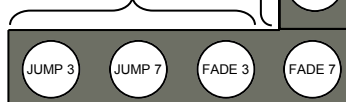

DIY Key programming instructions:

Step 1) Press any of the DIY 1 through DIY 6  keys to activate the programming of that

Step 2) Use the 6 Up and Down arrow keys to adjust the amount of Red, Green, or Blue, denoted by the arrow color.

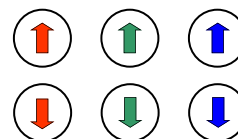

Step 3) When the color has been adjusted to your liking, press the same DIY key to lock-in the color you've created. To retrieve the color, simply press the assigned DIY key. Note: All DIY keys are independent of each other, allowing programming of 6 unique user-defined settings.



User-Programmable
DIY Key Section

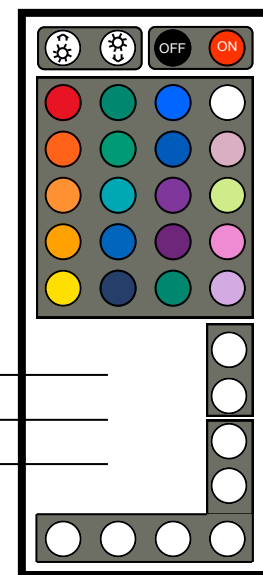
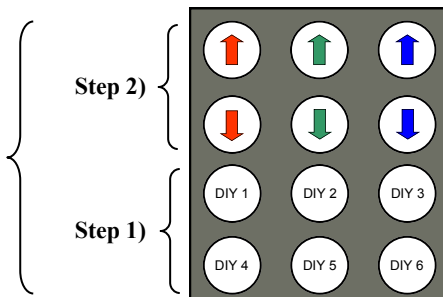



5 Series Slate and Pure Zero Edge Flex Installation Instructions

11

LIMITED ONE YEAR WARRANTY ON SCREEN INNOVATIONS PRODUCTS

Screen Innovations warrants its products to the original purchaser only, to be free from defects in materials and workmanship for a period of one (1) year from the date of purchase by the original purchaser provided they are properly operated according to Screen Innovations' instructions and are not damaged due to improper handling or treatment after shipment from the factory.

This warranty does not apply to equipment showing evidence of misuse, abuse or accidental damage, or which has been tampered with or repaired by a person other than authorized Screen Innovations personnel.

Screen Innovations' sole obligation under this warranty shall be to repair or to replace (at Screen Innovations' option) the defective part of the merchandise. Returns for service should be made to your Screen Innovations dealer. If it is necessary for the dealer to return the screen or part to Screen Innovations, transportation expenses to and from Screen Innovations are payable by the purchaser and Screen Innovations is not responsible for damage in shipment. To protect yourself against damage or loss in transit, insure the product and prepay all transportation expenses.

THIS WARRANTY IS IN LIEU OF ALL OTHER WARRANTIES, EXPRESS OR IMPLIED, INCLUDING WARRANTIES AS TO FITNESS FOR USE AND MERCHANT ABILITY. Any implied warranties of fitness for use, or merchantability, that may be mandated by statute or rule of law are limited to the one (1) year warranty period. This warranty gives you specific legal rights, and you may also have other rights, which vary from state-to-state. **NO LIABILITY IS ASSUMED FOR EXPENSES OR DAMAGES RESULTING FROM INTERRUPTION IN OPERATION OF EQUIPMENT, OR FOR INCIDENTAL, DIRECT, OR CONSEQUENTIAL DAMAGES OF ANY NATURE.**

In the event that there is a defect in materials or workmanship of a Screen Innovations product, you may contact us at 9715-B Burnet Road Suite 400, Austin, TX, 78758 , (512) 832-6939.

IMPORTANT: THIS WARRANTY SHALL NOT BE VALID AND SCREEN INNOVATIONS SHALL NOT BE BOUND BY THIS WARRANTY IF THE PRODUCT IS NOT OPERATED IN ACCORDANCE WITH SCREEN INNOVATIONS' WRITTEN INSTRUCTIONS.

Keep your sales receipt to prove the date of purchase and your original ownership.



NOTES