

ASSEMBLY INSTRUCTIONS
COASTER FINE FURNITURE



Fine Furniture for every stage of life

930071
SIDE TABLE

ITEM: 930071



ASSEMBLY INSTRUCTIONS

ASSEMBLY TIPS:

1. Remove hardware from box and sort by size.
2. Please check to see that all hardware and parts are present prior to start of assembly.
3. Please follow attached instructions in the same sequence as numbered to assure fast & easy assembly.



WARNING!

1. Don't attempt to repair or modify parts that are broken or defective. Please contact the store immediately.
2. This product is for home use only and not intended for commercial establishments.

ASSEMBLY TIME

20 MINUTES

PARTS IDENTIFICATION

A FRAME

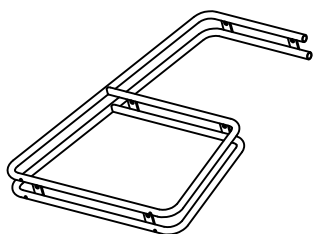

1PC

C

SHELF
(320mmDIA)

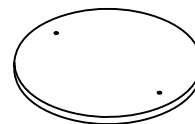

1PC

B

TOP
(400mmDIA)

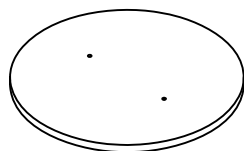

1PC

D

BASE
(380mmDIA)

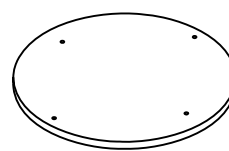

1PC

Z

HARDWARE IDENTIFICATION

1

ALLEN WRENCH
(4mm)

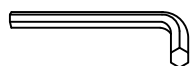

1PC

2

WRENCH



1PC

3

BOLT
(Ø1/4" x 12mm)



6PCS

4

NUT



4PCS

5

LEVELER



2PCS

6

FLOOR
PROTECTOR



4PCS

7

END CAP



2PCS

ITEM: **930071**

ASSEMBLY INSTRUCTIONS



STEP 1

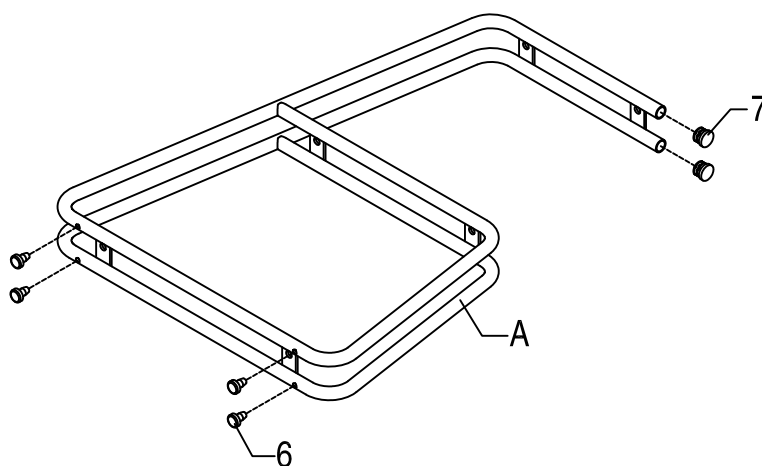

STEP 2

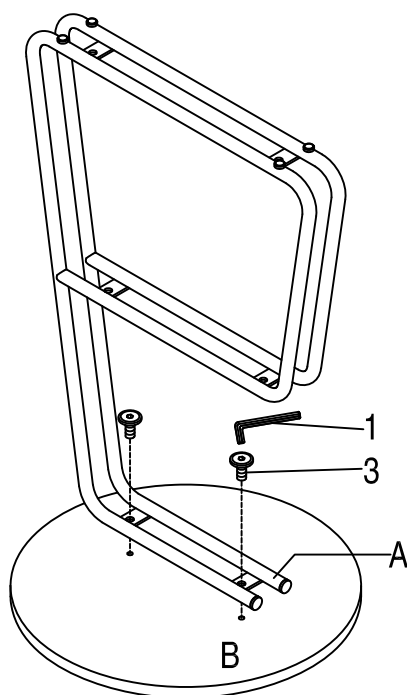

ITEM: **930071**

ASSEMBLY INSTRUCTIONS



STEP 3

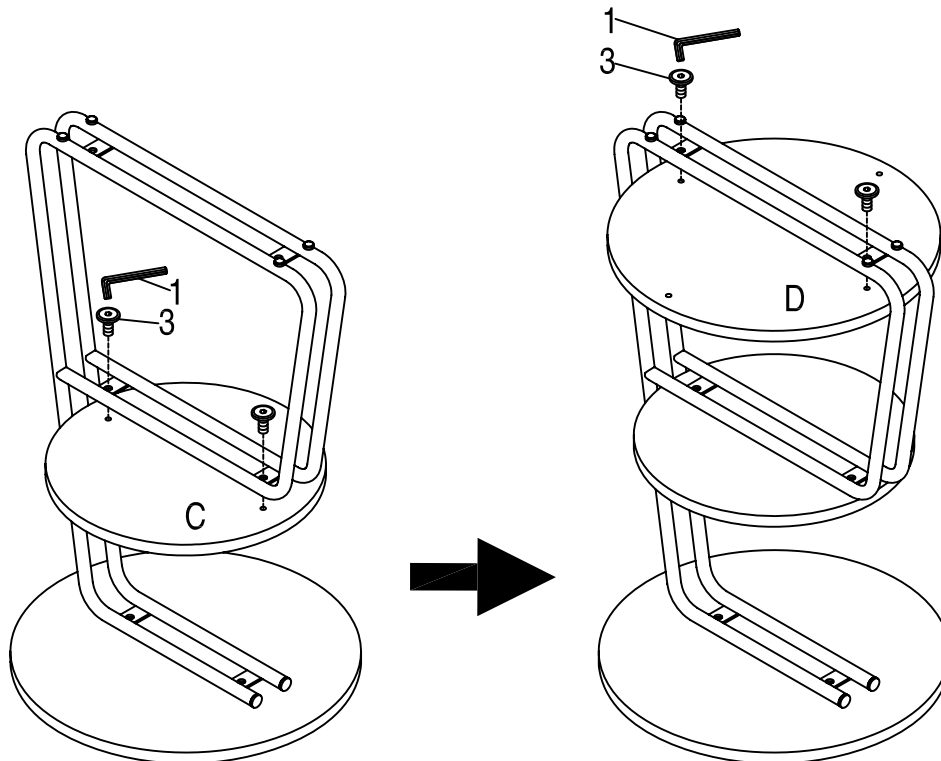

STEP 4

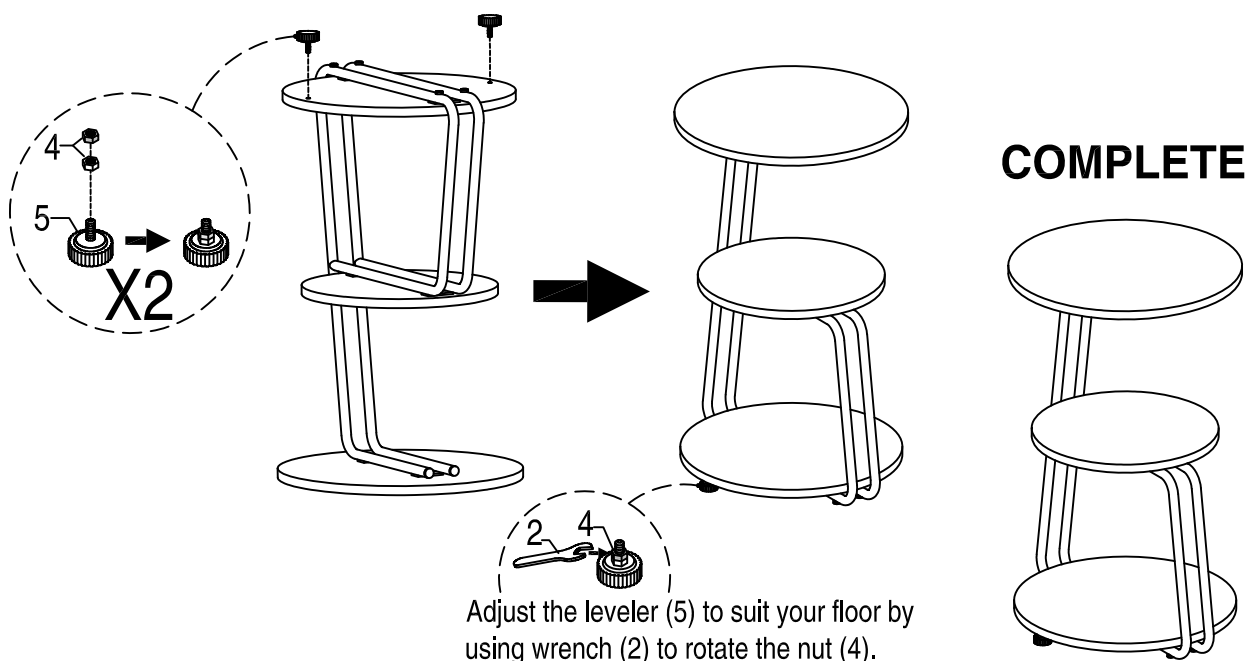

ITEM: **930071**



Product Size: 18.25" x 15.75" x 26"H

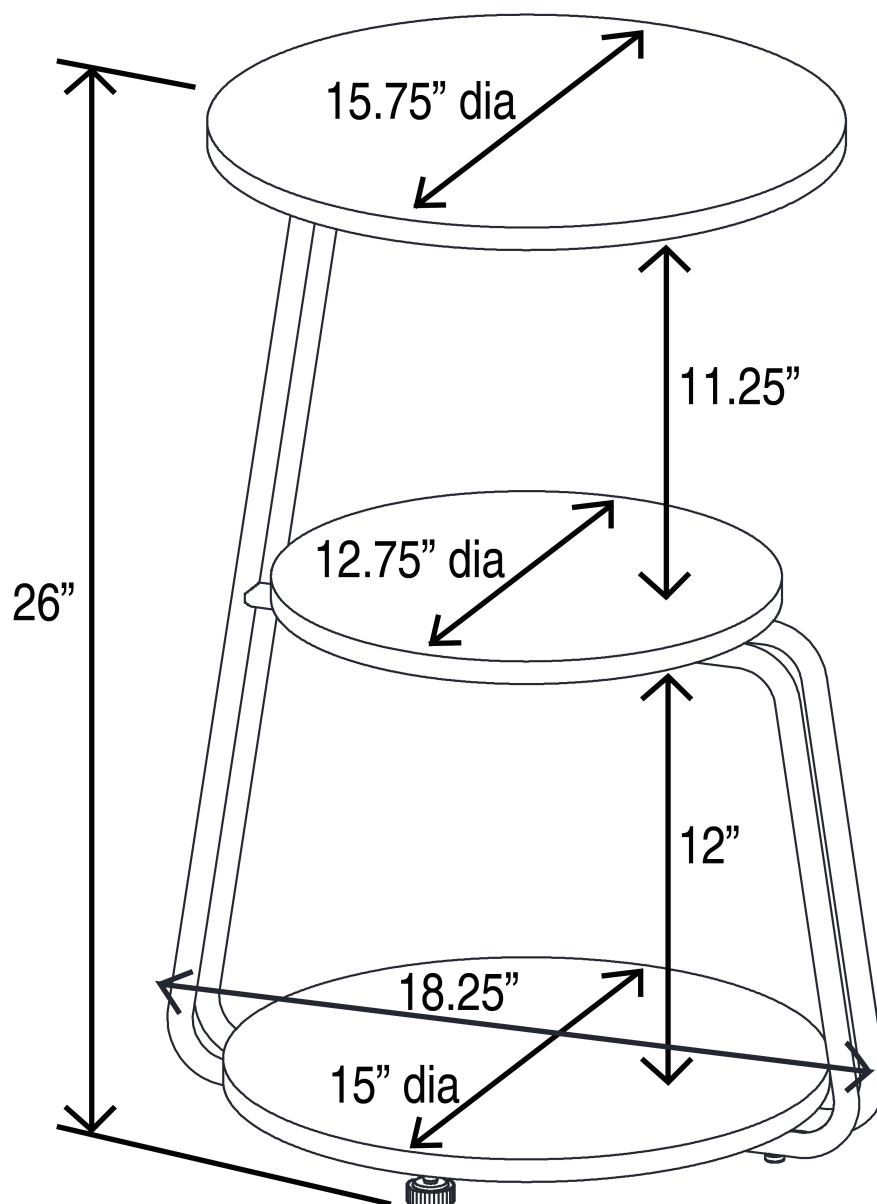

NOTE: Dimension tolerance $\pm 5\%$