

Description

The Savant On-Wall Charging Dock is used to conveniently dock and charge your iPod touch® or iPhone®.

In addition, these charging docks transform the Apple® iPod touch® into a cost-effective removable wireless touch panel providing a new user interface option (requires Savant TrueControl II app, not included).

Feature Summary

- Universal docking cradle and charger (Apple iOS devices not included)
- On-wall charging dock available in white or black
- Easy to install and effortlessly placed in strategic locations



Front View of OWC-200B

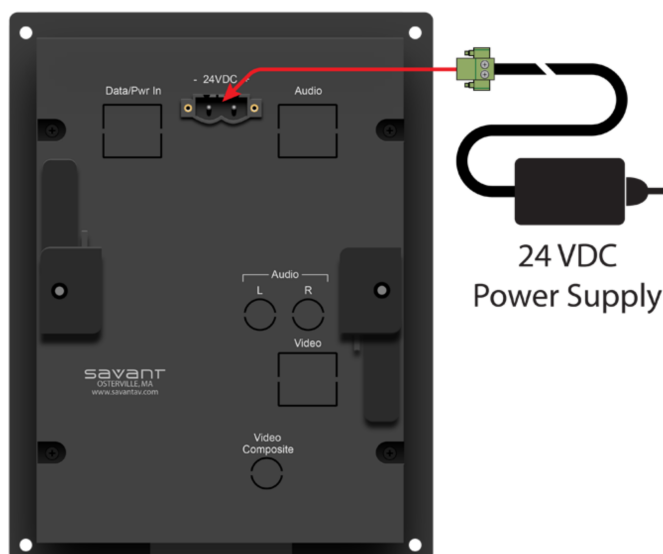

Rear View of OWC-200B

Dimensions

The next figures show the dimensions of the on-wall charging dock OWC-200B/OWC-200W.

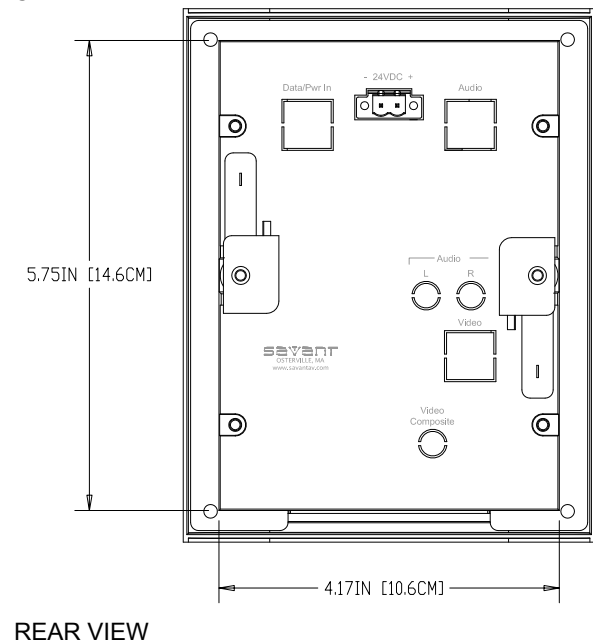
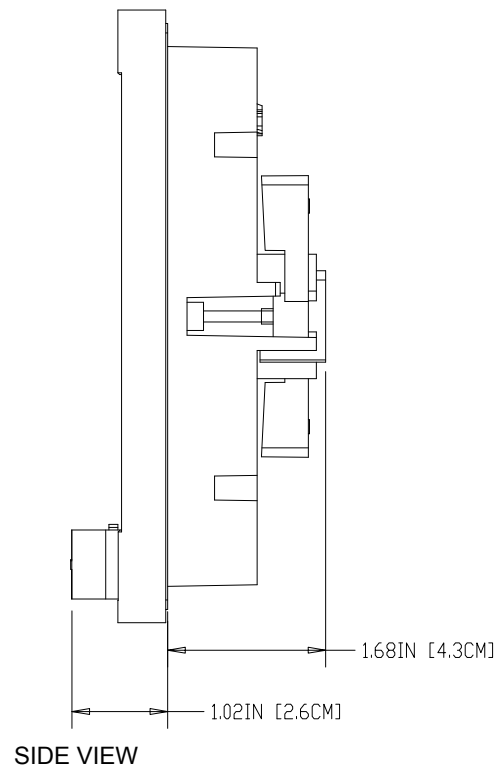
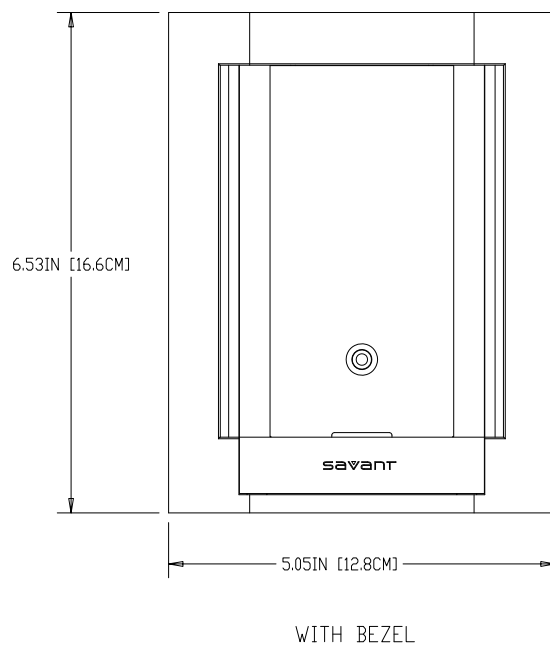
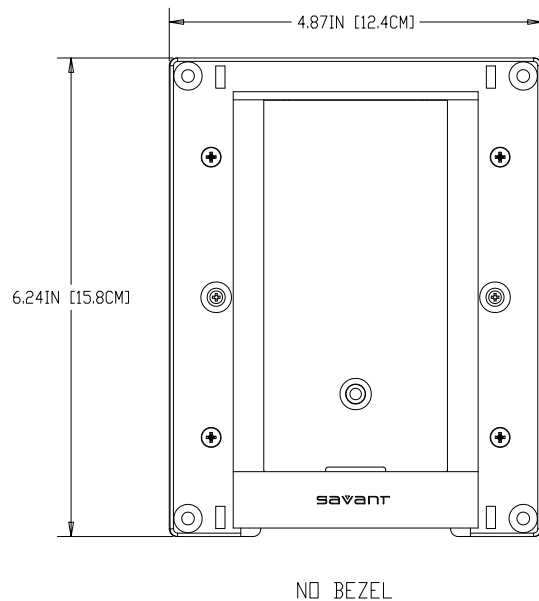

Specifications

| Environmental | |
|-----------------------|---|
| Temperature | 32° to 104° F (0° to 40° C) |
| Humidity | 10% to 90% RH (non-condensing) |
| Maximum BTU | 9 BTUs per hour |
| Dimensions and Weight | |
| Height with Bezel | 6.53 in/16.6 cm |
| Width with Bezel | 5.05 in/12.8 cm |
| Depth | 1.68 in/4.3 cm (bezel is an additional 1.02 in/ 2.6 cm) |
| Weight | .5 lb (0.23 kg) |
| Power | |
| Input Power | 24V DC, 120-230V AC, 50/60 Hz |
| Maximum Power Draw | 7 Watts |
| Compliance | |
| Safety and Emissions | FCC Part 15 CE Mark C-Tick |
| RoHS | Compliant |

Included Items

The items included with the OWC-200B/OWC-200W are outlined in the next table.

| Description | Quantity |
|--|----------|
| Two-foot Power Cord 10A plug, 1.83 m, 1250 watts or appropriate international cord | 1 |
| On-Wall Media Dock Bezel | 1 |
| 24V DC 60 Watt Power Supply | 1 |
| Two-pin Screw Down Connector | 2 |
| Media Dock Filler Plate | 1 |
| Phillips Pan Screws #8-32 X 1.75 | 2 |
| Phillips Pan Screws #6 X 1.5 | 4 |
| Cut-Out Template | 1 |
| Quick Reference Guide | 1 |

Required System Components

The system components required for use with the OWC-200B/OWC-200W are outlined in the next table.

| Description | Model Number |
|------------------|---|
| Host Controllers | HST-4001, HST-4002, SVR-4100 or SVR-4100S |
| Ethernet Network | Enterprise-grade network deployment |

Optional Accessories

An optional accessory available for use with the OWC-200B/OWC-200W is outlined in the next table.

| Description | Model Number |
|--|--------------|
| Pre/Post Construction Box for On-Wall Media Dock | RIB-OWMD |