

Assembly Instruction U8055 (MADE IN VIETNAM)

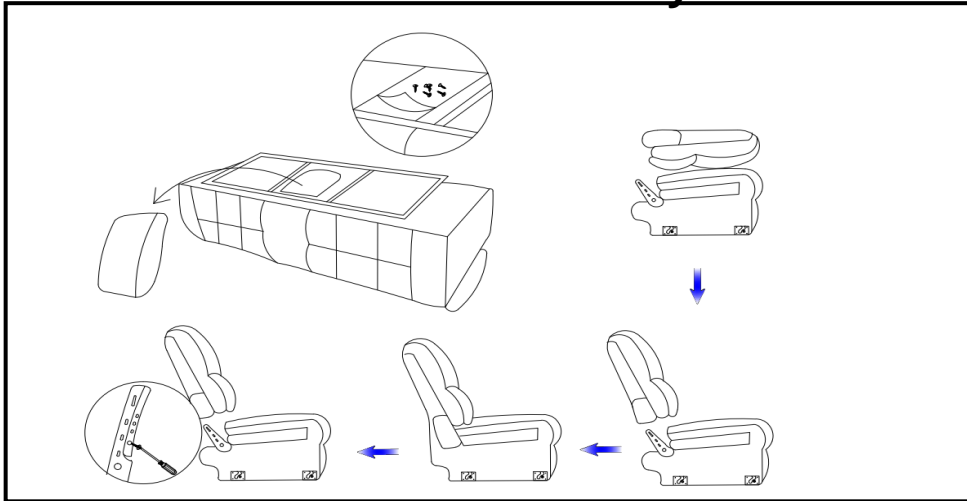

SLEEPER



Step 01

Grab the sleeper at the handle cut-out section and lift the unit up and out of the sofa to the first folded position



Step 02

Lift up on the front leg tube until it rests on the floor and the bed is fully open.

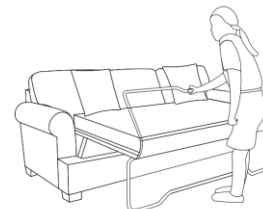

To close

Reverse step 1 and 2. Be sure the front leg tube closes completely against the folded bed.

Backrest Assemble

1. Open the Velcro under the console, take out the console back.
2. Remove the bags from Seat and Back.
3. Hold back and flap with both hands and line male and female brackets together. Apply downward force to top of back (one side at a time) to ensure snap engagement.
4. Attach Velcro back flap starting in the middle and working towards outside, pulling flap tight.
5. Above steps should be available for all the backrest in the item.

Your new sleeper mechanism is designed to provide years of reliable service.

To help your sleeper last as long as possible,

Please note these suggestions:



Don't sit on the
end of bed

Don't fold with
liner or pillows on
the mattress

Don't jump
on the bed

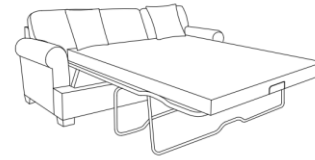

Position

Note: Disengage TV headrest before
closing.

TV Headrest Operation



To raise: Grab head tube only. Lift firmly on tube,
then release.

To lower: Repeat raising procedure.

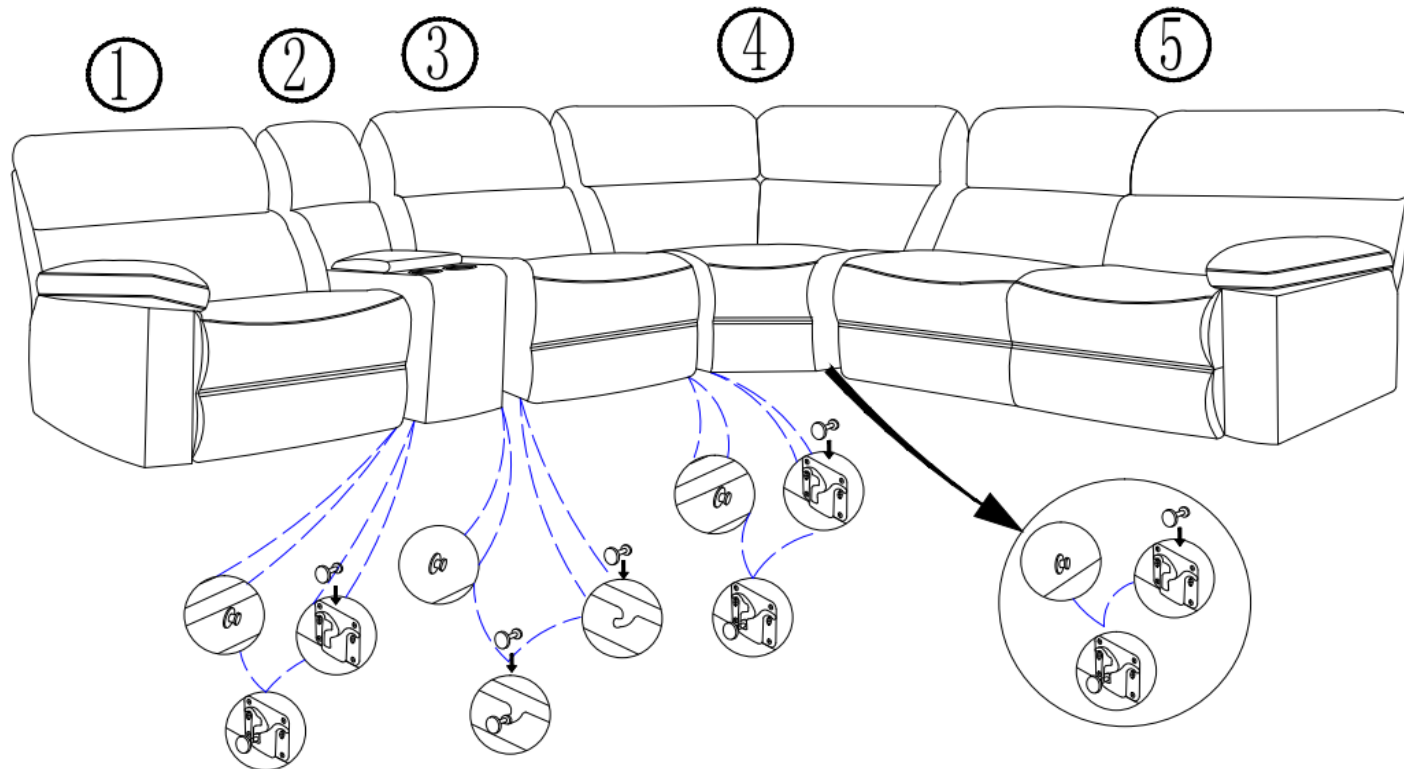

Sectional Assembly:

1. Downward hook slot location: right side of power armless recliner, wedge.
2. Upward hook slot location: left side of wedge, sofa bed.
3. Lift the side which located downward hook, let it slide into the upward hook slot, from ⑤→④→③→②→①
4. The back of ② in the tea table.

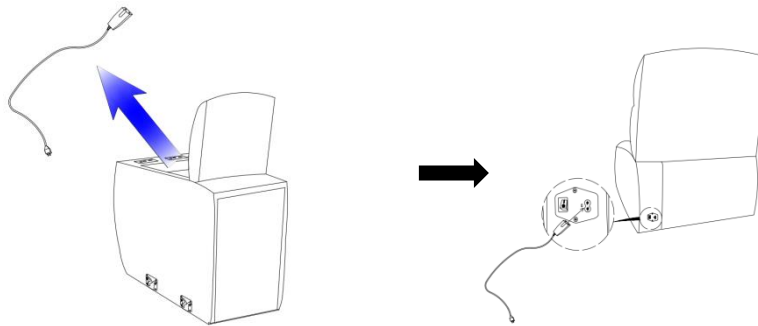

Take out the plug from the console box, connect it from the back of the armrest to the power outlet.

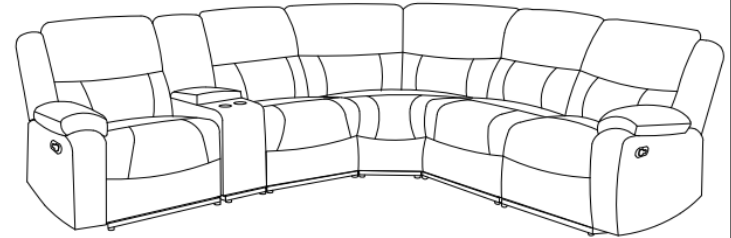

Assembly completed!