

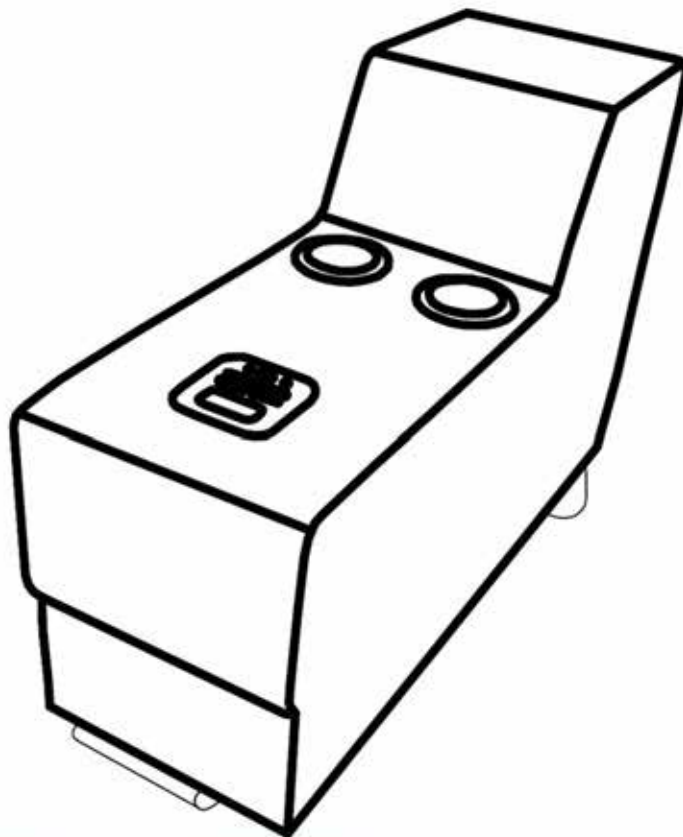

Assembly Instructions

CM6122BK-CS CM6122WH-CS CM6122RD-CS



ASSEMBLY RATING

The Assembly Rating is a 5-point system that shows the degree of effort needed in assembling a specific product (with 1 being easy and 5 being difficult). For some products, two persons are recommended.

EASY  DIFFICULT

Tools Required for Assembly

Allen Wrench



(Included)

Phillips Screwdriver



(Not Included)

ASSEMBLY & CARE ADVICE

FOR YOUR FURNITURE TO LAST, CORRECT ASSEMBLY AND PROPER MAINTENANCE ARE NECESSARY.
PLEASE FOLLOW THE INFORMATION PROVIDED BELOW TO FULLY ENJOY YOUR FURNITURE.

BASIC ASSEMBLY TECHNIQUES

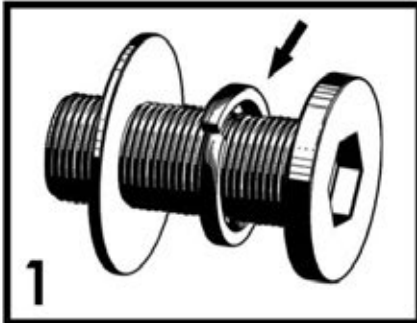

When lock or spring washer is used in an assembly, please make sure the lock or spring washer is placed between the larger flat washer and the head of the screw or bolt.

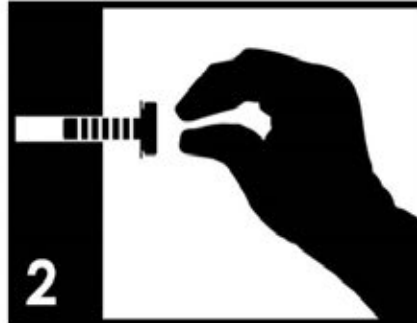

Position each part correctly and insert screws or bolts into their respective holes by hand tighten or using the proper hand tool. Only tighten when step is completed or when instructed to do so.



Use cardboard or carpet area when assembling furniture to prevent scratches. Make sure the furniture rests on a flat and level surface with each leg evenly touching the floor.

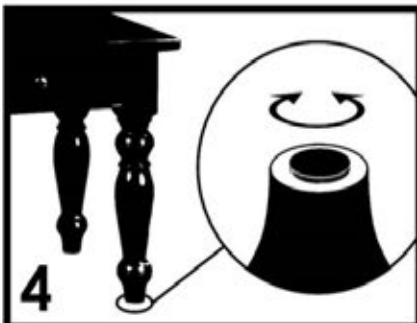

Some furniture comes with height adjustment knobs underneath each leg. To lower or to raise each leg, you need to turn clockwise or counterclockwise, respectively.

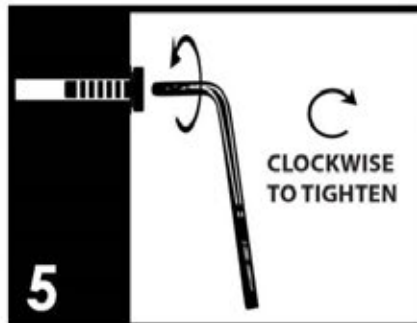

Make sure all parts are properly aligned, then use the appropriate hand tool to completely tighten the bolts or screws. Do not use power tools and do not overtighten.

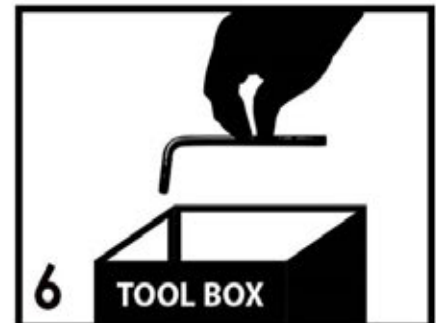

Save the instructions and store the Allen wrench or any supplied tool for later maintenance. After two weeks, check and tighten any loose hardware and repeat again every six months thereafter.

IT IS THE USER'S RESPONSIBILITY TO MAINTAIN THE FURNITURE. THE HARDWARE MAY LOOSEN OVER TIME AND MAY CAUSE THE FURNITURE TO BE WOBBLY AND UNABLE TO SUPPORT ITS INTENDED WEIGHT CAPACITY. THIS MAY LEAD TO COLLAPSE AND MAY CAUSE SERIOUS INJURY.



FAILURE TO FOLLOW THE GUIDELINES ABOVE MAY
RESULT IN INJURY AND/OR PROPERTY DAMAGE.



Before you begin, please read Page 2 of “Assembly and Care Advice”.

And remember, do not tighten until each step is completed or instructed.

MD

Parts List



#A x 1 pc
Front Leg



#E x 4 pcs
Wood Screw



#B x 1 pc
Flat Washer



#F x 2 pcs
Rear Leg



#C x 1 pc
Bolt



#G x 2 pcs
Plastic Washer



#D x 1 pc
Allen Wrench



#H x 1 pc
Power Adapter

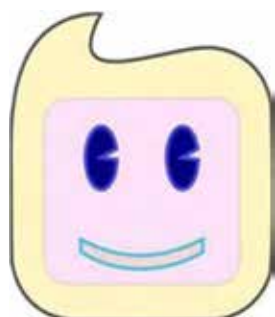

Note: The center console is sold as a stand alone unit. It is also a matching piece to CM6122 sofa and chaise set. Please contact your distributors or retailers for more information.



Step 1

- I. Remove the legs from underneath the console.
- II. Align the front leg (#A) with the five pre-drilled holes on the bottom of the console. Secured 4 wood screws (#E) onto the bracket of the front leg (#A) by using a Phillips screwdriver to tighten them down to the console.
- III. Insert a flat washer (#B) onto the bolt (#C) and secure that bolt using the Allen wrench (#D) to lock it in to the bottom of the console.
- IV. Insert a plastic washer (#G) onto the rear leg (#F). Align the threaded end of the rear leg (#F) with the pre-drilled hole of the bottom of the console and tighten by hands until secured. Repeat for the other rear leg (#F).

#B x 1 pc
#C x 1 pc
#E x 4 pcs
#G x 2 pcs

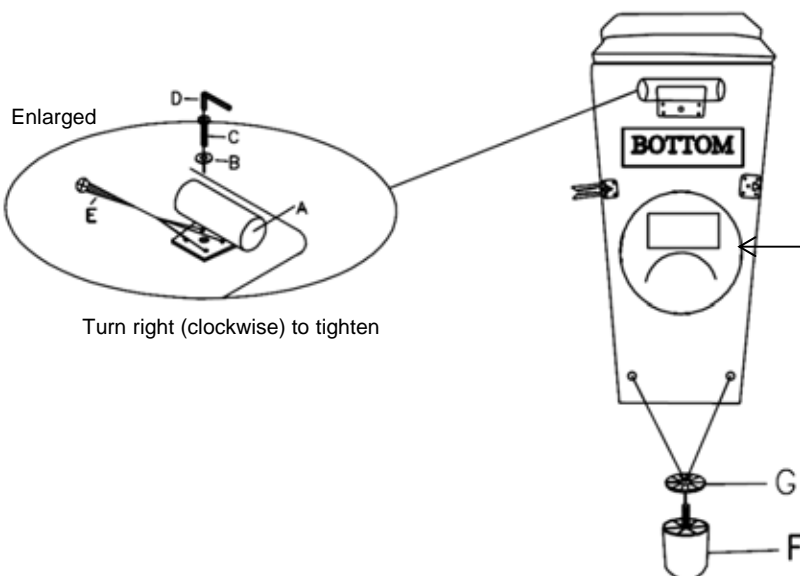

Step 2

Connect the end of the power adapter (#H) with the end of the wire coming from the console. Plug the power adapter into a wall outlet and test for power.

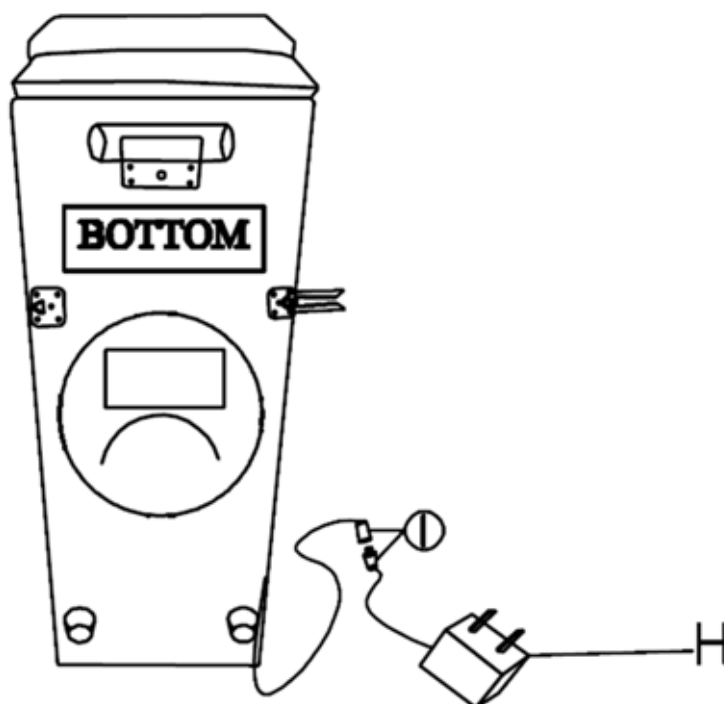

Step 3

This is an optional step for the assembly of the console to the CM6122 sofa and chaise set (sold separately). Align the locking mechanism of the console with the locking mechanism of the sofa and chaise as shown below. Make sure the parts are firmly locked together.

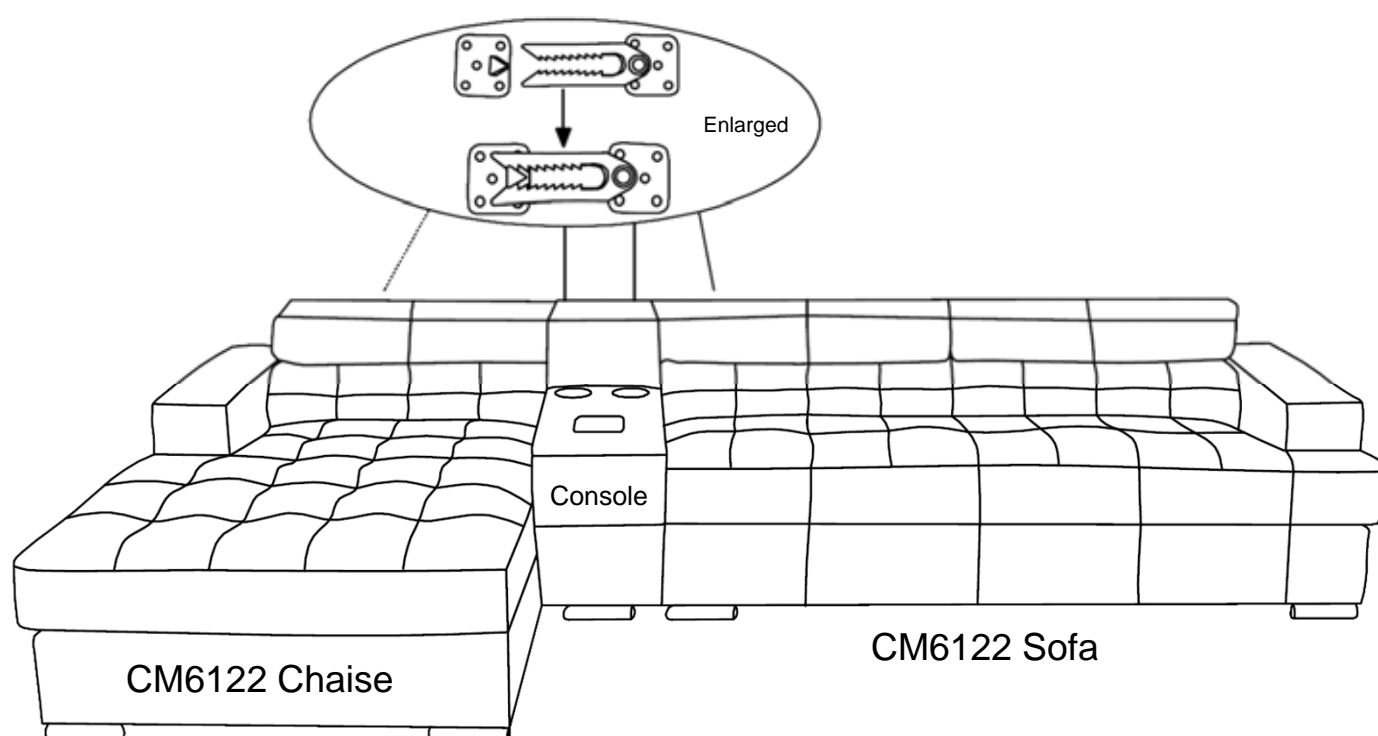

ASSEMBLY IS COMPLETED