

HRE515 • 15" Refrigerator • 5 Class



Stainless Frame



Stainless Solid



Integrated Frame



Integrated Solid

Additional Options

- Accessory panels are designed for easy installation on Integrated models



Stainless Handleless Panel

Key Features

- **Industry Exclusive: Full-depth lower interior maximizes storage options**
- **Industry Leading: Variable speed compressor delivers maximum energy efficiency, faster temperature response, and quieter operation**
- Stainless steel interior
- Stainless steel cabinet, toe kick, and accents
- U-Adjust™ Interior: 19 adjustable positions
- Three removable, full-extension Slide & Secure™ Bins
- Convection cooling system provides a quick cool down and consistent temperature
- Temperature range: 33°F - 70°F
- Adjustable bright white or blue LED lighting
- Soft close door with articulating hinge
- Volume of 2.9 cu ft holds up to 47 bottles (12 oz) or 72 cans (12 oz)
- Digital touch pad control with blue LED display
- Stainless steel handle (7/8" diameter)
- Integrated model requires 3/4" custom door panel and handle (not supplied by U-Line)
- Field reversible door is shipped right-hand hinged
- Built-in or freestanding
- Four adjustable leveling legs

MODEL DETAILS

| Model | Voltage/Hz | Door Swing | Finish | Shipping Weight |
|---------------|------------|------------------|------------------|-----------------|
| UHRE515-SG01A | 115 / 60 | Field Reversible | Stainless Frame | 105 lb |
| UHRE515-SS01A | 115 / 60 | Field Reversible | Stainless Solid | 92 lb |
| UHRE515-IG01A | 115 / 60 | Field Reversible | Integrated Frame | 103 lb |
| UHRE515-IS01A | 115 / 60 | Field Reversible | Integrated Solid | 88 lb |

ACCESSORIES

| Model | Description | Finish | Shipping Weight |
|----------------|--|-----------|-----------------|
| ULAGRILLE15 | Adjustable Grille (Accepts Integrated Panel) | Black | 1.5 lb |
| ULASHP15FRAME* | Stainless Handleless Panel Frame | Stainless | 5 lb |
| ULASHP15SOLID* | Stainless Handleless Panel Solid | Stainless | 6 lb |

HRE515 • 15" Refrigerator • 5 Class

Dimensions

Front

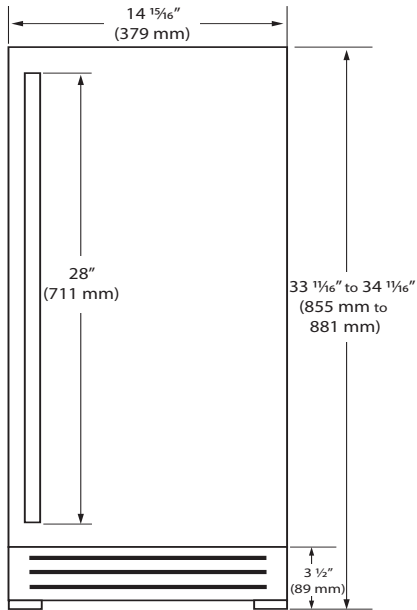

Side

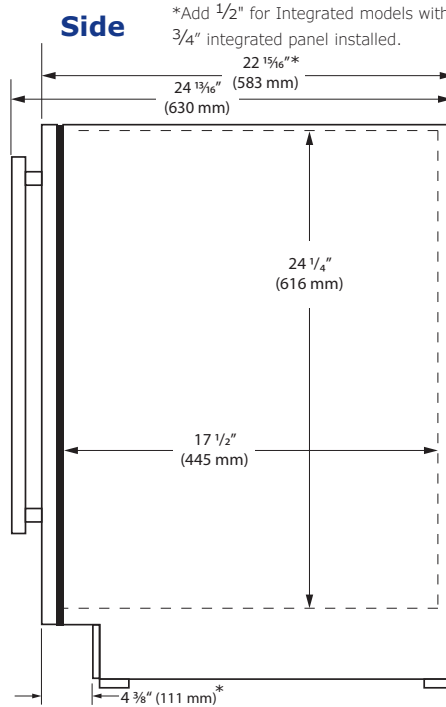

Top

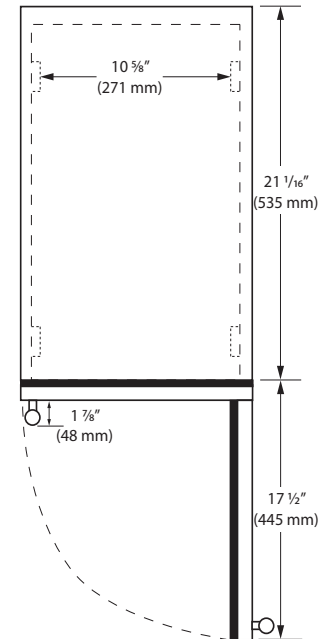

Specifications

| | |
|-----------------------------------|---|
| Model | HRE515 |
| Amps: Running | 1.2 |
| Capacity: Bottle (12 oz) | 47 |
| Capacity: Can (12 oz) | 72 |
| Capacity: Volume (cu ft) | 2.9 |
| Capacity: Wine Bottle (750 ml) | N/A |
| Dimensions: Product Depth | 22 ¹⁵ / ₁₆ " / 583 mm |
| Dimensions: Product Height (Min.) | 33 ¹¹ / ₁₆ " / 855 mm |
| Dimensions: Product Width | 14 ¹⁵ / ₁₆ " / 379 mm |
| Energy Consumption: Avg. Per Year | 255 - 285 kWh |
| ENERGY STAR (glass door) | No |
| ENERGY STAR (solid door) | Yes |
| Product Weight: Max | 105 lb |
| Refrigerant Type: | R600a |
| Sabbath (Star K Certified) | Yes |
| Temperature Range | 33°F - 70°F |

Back

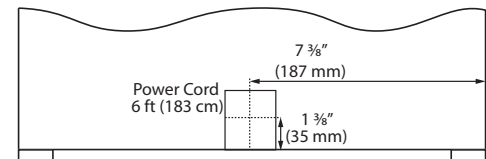

Cabinet Cut-Out

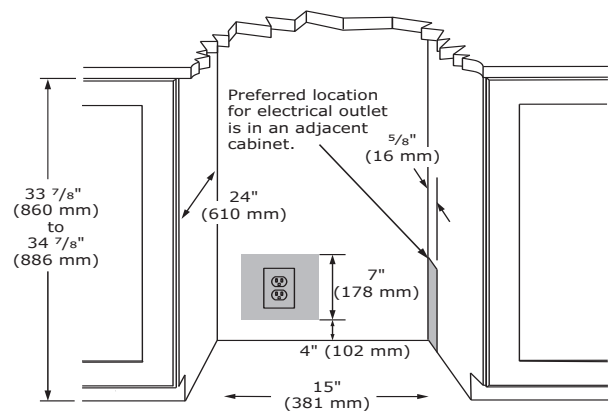

Warranty

- 1 Year (parts & labor) / 5 year sealed system (parts)
- 2 Year (parts & labor) / 5 year sealed system (parts) upgrade at no cost with product registration**



See complete warranty for details

Installation Notes

- No additional clearance is needed for ventilation
- Do not obstruct front grille air flow

