

ASSEMBLY INSTRUCTIONS

CROWNMARK
MODEL : 5109GY-2
NIGHTSTAND -KD

PART LIST

No	ITEM	Qty
A	Nightstand Box Frame	1 pc
B	Side Frame	2 pcs
C	Bottom Front & Back Apron	2 pcs
D	Bottom Shelf Panel	1 pc

HARDWARE LIST

No	ITEM	Qty
1	JCBC M6 x 40mm	4 pcs
2	JCBC M6 x 60mm	4 pcs
3	Barrel Nut M6 x 13mm	4 pcs
4	Wood Dowel 8 x 30mm	4 pcs
5	ALLEN KEY m4x65mm Blk	1 pc

STEP 1 Assemble Side Frame (B) to the Nightstand Box Frame (A) secure with JCBC (1). Then assemble Side Frame (B) to the Bottom Apron (C) secure with JCBC (2) and insert Barrel Nut (3) into predrilled hole then Tighten with Allen Key (5) as shown. Repeat the same steps for other Frame assembly.

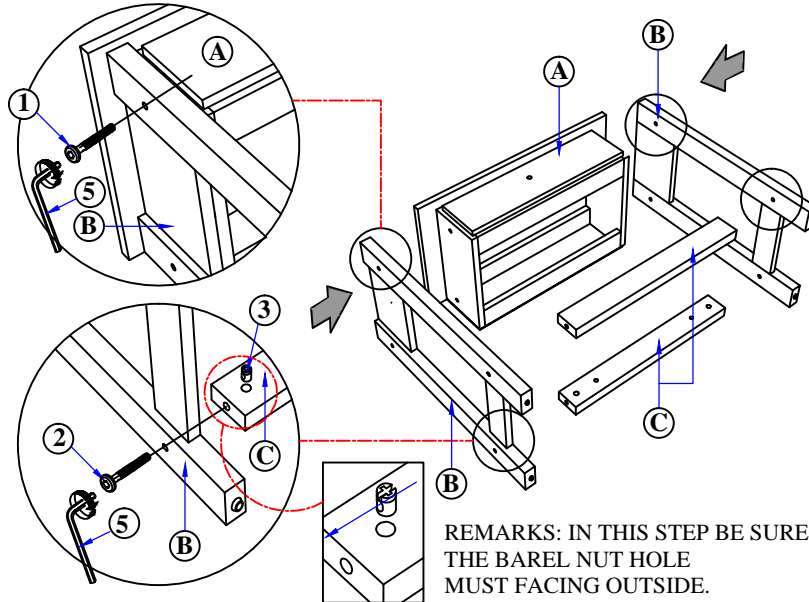

STEP 2 Insert the Wood Dowel (4) into predrilled hole as shown.

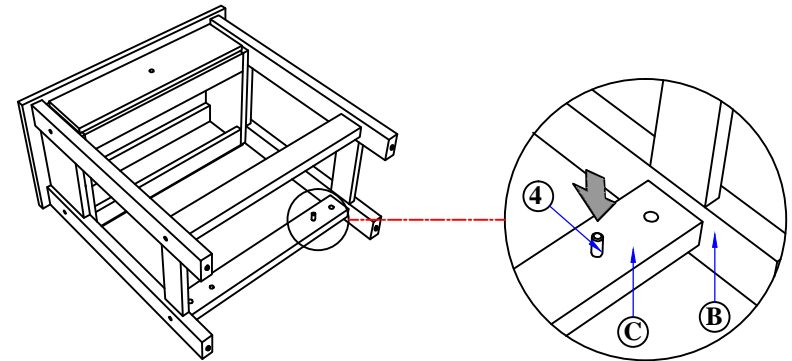

STEP 3 Fix handle from inside to outside positon as shown. Put the Bottom Shelf Panel (D) on top of wood dowel (4) as shown.

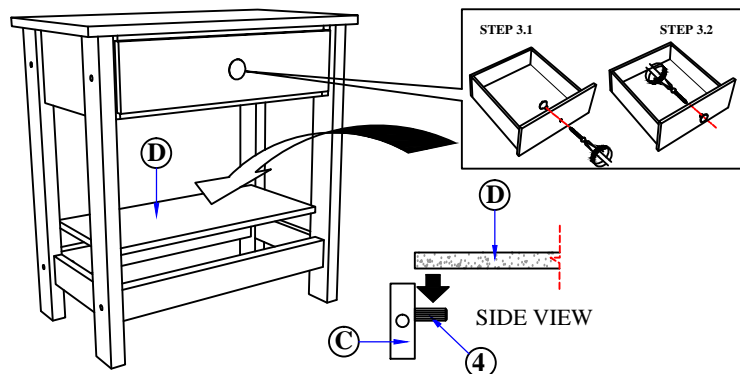

COMPLETE

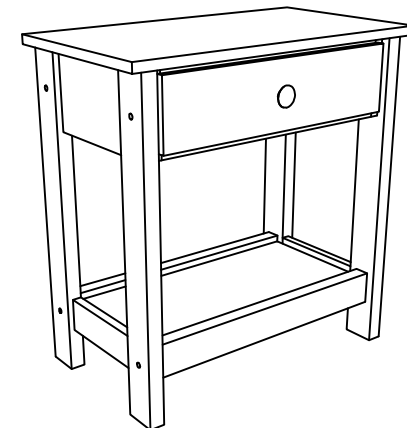

NOTE : MUST TIGHTEN SCREWS PERIODCALLY WITH USE SCREW WILL BECOME LOOSE CHECK TIGHTNESS OF ALL SCREW EVERY 6-8 WEEKS.