

# UBC3760

Undercounter Beverage Refrigerator

# LIEBHERR

## Refrigeration and Freezing

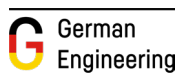

home.liebherr.com

UBC3760	
Energy consumption (kWh / y)	180
Estimated Yearly Energy Cost in US \$	25
Sound rating dB(A)	34
Refrigerator capacity cu.ft. (l)	4.6 (130)
Defrost type	Automatic
Electronic control	Touch&Swipe
Interior light	LED ceiling light - dimmable
Number of shelves / height adjustable	2/2
Shelf material	Glass
Shelf on Telescopic rails	1 pull-out glass shelf with aluminum frame 1 pull-out wooden shelf with aluminum trim
Temperature range	36°F to 50°F (2°C to 10°C)
Number of temperature zones	1
FreshAir activated charcoal filter	Yes
Door alarm	Yes
Door type	Panel ready
SoftSystem	Yes
Door hinges Right, reversible	Yes
<b>Product dimensions</b>	
in inch (H / W / D)	33 13/16 / 23 1/2 / 22 11/16
in cm (H / W / D)	85.9 / 59.7 / 57.6
<b>Cut out dimensions</b>	
in inch (H / W / D)	33 7/8 - 36 1/4 / 24 / 22
in cm (H / W / D)	86-92 / 60 / 56.5
Net weight lbs. (kg)	90.40 (41)
Voltage V / Hz	115/60

\* Energy Cost will depend on utility rates and use. Estimated energy cost based on a national average electricity cost of 14 cents per kWh.

\*\* Noise output – according to EN 60704-3



## Accessories

<b>Air Filter</b>	9882460
<b>Square Aluminum Handle</b>	9901561
<b>Round Stainless-Steel Handle</b>	9904734
<b>Stainless-steel panel right hinge</b>	9904930
<b>Stainless-steel panel left hinge</b>	9904929
<b>Height-adjustable stainless-steel toe kick</b>	7742874
<b>Lock to install in custom panel only</b>	7044118

## Features

<b>Power Cooling</b>	The fan – as powerful as it is quiet – distributes the cold air efficiently throughout the entire refrigeration compartment.
<b>Fresh Air</b>	The FreshAir activated charcoal filter cleans the circulating air and quickly binds unpleasant odors.
<b>Touch &amp; Swipe-Display</b>	Pressing buttons is a thing of the past. The Touch & Swipe display makes operation very simple and intuitive.
<b>Soft System</b>	SoftSystem integrated into the appliance door, cushions the door closure, thus eliminating slamming, even when the shelves are fully loaded.
<b>Super Cool</b>	Generates greater cold reserves so that freshly stored food can be rapidly chilled. Reversion from the chilling temperature of +35.6°F to the normal refrigeration temperature.
<b>Super Quiet</b>	Noise levels are kept to a minimum thanks to virtually silent, speed-controlled, and sound absorbing compressors.
<b>Smart Device ready</b>	The SmartDeviceBox can be installed in just a few steps and will open up the whole world of digital possibilities to you today.

# Diagrams

## Product and Cut out Dimensions

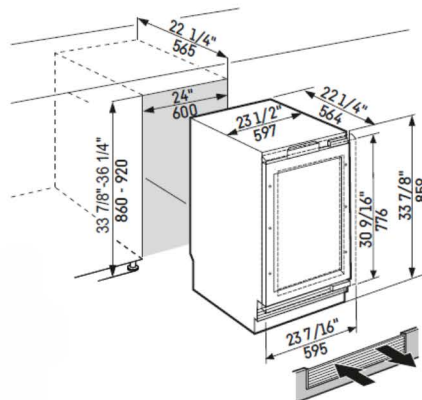
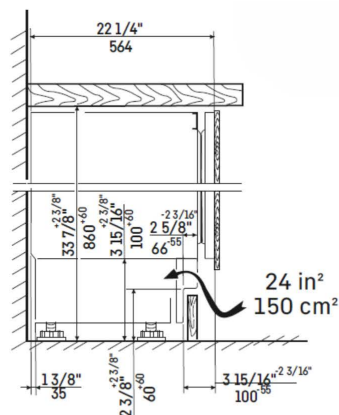

This is a built-in undercounter model which means that it is enclosed by a kitchen cabinet. This type of cabinet must be carefully constructed using the correct dimensions and it must provide suitable ventilation to ensure proper appliance operation.

The floor on which the appliance stands must be horizontal, and level and the kitchen cabinets must be aligned horizontally and vertically. The power cord exists the rear of the appliances and has a length of 6.5 ft (2m). We recommend the electrical outlet not be situated behind the appliance and be easily accessible. The under counter can be installed in a standard niche of 34" up to taller niche of 36". Height can be adjusted in a range of 2 3/8" (60mm) by turning the leveling feet.

To ensure proper refrigeration performance of the appliance, designed ventilation is required. he toe kick installation will be different depending on the cabinets where the appliance is installed. A toe kick panel will be required to cover the gap between the ventilation grill and the floor.

## Door Panel Dimensions

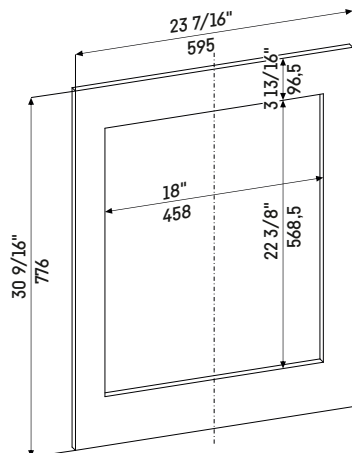

Custom panels should be at least 5/8"(16mm) and a maximum of 3/4"(19mm) thick.

Maximum value must not exceed the maximum ventilation cross-section of 24 in<sup>2</sup> (150 cm<sup>2</sup>).

Panel and handle max weight is:

Maximum weight of each custom panel door is 22 lbs. (10 kg).

If using a "shaker style" panel that undershoots the minimum panel thickness, please be aware that you will need to use shorter screws than on standard thickness panels.